

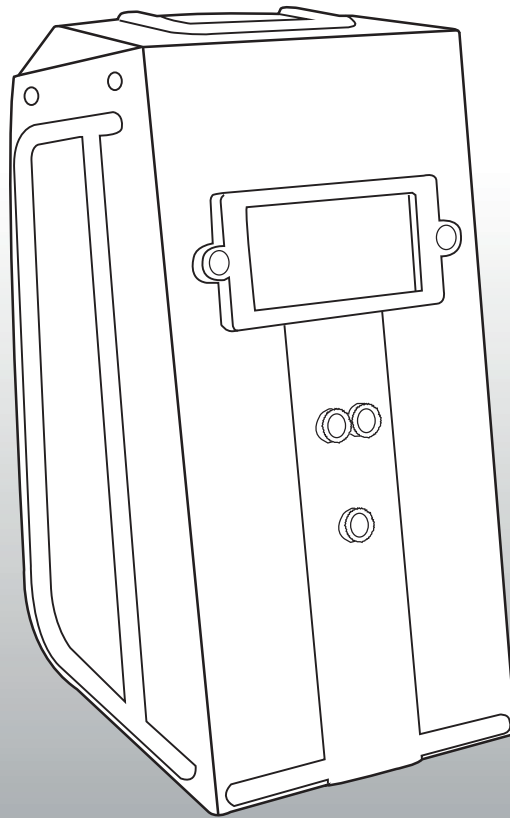

GB Original operating instructions
Welding screen

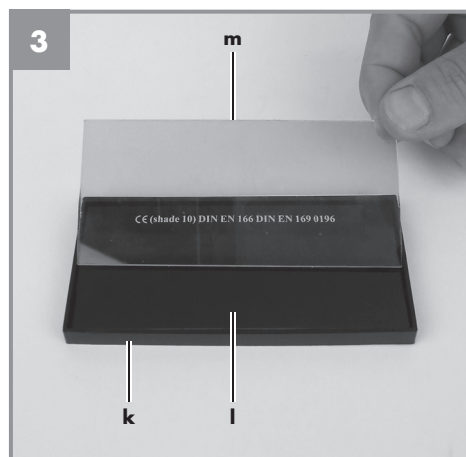

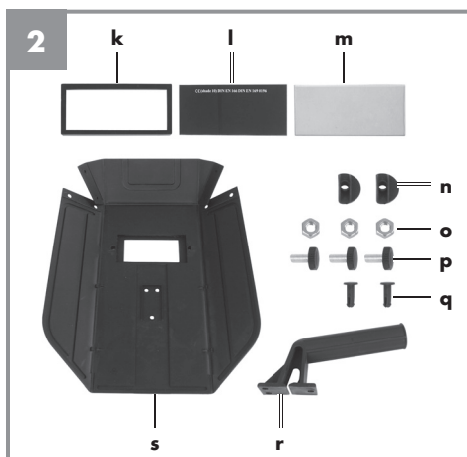

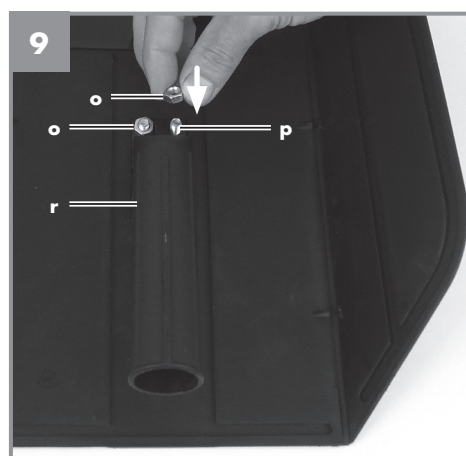
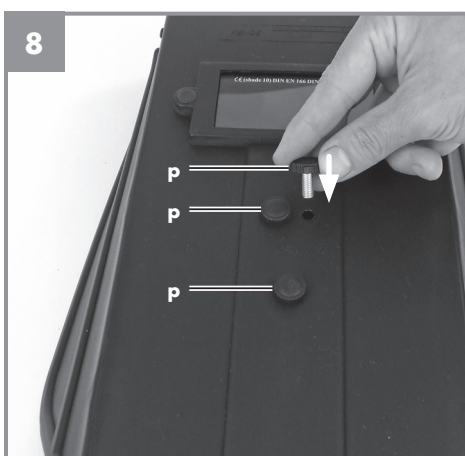
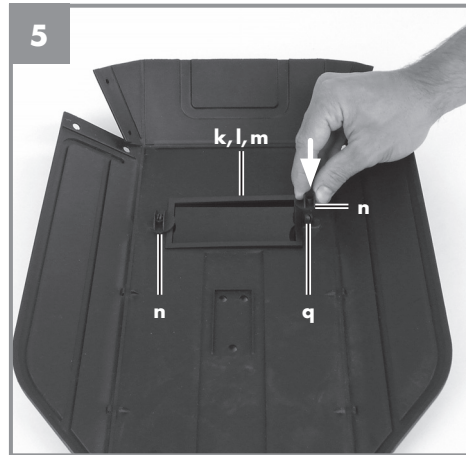

GB



Danger! - Read the operating instructions to reduce the risk of injury

Danger!

When using the equipment, a few safety precautions must be observed to avoid injuries and damage. Please read the complete operating instructions and safety regulations with due care. Keep this manual in a safe place, so that the information is available at all times. If you give the equipment to any other person, hand over these operating instructions and safety regulations as well. We cannot accept any liability for damage or accidents which arise due to a failure to follow these instructions and the safety instructions.

1. Safety regulations**Danger!****Read all safety regulations and instructions.**

Any errors made in following the safety regulations and instructions may result in an electric shock, fire and/or serious injury.

Keep all safety regulations and instructions in a safe place for future use.

- Use a bright light source (for example a lighter) to make sure that the welding screen is in perfect working order each time before you start your welding work.
- The permissible ambient temperature for operation is -5°C to +55 °C. At other temperatures the function of the equipment may be limited.
- The permissible ambient temperature for storage is -20°C to +70 °C.
- The safety window might become damaged by weld spatter. Damaged or scratched safety windows must be replaced immediately.
- Damaged or heavily soiled or spattered components must be replaced without delay.
- The welding screen is not designed to provide protection from mechanical damage (for example splinters caused by grinding or cutting with angle grinders, etc.).
- The equipment is allowed to be operated only by persons who are over 16 years of age.
- Use only accessories and spare parts that are specified in these operating instructions or are recommended by the manufacturer.
- Make yourself familiar with the safety regulations for welding. Also refer to the safety regulations for your welding set.
- Ensure that the rooms in which you wish to carry out welding work are well ventilated or use an extraction system so that the resulting smoke and toxic gases can be removed from

the area.

- Always wear the welding screen when welding. If you do not use it you may suffer serious retinal injuries.
- Always wear protective clothing when carrying out welding work.
- It is imperative to observe the accident prevention regulations in force in your area as well as all other generally recognized rules of safety. Note the information published by your professional associations. (VBG 7j)
- Never weld near inflammable liquids, gases or other highly inflammable materials.
- Materials which come into contact with the wearer's skin may cause allergic reactions on sensitive persons.
- The welding screen is not designed for laser welding.
- Protect the welding screen from high temperatures.
- Do not make any changes to the welding screen apart from those that are described in these instructions.
- Protect the transparent safety window and welding window from dirt
- Replace the transparent safety window and welding window promptly so that you can see through it easily and do not become tired when using it.

This equipment can be used by children of 16 years and older and by people with limited physical, sensory or mental capacities or those with no experience and knowledge if they are supervised or have received instruction in how to use the equipment safely and understand the dangers which result from such use. Children are not allowed to play with the equipment. Unless supervised, children are not allowed to clean the equipment and carry out user-level maintenance work.

2. Layout and items supplied**2.1 Layout**

- k Frame for safety window
- l Welding window
- m Transparent safety window
- n Safety window retaining bushes
- o Nuts for handle
- p Screws for handle
- q Safety window retaining pins
- r Handle
- s Welding screen frame

3. Proper use

The welding screen is allowed to be used only for welding purposes and only in combination with welder safety windows and front glass cover plates which are marked accordingly.

Welding methods: Welding with encased electrodes, MIG/MAG welding, TIG welding, plasma fusion cutting and micro plasma welding. Use the welding screen for only approved welding methods (see 8. Safety levels).

Caution!

The welding screen is not designed for laser welding!

The equipment is to be used only for its prescribed purpose. Any other use is deemed to be a case of misuse. The user / operator and not the manufacturer will be liable for any damage or injuries of any kind caused as a result of this.

Please note that our equipment has not been designed for use in commercial, trade or industrial applications. Our warranty will be voided if the machine is used in commercial, trade or industrial businesses or for equivalent purposes.

4. Fitting the welding screen (3-9)

- Place the welding glass (l) and the transparent safety glass (m) over it in the frame for the safety glass (k) (Fig. 3).
- Press the safety glass retaining pins (q) into the holes in welding screen frame (s) from the outside. (Fig. 4)
- Place the frame for the safety glass (k) with the welding glass (l) and transparent safety glass (m) from the inside into the recess in the welding frame (s), press the safety glass retaining bushes (n) on to the safety glass retaining pins (q) until they engage to secure the frame for the safety glass (k). The transparent safety glass (m) must be on the outside. (Fig. 5)
- Bend the top of the welding screen frame (s) inwards (Fig. 6/1) and fold down the top corners (Fig. 6/2) Now bend the outer sides of the welding screen frame (s) inwards (Fig. 6/3) and connect them by pressing the top corners and outer sides together. As the retaining pins engage, you should be able to hear

to clear clicks on each side (Fig. 6/4).

- When the top corners of the welding screen are connected as shown in Figure 7, place the screws for the handle (p) from the outside through the three holes in the welding screen. (Fig. 8)
- Turn over the welding screen and place the handle (r) over the threads on the three screws for the handle (p). Secure the handle (r) to the welding screen the three nuts for the handle (o) (Fig. 9).

Welder's hand safety screen according to DIN EN 175

CE = CE mark of European conformity

Caution!

The screen is allowed to be used for welding purposes only in combination with welder safety windows and front glass cover plates which are marked in compliance with EN 166/169.

Viewing windows with mineral filters are allowed to be used only in combination with a suitable rear glass cover plate.

Safety windows:

Use only safety windows which are approved and marked in accordance with EN 166/169. Use only filter windows with optical class 1 (safety level 4 to 14). The filter window must be selected in accordance with the welding method. Rear glass cover plate made of non-splintering, clear material.

Welder's safety filter in accordance with DIN EN 166 and DIN EN 169

Explanation: 10 = Welder's safety level, 1 = Optical class,

CE = CE mark of European conformity

Front Glass Cover

Plate in accordance with DIN EN 166

CE = CE mark of European conformity

5. Cleaning, maintenance and ordering of spare parts

5.1 Cleaning and disinfection

- Keep the welding screen free of dirt and dust as far as possible. Rub the equipment with a clean cloth or use a slightly damp cloth and a little lubricating soap. Do not use cleaning agents or solvents; these may be aggressive to the plastic parts in the equipment.
- We recommend cleaning the equipment immediately each time after use.
- You can also use a standard disinfectant to clean the welding screen.

5.2 Maintenance

Dispose of soiled maintenance material and operating materials at the appropriate collection point.

5.3 Ordering replacement parts:

Please quote the following data when ordering replacement parts:

- Type of machine
- Article number of the machine
- Identification number of the machine
- Replacement part number of the part required

For our latest prices and information please go to www.isc-gmbh.info

6. Storage

Store the equipment and accessories in a dark and dry place at above freezing temperature. The ideal storage temperature is between 5 and 30 °C. Store the electric tool in its original packaging. Because its materials are subject to aging, the helmet is allowed to be used for no more than 5 years after its date of manufacture.

You can continue to use the welding screen as long as it shows no signs of damage and as long as its materials do not become brittle. For prolonged life, do not expose it to great heat.

7. Disposal and recycling

The equipment is supplied in packaging to prevent it from being damaged in transit. The raw materials in this packaging can be reused or recycled. The equipment and its accessories are made of various types of material, such as metal and plastic. Never place defective equipment in your household refuse. The equipment should be taken to a suitable collection center for proper disposal. If you do not know the whereabouts of such a collection point, you should ask in your local council offices.

Notified body:

DIN CERTCO Gesellschaft für Konformitätsbewertung mbh

Alboinstrasse 56

12103 Berlin

Notified body number 0196

8. Safety levels

Table of recommended safety level use for the suitable welding methods

Method	Current strength A																											
	1,5	6	10	15	30	40	60	70	100	125	150	175	200	225	250	300	350	400	450	500	600							
Encased electrodes	8				9				10				11				12				13				14			
MAG	8				9				10				11				12				13				14			
WIG	8				9				10				11				12				13							
MIG with heavy metals	9				10				11				12				13				14							
MIG with light metals	10				11				12				13				14											
Arc-air gouging	10				11				12				13				14				15							
Plasma fusion cutting	9				10				11				12				13											
Micro plasma welding	4		5		6		7		8		9		10		11		12											
	1,5	6	10	15	30	40	60	70	100	125	150	175	200	225	250	300	350	400	450	500	600							
Please note: The term "heavy metals" refers to steel, alloyed steel, copper and its alloys, etc.																												