

Ⓒ Operating Instructions
Impact Drill

P O W E R
CRAFT

CE

Art.-No.: 42.589.66

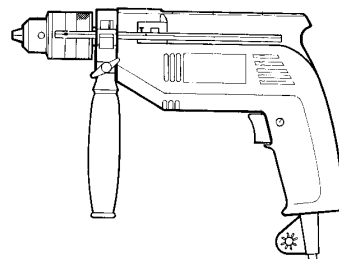

EHD 500 E



Ⓞ **Important:** Read and note the operating instructions and safety regulations before using!

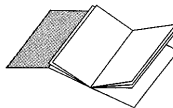

Ⓞ Please pull out page 2

Ⓞ **Contents:**

	Page
Description	3 / 4
General safety regulations and accident prevention	4
Operating instructions for electric hammer drills	5
EC conformity declaration	6
Warranty certificate	7

1

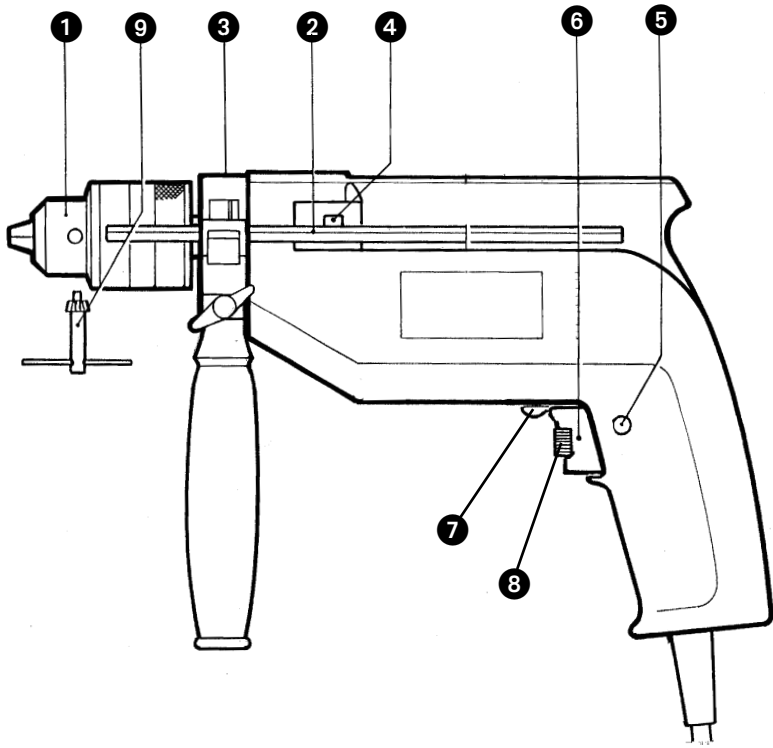

GB

Description

- 1 Sprocket chuck
- 2 Drilling depth stop
- 3 Supplementary grip
- 4 Drill/Hammer drill selector switch
- 5 Locking button
- 6 ON/OFF switch
- 7 Selector button: clockwise/anticlockwise
- 8 Speed control
- 9 Chuck key

General safety regulations and accident prevention

To ensure the accident-free and safe operation of this tool, please read and observe these safety regulations and operating instructions.

- Before each use, check the appliance, the power cable and the plug. Use only when the appliance is in perfect working order and undamaged. Any damaged parts must be replaced immediately by a qualified electrician.
- Always remove the plug from the socket before doing any work on the machine, before each tool change and whenever the drill is not in use.
- To prevent damage to the power cable, always ensure that the power cable trails behind the machine.
- When working outdoors, use only an extension lead designed for this purpose. The extension lead used must have a minimum cross section of 1.5 mm². The plug connection must be properly earthed and water-proof.
- Keep tools safe and away from children.
- When grinding, brushing and splitting, always wear safety goggles, protective gloves and ear defenders. Wear a mask for work which generates dust.
- Never leave the tool key in the machine. Before switching on, make sure the key and adjustment tools have been removed.
- Make sure the workpiece to be drilled cannot slip (clamp it).
- Use a dust extractor when working with stone (splitting and grinding). The dust extractor must be suitable for the extraction of stone dust.
- **Do not work on asbestos-containing materials.** Observe the professional association's relevant accident prevention regulations (VBG 116).
- Fire risk! When splitting and grinding materials, make sure there are no combustible materials within range of the sparks.
- Use only original spare parts.
- Repairs must be performed only by qualified electricians.
- Noise levels at the place of work should not exceed 85 db (A), in which case the operator will need ear defenders. The noise produced by this electric tool has been measured according to IEC 59 CO 11, IEC 704, DIN 45635 Part 21, NFS 31-031 (34/537/EC).
- Make sure you have a firm footing and avoid any abnormal postures.
- Do not expose your electric tool to rain. Do not use electric tools in a wet or damp environment or in the vicinity of combustible liquids.
- Do not carry the electric tool by the power cable. Protect the cable from damage caused by oil, solvents and sharp edges. Never carry the electric tool by the power cable.
- Keep your working area tidy.
- Make sure the ON/OFF switch is off before plugging in the drill.
- Wear suitable work clothes. Do not wear loose-fitting clothes or jewellery. If you have long hair, wear a hair net.
- In the interests of your own safety, use only accessories made by the same manufacturer.
- Take account of the drill's reaction moment, especially when the drill bit seizes.
- Vibration measured in the handle according to ISO 5349.

Operating Instructions for the Impact Drill EHD 500 E

Use only sharp bits and use your machine carefully.

STARTING UP

Momentary operation (Fig. 2)

Switch on: Press ON/OFF switch 7

Switch off: Release ON/OFF switch 7

Continuous operation (Fig. 2)

Switch on: Press ON/OFF switch 7 and lock in place with the locking button 6

Switch off: Press and release ON/OFF switch 7

Drill/Hammer drill selector switch (Fig. 3)

You can change from drilling to hammer-drilling using the selector switch 4. To drill, push the selector switch 4 to the „drill“ symbol on the left. To hammer-

drill, push switch 4 to the „hammer“ symbol on the right. The hammer drill function is for drilling in masonry, concrete and stone.

TECHNICAL DATA:

Voltage:	230 V 50 Hz
Power rating:	500 W
Chucking range:	1.5 mm dia. - 13 mm
Speed:	max. 2800 rpm
Sound pressure level LPA:	93 db (A)
Power level LWA:	103 db (A)
Vibration a_w	10 m/s ²
Weight	2 kg
Totally insulated	

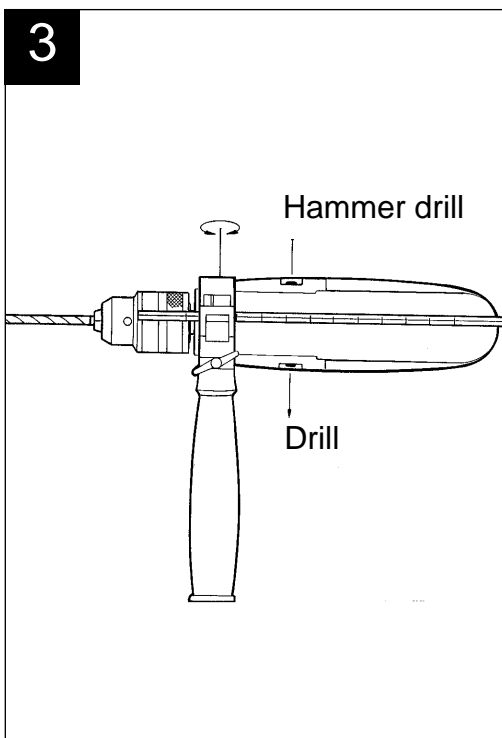
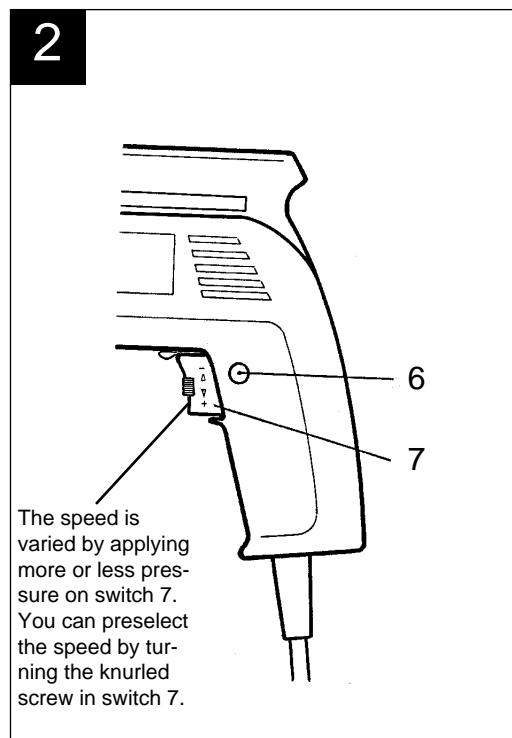

(GB)	(FIN)	(N)	(GR)	(I)	(DK)
EC Declaration of Conformity The Undersigned declares, on behalf of	EC Yhdennukaisuusilmoitus Allekirjoittanut ilmoittaa yhtiön	EC Konfirmitetserklæring Undertegnede erklærer på vegne av firma	EC Δήλωση περί της ανταπόκρισης Ο υπεγράφων δηλώνει εν ονόματι της εταιρίας	Dichiarazione di conformità CE Il sottoscritto dichiara in nome della ditta	EC Overensstemmelses-erklæring Undertegnede erklærer på vegne af firmaet
ISC GmbH - Eschenstraße 6 · D-94405 Landau/Isar					
that the	nimissä että	at	ότι η	che la	at
Machine / Product	kone/tuote	Maskin/produkt	μηχανή / το προϊόν	macchina/prodotto	maskine/produkt
Impact Drill	Sähköporakone	Elektrisk slagboremaskin	Ηλεκτρικό κρουστικό τυπύακι	Trapano elettrico	Elektrisk slagboremaskine
produced by:	merkki	Merke	υάρκα	marca	mærke
P O W E R CRAFT					
Type	tyyppi	Type	τύπος	tipo	type
EHD 500 E					
is in accordance with the <input checked="" type="checkbox"/> EC Directive regarding machinery 89/392 EEC, as amended; <input checked="" type="checkbox"/> EC Directive regarding low-voltage equipment 73/23 EEC; <input checked="" type="checkbox"/> EC Directive regarding electromagnetic compatibility 89/336 EEC, as amended.	vastaa <input checked="" type="checkbox"/> EU-komeditiiviki (johon on tehty muutoksia) 89/392/EWG <input checked="" type="checkbox"/> EU-pienjännitedirektiiviä 73/23 EWG <input checked="" type="checkbox"/> EU-direktiiviä 89/336 EWG (johon on tehty muutoksia) ja joka koskee sähkömagneti- eettisiä mukautuvuutta (EMl)	tillfredsstillter følgende retningslinjer: <input checked="" type="checkbox"/> EU Maskinretningslinje 89/392/EWG med ændringer <input checked="" type="checkbox"/> EU Lavspennings- retningslinje 73 / 23 EWG <input checked="" type="checkbox"/> EU Rainingslinje for elektromagnetisk kompatibilitet 89/336 EWG med endringer,	ανταποκρίνεται στην <input checked="" type="checkbox"/> κατευθυντήρια γραμμή της Ευρωπαϊκής Κοινότητας 89/392/EOK με αλλαγές <input checked="" type="checkbox"/> κατευθυντήρια γραμμή χαμηλής τάσεως της Ευρωπαϊκής Κοινότητας 73/23/EOK <input checked="" type="checkbox"/> κατευθυντήρια γραμμή ηλεκτρομαγνητικής ανεκτικότητας της Ευρωπαϊκής Κοινότητας 89/336/EOK με αλλαγές;	corrisponde <input checked="" type="checkbox"/> alla Direttiva CE sulle macchine 89/392/CEE con modifiche <input checked="" type="checkbox"/> alla Direttiva CE sulla bassa tensione 73/23 CEE <input checked="" type="checkbox"/> alla Direttiva CE sulla compatibilità elettro- magnetica 89/336 CEE con modifiche CEE con modificaciones.	oplyder <input checked="" type="checkbox"/> EU-maskindirektiv 89/392/EØF med ændringer <input checked="" type="checkbox"/> EU-lavspændingsdirektiv 73/23/EØF <input checked="" type="checkbox"/> EU-direktiv vedr. elektromagnetisk støj (EMC) 89/336/EØF med ændringer.
Landau/Isar, (date) 04.07.2000	Landau/Isar 04.07.2000	Landau/Isar, den 04.07.2000	Landau/Isar, στις 04.07.2000	Landau/Isar, il 04.07.2000	Landau/Isar, den 04.07.2000
Produkt-Management	Produkt-Management	Produkt-Management	Produkt-Management	Produkt-Management	Produkt-Management
EN 50144-1 EN 50144-2-1 EN 55014-1 EN 55014-2 EN 61000-3-2 EN 61000-3-3					
BSM - 0644 - 26 - 4141800-E					

Achieving / For archives:

BSM - 0644 - 26 - 4141800-E

® WARRANTY CERTIFICATE

The guarantee period begins on the sales date and is valid for 1 year.

Responsibility is assumed for faulty construction or material or functional defects.

Any necessary replacement parts and necessary repair work are free of charge.

We do not assume responsibility for consequential damage. Your statutory rights are not affected.

Your customer service partner

Service UK:

® Einhell UK Ltd
Brook House, Brookway
North Chesire Trading Estate
Prenton, Wirral, Chesire
CH 43 3DS
Tel. 0151 6084802, Fax 0151 6086339

Technical specification subject to change

EH07/00

