

ozito

HIGH PRESSURE WASHER KIT

1500W 1885PSI

INSTRUCTION MANUAL

SPECIFICATIONS

Mains Voltage:	230-240V ~ 50Hz
Input Power:	1500W
Allowable Pressure:	13MPa (1885psi)
Rated Pressure:	9MPa (1305psi)
Max. Flow Rate:	8L/min
Rated Flow:	5L/min
Max. Inlet Pressure:	1MPa (145psi)
Hose Length:	5m
Power Cord Length:	5m
IP Rating:	IPX5
Noise Rating:	92dB
Weight:	7.6kg

ozito.com.au



3 YEAR

REPLACEMENT WARRANTY*

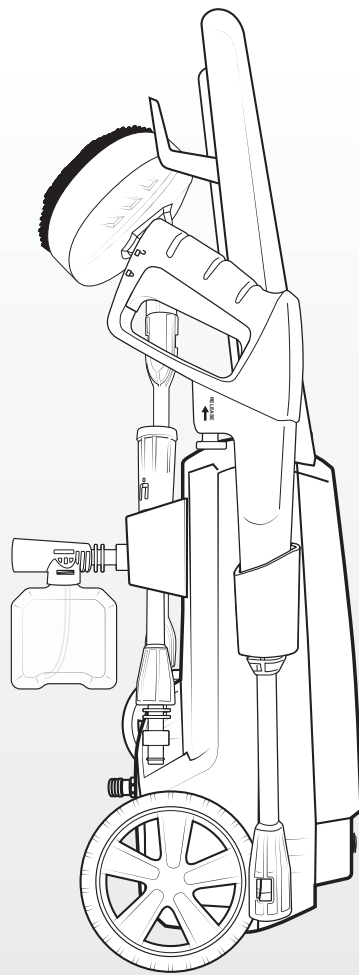

STANDARD EQUIPMENT

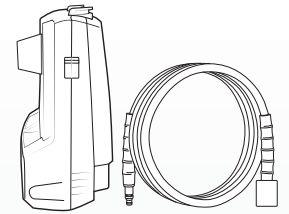

Pressure Washer & High Pressure Hose

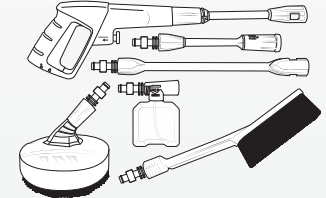

Spray Gun, Adjustable Turbo Lance, Extension Lance, Patio Cleaner, Foam Bottle & Wash Brush

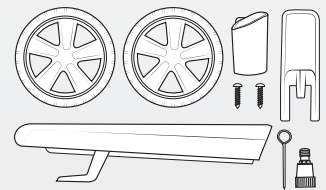

2 x Wheels, Handle, 2 x Screws, Accessory Holder, Cable Hook, Cleaning Needle & Hose Adaptor with Filter

HPW-1885K

WARRANTY

IN ORDER TO MAKE A CLAIM UNDER THIS WARRANTY YOU MUST RETURN THE PRODUCT TO YOUR NEAREST BUNNINGS WAREHOUSE WITH YOUR BUNNINGS REGISTER RECEIPT. PRIOR TO RETURNING YOUR PRODUCT FOR WARRANTY PLEASE TELEPHONE OUR CUSTOMER SERVICE HELPLINE:

Australia: 1800 069 486

New Zealand: 0508 069 486

TO ENSURE A SPEEDY RESPONSE PLEASE HAVE THE MODEL NUMBER AND DATE OF PURCHASE AVAILABLE. A CUSTOMER SERVICE REPRESENTATIVE WILL TAKE YOUR CALL AND ANSWER ANY QUESTIONS YOU MAY HAVE RELATING TO THE WARRANTY POLICY OR PROCEDURE.

The benefits provided under this warranty are in addition to other rights and remedies which are available to you at law.

Our goods come with guarantees that cannot be excluded at law. You are entitled to a replacement or refund for a major failure and for compensation for any other reasonably foreseeable loss or damage. You are also entitled to have the goods repaired or replaced if the goods fail to be of acceptable quality and the failure does not amount to a major failure.

Generally you will be responsible for all costs associated with a claim under this warranty, however, where you have suffered any additional direct loss as a result of a defective product you may be able to claim such expenses by contacting our customer service helpline above.

3 YEAR REPLACEMENT WARRANTY*

Your product is guaranteed for a period of **36 months from the original date of purchase**. If a product is defective it will be replaced in accordance with the terms of this warranty. Warranty excludes consumable parts, for example: valve adapters and accessories.

*This product is intended for DIY use only and replacement warranty covers domestic use.

WARNING

The following actions will result in the warranty being void.

- If the tool has been operated on a supply voltage other than that specified on the tool.
- If the tool shows signs of damage or defects caused by or resulting from abuse, accidents or alterations.
- Failure to perform maintenance as set out within the instruction manual.
- If the tool is disassembled or tampered with in any way.
- Professional, industrial or high frequency use.

KNOW YOUR PRODUCT

HIGH PRESSURE WASHER

- | | |
|----------------------|------------------------------|
| 1. Transport Handle | 10. Accessory Storage Holder |
| 2. Spray Gun | 11. Adjustable Turbo Lance |
| 3. On/Off Dial | 12. Hose Release Button |
| 4. Accessory Holder | 13. Extension lance |
| 5. Spray Gun Lance | 14. Spray Trigger |
| 6. Water Outlet Port | 15. Trigger Lock |
| 7. Wheel | 16. Patio Cleaner |
| 8. Water Inlet Port | 17. Hose Hook |
| 9. Foam Bottle | |

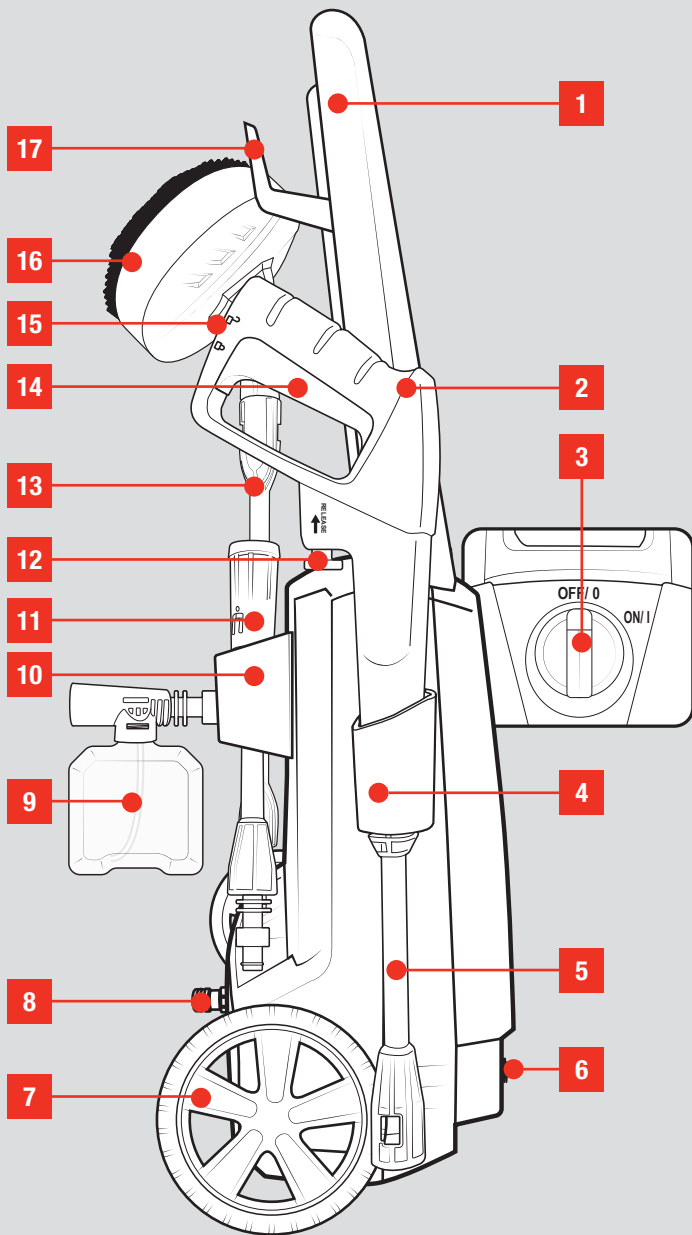

ONLINE MANUAL

Scan this QR Code with your mobile device to take you to the online manual.

3 YEAR REPLACEMENT WARRANTY*



SETUP & PREPARATION

1. ASSEMBLY



WARNING! ENSURE THE TOOL IS TURNED OFF AND DISCONNECTED FROM THE POWER SUPPLY BEFORE PERFORMING ANY OF THE FOLLOWING OPERATIONS.

Attaching The Handle

1. Slide the base of the handle into the tabs on the top of the unit.
2. Insert the two screws (supplied) through the tabs and into the handle.
3. Using a phillips head screwdriver, tighten the screws into place.

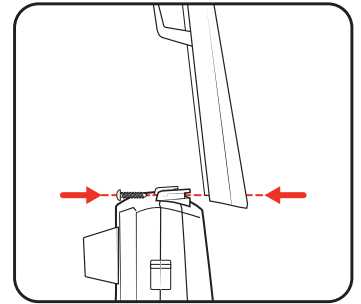

Installing The Wheels

1. Press the wheel onto the tab on one side of the unit until it clicks into place.
2. Repeat the step above for the other wheel.

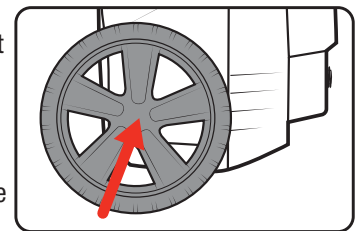

Attaching The Accessory Holder & Cable Hook

1. Slide the accessory holder onto the slots on one side of the unit until it clicks into place.
2. Slide the cord hook onto the slot on the other side of the unit until it clicks into place.

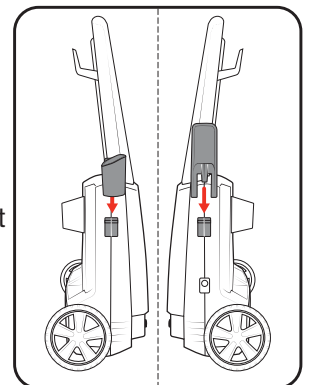

2. ACCESSORIES



WARNING! ENSURE THE TOOL IS TURNED OFF AND DISCONNECTED FROM THE POWER SUPPLY BEFORE PERFORMING ANY OF THE FOLLOWING OPERATIONS.



WARNING! THIS PRODUCT MUST NOT BE CONNECTED TO THE POTABLE WATER MAINS WITHOUT BACKFLOW PREVENTION. CHECK LOCAL AND NATIONAL PLUMBING REGULATIONS BEFORE CONNECTING THE MACHINE TO THE POTABLE WATER MAINS.

Connecting The Water Supply

This pressure washer requires a pressurised water source with a maximum pressure of 1MPa (145psi). It is recommended that a reinforced garden hose (with minimum diameter of 12mm) is used for the inlet connection. It cannot be used with a bucket and siphon.



WARNING! RUN WATER THROUGH THE GARDEN HOSE BEFORE ATTACHING IT TO THE PRESSURE WASHER TO PREVENT ANY SAND OR DIRT FROM ENTERING THE UNIT.

1. Place the mesh inlet filter into the hose adaptor, and then screw this onto the water inlet port.

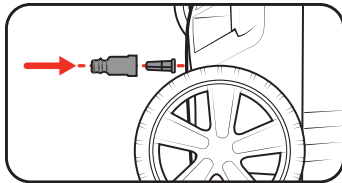

Note: The mesh inlet filter must be in place to prevent impurities in the water source from entering the unit and damaging the pump.



WARNING! ENSURE THE GARDEN HOSE IS ADEQUATELY RATED AND SUFFICIENTLY LONG FOR THE INTENDED APPLICATION.

2. Push the standard quick coupling adaptor on the end of the garden hose onto the hose adaptor on the pressure washer until it clicks into place.

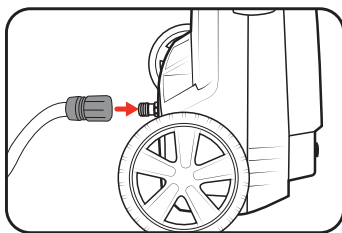

Note: The standard 12mm quick coupling adaptor should be used.

3. Pull gently on the hose to ensure the connection is secure.

Connecting The Pressure Hose

1. Push the flat end of the high pressure hose into the water outlet port and screw it clockwise into place.

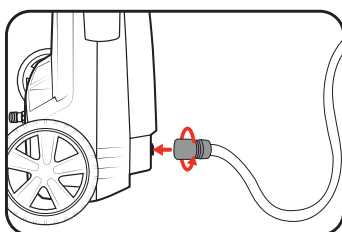

Attaching The Spray Gun & Accessories

1. Push the desired accessory into the spray gun lance and twist clockwise to lock it into place.

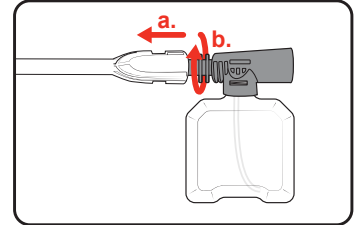

Note: If a longer reach is required, connect the extension lance to the spray gun lance, and attach the desired accessory to the free end of the extension lance.

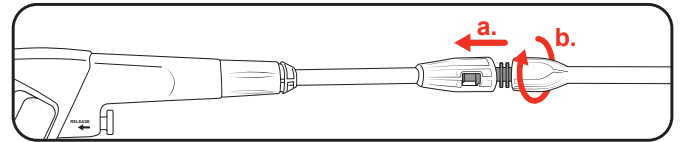

Note: There is a locking sleeve on the patio cleaner and spray gun to prevent the accessory from coming loose during use.

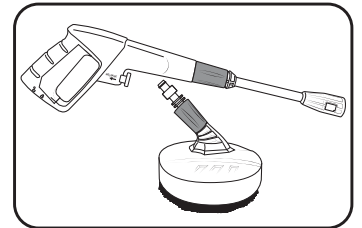

Rotate the sleeve counter clockwise until it tightens up against the accessory it's connected to.

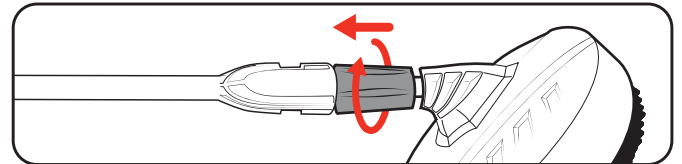

2. To disconnect the accessory, push the accessory towards the spray gun, twist the accessory counter clockwise and pull it.

3. Push the end of the pressure hose into the inlet port on the spray gun until it clicks into place.

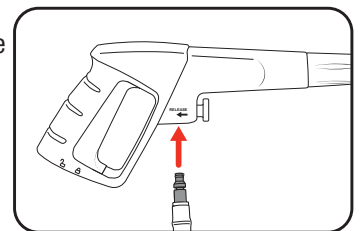

4. Tug gently on the pressure hose to check that it is inserted correctly.



WARNING! PRESSURISED WATER. SHUT OFF WATER SUPPLY, TURN OFF UNIT AND SQUEEZE THE SPRAY GUN TRIGGER TO RELIEVE THE PRESSURE BEFORE DISCONNECTING THE HIGH PRESSURE HOSE.

5. To disconnect the spray gun, press and hold down the quick release tab and pull out the pressure hose.

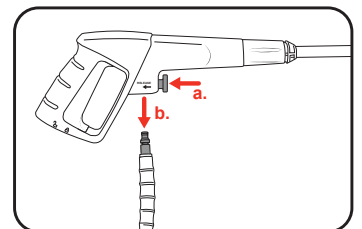

OPERATION

3. CONTROLS

WARNING! NEVER RUN BLEACH OR DETERGENTS NOT DESIGNED FOR PRESSURE WASHERS IN THE UNIT TO PREVENT DAMAGING THE PUMP.

Using The Foam Bottle

Pour detergent directly into the foam bottle and attach it to the lance. Follow the detergent manufacturers' directions for use.

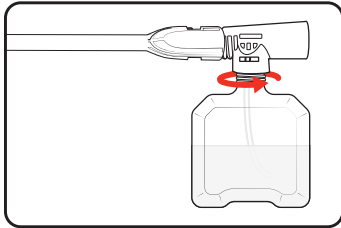

Adjusting The Spray Jet

The water jet output can be controlled when using the adjustable turbo lance.

1. Turn the nozzle clockwise for a wide, fan jet to clean larger areas faster.

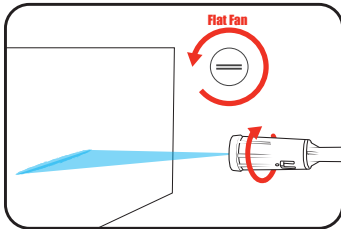

2. Turn the nozzle anti-clockwise for a narrow jet over a small area for concentrated cleaning.

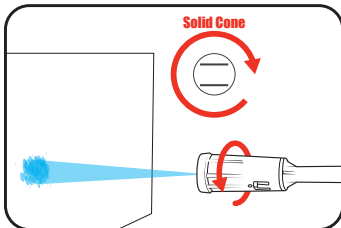

WARNING! THE POWER SUPPLY FOR THIS PRODUCT MUST BE PROTECTED BY A RESIDUAL CURRENT DEVICE (RATED AT 30mA OR LESS).

The high pressure washer is designed to force water at high pressure via a pump through a concentrating nozzle.

It is intended for washing dirt, mud and dust from cars, garden equipment, outdoor furniture, clean grime from barbecue hot plates and grills, wash down driveways, patios, decks and brick walls.

Starting & Stopping The Unit

1. Rotate the on/off dial to the 'ON I' position to turn the unit on.

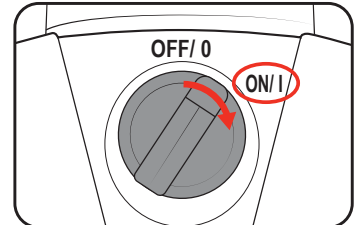

2. Unlock the spray gun by pressing the back end of the trigger lock.

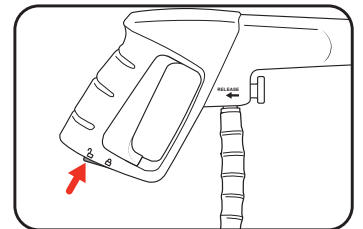

2. Squeeze the spray gun trigger to start spraying.

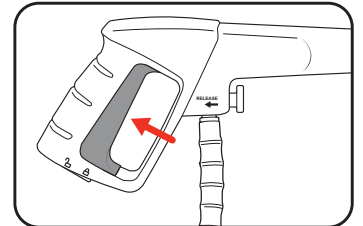

3. Release the trigger to stop spraying.

WARNING! LOCK THE SPRAY GUN TRIGGER WHEN NOT IN USE TO PREVENT ACCIDENTAL STARTING.

4. Rotate the dial to the 'OFF 0' position to switch the unit off.

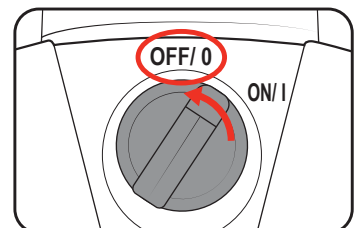

WARNING! DO NOT LEAVE THE UNIT IDLING IN THE 'ON' POSITION FOR MORE THAN 5 MINUTES WITHOUT ACTIVATING THE SPRAY GUN. DOING SO MAY DAMAGE THE PUMP IN THE UNIT.

Overload Protection

The tool is equipped with an overload protection feature. If an overload occurs, the tool will automatically shut off to protect the tool.

1. In the event of an overload turn the on/off dial to the 'OFF 0' position, allow the tool to cool down and remove the power plug from the mains socket.

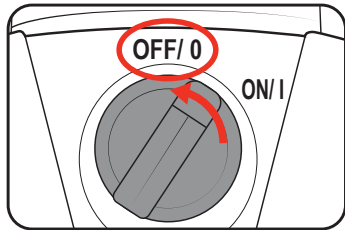

2. Shut off the water supply completely and squeeze the spray gun trigger several times to release any built up pressure and water in the system, then disconnect the garden hose from the water inlet port.

3. Unscrew the hose adaptor from the water inlet port and inspect the mesh filter for any blockages.

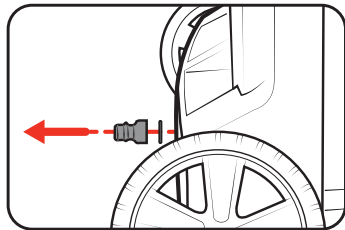

4. Clean the filter as necessary and reinstall it when done.

5. Once the unit has cooled sufficiently, restart the unit and use as normal.

WARNING! DO NOT CONTINUE USING THE UNIT IF THE OVERLOAD SWITCH TRIPS AGAIN IMMEDIATELY AFTER THE RESET.

WARNING! WHEN INSPECTING EQUIPMENT FOR FAULTS, ENSURE THE UNIT IS SWITCHED OFF AND THE POWER CABLE IS DISCONNECTED BEFORE CARRYING OUT INSPECTION.

Shutting Down The Pressure Washer

WARNING! PRESSURISED WATER. SHUT OFF WATER SUPPLY, TURN OFF UNIT AND SQUEEZE THE SPRAY GUN TRIGGER TO RELIEVE THE PRESSURE BEFORE DISCONNECTING THE HIGH PRESSURE HOSE.

1. Twist the on/off dial to the off position and disconnect the power plug.
2. Shut off the water supply completely and squeeze the spray gun trigger several times to release any built up pressure and water in the system.

4. USAGE

WARNING! DO NOT POINT THE SPRAY JET AT ANY PART OF YOUR BODY, OTHER PEOPLE, PETS OR ANIMALS. THE PRESSURISED WATER STREAM CAN CAUSE SERIOUS CUTS AND INJURIES.

WARNING! ALWAYS WEAR SAFETY BOOTS, SAFETY GLOVES, SAFETY HELMET WITH VISOR AND HEARING PROTECTION WHILE OPERATING THE EQUIPMENT.

WARNING! ENSURE THAT THE SPRAY JET IS NOT DIRECTED AT POWER LINES, ELECTRICAL OUTLETS OR ELECTRONICS.

WARNING! HIGH PRESSURE HOSES, FITTINGS & COUPLINGS ARE IMPORTANT FOR THE SAFETY OF THE USER. USE ONLY HOSES, FITTING & COUPLINGS SUPPLIED.

Quick Start Procedure

1. With the adjustable spray nozzle attached, adjust it to the widest spray setting.

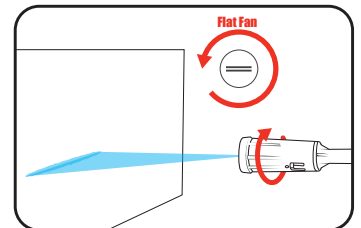

2. Attach the garden hose to the water inlet port and turn on the water at the tap.

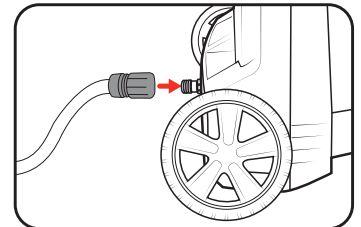

3. Squeeze the spray gun trigger to prime the pump and purge any air from the system.

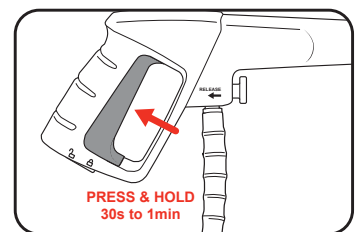

4. Plug the power cord into mains power.

5. Turn the unit on using the on/off dial to start washing.

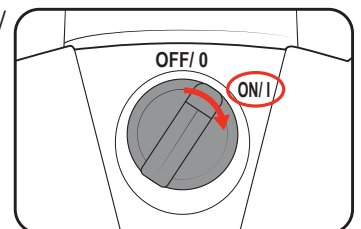

WARNING! ENSURE THE PRESSURE WASHER IS PLACED ON A FLAT, HARD SURFACE. ALWAYS HAVE THE PRESSURE WASHER IN AN UPRIGHT POSITION DURING USE.

WARNING! ALWAYS TEST THE SPRAY JET ON A SMALL INCONSPICUOUS AREA TO ENSURE THE SETTINGS WON'T CAUSE ANY DAMAGE TO THE SPRAYED SURFACE.

WARNING! DO NOT USE PRESSURE WASHERS WHILE WORKING ON LADDERS. THE RECOIL FROM OPERATING THE SPRAY GUN COULD UNBALANCE YOU AND THROW YOU OFF THE LADDER.

WARNING! DURING USE OF HIGH PRESSURE CLEANERS, AEROSOLS MAY BE FORMED. INHALATION OF AEROSOLS CAN BE HAZARDOUS TO HEALTH.

Usage Tips

Pressure washers are designed to remove dirt and grime. They are not designed to strip paint or kill mildew from surfaces.

1. Lay tarps around the house perimeter to protect plants from debris and accidental spray.

2. Hold the spray jet at a 45° angle and at a suitable distance to the surface being washed to prevent gouging the surface. Do not hold the spray jet straight on to the surface as this drives dirt in rather than washing it off.

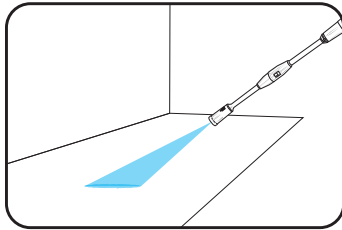

3. Work small areas at a time and use overlapping strokes to prevent streaks.

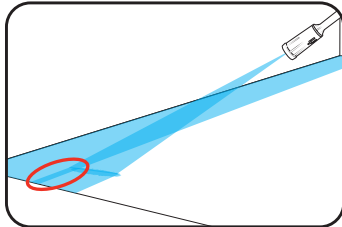

WARNING! WHEN CLEANING WALLS, DO NOT SPRAY WINDOWS AS THE HIGH PRESSURE CAN CRACK THEM.

Washing Your Car

1. With the adjustable spray nozzle attached and on a medium to wide spray setting, loosen and rinse off any dirt.

2. Change to the foam dispenser nozzle and coat your car in a layer of foam. Allow the soap to sit for a few minutes (or as directed by the manufacturer) for it to penetrate any dirt or grime.

Note: Keep the car surface wet to prevent any discolouration or damage from the detergent.

3. Swap back to the adjustable spray nozzle and rinse down your car on the wide spray setting.

5. TROUBLESHOOTING

Symptom	Possible Cause	Suggested Solution
Fluctuating pressure	The pump is drawing in air	Check that the connections are securely installed. Check the hoses for kinks and punctures
	Insufficient water supply	Increase the water supply at the tap, check for blockages or kinks in the hose and/or swap to a larger diameter hose
The machine stops mid-use	Incorrect mains voltage	Unplug other appliances. Check that the power supply corresponds to the specifications on the datalabel
	Overload protection activated	Allow the machine to cool for 5 minutes. Refer to the Overload Protection section
	Partially blocked water jet	Clean the nozzle with the supplied cleaning needle
Pulsing/inconsistent spray	Air in the inlet hose/pump	Pull and hold the spray gun trigger and allow the machine to run until working pressure resumes
	Inadequate water supply	Increase the water supply at the tap, check for blockages or kinks in the hose and/or swap to a larger diameter hose
	Partially blocked water jet	Clean the nozzle with the supplied cleaning needle
	Kinked water hose	Unwind the water hose fully
No water emitted	Water filter blocked	Clean the inlet filter
	Blocked nozzle	Clean the nozzle with the supplied cleaning needle
	Insufficient water supply	Increase the water supply at the tap, check for blockages or kinks in the hose and/or swap to a larger diameter hose

MAINTENANCE



WARNING! BEFORE CLEANING THE APPLIANCE OR CARRYING OUT ANY MAINTENANCE PROCEDURE, MAKE SURE THAT IT IS DISCONNECTED FROM THE POWER SUPPLY TO PREVENT ACCIDENTAL STARTING.

Cleaning

1. We recommend that you clean the tool immediately after you use it.
2. Keep the tool free of dirt and dust as much as possible. Wipe the equipment with a clean cloth.
3. Do not use cleaning agents or solvents; these may be aggressive to the plastic parts in the appliance.
4. You must disconnect the hose and spraying tools from the pressure washer before cleaning. Do not clean the pressure washer with water.
5. The hose adaptor and mesh inlet filter must be inspected regularly to avoid blockages and restriction in the water supply to the unit.

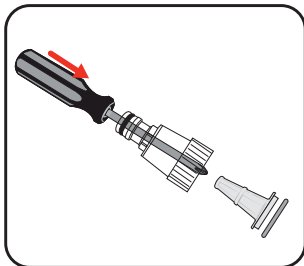

Insert the cleaning needle (supplied) into the adjustable turbo lance outlet and move it back and forth until any debris is dislodged.

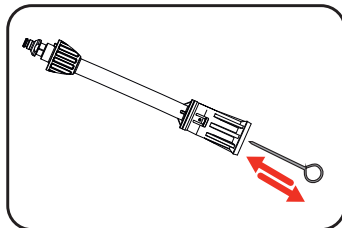
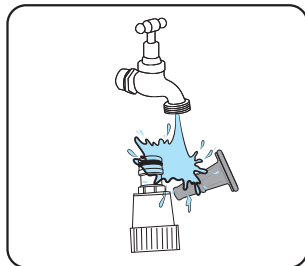

Storage

Pull the mains plug out of the socket, switch off the tool and make sure that it is secured in such a way that it cannot be started up again by any unauthorised person.

The nozzle can be stored on the accessory slots on the back of the unit when not in use. Wind the water hose around the handle hook and the power cord around the cord hook to keep them tidy and out of the way. Empty the detergent bottle before storing the tool in a dry location which is not accessible to unauthorised persons.

Supply Cords

If replacement of the supply cord is necessary, this has to be done by a certified electrician in order to avoid a safety hazard.

Note: Ozito Industries will not be responsible for any damage or injuries caused by the repair of the tool by an unauthorised person or by mishandling of the tool.

DESCRIPTION OF SYMBOLS

V	Volts	Hz	Hertz
~	Alternating Current	W	Watts
L/min	Revolutions or reciprocations per minute	MPa	Megapascals
psi	Pounds per square inch	IPX5	Ingress protection from water
°C	Degrees Celsius	L_{wa}	Sound power level
mm	Millimetres		Warning
	Wear gloves		Wear closed-toe shoes
	Wear face protection		Wear hearing protection
	Double insulated		Regulatory Compliance Mark (RCM)
	Warning! High pressure jets can be dangerous if not used properly. Do not direct the jet at persons, animals, live electrical equipment or the pressure washer itself.		Machine not suitable for connection to the potable water mains
	Read Instruction Manual		

CARING FOR THE ENVIRONMENT



Power tools that are no longer usable should not be disposed of with household waste but in an environmentally friendly way. Please recycle where facilities exist. Check with your local council authority for recycling advice.



Recycling packaging reduces the need for landfill and raw materials. Reuse of recycled material decreases pollution in the environment. Please recycle packaging where facilities exist. Check with your local council authority for recycling advice.

SPARE PARTS

Spare parts can be ordered from the Special Orders Desk at your local Bunnings Warehouse.

For further information, or any parts not listed here, visit www.ozito.com.au or contact Ozito Customer Service:

Australia 1800 069 486

New Zealand 0508 069 486

E-mail: enquiries@ozito.com.au

ELECTRICAL SAFETY



WARNING! When using mains-powered tools, basic safety precautions, including the following, should always be followed to reduce risk of fire, electric shock, personal injury and material damage. Read the whole manual carefully and make sure you know how to switch the tool off in an emergency, before operating the tool.

Save these instructions and other documents supplied with this tool for future reference.

This tool has been designed for 230V and 240V only. Always check that the power supply corresponds to the voltage on the rating plate.

Note: The supply of 230V and 240V on Ozito tools are interchangeable for Australia and New Zealand.



This tool is double insulated; therefore no earth wire is required.

Note: Double insulation does not take the place of normal safety precautions when operating this tool. The insulation system is for added protection against injury resulting from a possible electrical insulation failure within the tool.

Using an Extension Lead

Always use an approved extension lead suitable for the power input of this tool. Before use, inspect the extension lead for signs of damage, wear and ageing. Replace the extension lead if damaged or defective.

When using an extension lead on a reel, always unwind the lead completely. Use of an extension lead not suitable for the power input of the tool or which is damaged or defective may result in a risk of fire and electric shock.

The power supply for this product should be protected by a residual current device (rated at 30mA or less). A residual current device reduces the risk of electric shock.

GENERAL POWER TOOL SAFETY WARNINGS



WARNING! Read all safety warnings, instructions, illustrations and specifications provided with this power tool. Failure to follow all instructions listed below may result in electric shock, fire and/or serious injury.

Save all warnings and instructions for future reference.

The term "power tool" in the warnings refers to your mains-operated (corded) power tool or battery-operated (cordless) power tool.

1) Work area safety

- Keep work area clean and well lit.** Cluttered or dark areas invite accidents.
- Do not operate power tools in explosive atmospheres, such as in the presence of flammable liquids, gases or dust.** Power tools create sparks which may ignite the dust or fumes.
- Keep children and bystanders away while operating a power tool.** Distractions can cause you to lose control.

2) Electrical safety

- Power tool plugs must match the outlet. Never modify the plug in any way. Do not use any adapter plugs with earthed (grounded) power tools.** Unmodified plugs and matching outlets will reduce risk of electric shock.
- Avoid body contact with earthed or grounded surfaces, such as pipes, radiators, ranges and refrigerators.** There is an increased risk of electric shock if your body is earthed or grounded.
- Do not expose power tools to rain or wet conditions.** Water entering a power tool will increase the risk of electric shock.
- Do not abuse the cord. Never use the cord for carrying, pulling or unplugging the power tool. Keep cord away from heat, oil, sharp edges or moving parts.** Damaged or entangled cords increase the risk of electric shock.
- When operating a power tool outdoors, use an extension cord suitable for outdoor use.** Use of a cord suitable for outdoor use reduces the risk of electric shock.

3) Personal safety

- Stay alert, watch what you are doing and use common sense when operating a power tool. Do not use a power tool while you are tired or under the influence of drugs, alcohol or medication.** A moment of inattention while operating power tools may result in serious personal injury.
- Use personal protective equipment. Always wear eye protection.** Protective equipment such as a dust mask, non-skid safety shoes, hard hat or hearing protection used for appropriate conditions will reduce personal injuries.
- Prevent unintentional starting. Ensure the switch is in the off-position before connecting to power source and/or battery pack, picking up or carrying the tool.** Carrying power tools with your finger on the switch or energising power tools that have the switch on invites accidents.
- Remove any adjusting key or wrench before turning the power tool on.** A wrench or a key left attached to a

rotating part of the power tool may result in personal injury.

- Do not overreach. Keep proper footing and balance at all times.** This enables better control of the power tool in unexpected situations.
 - Dress properly. Do not wear loose clothing or jewellery. Keep your hair and clothing away from moving parts.** Loose clothes, jewellery or long hair can be caught in moving parts.
 - If devices are provided for the connection of dust extraction and collection facilities, ensure these are connected and properly used.** Use of dust collection can reduce dust-related hazards.
 - Do not let familiarity gained from frequent use of tools allow you to become complacent and ignore tool safety principles.** A careless action can cause severe injury within a fraction of a second.
- ## 4) Power tool use and care
- Do not force the power tool. Use the correct power tool for your application.** The correct power tool will do the job better and safer at the rate for which it was designed.
 - Do not use the power tool if the switch does not turn it on and off.** Any power tool that cannot be controlled with the switch is dangerous and must be repaired.
 - Disconnect the plug from the power source and/or remove the battery pack, if detachable, from the power tool before making any adjustments, changing accessories, or storing power tools.** Such preventive safety measures reduce the risk of starting the power tool accidentally.
 - Store idle power tools out of the reach of children and do not allow persons unfamiliar with the power tool or these instructions to operate the power tool.** Power tools are dangerous in the hands of untrained users.
 - Maintain power tools and accessories. Check for misalignment or binding of moving parts, breakage of parts and any other condition that may affect the power tool's operation. If damaged, have the power tool repaired before use.** Many accidents are caused by poorly maintained power tools.
 - Keep cutting tools sharp and clean.** Properly maintained cutting tools with sharp cutting edges are less likely to bind and are easier to control.
 - Use the power tool, accessories and tool bits etc. in accordance with these instructions, taking into account the working conditions and the work to be performed.** Use of the power tool for operations different from those intended could result in a hazardous situation.
 - Keep handles and grasping surfaces dry, clean and free from oil and grease.** Slippery handles and grasping surfaces do not allow for safe handling and control of the tool in unexpected situations.
- ## 5) Service
- Have your power tool serviced by a qualified repair person using only identical replacement parts. This will ensure that the safety of the power tool is maintained.

PRESSURE WASHER SAFETY WARNINGS



The appliance is not to be used by persons (including children) with reduced physical, sensory or mental capabilities, or lack of experience and knowledge, unless they have been given supervision or instruction.

Young children should be supervised to ensure that they do not play with the appliance.

WARNING! Before connecting a tool to a power source (mains switch power point receptacle, outlet, etc.) be sure that the voltage supply is the same as that specified on the nameplate of the tool. A power source with a voltage greater than that specified for the tool can result in serious injury to the user, as well as damage to the tool. If in doubt, do not plug in the tool. Using a power source with a voltage less than the nameplate rating is harmful to the motor.

- Unsafe operation of your high pressure cleaner could lead to serious injury or death to you or others.
- The spray gun/wand is a powerful cleaning tool that could look like a toy to a child.
- Improper control of gun/wand can result in injuries to self, others and property damage. Reactive force from the spray can result in gun/lance movement, potentially causing the operator to slip, fall or misdirect the spray.
- Become familiar with the operation and controls of the pressure cleaner.
- Keep children away from the pressure cleaner at all times.
- Never modify or remove the safety features of this product.
- Do not operate the machine with missing, broken or unauthorized parts.
- Never leave wand unattended while unit is running.
- Keep work area free of obstacles.
- Stand on stable surface and grip gun/lance firmly. Expect the gun to kick back when engaged.
- Do not use to pump flammable or explosive liquids such as gasoline, fuel oil, kerosene, solvents or thinners. Pump should only be used with liquids compatible with pressure washer component materials. Failure to follow this warning can result in serious personal injury, death and/or property damage.
- Only use cleaning agents designed for pressure washers. The use of other cleaning agents or chemicals may adversely affect the safety and/or operation of the appliance.
- Do not use the appliance within range of persons unless they wear protective clothing.
- High pressure jets can be dangerous if subject to misuse. The jet must not be directed at persons, animals, live electrical equipment or the appliance itself.

- Do not direct the jet against yourself or others in order to clean clothes or foot-wear.
- To ensure appliance safety, use only original spare parts from the manufacturer or approved by the manufacturer.
- High pressure hoses, fittings and couplings are important for the safety of the appliance. Use only hoses, fittings and couplings recommended by the manufacturer.
- Do not use the appliance if a supply cord or important parts of the appliance are damaged, e.g. safety devices, high pressure hoses, trigger gun.
- Water that has flowed through a backflow preventer is considered to be non-potable.
- Depending on the application, shielded nozzle can be used for high pressure cleaning, which will reduce the emission of hydrous aerosols dramatically. However, not all applications allow the use of such a device. If shielded nozzles are not applicable for the protection against aerosols, a respiratory mask of class FFP 2 or equivalent may be needed, depending on the cleaning environment.
- The electric supply connection shall be made by a qualified electrician and comply with IEC60364-1.
- It is recommended that the electric supply to this machine should include either a residual current device that will interrupt the supply if the leakage current to earth exceeds 30mA for 30ms or a device that will prove the earth circuit.
- Never touch the mains plug or power outlet with wet hands.
- Always disconnect the product from the power outlet when leaving the machine unattended.
- This product must not be connected to the potable water mains without backflow prevention. Check local and national plumbing regulations before connecting the machine to the potable water mains.
- Do not operate the machine at temperatures below 0°C.
- If an extension cord is used, it shall be suitable for outdoor use, and the connection has to be kept dry and off the ground. It is recommended that this is accomplished by means of a cord reel which keeps the socket at least 60 mm above the ground.
- It is recommended that a reinforced garden hose (with minimum diameter of 12mm) is used for the inlet connection.
- During use of high pressure cleaners, aerosols may be formed. Inhalation of aerosols can be hazardous to health.
- Avoid using power tools and machines for long periods of time without breaks. Vibration from tools and machines can be transmitted into your hands and arms.