



36V BRUSHLESS 2X18V

# BLOWER VAC

## INSTRUCTION MANUAL

### SPECIFICATIONS

Input:	2 x 18V
No Load Speed:	8,000-15,000/min
Max. Air Speed:	240km/h
Max. Suction Volume:	740m <sup>3</sup> /h
Max. Blowing Volume:	230m <sup>3</sup> /h
Mulching Ratio:	10:1
Collection Bag:	45 litres
Noise Rating:	102dB
Weight:	3.9kg

ozito.com.au

**5 YEAR**  
REPLACEMENT WARRANTY

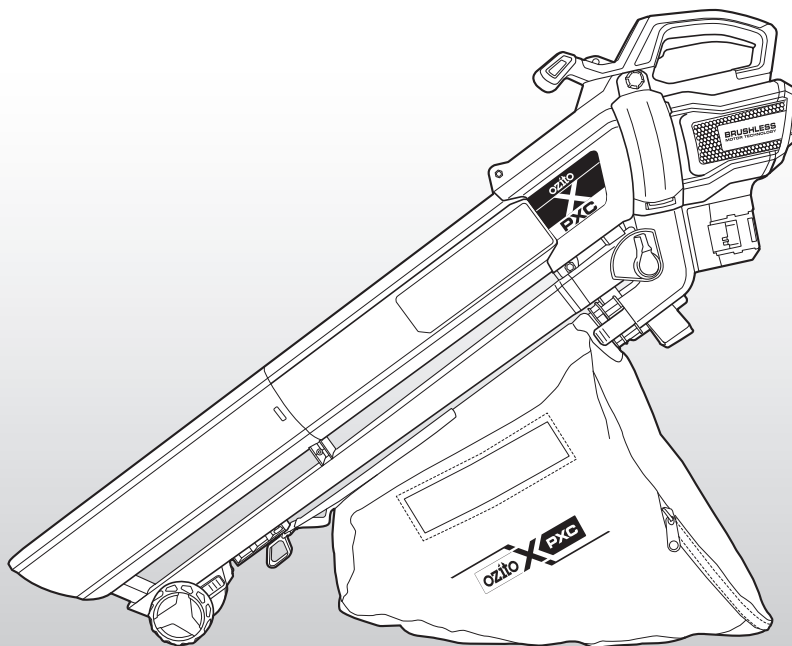

### STANDARD EQUIPMENT



Motor Housing

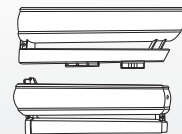

Tubes

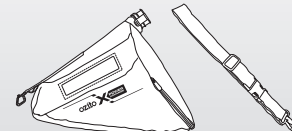

Collection Bag, Shoulder Strap



Guide Wheels, Wall Support Bracket

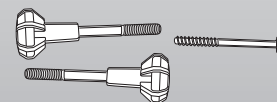

Assembly Fasteners x 3

**PXBVS-3624**

## WARRANTY

IN ORDER TO MAKE A CLAIM UNDER THIS WARRANTY YOU MUST RETURN THE PRODUCT TO YOUR NEAREST BUNNINGS WAREHOUSE WITH YOUR BUNNINGS REGISTER RECEIPT. PRIOR TO RETURNING YOUR PRODUCT FOR WARRANTY PLEASE TELEPHONE OUR CUSTOMER SERVICE HELPLINE:

**Australia 1800 069 486**

**New Zealand 0508 069 486**

TO ENSURE A SPEEDY RESPONSE PLEASE HAVE THE MODEL NUMBER AND DATE OF PURCHASE AVAILABLE. A CUSTOMER SERVICE REPRESENTATIVE WILL TAKE YOUR CALL AND ANSWER ANY QUESTIONS YOU MAY HAVE RELATING TO THE WARRANTY POLICY OR PROCEDURE.

### WARNING

The following actions will result in the warranty being void.

- If the tool has been operated on a supply voltage other than that specified on the tool.
- If the tool shows signs of damage or defects caused by or resulting from abuse, accidents or alterations.
- Failure to perform maintenance as set out within the instruction manual.
- If the tool is disassembled or tampered with in any way.
- Professional, industrial or high frequency use.

The benefits provided under this warranty are in addition to other rights and remedies which are available to you at law.

Our goods come with guarantees that cannot be excluded at law. You are entitled to a replacement or refund for a major failure and for compensation for any other reasonably foreseeable loss or damage. You are also entitled to have the goods repaired or replaced if the goods fail to be of acceptable quality and the failure does not amount to a major failure.

Generally you will be responsible for all costs associated with a claim under this warranty, however, where you have suffered any additional direct loss as a result of a defective product you may be able to claim such expenses by contacting our customer service helpline above.

### 5 YEAR REPLACEMENT WARRANTY

Your Product is guaranteed for a period of 60 months from the original date of purchase and is intended for DIY (Do It Yourself) use only. If a product is defective it will be replaced in accordance with the terms of this warranty. **Lithium Ion batteries and chargers are covered by a 36 month warranty** and are excluded from the warranty extension. Warranty excludes consumable parts.

# KNOW YOUR PRODUCT

## BRUSHLESS BLOWER VAC

- |                  |                          |
|------------------|--------------------------|
| 1. Guide Wheels  | 8. On/Off Trigger        |
| 2. Lower Tubes   | 9. Sure Grip Handle      |
| 3. Upper Tubes   | 10. Battery Seating x 2  |
| 4. Bag Connector | 11. Impeller Cover       |
| 5. Mode Selector | 12. Wall Support Bracket |
| 6. Front Handle  | 13. Collection Bag       |
| 7. Speed Control |                          |

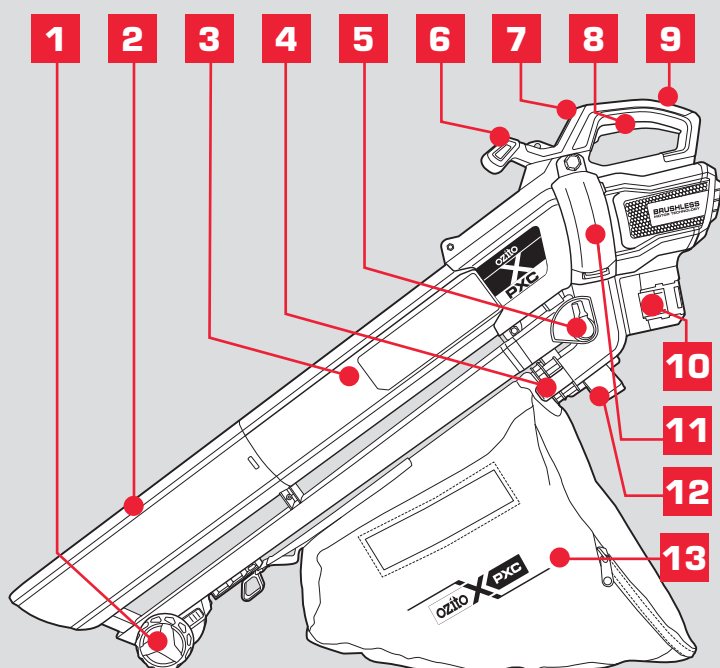

## ACCESSORIES

- |                      |                   |
|----------------------|-------------------|
| 14. Shoulder Strap   | 16. One-way Screw |
| 15. Thumb Screws x 2 |                   |

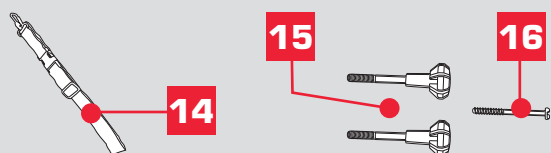

## BATTERY & CHARGER

This tool is compatible with all battery and chargers from the Ozito PXC Range.

### ONLINE MANUAL

Scan this QR Code with your mobile device to take you to the online manual.

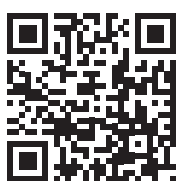

**5 YEAR**  
REPLACEMENT WARRANTY

# SETUP & PREPARATION

## 1. ASSEMBLY

**WARNING!** ENSURE THE BLOWER VAC IS SWITCHED OFF AND THE BATTERY IS REMOVED BEFORE PERFORMING ANY OF THE FOLLOWING TASKS.

### Assembling the Tubes

1. Connect the lower tube onto the upper tube. Ensure the two halves latch together fully and the guide lugs (a) sits correctly in the recess.
2. Secure the tubes together with the one-way assembly screw using a flat tip screwdriver (not included).

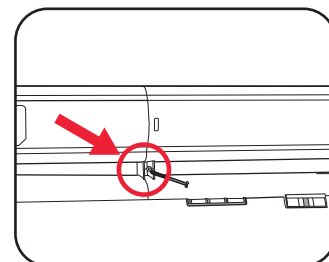
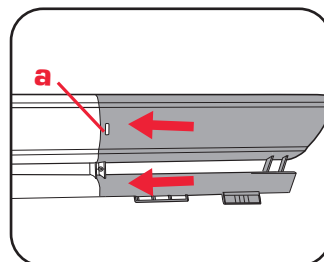

**WARNING!** NEVER OPERATE WITHOUT THE LOWER TUBES FITTED TO THE UPPER TUBES OTHERWISE RISK OF INJURY.

3. Feed the assembled suction tubes into the motor housing. Push together until they are connected firmly.

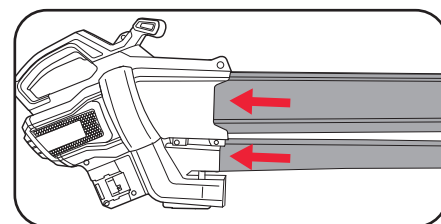

4. Using the two thumb screws secure the suction tubes to the motor housing.

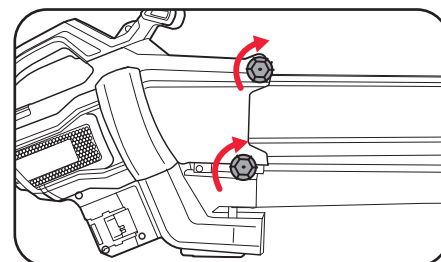

**Note:** Integrated safety switches prevent the motor from operation unless the suction tubes are fully assembled and secured to the motor housing. If the tubes are not fitted and secured against the motor housing, the safety switch will trip and prevent the motor from working.

**WARNING!** DO NOT USE ANY ATTACHMENTS OR ACCESSORIES NOT RECOMMENDED BY THE MANUFACTURER OF THIS PRODUCT, AS IT CAN RESULT IN SERIOUS PERSONAL INJURY.

## Assembling the Guide Wheels

Squeeze the release levers (a) simultaneously on both side as you slide the guide wheels into position on the lower tubes. Three fixed locking positions (b) are possible for setting the desired working position.

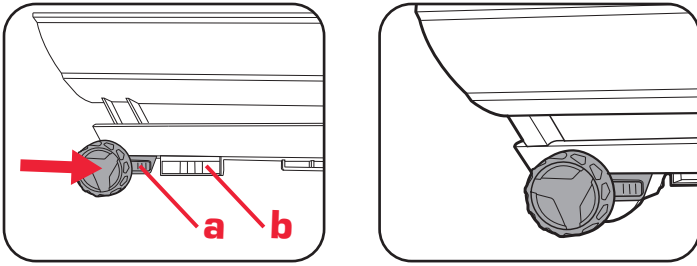

## Fitting the Wall Bracket

Slide the wall bracket onto the motor housing as far as it will go. Make sure that the V-shaped cut-out faces the tubes.

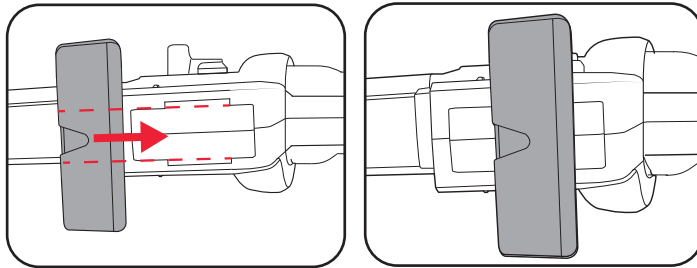

## Attaching and Removing the Collection Bag

1. Attach the plastic connector on the collection bag to the outlet in the motor housing. Ensure that it latches in place correctly.
2. Attach the collection bag to the closest hole on the suction tube.

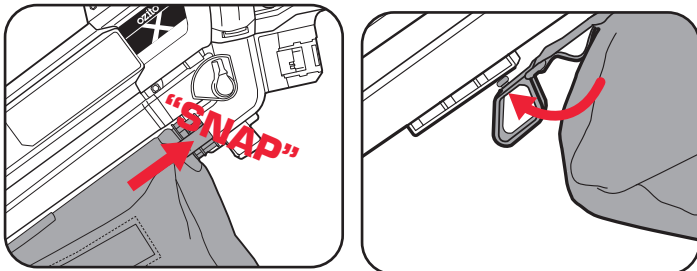

3. To remove the collection bag, first unhook it from the suction tube, then press the release levers (b) simultaneously on both sides and pull off the plastic connector away from the motor housing.

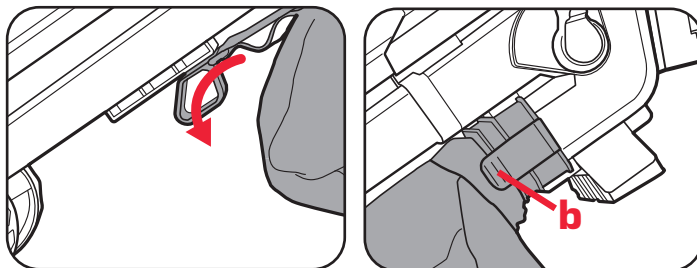

## 2. CONTROLS

### On/Off Trigger

**WARNING!** DO NOT SWITCH ON IN ENCLOSED OR POORLY VENTILATED SPACES OR IN THE PRESENCE OF FLAMMABLE AND/OR EXPLOSIVE LIQUIDS, GASES AND POWDERS.

1. Squeeze the on/off trigger to start. Motor will start after a short delay.
2. To stop operation, release the on/off trigger.

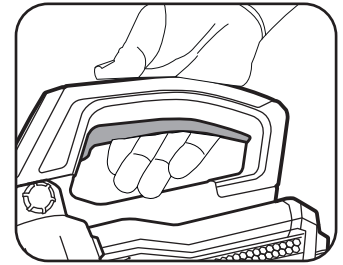
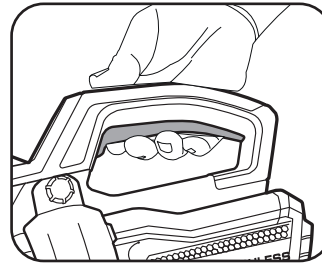

### Speed Control

- You can increase the air velocity by pressing the SPEED button. Each bar on the display will illuminate according to the air velocity selected. Up to 4 bars can be selected for the highest air velocity.

**Note:** If you press the SPEED button again when the highest air velocity is active, the equipment will return to the lowest air velocity.

**Note:** To minimize noise and prolong battery operating time, always use the speed which is actually required and never run at a speed which is faster than necessary.

- If you need a higher air velocity for a short time, you can press the TURBO\* button. Pressing the TURBO\* button will increase the air velocity providing the maximum velocity. All the bars will illuminate in the display.

\*For best performance use with 2.5Ah batteries and above.

**Note:** To minimize noise and prolong battery operating time, never actuate the turbo button any longer than necessary.

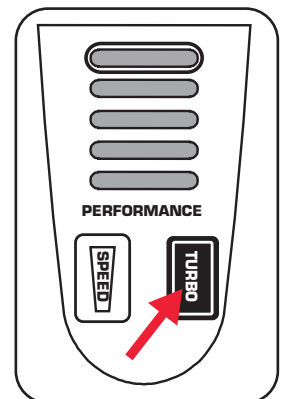
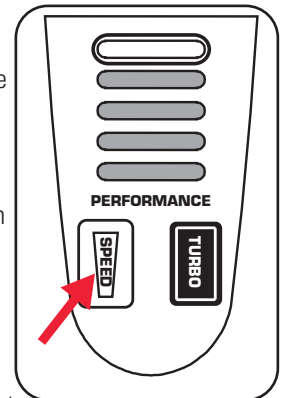

## Mode Selection

1. To select the **Blower** function turn the lever right to the blower icon.

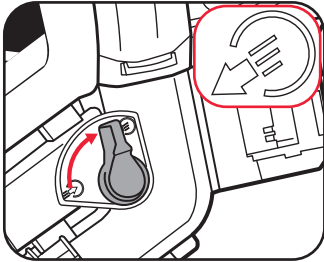

2. To select the **Vacuum/Mulching** function move the lever left to the vacuuming icon.

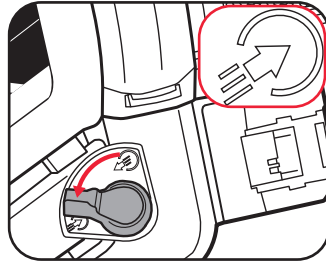

## Run Time

The operating time of the PXC battery (the area that can be covered with a single battery charge) is largely dependent on the speed selected, operating mode, battery charge and the rate of work (walking speed).

Frequently turning the equipment on and off will also reduce the amount of area that you can cover. If the operating time of the PXC battery (area coverage) is still unsatisfactory in spite of the above measures, you can remedy the problem by using PXC battery with a larger capacity (Ah).

## 3. PREPARATION

### Installing and Removing the Batteries

Only use 2 batteries with the same capacity (Ah). Always use 2 batteries which are charged to the same level. Never combine full and half-full batteries as the equipment's operating time depends on the battery with the lower charge level.

1. Align the ribs of a fully charged battery with the recess at the base of the motor housing.

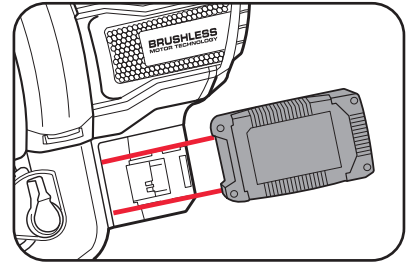

2. Slide the battery in so that it clicks into place.

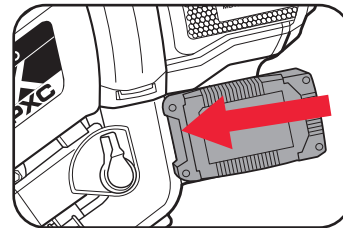

3. To remove, press and hold the battery release tab on the top of the battery, then slide the battery out.

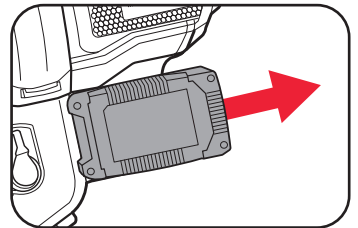

**WARNING!** ALWAYS ENSURE THE BATTERIES ARE REMOVED WHEN NOT IN USE.

### Shoulder Strap

Hook the carabiner to the motor housing.

To use the shoulder strap simply slip the shoulder strap over your shoulder and adjust the length of the strap so that you can handle the equipment comfortably. Wear in such a way that the buckle is always close to hand. In an emergency you can quickly unclip by pressing either side of the buckle.

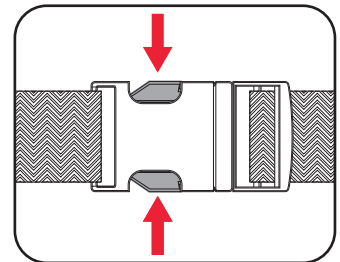
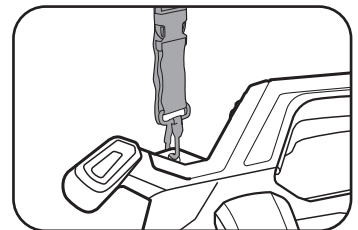

# OPERATION

## 4. USING THE BLOWER VAC

**WARNING!** ALWAYS WEAR APPROPRIATE PERSONAL PROTECTIVE EQUIPMENT (PPE) WHEN USING THE BLOWER VAC, SUCH AS STURDY, NON-SLIP FOOTWEAR, LONG TROUSERS, SAFETY GLASSES, DUST MASK AND HEARING PROTECTION. NEVER USE THE EQUIPMENT BAREFOOT OR IN SANDALS.

### Proper Use

The Blower Vac is designed to be used for clearing, gathering and vacuuming dry to slightly damp leaves and grass from paved areas and lawns. The equipment is intended for private use i.e. for use in home and gardening environments.

**Note:** Be aware of other people and animals in the area where you are to be operating the blower vac.

**Note:** Avoid collisions with hard objects which could damage your machine.

**WARNING!** DO NOT OPERATE THE MACHINE WITH LONG LOOSE HAIR, LOOSE CLOTHING OR LOOSE FITTING JEWELLERY. TIE LONG LOOSE HAIR BACK AND REMOVE LOOSE FITTING JEWELLERY.

### Blowing

Hold the blower vac firmly with both hands, squeeze the on/off trigger, point the jet of air in front of you and move forward slowly to blow foliage or garden refuse into a pile or to clear out hard-to-reach places. Move the blower vac from side to side, with the nozzle several inches above the ground.

Be careful where you point the jet of air as it can move heavy material and cause injury or damage to bystanders.

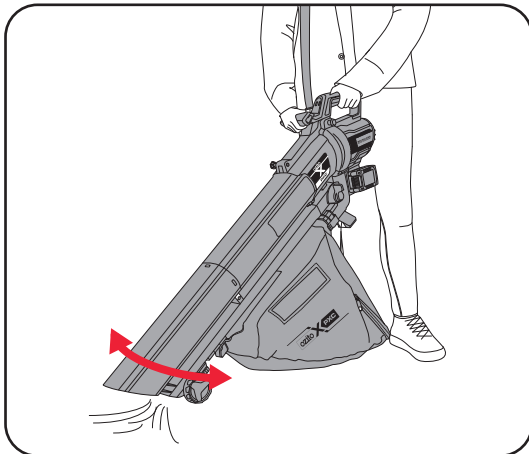

**WARNING!** NEVER GATHER (BLOW) HOT, COMBUSTIBLE OR EXPLOSIVE MATERIALS INTO PILES.

### Vacuum-Mulching

Hold the blower vac firmly with both hands, squeeze the on/off trigger, point the vacuum tubes in front of you and move the machine forward, then backward, slowly resting the guide wheels on the ground as you vacuum leaves, grass clippings and other garden debris while shredding and reducing the volume collected for composting if desired.

The guide rollers at the bottom end of the suction tube will help you to manoeuvre the suction tube on the ground.

**WARNING!** DO NOT ATTEMPT TO VACUUM STONES, GLASS OR OTHER SOLID OBJECTS, DOING SO COULD CAUSE MAJOR DAMAGE TO THE IMPELLOR AND COLLECTION BAG.

**WARNING!** ALWAYS ENSURE THE COLLECTION BAG IS CORRECTLY ATTACHED AND BE AWARE OF WHAT IS BEING DRAWN UP INTO THE BLOWER VAC TUBE.

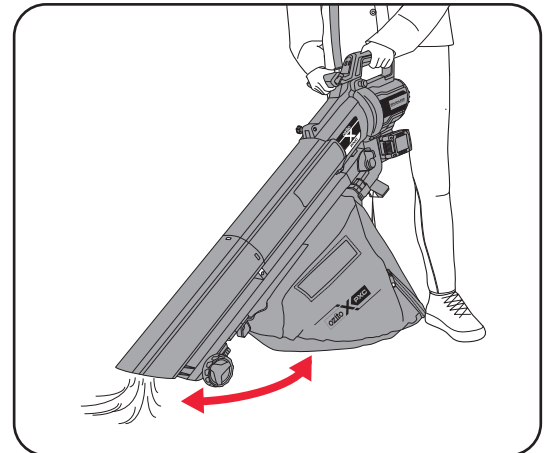

- Only use the blower vac in vacuum mode if the collection bag is undamaged and properly fitted.
- Do not pick up too many leaves in one go as this could clog the tube and the mulching blade.
- To clear any blockages, follow the steps described in the maintenance section "Clearing Debris".
- Always position the suction tube on the ground and adjust the length of the strap to your requirements. The guide rollers at the bottom end of the suction tube will help you to manoeuvre the suction tube on the ground.
- Do not vacuum hard or wet materials.



# MAINTENANCE

**WARNING!** BEFORE CLEANING YOUR BLOWER VAC OR CARRYING OUT ANY MAINTENANCE PROCEDURE, MAKE SURE THE BATTERIES ARE REMOVED TO PREVENT ACCIDENTAL STARTING.

## Emptying the Collection Bag

For best results when vacuuming it is recommended to empty the collection bag after it becomes half full.

**Note:** The suction power drops when the collection bag is almost full.

Always empty the collection bag after you have finished your job. Organic waste should be composted.

**WARNING!** ENSURE THE MACHINE IS OFF & THE BATTERY IS REMOVED. WAIT UNTIL THE IMPELLOR HAS STOPPED BEFORE ATTEMPTING TO EMPTY OR REMOVE THE COLLECTION BAG.

1. Open the zip at the rear of the bag and shake out the collected material.
2. Be sure to close the zip prior to operating the blower vac.

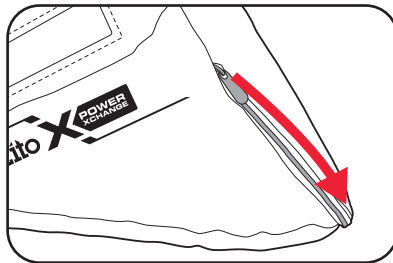

## Clearing Debris

Wear protective gloves.

There is an access point on the left side of the blower vac to allow debris to be cleared easily from the impeller.

1. Unscrew the locking knob to allow the impeller cover to pivot open.
2. Remove any debris from the impeller.
3. Ensure the locking knob is fully tightened after cleaning, or the Blower Vac will not start.

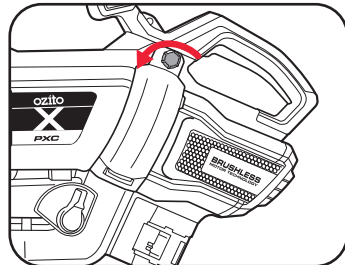

Additional, remove any debris or build up within the suction/blower tubes and the collection bag inlet, and the outlet in the motor housing.

1. Un-fasten the clip on the collection bag from the hook underneath the upper tube.
2. Simultaneously squeeze the two release levers (b) on the plastic connector and pull the collection bag away from the motor housing.

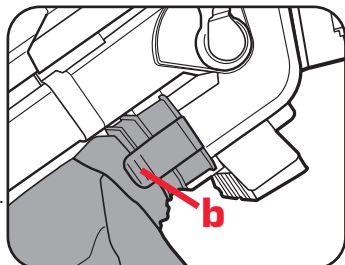

3. Remove the thumb screws holding the tube assembly to the housing before pulling the assembled tubes from the motor housing.

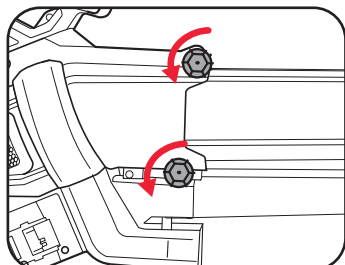

4. Remove any debris or build up within the suction/ blower tubes the collection bag inlet, outlet and inlet in the motor housing.

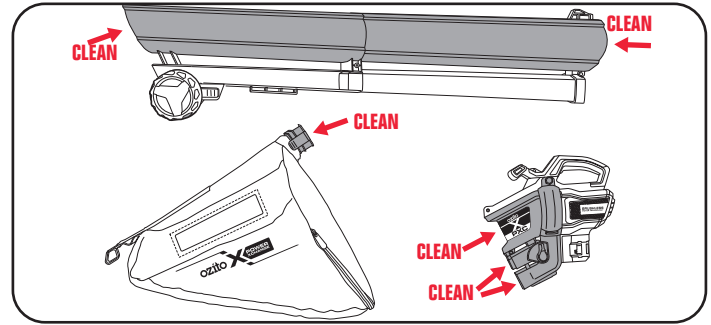

- We recommend that you clean the device immediately each time you have finished using it.
- Keep air intake clean and air vents free from debris to ensure efficient operation.
- If the housing of the machine requires cleaning, do not use solvents. Use of a soft cloth and brush only is recommended. Water must never come into contact with the blower vac.
- After each use, blow it with compressed air at low pressure through the machine housing to ensure it is free from all dust, dirt, etc. Build up of dust or dirt particles may cause the machine to overheat and shorten the life of the machine.
- Never allow any liquid to get inside the machine, never immerse any part of the machine into liquid or clean the blower vac with running water, particularly with high-pressure water.
- After shaking out the collection bag, turn it inside out and thoroughly clean it in order to prevent mold and unpleasant odours from forming.
- You can use soap and water to clean out a heavily soiled collection bag.
- Rub a bar of dry soap across the zipper teeth if the zipper becomes difficult to pull.
- Dirt from the vacuumed material can make it more difficult to move the mode selector lever (blower/vacuum). To restore smooth operation of the selector lever, simply flip the lever back and forth several times from vacuum to blower.
- There are no user serviceable parts in the blower vac; if a fault is suspected, return the blower vac to a power tool repairer.
- If the blower vac vibrates abnormally, stop motor immediately. Abnormal vibration usually indicates a mechanical problem continued operation could lead to injury or damage.
- No lubrication is necessary as the motor is equipped with lifetime-lubrication bearings.

## Storage

- When not in use, the blower vac should be stored in a dry, frost free location not within the reach of children.
- Store the equipment and its accessories in a dark and dry place at above freezing temperature. The ideal storage temperature is between 5 and 30°C.
- Remove the batteries from the blower vac when in storage.
- Allow the motor to cool before you put the equipment in an enclosed area.
- The V-shaped cut-out on the wall bracket allows the machine to hang from a screw in the wall. The wall bracket also supports the blower vac when placed on the ground.

**WARNING!** STORE THE BLOWER VAC IN A SAFE AND DRY PLACE OUT OF THE REACH OF CHILDREN.

**Note:** Ozito Industries will not be responsible for any damage or injuries caused by the repair of the blower vac by an unauthorised person or by mishandling of the blower vac. This machine is designed for DIY use - use in commercial or industrial environments will void the warranty.

# TROUBLESHOOTING

Problem	Cause	Remedy
Poor suction	Collection bag full	Empty the collection bag
	Clogged air tubes	Remove any debris or built up within the upper and lower tubes. Refer to <b>Cleaning Debris</b>
	Clogged collection bag connector	Remove the collection bag, remove build up of debris from connector & outlet in the housing. Refer to <b>Cleaning Debris</b>
Blower vac is not starting	Blower vac air tubes not secured on the motor housing	A micro switch prevents the blower vac from operating if both blower air tubes are not secured with the assembly screws provided
	Impeller access cover not secured on the motor housing	A micro switch prevents the blower vac from operating if the impeller cover locking knob is not fully tightened after cleaning
	Battery is low in charge	Charge batteries
	Battery not inserted properly	Insert battery correctly
Blower vac is not operating at full capacity	Speed set low	Inspect speed controller and increase as necessary
Motor stops while in operation	Battery has no power	Charge batteries

# SPARE PARTS

Spare parts can be ordered from the **Special Orders Desk** at your local **Bunnings Warehouse**.









For further information, or any parts not listed here, visit [www.ozito.com.au](http://www.ozito.com.au) or contact **Ozito Customer Service**:

**Australia 1800 069 486**

**New Zealand 0508 069 486**

**E-mail: [enquiries@ozito.com.au](mailto:enquiries@ozito.com.au)**

# DESCRIPTION OF SYMBOLS

<b>V</b>	Volts	<b>Hz</b>	Hertz
<b>a.c./~</b>	Alternating Current	<b>W</b>	Watts
<b>/min</b>	Revolutions or reciprocations per minute	<b>n<sub>0</sub></b>	No load speed
<b>dc/---</b>	Direct current	<b>Ø</b>	Diameter
<b>mA</b>	Milliamperes	<b>Ah</b>	Amp hour
<b>m<sup>3</sup>/h</b>	Cubic metres per hour	<b>mm</b>	Millimetres
	Regulatory Compliance Mark (RCM)	<b>km/h</b>	Kilometres per hour
	Wear hearing and eye protection		Warning!
	Read Instruction Manual to reduce the risk of injury		Do not operate in rain or leave the blower vac outdoors while raining
	Sound power level 102dB		Keep Bystanders away. Do not operate whilst people especially children or pets are in the area
	Keep hands and head hair out of the openings while the blower vac is running		

# CARING FOR THE ENVIRONMENT



Power tools and garden machinery that are no longer usable should not be disposed of with household waste but in an environmentally friendly way. Please recycle where facilities exist. Check with your local council authority for recycling advice.



Recycling packaging reduces the need for landfill and raw materials. Reuse of recycled material decreases pollution in the environment. Please recycle packaging where facilities exist. Check with your local council authority for recycling advice.



# ELECTRICAL SAFETY



**WARNING!** When using electric machines, basic safety precautions, including the following, should always be followed to reduce risk of fire, electric shock, personal injury and material damage.

-Read the whole manual carefully and make sure you know how to switch the machine off in an emergency, before operating the machine. Save these instructions and other documents supplied with this machine for future reference.

-This appliance is not intended for use by persons (including children) with reduced physical, sensory or mental capabilities, or lack of experience and knowledge, unless they have been given supervision or instruction concerning use of the appliance by a person responsible for their safety.



# GENERAL MACHINE SAFETY WARNINGS



**WARNING!** Read all safety warnings, instructions, illustrations and specifications provided with this machine. Failure to follow all instructions listed below may result in electric shock, fire and/or serious injury.

Save all warnings and instructions for future reference.

The term "machine" in the warnings refers to your mains-operated (corded) machine or battery-operated (cordless) machine.

## 1) Work area safety

- a) **Keep work area clean and well lit.** Cluttered or dark areas invite accidents.
- b) **Do not operate machines in explosive atmospheres, such as in the presence of flammable liquids, gases or dust.** Machines create sparks which may ignite the dust or fumes.
- c) **Keep children and bystanders away while operating a machine.** Distractions can cause you to lose control.

## 2) Electrical safety

- a) **Machine plugs must match the outlet. Never modify the plug in any way. Do not use any adapter plugs with earthed (grounded) machines.** Unmodified plugs and matching outlets will reduce risk of electric shock.
- b) **Avoid body contact with earthed or grounded surfaces, such as pipes, radiators, ranges and refrigerators.** There is an increased risk of electric shock if your body is earthed or grounded.
- c) **Do not expose machines to rain or wet conditions.** Water entering a machine will increase the risk of electric shock.
- d) **Do not abuse the cord. Never use the cord for carrying, pulling or unplugging the machine. Keep cord away from heat, oil, sharp edges or moving parts.** Damaged or entangled cords increase the risk of electric shock.
- e) **When operating a machine outdoors, use an extension cord suitable for outdoor use.** Use of a cord suitable for outdoor use reduces the risk of electric shock.
- f) **If operating a power tool in a damp location is unavoidable, use a residual current device (RCD) protected supply.** Use of an RCD reduces the risk of electric shock.

## 3) Personal safety

- a) **Stay alert, watch what you are doing and use common sense when operating a machine. Do not use a machine while you are tired or under the influence of drugs, alcohol or medication.** A moment of inattention while operating machines may result in serious personal injury.
- b) **Use personal protective equipment. Always wear eye protection.** Protective equipment such as a dust mask, non-skid safety shoes, hard hat or hearing protection used for appropriate conditions will reduce personal injuries.
- c) **Prevent unintentional starting. Ensure the switch is in the off-position before connecting to power source and/or battery pack, picking up or carrying the machine.** Carrying machines with your finger on the switch or energising machines that have the switch on invites accidents.
- d) **Remove any adjusting key or wrench before turning the machine on.** A wrench or a key left attached to a rotating part of the machine may result in personal injury.
- e) **Do not overreach. Keep proper footing and balance at all times.** This enables better control of the machine in unexpected situations.
- f) **Dress properly. Do not wear loose clothing or jewellery. Keep your hair and clothing away from moving parts.** Loose clothes, jewellery or long hair can be caught in moving parts.
- g) **If devices are provided for the connection of dust extraction and collection facilities, ensure these are connected and properly used.** Use of dust collection can reduce dust-related hazards.
- h) **Do not let familiarity gained from frequent use of machines allow you to become complacent and ignore machine safety principles.** A careless action can cause severe injury within a fraction of a second.

Children should be supervised to ensure that they do not play with the appliance.

-This appliance is compatible and only to be used with all batteries & chargers from the Ozito PXC range. Refer to the PXC battery and charger manuals for information regarding charging, use and storage.

-Remove the batteries from the appliance before being charged.

-Do not combine different types of batteries or new and used batteries.

-If the appliance is to be stored unused for a long period, the batteries should be removed.

-Do not use modified or damaged batteries.

## 4) Machine use and care

- a) **Do not force the machine. Use the correct machine for your application.** The correct machine will do the job better and safer at the rate for which it was designed.
- b) **Do not use the machine if the switch does not turn it on and off.** Any machine that cannot be controlled with the switch is dangerous and must be repaired.
- c) **Disconnect the plug from the power source and/or remove the battery pack, if detachable, from the machine before making any adjustments, changing accessories, or storing machines.** Such preventive safety measures reduce the risk of starting the machine accidentally.
- d) **Store idle machines out of the reach of children and do not allow persons unfamiliar with the machine or these instructions to operate the machine.** Machines are dangerous in the hands of untrained users.
- e) **Maintain machines and accessories. Check for misalignment or binding of moving parts, breakage of parts and any other condition that may affect the machine's operation. If damaged, have the machine repaired before use.** Many accidents are caused by poorly maintained machines.
- f) **Keep cutting machines sharp and clean.** Properly maintained cutting machines with sharp cutting edges are less likely to bind and are easier to control.
- g) **Use the machine, accessories and machine bits etc. in accordance with these instructions, taking into account the working conditions and the work to be performed.** Use of the machine for operations different from those intended could result in a hazardous situation.
- h) **Keep handles and grasping surfaces dry, clean and free from oil and grease.** Slippery handles and grasping surfaces do not allow for safe handling and control of the machine in unexpected situations.

## 5) Battery machine use and care

- a) **Recharge only with the charger specified by the manufacturer.** A charger that is suitable for one type of battery pack may create a risk of fire when used with another battery pack.
  - b) **Use machines only with specifically designated battery packs.** Use of any other battery packs may create a risk of injury and fire.
  - c) **When battery pack is not in use, keep it away from other metal objects, like paper clips, coins, keys, nails, screws or other small metal objects, that can make a connection from one terminal to another.** Shorting the battery terminals together may cause burns or a fire.
  - d) **Under abusive conditions, liquid may be ejected from the battery; avoid contact. If contact accidentally occurs, flush with water. If liquid contacts eyes, additionally seek medical help.** Liquid ejected from the battery may cause irritation or burns.
  - e) **Do not use a battery pack or machine that is damaged or modified.** Damaged or modified batteries may exhibit unpredictable behaviour resulting in fire, explosion or risk of injury.
  - f) **Do not expose a battery pack or machine to fire or excessive temperature.** Exposure to fire or temperature above 130 °C may cause explosion.
  - g) **Follow all charging instructions and do not charge the battery pack or machine outside the temperature range specified in the instructions.** Charging improperly or at temperatures outside the specified range may damage the battery and increase the risk of fire.
- ## 6) Service
- a) **Have your machine serviced by a qualified repair person using only identical replacement parts.** This will ensure that the safety of the machine is maintained.
  - b) **Never service damaged battery packs.** Service of battery packs should only be performed by the manufacturer or authorized service providers.



# BLOWER VAC SAFETY WARNINGS



**WARNING!** This appliance is not intended for use by persons (including children) with reduced physical, sensory or mental capabilities, or lack of experience and knowledge, unless they have been given supervision or instruction concerning use of the appliance by a person responsible for their safety.

**Young children should be supervised to ensure that they do not play with the appliance.**

Always wear adequate protective clothing when operating the blower vac to avoid injuries to face, eyes, hand, feet, head or hearing. Use safety glasses or a face shield, high boots or sturdy shoes, long trousers, work gloves, a hard hat and ear defenders.

Do not start the blower vac when it is upside down or when it is not in the operating position.

Switch the motor off and remove the battery when the blower vac is not being used, left unattended, being cleaned, being moved from one place to another.

Do not operate the blower vac near people, especially children or pets. Turn it off if they get too close.

Maintain a safe distance of at least 5m from other people when using the blower vac.

Slightly dampen surfaces in dusty conditions.

Take wind conditions into account: avoid operating near open doors and windows.

Never direct the blower direction nozzle towards bystanders or pets. Never blow debris in the direction of bystanders or pets.

The operator is responsible for accidents or hazards occurring to other people or their property.

Do not handle the battery or the machine with wet hands and do not use the blower vac in the rain.

Keep all the air intakes and the blower tube free of dust, lint, hair and other material that may cause a reduction in air flow.

Keep a balanced and stable stance while using the blower vac. Do not switch on the machine in enclosed or poorly ventilated spaces or in the presence of inflammable and/or explosive substances such as liquids, gasses and powders.

Do not get distracted and always concentrate on what you are doing. Use common sense. Never operate the blower vac when you are tired, sick or under the influence of alcohol or other drugs.

Do not operate this appliance with long loose hair or loose fitting jewellery. Tie long loose hair back and remove loose fitting jewellery.

Only operate the blower vac during broad daylight or with adequate artificial light.

Only use the blower vac according to the instructions given in this manual.

Check regularly that the screws are tight.

Do not allow the blower vac to pick up any burning or smouldering materials like ashes, cigarette butts etc.

Do not attempt to pick up breakable objects like glass, plastics, china etc.

Do not use in vacuum operation without the collection bag fitted.

Do not use in the rain or leave outdoors while raining.

## 1) Training

- Read the instructions carefully. Be familiar with the controls and the proper use of the appliance.

- Never allow children to use the appliance.
- Never allow people unfamiliar with these instructions to use the appliance. Local regulations may restrict the age of the operator.

- Never operate the appliance while people, especially children, or pets are nearby.
- The operator or user is responsible for accidents or hazards occurring to other people or their property.

## 2) Preparation

- While operating the appliance, always wear substantial footwear and long trousers.
- Do not wear loose clothing or jewellery that can be drawn into the air inlet. Keep long hair away from the air inlets.
- Wear protective goggles while operating.
- To prevent dust irritation the wearing of a face mask is recommended.
- Never operate the appliance with defective guards or shields, or without safety devices, for example collection bag in place.

## 3) Operation

- Disconnect the appliance from the battery
  - whenever you leave the machine;
  - before clearing a blockage;
  - before checking, cleaning or working on the appliance;
  - if the appliance starts to vibrate abnormally.
- Operate the appliance only in daylight or in good artificial light.
- Do not overreach and keep your balance at all times.
- Always be sure of your footing on slopes.
- Walk, never run.
- Keep all cooling air inlets clear of debris.
- Never blow debris in the direction of bystanders.

## 4) Maintenance and storage

- Keep all nuts, bolts and screws tight to be sure the appliance is in safe working condition.
- Check the collection bag frequently for wear or deterioration.
- Replace worn or damaged parts.
- Use only genuine replacement parts and accessories.
- Store the appliance only in a dry place.



**Danger!** Always remove the batteries from the blower vac:

- when the equipment is left unattended,
- when the equipment is being checked, cleaned, or having maintenance work done,
- or if the equipment vibrates abnormally.