



AIR GREASE GUN

410g

INSTRUCTION MANUAL

SPECIFICATIONS

Chamber Capacity:	410g
Chamber Length:	280mm
Operating Pressure:	30-90psi (2.0-6.2Bar)
Average Air Consumption:	113L/min (4cfm)
Grease Outlet Pressure:	900-2700psi (60-190Bar)
Air Inlet:	1/4" BSP
Hose Diameter:	ø9.5mm (3/8")
Weight:	1.45kg

AGG-310

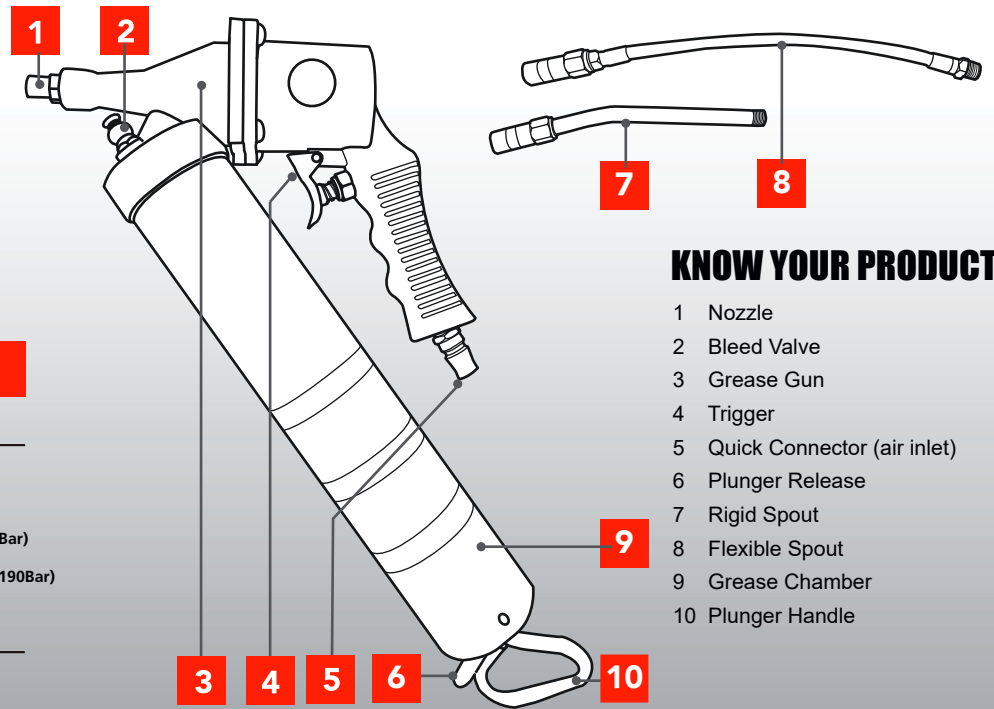

KNOW YOUR PRODUCT

- 1 Nozzle
- 2 Bleed Valve
- 3 Grease Gun
- 4 Trigger
- 5 Quick Connector (air inlet)
- 6 Plunger Release
- 7 Rigid Spout
- 8 Flexible Spout
- 9 Grease Chamber
- 10 Plunger Handle

OZITO Australia/New Zealand (Head Office) 1-23 Letcon Drive, Bangholme, Victoria, Australia 3175.

0918

GENERAL AIR TOOL SAFETY WARNINGS

WARNING! Read all safety warnings and all instructions. Failure to follow the warnings and instructions may result in electric shock, fire and/or serious injury. Save all warnings and instructions for future reference. The term "power tool" in the warnings refers to your mains-operated (corded) power tool or battery-operated (cordless) power tool.

1. **Work area safety**
 - a. **Keep work area clean and well lit.** Cluttered or dark areas invite accidents.
 - b. **Do not operate power tools in explosive atmospheres, such as in the presence of flammable liquids, gases or dust.** Power tools create sparks which may ignite the dust or fumes.
 - c. **Keep children and bystanders away while operating a power tool.** Distractions can cause you to lose control.
 - d. **Dress properly. Do not wear loose clothing or jewellery. Keep your hair, clothing and gloves away from moving parts.** Loose clothes, jewellery or long hair can be caught in moving parts.
 - e. Check the maximum pressure rating of any tools or accessories that you intend using with the compressor. The output pressure of the air from the compressor must be regulated so that it never exceeds the rated pressure of the tool or accessory.
 - f. Always wear safety goggles or glasses when using the air compressor. Never point the nozzle of an accessory towards any part of your body or towards another person.
 - g. **Drain the moisture from the tank daily.** It will help prevent corrosion.

- h. Use safety equipment including safety goggles or shield, ear protection, breathing respirator mask and protective clothing.
- i. Air tools should not be used in a potentially explosive environment.
- j. Use safety equipment including safety goggles or shield, ear protection, breathing or respirator mask and protective clothing.
- k. **The tool must be used only for its prescribed purpose.** Any use other than those mentioned in this Manual will be considered a case of misuse. The user and not the manufacturer shall be liable for any damage or injury resulting from such cases of misuse.

WARNING! In the event that an air line is cut or broken, the air supply must be turned off at the compressor. A broken air line which is not supported is extremely dangerous and can whip around very quickly, both with the capability of striking people, and blowing foreign particles into the air. Do not attempt to catch the air line but immediately keep bystanders well clear and turn off the air supply to the hose, turn off the compressor at the On / Off button, and then remove the hose from the compressor.

This appliance is not intended for use by persons (including children) with reduced physical, sensory or mental capabilities, or lack of experience and knowledge, unless they have been given the supervision or instruction concerning use of the appliance by a person responsible for their safety. Children should be supervised to ensure that they do not play with the appliance.

AIR GREASE GUN SAFETY WARNINGS

WARNING!
Using an Extension Hose
Always use an approved extension hose suitable for the air input of this tool. Before use, inspect the hose for signs of damage, wear and ageing. Replace the extension hose if damaged or defective. When using an hose on a reel, always unwind the lead completely. It is recommended that the hose is a maximum of 25m in length.

- NEVER under any circumstances aim the nozzle at another person or animal.**
- In the event of an injury occurring, seek medical advice immediately.
 - Always ensure there is adequate ventilation when using the grease gun.
 - The use of ear protection is recommended.
 - Eye protection is recommended to keep hazardous material, vapours and liquids out of eyes.
 - Always wear a face mask when using the grease gun.
 - Never immerse the grease gun in liquid.

- NEVER allow children to operate or play with the grease gun.**
- Before cleaning, always disconnect the appliance from the air supply.
 - Always disconnect from air supply when refilling the grease container.
 - After every use ensure you clean your grease gun thoroughly.

NEVER use the grease gun outside when it is raining.

DESCRIPTION OF SYMBOLS

	Warning		Read instruction manual
	Wear ear protection		Wear eye protection and breathing mask
L/min	Litres per minute	cfm	Cubic feet per minute

SPARE PARTS

Spare parts can be ordered from the Special Orders Desk at your local Bunnings Warehouse.

For further information, or any parts not listed here, visit www.ozito.com.au or contact Ozito Customer Service:

Australia 1800 069 486

New Zealand 0508 069 486

Email: enquiries@ozito.com.au

CONNECTING TO COMPRESSOR

1. Wrap the threaded male end of an air fitting with thread seal tape in a clockwise direction.

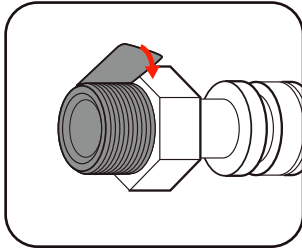

2. Screw the male nitro fitting clockwise into the female end of the air inlet.

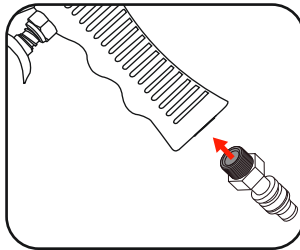

3. Pull back the sleeve on hose fitting, insert male end & release sleeve on hose fitting.

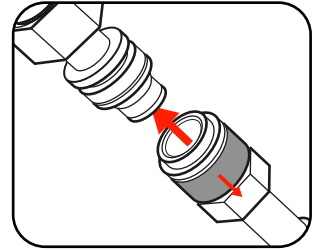

Note: Operating Pressure range is 30 - 90psi (2 - 6.2Bar). Ensure your compressor is set no higher than 90psi (6.2Bar)
Note: This tool should be connected to a clean, dry air supply with inline oiler and water separator.

FILLING THE GREASE GUN

Note: Disconnect the tool from the air supply before fitting or removing attachments.

Filling from a container.

1. Unscrew the grease chamber.
2. Pull the handle back so that it is fully extended.
3. Use a spatula to pack the grease into the chamber.
4. Once filled, clean excess from the edge of the chamber.
5. Screw the chamber securely back onto the gun.
6. Press the plunger release mechanism.

Note: Be careful not to accidentally press the release mechanism whilst filling.

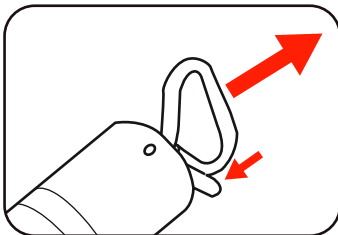

Filling from a grease filler pump

1. Pull the handle back so it is fully extended.
2. Hold the grease gun vertically and connect the plug of a filler pump to the gun nozzle.
3. Operate the filler pump to load the grease.
4. Stop pumping when grease is loaded.
5. Disconnect the filler plug, clean the filler pump nozzle and press the plunger release.

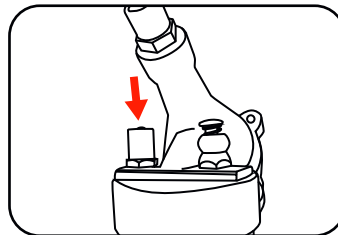

Installing a cartridge.

1. Unscrew the grease chamber.
2. Pull the handle back so it is fully extended.
3. Remove the packaging from the cartridge.
4. Insert the cartridge fully into the chamber.
5. Screw the chamber back into the gun.
6. Press the plunger release mechanism.

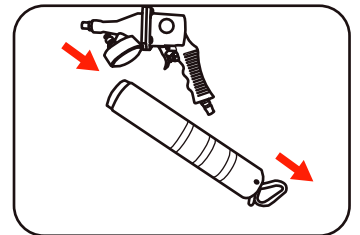

Note: Pulling back on the plunger handle slightly will make pressing the plunger release mechanism easier.

OPERATION

After Filling, remove any air pockets in the grease chamber.

1. Disconnect the tool from the air supply.
2. Release the plunger by depressing the plunger release.
3. Unscrew the chamber slightly by one and a half turns.
4. Draw back the plunger handle fully.
5. Press the plunger release mechanism.
6. Retighten the grease chamber.
7. Depress the air bleed valve several times to let air escape.

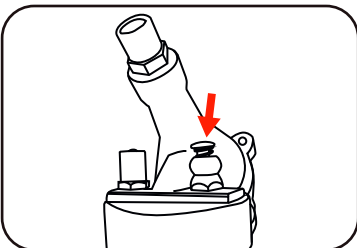

Operation

1. Connect to suitable air supply.
2. Pull trigger to dispense grease from the spout.
3. When finished disconnect from air supply.

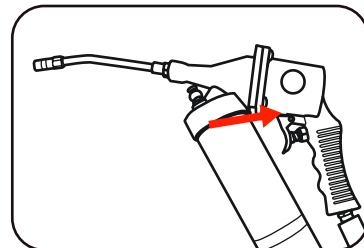

Attaching a spout to a grease nipple

1. Ensure the grease nipple is clean.
2. Connect the required spout by screwing the threaded end into the grease gun.
3. Firmly press the other end of the spout against grease nipple and dispense grease.

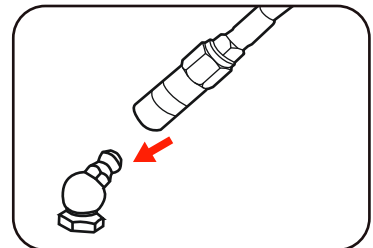

MAINTENANCE

- If the enclosure of the gun requires cleaning, do not use solvents but a moist soft cloth only. Never let any liquid get inside the gun; never immerse any part of the gun into a liquid.
- If the tool is used for long periods at a time, a combined filter/lubricator must be fitted. Air filter must be fitted at all times.
- Store the tool in a dry and safe place out of reach of children.
- **Oil the grease gun after each use.**

TROUBLESHOOTING

If the grease gun fails to work effectively, perform the following checks:

- Check the air inlet is free of any dirt or blockages.
- Ensure the grease gun is lubricated properly.
- Check that the pressure on the air compressor is within its working range. If not, let the compressor rest to re-pressurise / refer to the compressor instruction manual.
- Check plunger has been released
- Check grease level in chamber
- Check for blockages or leaks