



36V / CORDLESS 2X18V

GARDEN SHREDDER

INSTRUCTION MANUAL

SPECIFICATIONS

Input: 36V (2 x 18V)
 No Load Speed: 3,000/min
 Cutting Diameter: 25mm max.
 Blades: 3, Reversible
 Noising Rating: 100dB
 Collection Bag: 55 Litres
 Weight: 10.74kg

ozito.com.au

5 YEAR
REPLACEMENT WARRANTY

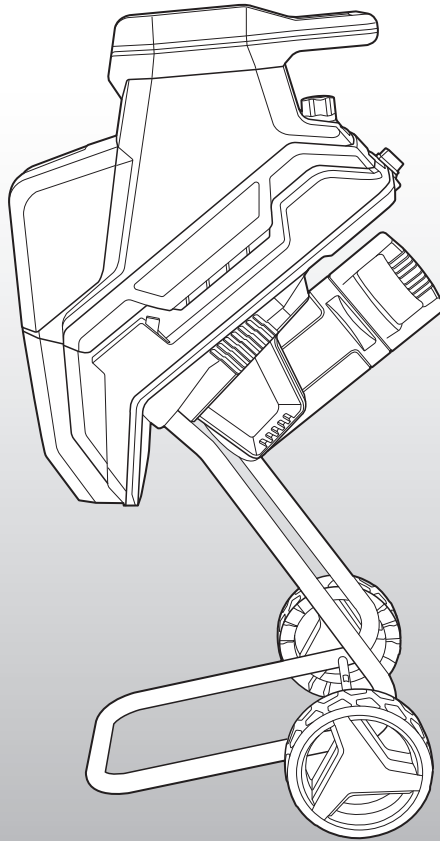

STANDARD EQUIPMENT



Shredder Housing

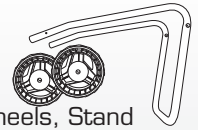

Wheels, Stand



Axle, Wheel Caps



Push Stick, Collection Bag



Wheel Spacers, Hex Key



Socket Screws & Washers

Assembly
Screw x 2



PXGSS-3625

WARRANTY

IN ORDER TO MAKE A CLAIM UNDER THIS WARRANTY YOU MUST RETURN THE PRODUCT TO YOUR NEAREST BUNNINGS WAREHOUSE WITH YOUR BUNNINGS REGISTER RECEIPT. PRIOR TO RETURNING YOUR PRODUCT FOR WARRANTY PLEASE TELEPHONE OUR CUSTOMER SERVICE HELPLINE:

Australia 1800 069 486

New Zealand 0508 069 486

TO ENSURE A SPEEDY RESPONSE PLEASE HAVE THE MODEL NUMBER AND DATE OF PURCHASE AVAILABLE. A CUSTOMER SERVICE REPRESENTATIVE WILL TAKE YOUR CALL AND ANSWER ANY QUESTIONS YOU MAY HAVE RELATING TO THE WARRANTY POLICY OR PROCEDURE.

WARNING

The following actions will result in the warranty being void.

- If the tool has been operated on a supply voltage other than that specified on the tool.
- If the tool shows signs of damage or defects caused by or resulting from abuse, accidents or alterations.
- Failure to perform maintenance as set out within the instruction manual.
- If the tool is disassembled or tampered with in any way.
- Professional, industrial or high frequency use.

The benefits provided under this warranty are in addition to other rights and remedies which are available to you at law.

Our goods come with guarantees that cannot be excluded at law. You are entitled to a replacement or refund for a major failure and for compensation for any other reasonably foreseeable loss or damage. You are also entitled to have the goods repaired or replaced if the goods fail to be of acceptable quality and the failure does not amount to a major failure.

Generally you will be responsible for all costs associated with a claim under this warranty, however, where you have suffered any additional direct loss as a result of a defective product you may be able to claim such expenses by contacting our customer service helpline above.

5 YEAR REPLACEMENT WARRANTY

Your Product is guaranteed for a period of 60 months from the original date of purchase and is intended for DIY (Do It Yourself) use only. If a product is defective it will be replaced in accordance with the terms of this warranty. **Lithium Ion batteries and chargers are covered by a 36 month warranty.** Warranty excludes consumable parts and included accessories, for example: bearings, blades, push stick, hex key, collection bag and wheels.

KNOW YOUR PRODUCT

CORDLESS GARDEN SHREDDER

- | | |
|------------------------|---------------------|
| 1. Hopper | 9. Transport Wheels |
| 2. Transport Handle | 10. Hex Key |
| 3. Hopper Lock | 11. Push Stick |
| 4. Hex Key Storage | 12. Collection Bag |
| 5. On/Off Switch | 13. Discharge Chute |
| 6. Collection Bag Hook | 14. Battery Cover |
| 7. Motor Housing | 15. Hopper Housing |
| 8. Stand | |

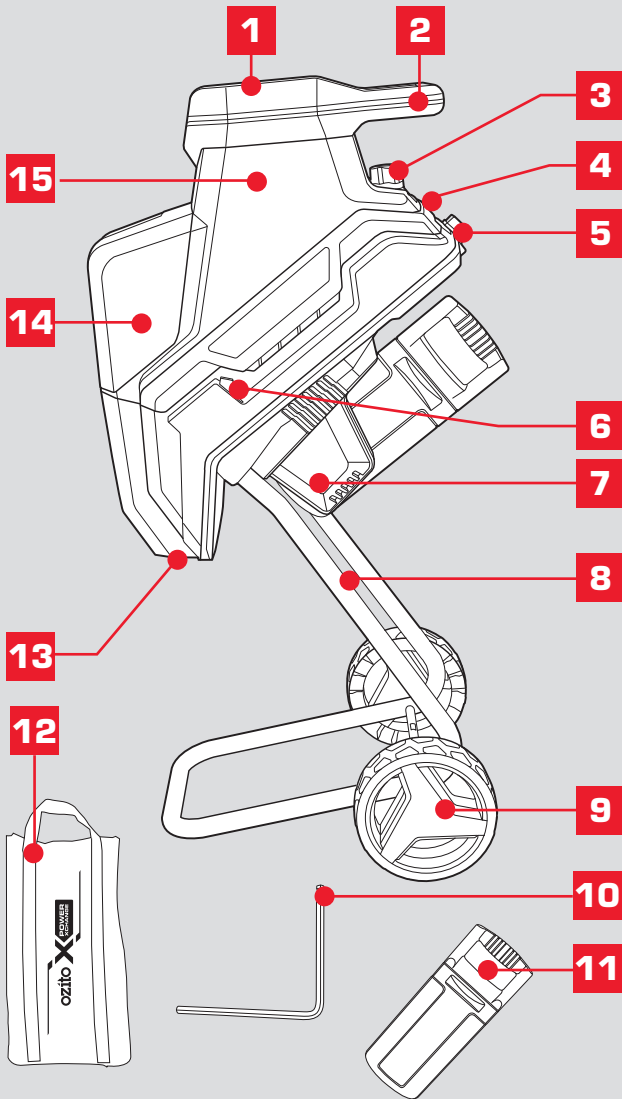

BATTERY & CHARGER

This tool is compatible with all battery and chargers from the Ozito PXC Range.

ONLINE MANUAL

Scan this QR Code with your mobile device to take you to the online manual.



SETUP & PREPARATION

1. ASSEMBLY

WARNING! ENSURE THE MACHINE IS SWITCHED OFF AND BATTERIES ARE DISCONNECTED BEFORE PERFORMING ANY OF THE FOLLOWING TASKS.

Fitting the Wheels and Stand

1. Carefully place the shredder upside down on a flat surface. Place each leg of the stand into the two holes at the base of the shredder housing.

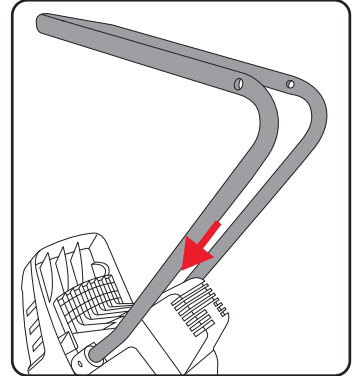

2. Using a screwdriver (not included) secure the legs using the two assembly screws provided, turn in a clockwise direction to tighten.

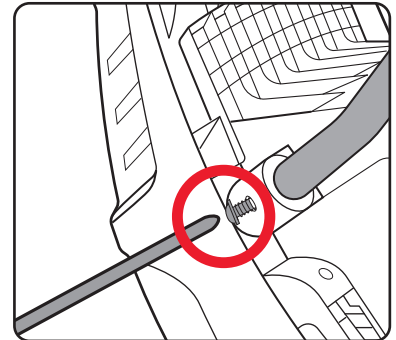

3. Thread the axle through the holes in the stand.

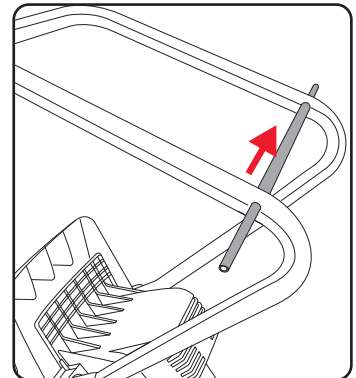

4. Place wheel spacer over each protruding end of the axle.

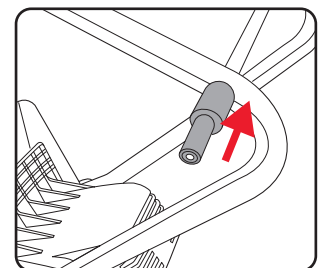

5 YEAR
REPLACEMENT WARRANTY

5. Insert each wheel over the wheel spacers, then secure with washer and socket screws.

Note: Ensuring that the larger inner diameter of the wheel is facing outwards. This allows the wheel cap to be fitted.

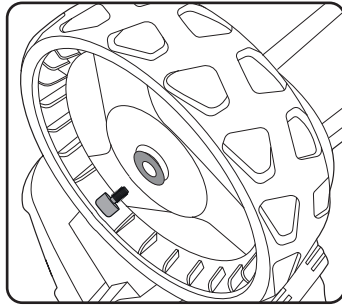

6. Insert a screwdriver through the holding hole on the axle and tighten the socket screws with hex key provided, turn in a clockwise direction.

Note: The Hex Key storage location is on the rear of the shredder directly above the on/off switch.

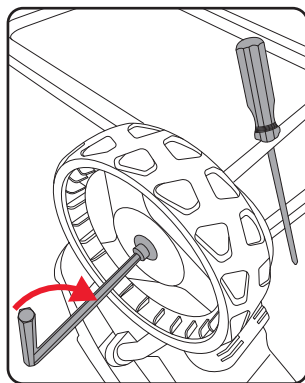
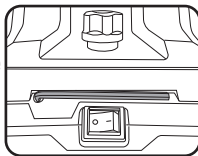

7. Place the wheel cap onto the wheels; ensure the three tabs on the caps latch onto the recesses on the wheels.

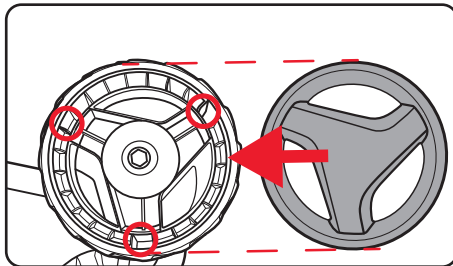

8. Once fully assembled carefully lift the shredder into its correct position supported by the stand and wheels.

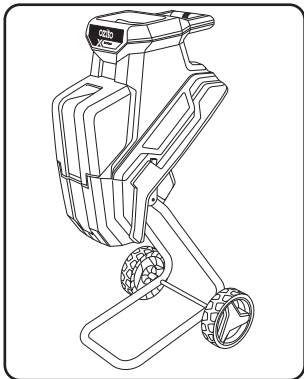

9. For easy access and safe storage of your push stick, slide it onto the holder located on the right underside of the shredder.

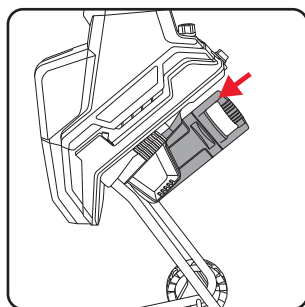

2. PREPARATION

Collection Bag

Hang the collection bag on the hooks located on both sides of the shredder.

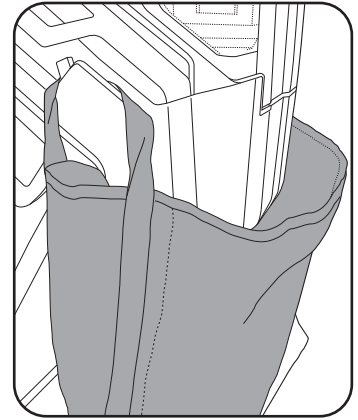

Inserting and Removing the Batteries

Only use 2 batteries with the same capacity (Ah). Always use 2 batteries with the same charge state with the garden shredder.

Note: The cover is spring loaded and is self-closing. Magnets hold the cover shut.

Hold open the cover and insert two fully charged batteries into the battery mounts, align the ribs of the battery with the battery mounts as you slide the battery in so that they click into place.

To remove, press and hold the battery release tab **(a)** to release, then slide the battery out **(b)**.

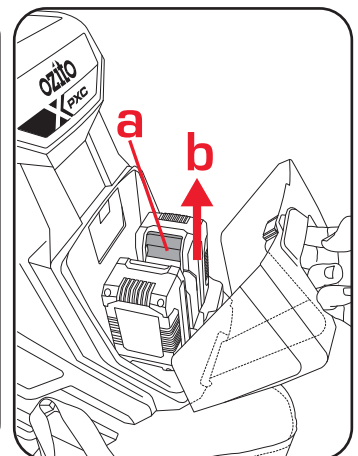
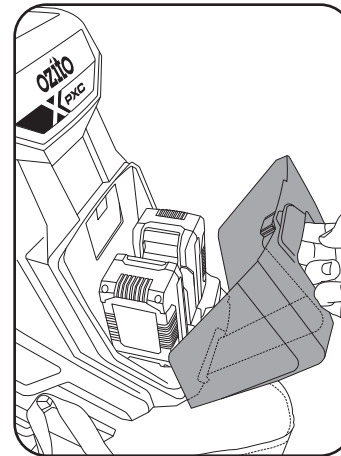

Run Time

The operating time of the PXC battery (the amount that can be shredded with a single battery charge) is largely dependent on the state of the shrubbery (e.g. Density, moisture, thickness, etc.) and the battery charge level. Never combine full and half-full batteries or batteries with different capacities (Ah).

Frequently turning the equipment on and off will also reduce the runtime and amount that you can shred. If the operating time of the PXC battery (runtime) is still unsatisfactory in spite of the above measures, you can remedy the problem by using a PXC battery with a larger capacity (Ah).

OPERATION

3. CONTROLS & SAFETY FEATURES

On/Off Switch

1. To start the shredder move the on/off switch to the ON 'I' position.

Note: If the batteries are empty or if the equipment is overloaded (blocked), the equipment will switch off automatically (switch position 'O'). The equipment can be switched on again after you have replaced the batteries or removed the blockage.

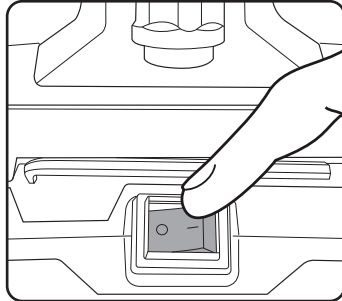

2. To stop the shredder move the on/off switch to the OFF 'O' position.

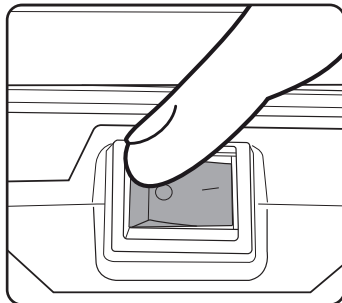

Overload Protection

The motor is protected from overloads (motor circuit breaker). If an overload occurs, the equipment will shut down automatically. To restart, set the On/Off switch to the position 'I'. If the motor fails to start, you must clean the Hopper and the Discharge Chute. See the **Cleaning** section of this manual for further details.

Safety Interlock

The shredder is fitted with a safety switch on the closure between the shredder housing and motor housing. This acts as a safety mechanism to prevent the shredder from operating if it is not closed correctly.

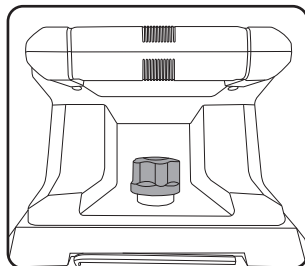

- If the housing is not closed correctly and secured with the hopper lock, the safety switch will prevent the shredder from being turned on.
- If this occurs open the housing and ensure no debris is preventing closure. Refit and tighten the hopper lock knob in a clockwise direction. Take care to correctly line up the thread on the knob before tightening to avoid cross threading. See the **Cleaning** section of this manual for further details.

WARNING! NEVER LOOSEN THE HOPPER LOCK KNOB WHEN THE POWER IS ON. ALWAYS ENSURE THE POWER IS SWITCHED OFF AND BOTH BATTERIES ARE REMOVED.

4. OPERATING THE SHREDDER

WARNING! THE SHREDDER IS NOT SUITABLE FOR MATERIALS INCLUDING GLASS, METAL, PLASTIC BAGS, STONES, FABRIC, EARTH COVERED ROOTS, SOFT LEAFY MATERIAL AND WASTE WITHOUT A FIRM CONSISTENCY (EG. KITCHEN WASTE).

WARNING! ALWAYS WEAR APPROPRIATE PERSONAL PROTECTIVE EQUIPMENT (PPE) WHEN USING THE SHREDDER, SUCH AS NON-SLIP FOOTWEAR, LONG TROUSERS, LEATHER GLOVES, SAFETY GLASSES AND EAR PROTECTION. NEVER USE THE EQUIPMENT BAREFOOT OR IN SANDALS

WARNING! TO PREVENT DAMAGE TO THE SHREDDER IT IS RECOMMENDED THAT GARDEN MATERIAL GREATER THEN Ø25MM IS NOT FED INTO THE HOPPER

The following types of material can be used in the shredder:

- Twigs
- Branches
- Waste from cut bushes
- Waste from hedge trimming

1. Feed the material to be shredded into the feeding hopper.

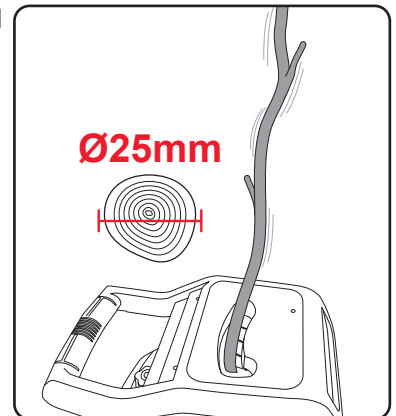

WARNING! THE MATERIAL IS DRAWN INTO THE SHREDDER AUTOMATICALLY. LONG PIECES OF MATERIAL PROJECTING OUT OF THE HOPPER MAY WHIPLASH WHEN DRAWN IN - KEEP A SAFE DISTANCE BETWEEN YOURSELF AND THE MACHINE.

2. The shredder will automatically pull the material through the feeding hopper. The push stick can be used to assist in feeding the garden material.

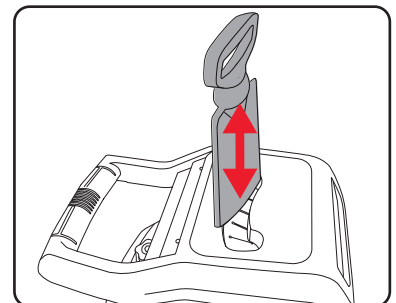

Note: The shredder may clog if too much fine material is fed in. To prevent clogging, mix fine material with larger material.

WARNING! DO NOT OPERATE THIS MACHINE WITH LONG LOOSE HAIR OR LOOSE FITTING JEWELLERY. TIE LONG LOOSE HAIR BACK AND REMOVE LOOSE FITTING JEWELLERY.

MAINTENANCE

5. TIPS

Shredding

Following the below procedures will improve operation and prolong the life of the shredder.

Note: Do not use garden material stems greater than $\varnothing 25\text{mm}$.

- Branches and twigs should be shredded shortly after they are cut. They become extremely hard once dry and the maximum cutting diameter is reduced.
- Garden waste such as fresh foliage, creepers and vines contain a lot of moisture, this can result in material sticking to the cutter head. Such material should be allowed to dry for a few days before being fed into the shredder.
- Judge the quantity of material which you put into the hopper so that the hopper does not clog.
- If you want to shred withered, damp material that has been lying in the garden for several days, alternate between putting in this material and branches. This will help to prevent the hopper becoming clogged with material.
- Always check material before shredding, ensure it does not contain any stones or nails as this may severely damage the shredder.
- Do not allow the discharge chute to become clogged with shredded material – risk of pile-ups.
- Do not place heavy material or thick branches into the machine continuously. This may cause the blade to jam.
- Material that contains dirt will rapidly blunt the blades and should be avoided.
- Always clean the shredder after each use.

Composting

The shredded material can be composted in many various ways:

- The material can be placed in a heap directly on the ground (cold composting).
- The material can be placed in a plastic container, wooden crate, skeleton container or similar (cold composting).
- The material can be placed in an insulated compost holder. The heat is then maintained for longer periods and the rotting process continues during the winter. This method produces faster results (warm composting).
- The material can be spread directly onto the garden (surface composting).

WARNING! ALWAYS USE A DUST MASK AND SAFETY GLOVES WHEN HANDLING COMPOSTED MATERIAL TO PREVENT CONTAMINATION FROM MICRO ORGANISMS.

6. CLEANING THE HOPPER

WARNING! ALWAYS ENSURE THE SHREDDER HAS COMPLETELY STOPPED AND THE BATTERIES ARE REMOVED PRIOR TO ANY CLEANING.

WARNING! BLADES ARE SHARP, HANDLE WITH CARE, IT IS RECOMMENDED TO USE SAFETY GLOVES WHEN CLEANING THE SHREDDER OR PERFORMING ANY MAINTENANCE.

WARNING! NEVER USE A HIGH-PRESSURE WASHER OR RUNNING WATER WHEN CLEANING THE SHREDDER.

1. Ensure the shredder is turned off and both batteries are removed. Unscrew the hopper locking knob in an anti-clockwise direction. The thread on the knob is quite lengthy, the operation will require approximately 15 rotations to fully open the housing.

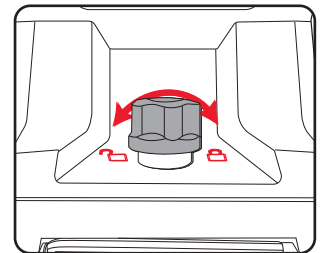

2. After unscrewing the hopper locking knob lift the hopper housing upwards to remove and gain access to the blades and discharge chute.

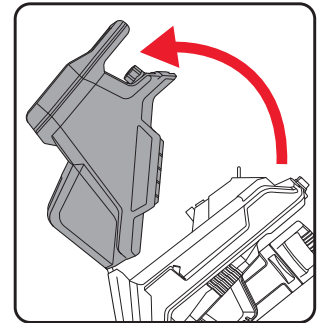

3. Carefully clean out the cutting and discharge area. Ensure that all debris is removed to prevent the blades from clogging. The discharge area should be free of all organic matter. If the shredder is full of organic matter it will burn out the motor and prevent operation.

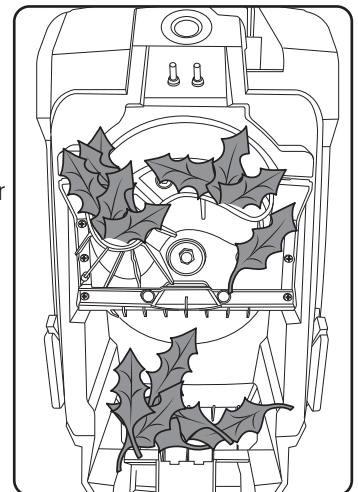

4. Once the shredder blades are completely clean gently refit the hopper housing and tighten the knob by rotating in a clockwise direction. Ensure it is securely fitted to the housing.

MAINTENANCE cont.

7. BLADE REPLACEMENT



WARNING! ALWAYS ENSURE THE SHREDDER HAS COMPLETELY STOPPED AND THE BATTERIES ARE REMOVED PRIOR TO ANY MAINTENANCE.



WARNING! BLADES ARE SHARP, HANDLE WITH CARE, IT IS RECOMMENDED TO USE SAFETY GLOVES WHEN HANDLING THE BLADES.

The blades supplied with the shredder are reversible. The blades can also be re-sharpened if they become blunt over a period of time. Additional blades & bolts can be obtained as spare parts. Always reverse or replace three blades at the same time.

To remove the blades proceed as follows:

1. Ensure the shredder is turned off and batteries are removed. Unscrew the hopper knob in an anti-clockwise direction. The thread on the locking knob is quite long, the operation will require approximately 15 rotations to fully open the housing.

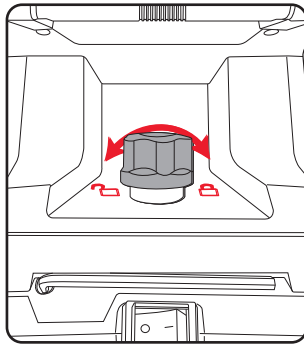

2. After unscrewing the hopper knob lift the housing upwards to gain access to the blades.

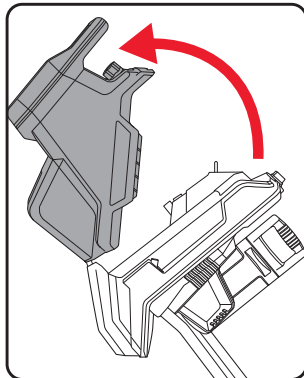

3. There are three blades and these are each fixed to the rotating blades plate with two socket head screws. To remove the blades first clean out any debris and build up of material from the blades. Then undo the 6 screws and remove the cover plates.

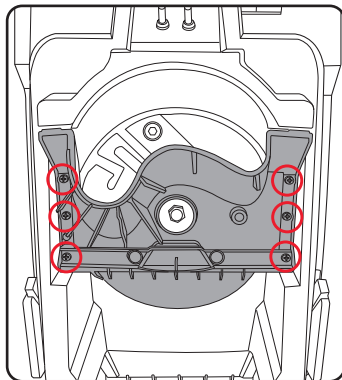

4. Place a screwdriver (not supplied) through the slot in the blade plate, this will secure the rotating blade plate in its position allowing you to remove both blades. The screws may be tight due to corrosion and dirt buildup. Ensure that the supplied hex key is a good fit into the screw and that the hex key is held firmly and at right angles to the blade plate.

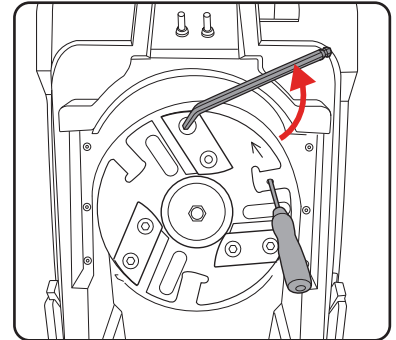

Remove the 2 blade securing screws by rotating the hex key in the anti-clockwise direction.

To remove each remaining blade repeat step 4.

5. If the opposite side of the blades are new, the blades can be reversed to use the new side. If both sides of the blades are worn then replace the blades and retighten the blades by following steps 4-5 in reverse. If new blades are being fitted ensure that the new blade securing screws are fitted at the same time. Ensure all blade securing screws are tight prior to operation.

Note: It is recommended to add a small amount (drop) of Loctite® 222 Threadlocker to the thread of the blade securing screw, Loctite® 222 Threadlocker is available from all Bunnings stores. This assists in securing the screw and reduces the chance of the blade securing screw vibrating loose whilst in operation.



WARNING! ENSURE THE BLADE SECURING SCREWS SECURING THE BLADES ARE FULLY TIGHTENED PRIOR TO OPERATION. IF THERE IS ANY VIBRATION OR ABNORMAL NOISE AFTER RE-STARTING THE SHREDDER, IMMEDIATELY STOP OPERATION. REMOVE BOTH BATTERIES AND CHECK THAT THE BLADES ARE ASSEMBLED CORRECTLY AND SECURELY TIGHTENED.

6. Once the blades are removed/reversed, refit cover plates, lower the housing and tighten the hopper locking knob by rotating in a clockwise direction. Ensure it is securely fitted to the housing.

Cleaning and Storage

- Clean the machine regularly. This will help to keep the machine in good working order and is the basis for a long working life.
- Use a soft brush to remove debris from all air intakes and the blades.
- Never allow water to get inside the machine or clean the garden shredder with running water, particularly with high-pressure water. Avoid using solvents when cleaning plastic parts. Most plastics are susceptible to damage from various types of commercial solvents. Use clean cloths to remove dirt.
- If the housing of the machine requires cleaning, do not use solvents. Use of a soft cloth and brush only is recommended.
- Inspect the stand assembly screws from time to time to ensure that they are tight.
- When not in use remove the batteries.
- Store in a dry, frost free location not within the reach of children.
- Keep air intake clean and air vents free of debris to avoid overheating the motor.
- Keep away from corrosive agents such as garden chemicals.
- Store the garden shredder in a dry location at above freezing temperature which is not accessible to unauthorised persons.
- The ideal storage temperature is between 5°C and 30°C.

Note: Ozito Industries will not be responsible for any damage or injuries caused by the repair of the shredder by an unauthorised person or by mishandling of the shredder. This tool is designed for DIY use - use in commercial or industrial environments will void the warranty.

TROUBLESHOOTING

Problem	Cause	Remedy
The motor does not run.	The shredder may have been overloaded.	Wait 1-5 minutes and allow the motor to cool down. Move the on/off switch to the ON 'I' position to restart the shredder.
	Discharge chute is blocked.	Clean discharge chute.
	The closure between the hopper housing and shredder motor housing has not been closed correctly.	The safety interlock will not allow power to the shredder. Open the housing and ensure the contact surfaces are clean. Refit and tighten the hopper locking knob in a clockwise direction.
	Battery not inserted properly.	Insert battery pack correctly
Shredder is not operating at full capacity.	Possible clogging.	Open the shredder and clean the hopper and blades of any leaves or debris.
	Blades worn.	Turn, sharpen or replace blades.
Motor stops while shredding.	Battery has no power.	Charge battery.
	The shredder may have been overloaded.	Wait 1-5 minutes and allow the motor to cool down. Move the on/off switch to the ON 'I' position to restart the shredder.
The material to be shredded is not pulling through the unit.	The hopper plate is blocked.	Remove the batteries and unscrew the locking knob. Carefully clean all debris and free organic matter from the discharge area. Lower the housing and tighten the locking knob to ensure it is secure.
	Blades worn.	Turn, sharpen or replace blades.

DESCRIPTION OF SYMBOLS

V	Volts	Hz	Hertz
a.c./~	Alternating Current	W	Watts
dc/---	Direct Current	n₀	No load speed
IPX1	Ingress protection from water		Diameter
/min	Revolutions or reciprocations per minute		Warning
	Regulatory Compliance Mark (RCM)		Wear eye protection
	Do not operate in the rain or leave the shredder outdoors while raining		Wear ear protection
	Beware of debris being ejected from the shredder		Wear safety gloves
	Read Instruction Manual to reduce the risk of injury		Keep bystanders away
	DANGER - Rotating blades. Keep hands and feet out of openings while machine is running		
	DANGER - Sharp blades. Always wear safety gloves when replacing or cleaning the blades. The blades are sharp and will cut you even when not rotating		
	Sound power level: 100dB		The equipment's operating time depends on the battery with the lower charge level. Therefore, only use rechargeable batteries which are charged to the same level.

CARING FOR THE ENVIRONMENT



Power tools that are no longer usable should not be disposed of with household waste but in an environmentally friendly way. Please recycle where facilities exist. Check with your local council authority for recycling advice.



Recycling packaging reduces the need for landfill and raw materials. Reuse of recycled material decreases pollution in the environment. Please recycle packaging where facilities exist. Check with your local council authority for recycling advice.

SPARE PARTS

Spare parts can be ordered from the Special Orders Desk at your local Bunnings Warehouse.

For further information, visit www.ozito.com.au or

contact Ozito Customer Service:

Australia 1800 069 486

New Zealand 0508 069 486

E-mail: hello@ozito.com.au



ELECTRICAL SAFETY



WARNING! When using electric machines, basic safety precautions, including the following, should always be followed to reduce risk of fire, electric shock, personal injury and material damage.

-Read the whole manual carefully and make sure you know how to switch the machine off in an emergency, before operating the machine. Save these instructions and other documents supplied with this machine for future reference.

-This appliance is not intended for use by persons (including children) with reduced physical, sensory or mental capabilities, or lack of experience and knowledge, unless they have been given supervision or instruction concerning use of the appliance by a person responsible for their safety.

Children should be supervised to ensure that they do not play with the appliance.

-This appliance is compatible and only to be used with all batteries & chargers from the Ozito PXC range. Refer to the PXC battery and charger manuals for information regarding charging, use and storage.

-Remove the batteries from the appliance before being charged.

-Do not combine different types of batteries or new and used batteries.

-If the appliance is to be stored unused for a long period, the batteries should be removed.

-Do not use modified or damaged batteries.



GENERAL MACHINE SAFETY WARNINGS



WARNING! Read all safety warnings, instructions, illustrations and specifications provided with this machine. Failure to follow all instructions listed below may result in electric shock, fire and/or serious injury.

Save all warnings and instructions for future reference.

The term "machine" in the warnings refers to your mains-operated (corded) machine or battery-operated (cordless) machine.

1) Work area safety

- a) **Keep work area clean and well lit.** Cluttered or dark areas invite accidents.
- b) **Do not operate machines in explosive atmospheres, such as in the presence of flammable liquids, gases or dust.** Machines create sparks which may ignite the dust or fumes.
- c) **Keep children and bystanders away while operating a machine.** Distractions can cause you to lose control.

2) Electrical safety

- a) **Machine plugs must match the outlet. Never modify the plug in any way. Do not use any adapter plugs with earthed (grounded) machines.** Unmodified plugs and matching outlets will reduce risk of electric shock.
- b) **Avoid body contact with earthed or grounded surfaces, such as pipes, radiators, ranges and refrigerators.** There is an increased risk of electric shock if your body is earthed or grounded.
- c) **Do not expose machines to rain or wet conditions.** Water entering a machine will increase the risk of electric shock.
- d) **Do not abuse the cord. Never use the cord for carrying, pulling or unplugging the machine. Keep cord away from heat, oil, sharp edges or moving parts.** Damaged or entangled cords increase the risk of electric shock.
- e) **When operating a machine outdoors, use an extension cord suitable for outdoor use.** Use of a cord suitable for outdoor use reduces the risk of electric shock.
- f) **If operating a power tool in a damp location is unavoidable, use a residual current device (RCD) protected supply.** Use of an RCD reduces the risk of electric shock.

3) Personal safety

- a) **Stay alert, watch what you are doing and use common sense when operating a machine. Do not use a machine while you are tired or under the influence of drugs, alcohol or medication.** A moment of inattention while operating machines may result in serious personal injury.
- b) **Use personal protective equipment. Always wear eye protection.** Protective equipment such as a dust mask, non-skid safety shoes, hard hat or hearing protection used for appropriate conditions will reduce personal injuries.
- c) **Prevent unintentional starting. Ensure the switch is in the off-position before connecting to power source and/or battery pack, picking up or carrying the machine.** Carrying machines with your finger on the switch or energising machines that have the switch on invites accidents.
- d) **Remove any adjusting key or wrench before turning the machine on.** A wrench or a key left attached to a rotating part of the machine may result in personal injury.
- e) **Do not overreach. Keep proper footing and balance at all times.** This enables better control of the machine in unexpected situations.
- f) **Dress properly. Do not wear loose clothing or jewellery. Keep your hair and clothing away from moving parts.** Loose clothes, jewellery or long hair can be caught in moving parts.
- g) **If devices are provided for the connection of dust extraction and collection facilities, ensure these are connected and properly used.** Use of dust collection can reduce dust-related hazards.
- h) **Do not let familiarity gained from frequent use of machines allow you to become complacent and ignore machine safety principles.** A careless action can cause severe injury within a fraction of a second.

4) Machine use and care

- a) **Do not force the machine. Use the correct machine for your application.** The correct machine will do the job better and safer at the rate for which it was designed.
- b) **Do not use the machine if the switch does not turn it on and off.** Any machine that cannot be controlled with the switch is dangerous and must be repaired.
- c) **Disconnect the plug from the power source and/or remove the battery pack, if detachable, from the machine before making any adjustments, changing accessories, or storing machines.** Such preventive safety measures reduce the risk of starting the machine accidentally.
- d) **Store idle machines out of the reach of children and do not allow persons unfamiliar with the machine or these instructions to operate the machine.** Machines are dangerous in the hands of untrained users.
- e) **Maintain machines and accessories. Check for misalignment or binding of moving parts, breakage of parts and any other condition that may affect the machine's operation. If damaged, have the machine repaired before use.** Many accidents are caused by poorly maintained machines.
- f) **Keep cutting machines sharp and clean.** Properly maintained cutting machines with sharp cutting edges are less likely to bind and are easier to control.
- g) **Use the machine, accessories and machine bits etc. in accordance with these instructions, taking into account the working conditions and the work to be performed.** Use of the machine for operations different from those intended could result in a hazardous situation.
- h) **Keep handles and grasping surfaces dry, clean and free from oil and grease.** Slippery handles and grasping surfaces do not allow for safe handling and control of the machine in unexpected situations.

5) Battery machine use and care

- a) **Recharge only with the charger specified by the manufacturer.** A charger that is suitable for one type of battery pack may create a risk of fire when used with another battery pack.
- b) **Use machines only with specifically designated battery packs.** Use of any other battery packs may create a risk of injury and fire.
- c) **When battery pack is not in use, keep it away from other metal objects, like paper clips, coins, keys, nails, screws or other small metal objects, that can make a connection from one terminal to another.** Shorting the battery terminals together may cause burns or a fire.
- d) **Under abusive conditions, liquid may be ejected from the battery; avoid contact. If contact accidentally occurs, flush with water. If liquid contacts eyes, additionally seek medical help.** Liquid ejected from the battery may cause irritation or burns.
- e) **Do not use a battery pack or machine that is damaged or modified.** Damaged or modified batteries may exhibit unpredictable behaviour resulting in fire, explosion or risk of injury.
- f) **Do not expose a battery pack or machine to fire or excessive temperature.** Exposure to fire or temperature above 130 °C may cause explosion.
- g) **Follow all charging instructions and do not charge the battery pack or machine outside the temperature range specified in the instructions.** Charging improperly or at temperatures outside the specified range may damage the battery and increase the risk of fire.

6) Service

- a) **Have your machine serviced by a qualified repair person using only identical replacement parts.** This will ensure that the safety of the machine is maintained.
- b) **Never service damaged battery packs.** Service of battery packs should only be performed by the manufacturer or authorized service providers.



GARDEN SHREDDER SAFETY WARNINGS



WARNING! This appliance is not intended for use by persons (including children) with reduced physical, sensory or mental capabilities, or lack of experience and knowledge, unless they have been given supervision or instruction concerning use of the appliance by a person responsible for their safety.

Young children should be supervised to ensure that they do not play with the appliance.

- Only operate the machine in open space (eg. not close to a wall or other fixed object) and on a firm, level surface.
- Do not operate the machine on a paved or gravel surface where ejected material could cause injury.
- Always stand clear of the discharge zone when operating this machine.
- Do not transport this machine while the power source is running.
- Do not tilt the machine while the power source is running.
- Only use the shredder in dry conditions and never outdoors when it is raining.
- Do not allow children or any person who has not read this instruction manual or who is not familiar with the shredder.
- Remember that the operator may be held responsible for accidents or hazards occurring to other people and/or their property.
- Ensure the shredder is placed on a firm and level surface prior to using.
- Before starting the shredder, ensure the chute is empty.
- Never use the shredder with damaged safety devices or without protection.
- Never operate the shredder unless the chute is in place and securely fastened.
- Wear ear protection when operating the shredder.
- Never look directly into the outlet while the shredder is running as loose debris may be ejected.
- Do not allow processed material to build up in the discharge chute. This may prevent proper discharge and can result in kickback of material through the feeding hopper.
- If the machine becomes clogged, switch off the machine and disconnect from the power. Allow the cutter to come to a stop. Clear debris from the cutter assembly.
- Never attempt to shred bones, stone, glass, metals, plastic or rags.
- Ensure the customer assembled all screws and nuts are properly tightened.
- Wear protective gloves, safety glasses and avoid loose clothing.



WARNING! Rotating cutter head. Keep hands and feet out of openings.

- Store shredder upright in a dry place when not in use.
- Never put your hands in the cutter area while the cutter assembly is running or having first removed the batteries from the shredder. The cutter continues to run for a few seconds after the shredder has been switched off.
- If the cutter strikes any foreign objects or if the shredder starts making any unusual noise or vibration, switch off the shredder immediately and disconnect the power.

Allow the cutter to come to a stop and take the following steps:

- Inspect for damage
- Check and tighten any loose parts
- Have any damaged parts replaced and/or repaired by an electrician or power tool repairer.

- Always switch off the shredder and remove the batteries whenever you leave the work area.



WARNING! When servicing, use only identical replacement parts. Use of any other parts may create a hazard or cause product damage. To ensure safety and reliability, all repairs should be performed by a qualified service technician.



DANGER! Always remove the batteries from the shredder:

- when the equipment is left unattended,
- when the equipment is being checked, cleaned, or having maintenance work done,
- or if the equipment vibrates abnormally.