

The mobile solution for thorny situations!

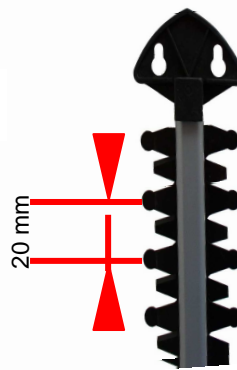

MECHANICAL BLADE STOP



The convenient helper for getting even the densest hedges in shape. Silent, safe and easy to handle. Special drive system for powerful cutting performance and highly efficient blocking protection. Equipped with counter-rotating double blades made of precision-sharpened special steel. ON/OFF (dead man's) safety switch and a large hand protection shield for safe operation. Supplied with a sturdy blade protection cover for storage and transport. Optimized ergonomic design for fatigue-free working. The rear handle turns at a 90-degree angle for easy handling in hard-to-reach areas (i.e. when cutting hedge in "overhead" position). Horizontal guidance, easy collection of cuts thanks to mountable shovel. Better than the competition's leading products with 3,200 cuts per minute.

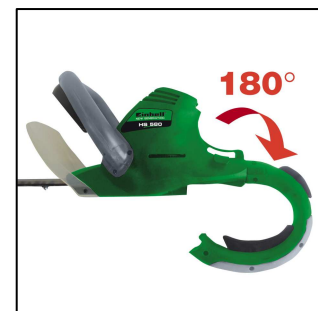
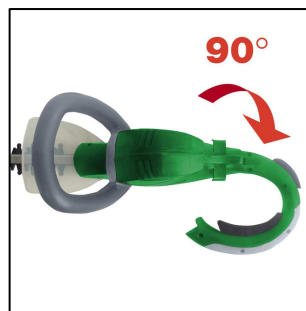

HS 580 Electric Hedge Trimmer

Logistic Information:

Type:	HS 580	Sales unit:	4 pcs
Art. No.:	34.035.90	20`:`:	728 pcs
Ident. No.:	01025	40`:`:	1624 pcs
Bar Code:	4006825 508963	40``HC:	1856 pcs
Packing:	1085x190x225 mm	Weight:	5.5 kgs (gross)



The mobile solution for thorny situations!

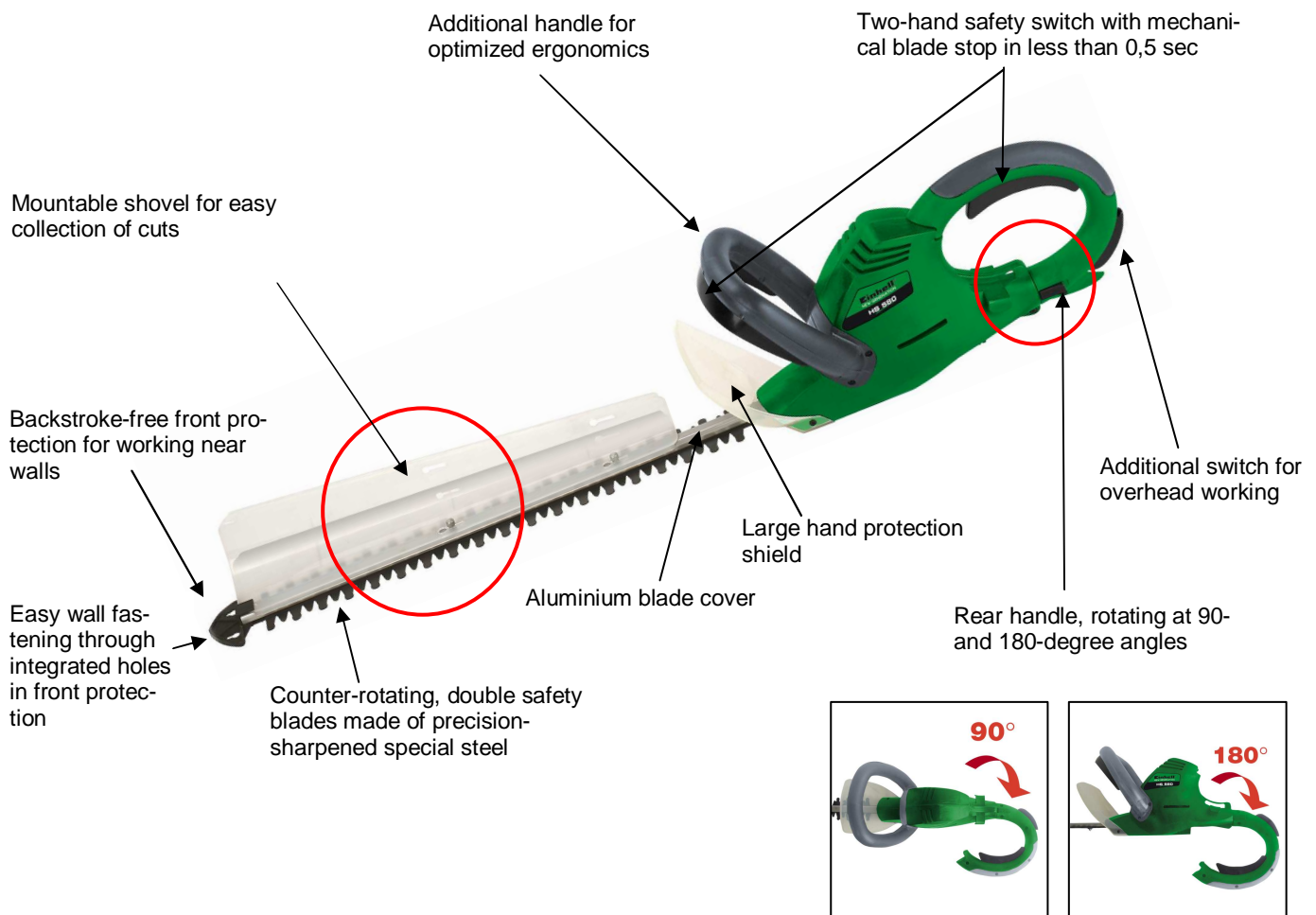

Features:

- Mountable shovel
- Additional switch for overhead working
- Rear handle, rotating at 90- and 180-degree angles
- Two-hand safety switch with mechanical blade stop <0,5 sec
- Counter-rotating, double safety blades made of precision-sharpened special steel
- Aluminium knife cover
- Impact protection with integrated holes for wall fastening
- Sturdy blade protection cover for storage and transport (not shown)

Technical Data:

- Voltage: 230V~50 Hz
- Power: 600 Watt
- Cutting length: 530 mm
- Sword length: 600 mm
- Teeth spacing: 20 mm
- Cutting strength max.: 15 mm
- Cuts per min: 3200

Logistic Information:

Type:	HS 580	Tool:	Electric Hedge Trimmer
Art. No.:	34.035.90	Sales unit:	4 pcs
Ident. No.:	01025	20`:`:	728 pcs
Bar Code:	4006825 508963	40`:`:	1624 pcs
Packing:	1085x190x225 mm	40``HC:	1856 pcs
		Weight:	5.5 kgs (gross)

