

# PESG 120 A1



**GB**  
**ARC WELDER**  
Operation and Safety Notes  
Original operating instructions

**SI**  
**ELEKTRIČNI VARILNI APARAT**  
Navodila za upravljanje in varnostna opozorila  
Originalna navodila za uporabo

**SK**  
**ELEKTRICKÁ ZVÁRAČKA**  
Pokyny pre obsluhu a bezpečnostné pokyny  
Originálny návod na obsluhu

**DE AT CH**  
**ELEKTRO-SCHWEISSGERÄT**  
Bedienungs- und Sicherheitshinweise  
Originalbetriebsanleitung

**HU**  
**ÍVHEGESZTŐ BERENDEZÉS**  
Kezelési és biztonsági utalások  
Eredeti használati utasítás

**CZ**  
**ELEKTRICKÁ SVÁŘEČKA**  
Pokyny pro obsluhu a bezpečnostní pokyny  
Originální návod k obsluze

**PL**  
**SPAWARKA TRANSFORMATOROWA**  
Wskazówki dotyczące obsługi i bezpieczeństwa  
Instrukcja oryginalna

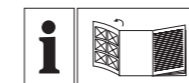

**GB**

Before reading, unfold the page containing the illustrations and familiarise yourself with all functions of the device.

**HU**

Olvasás előtt kattintson az ábrát tartalmazó oldalra és végezetül ismerje meg a készülék mindegyik funkcióját.

**SI**

Pred branjem stran s slikami odprite navzven in se nato seznanite z vsemi funkcijami naprave.

**CZ**

Před čtením si otevřete stranu s obrázky a potom se seznamte se všemi funkcemi přístroje.

**SK**

Pred čítaním si odklopte stranu s obrázkami a potom sa oboznámte so všetkými funkciami prístroja.

**PL**

Przed przeczytaniem proszę rozłożyć stronę z ilustracjami, a następnie proszę zapoznać się z wszystkimi funkcjami urządzenia.

**DE AT CH**

Klappen Sie vor dem Lesen die Seite mit den Abbildungen aus und machen Sie sich anschließend mit allen Funktionen des Gerätes vertraut.

GB	Operation and Safety Notes	Page	5
HU	Kezelési és biztonsági utalások	Oldal	15
SI	Navodila za upravljanje in varnostna opozorila	Stran	25
CZ	Pokyny pro obsluhu a bezpečnostní pokyny	Strana	35
SK	Pokyny pre obsluhu a bezpečnostné pokyny	Strana	45
PL	Wskazówki dotyczące obsługi i bezpieczeństwa	Strona	56
DE/AT/CH	Bedienungs- und Sicherheitshinweise	Seite	67

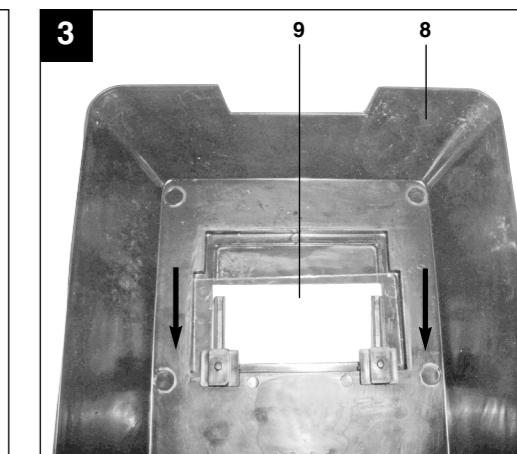
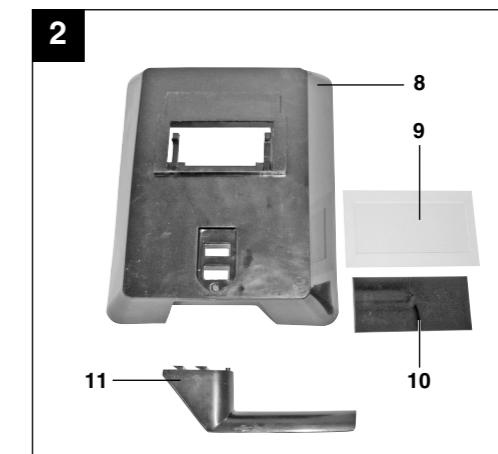
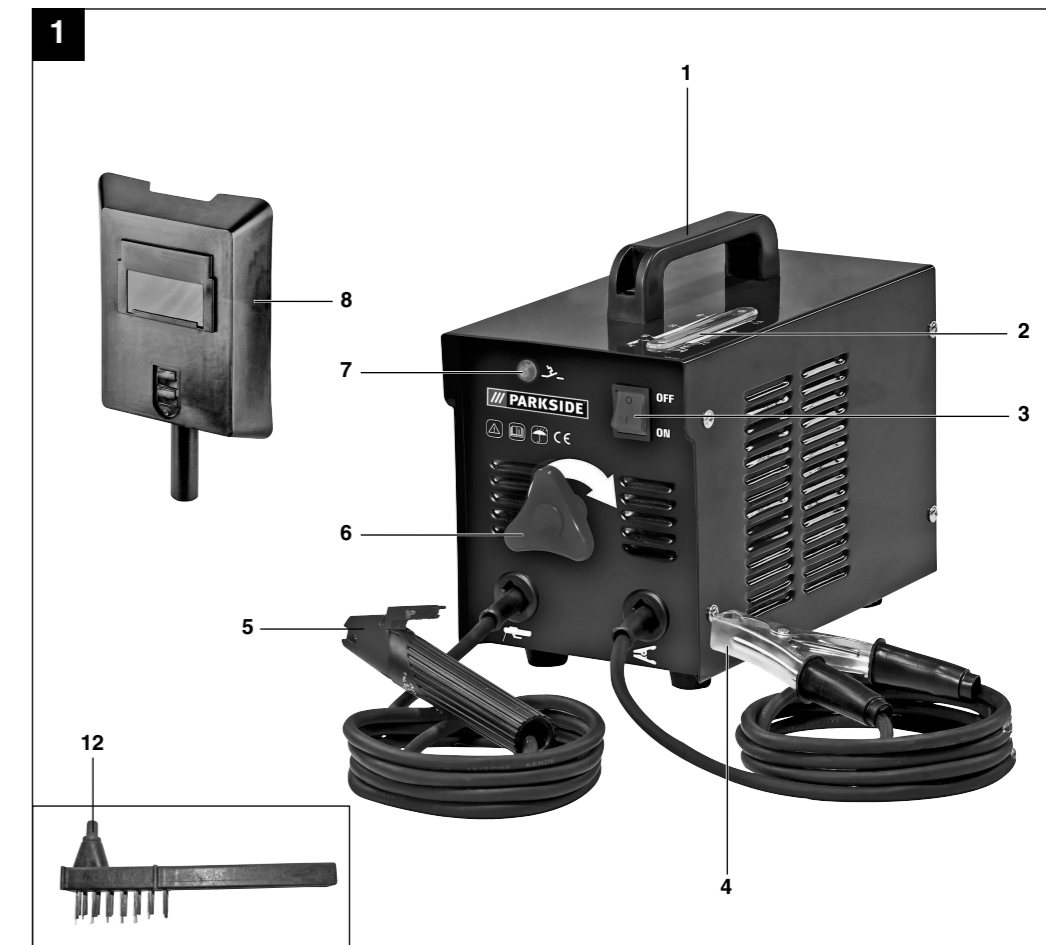

IAN: 70383 PESG 120 A1  
Einhell Germany AG  
Wiesenweg 22  
D-94405 Landau/Isar

Last Information Update · Információk állása · Stanje informacij · Stav informací  
Stav informácií · Stan informací · Stand der Informationen: 11/2011  
Ident.-No.: 15.490.53 112011 - 4

4

4

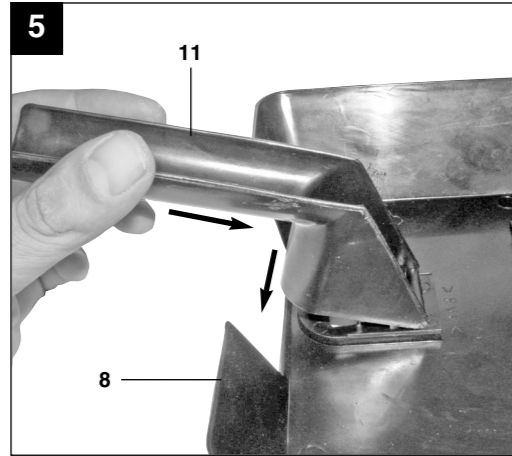
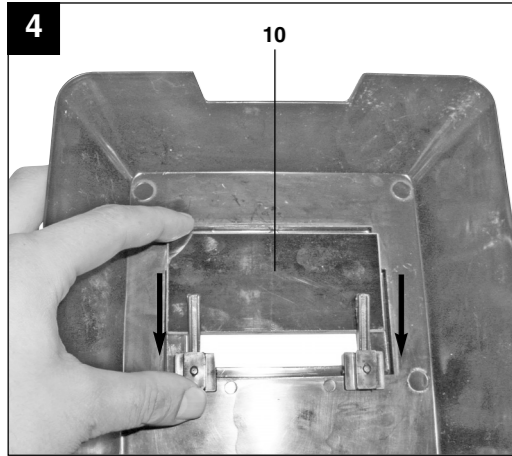

Table of contents:	Page
1. Introduction .....	6
2. Layout and items supplied .....	6
3. Important information .....	6-9
4. Symbols and technical data .....	9
5. Assembling the welding screen .....	10
6. Welding preparations .....	10
7. Welding .....	10
8. Overheating guard .....	10
9. Transport .....	10
10. Maintenance .....	11
11. Ordering spare parts .....	11
12. Disposal and recycling .....	11
13. Circuit diagram .....	12
14. Declaration of conformity .....	13
15. Guarantee certificate .....	14



Read and follow the operating instructions and safety information before using for the first time.

The reprinting or reproduction by any other means, in whole or in part, of documentation and papers accompanying products is permitted only with the express consent of ISC GmbH.

Technical changes subject to change

## 1. Introduction

### ⚠ Important!

When using the equipment, a few safety precautions must be observed to avoid injuries and damage. Please read the complete operating manual with due care. Keep this manual in a safe place so that the information is available at all times. If you give the equipment to any other person, give them these operating instructions as well. We cannot accept any liability for damage or accidents which arise due to a failure to follow these instructions and the safety information.

## 2. Layout and items supplied (Fig. 1/2)

1. Carry handle
2. Welding current scale
3. ON/OFF switch
4. Earth terminal
5. Electrode holder
6. Adjustment wheel for welding current
7. Warning lamp for overheating
8. Welding screen
9. Safety glass
10. Welding glass
11. Welding screen holder
12. Wire brush / slag hammer

## 3. Important information

The equipment is to be used only for its prescribed purpose. Any other use is deemed to be a case of misuse. The user / operator and not the manufacturer will be liable for any damage or injuries of any kind caused as a result of this.

Please note that our equipment has not been designed for use in commercial, trade or industrial applications. Our warranty will be voided if the equipment is used in commercial, trade or industrial businesses or for equivalent purposes.

## 1. Introduction

Please read the operating instructions carefully and observe the information provided. It is important to consult these instructions in order to acquaint yourself with the equipment, its proper use and safety information.

### ⚠ Safety information

Please note

#### Warning!

Use this equipment only for the purpose for which it is designed, as described in these instructions: Manual arc welding with coated electrodes. Handling this system incorrectly may be hazardous for persons, animals and property and may result in burning buildings, electric shocks, eye injuries, etc. The user of this system is responsible for his/her own safety and for the safety of others. Read these operating instructions and follow all the information.

- Repairs and/or maintenance work must be left strictly to qualified personnel.
- Only use the welding cables supplied (H07RN-F 3x1.5 mm<sup>2</sup> / H01N2-D 1x10 mm<sup>2</sup>).
- Ensure that the equipment is looked after properly.
- To ensure that sufficient air can be drawn in through the ventilation slits, the equipment should not be constricted or placed next to a wall while it is operating. Make sure that the equipment is correctly connected to the mains supply (see 4.). Do not subject the mains lead to any tensile stress. Unplug the equipment before you change its position.
- Check the condition of the welding cables, the electrode holder and the earth terminals; wear on the insulation and the live parts may result in dangerous conditions and reduce the quality of the welding work.
- Arc welding generates sparks, molten metal particles and smoke, so the following is required: Remove all inflammable substances and/or materials from the working area.
- Ensure that there is adequate ventilation.
- Do not weld on tanks, vessels or pipes that have contained inflammable liquids or