

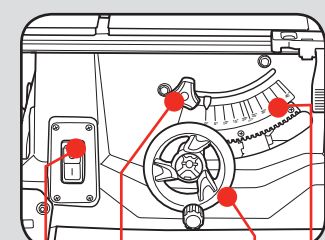

# KNOW YOUR PRODUCT

## TABLE SAW

- |                         |                                     |
|-------------------------|-------------------------------------|
| 1. Side table extension | 10. Guide rail                      |
| 2. Rear table extension | 11. Table insert                    |
| 3. Sliding mitre gauge  | 12. Rip fence lever                 |
| 4. Dust extractor hose  | 13. ON/OFF switch                   |
| 5. Blade guard          | 14. Bevel lock                      |
| 6. Rip fence            | 15. Blade height & Bevel adjustment |
| 7. Support strut        | 16. Bevel scale                     |
| 8. Stabilising bracket  |                                     |
| 9. Push stick           |                                     |

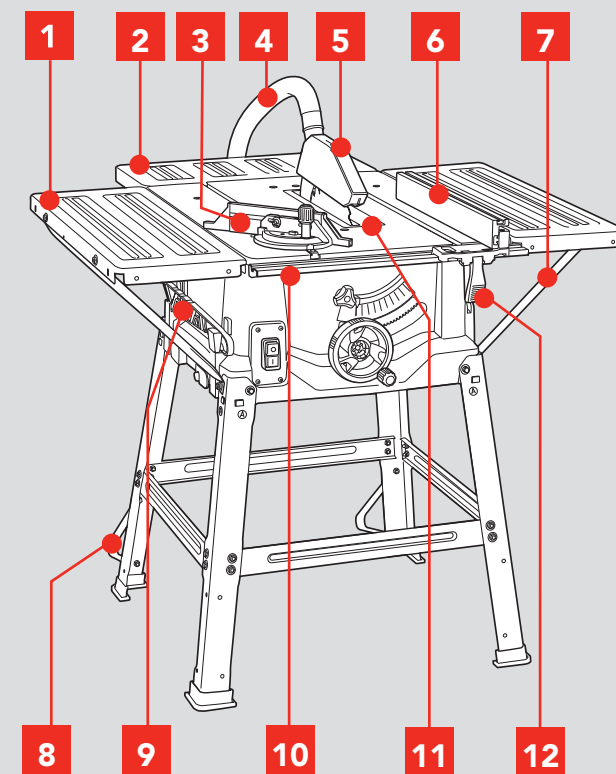

### ONLINE MANUAL

Scan this QR Code with your mobile device to take you to the online manual.



# SETUP & PREPARATION

## 1. ADJUSTMENTS

For detailed assembly instruction see Assembly Manual.

**WARNING!** ENSURE THE TOOL IS SWITCHED OFF AND DISCONNECTED FROM THE POWER SUPPLY BEFORE PERFORMING ANY OF THE FOLLOWING PROCEDURES.

### Cutting Depth

- To lower the blade for a smaller depth of cut, rotate the blade height & bevel adjustment clockwise.
- To raise the blade for a larger depth of cut, rotate the blade height & bevel adjustment anti-clockwise.

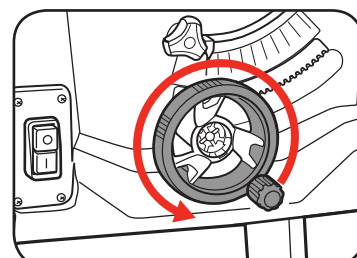
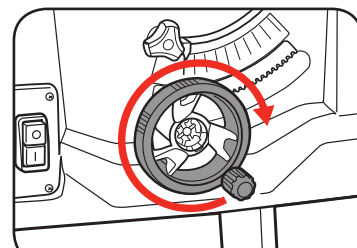

### Bevel Angle

- Loosen the bevel lock by rotating anti-clockwise.
- Push and hold the blade height & bevel adjustment dial in to engage the bevel gear.

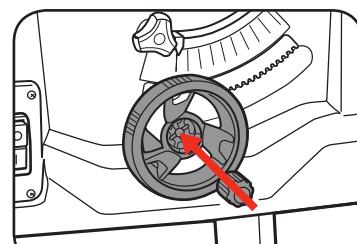
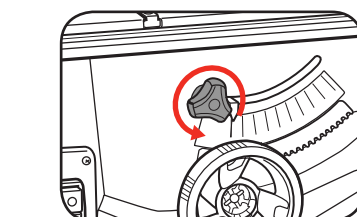

- Rotate the blade height & bevel adjustment to the desired angle using the bevel scale.

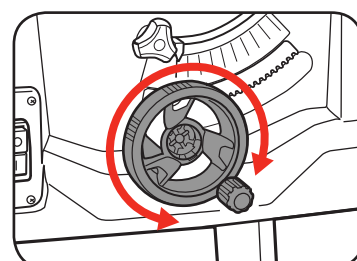

- Release the blade height & bevel adjustment dial, secure in place by rotating the bevel lock clockwise.

## 2. SETTING THE RIP FENCE

### Rip Fence Stop Height

The rip fence supplied with the table saw has two different guide faces. 1 for thick material and 1 for thin material.

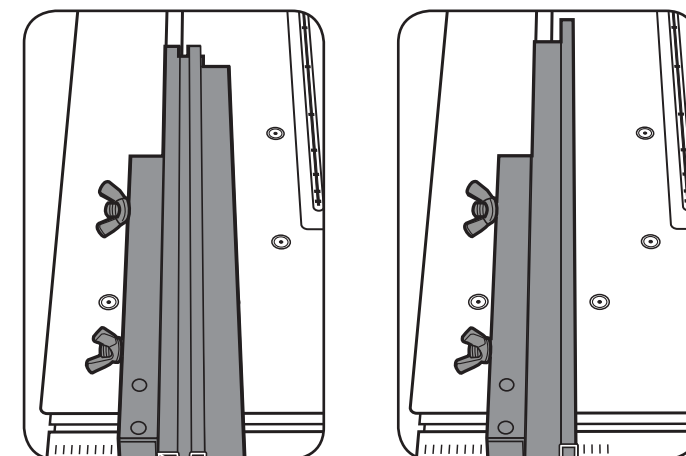

Thin Material

Thick Material

- To change the stop rail, loosen the 2 wing nuts.

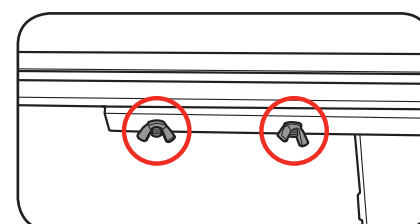

- Slide the stop rail off and re-insert the desired rail.

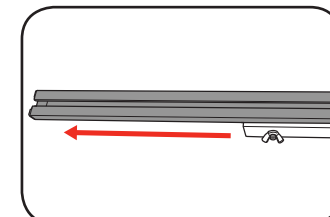

- Tighten the 2 wing nuts to lock in place.

### Rip Fence Cutting Width

The rip fence has to be used when making longitudinal cuts in wooden work pieces.

The rip fence can be mounted on either side of the saw table.

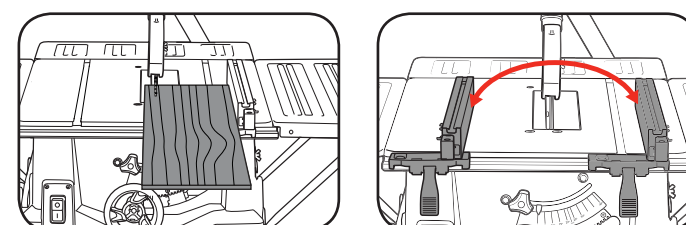

## 3. SETTING THE MITRE GAUGE

### Using the Sliding Mitr Gauge

The sliding mitre gauge can be fitted into 1 of the 2 grooves in the table and can be used to easily perform mitre angle cuts.

- Loosen the rip fence lever and insert the fence into the table guide rail.
- Slide the rip fence to the desired dimension using the scale of the guide rail.
- Tighten the rip fence lever to lock the rip fence in position.

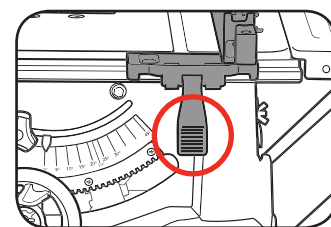
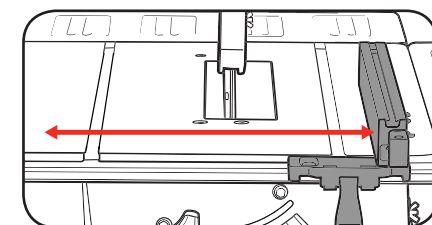
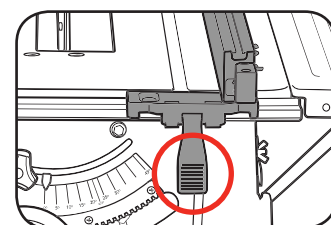

### Setting the Stop Length

The stop rail can be moved in a longitudinal direction in order to prevent the workpiece from becoming jammed.

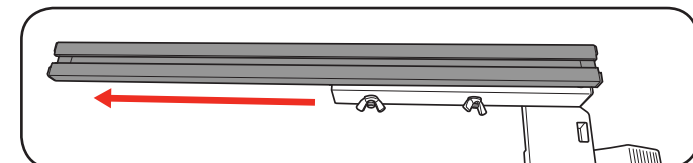

**Note:** Rule of thumb: The rear end of the stop comes up against an imaginary line that begins roughly at the centre of the blade and runs at an angle of 45° to the rear.

- Set the required cutting width.
- Loosen the wing nuts and push the stop rail forward until it touches the imaginary 45° line.
- Retighten the wing nuts.

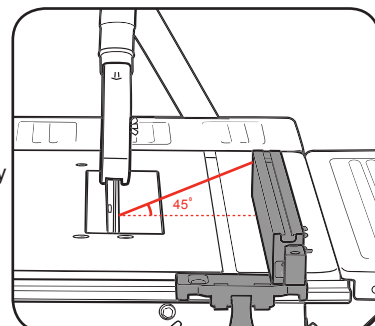

## 4. USING THE TABLE SAW

### Using the Sliding Mitr Gauge

The sliding mitre gauge can be fitted into 1 of the 2 grooves in the table and can be used to easily perform mitre angle cuts.

- Slide the rail of the mitre gauge into 1 of the 2 grooves of the table.
- Loosen the knurled screw to adjust the mitre angle.
- Rotate the mitre gauge to the desired angle using the mitre scale.
- Lock the mitre angle by tightening the knurled screw.

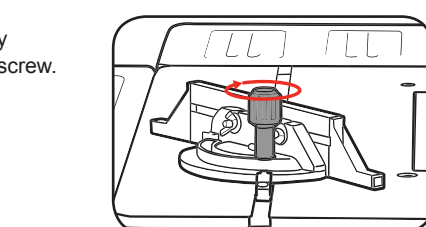
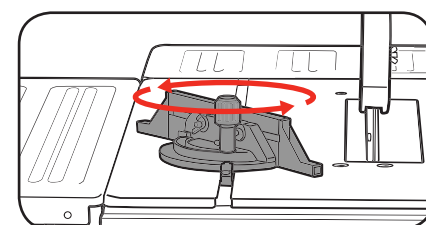
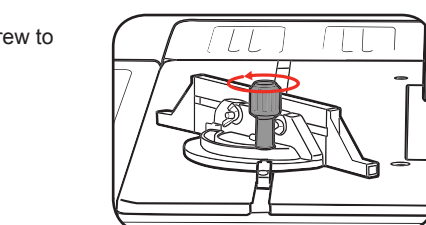
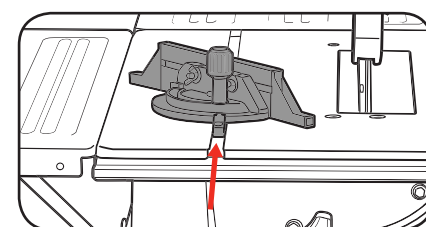

**IMPORTANT!** DO NOT PUSH THE MITRE GAUGE STOP RAIL TOO FAR TOWARD THE BLADE. THE DISTANCE BETWEEN THE STOP RAIL AND THE BLADE SHOULD BE APPROX. 20MM.

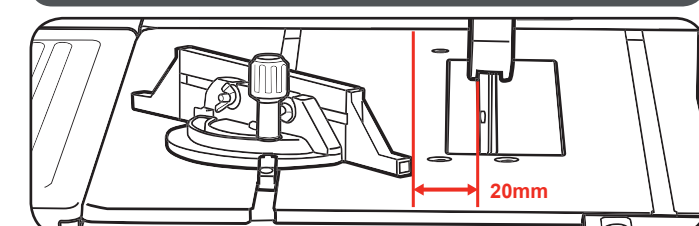

# OPERATION

## 4. USING THE TABLE SAW

**CAUTION!** TO REDUCE THE RISK OF ELECTRICAL SHOCK, THE USE OF A RESIDUAL CURRENT DEVICE (RATED 30mA OR LESS) IS RECOMMENDED.

### On / Off Switch

- To turn the saw ON, press the green button "I".
- To turn the saw OFF, press the red button "0".

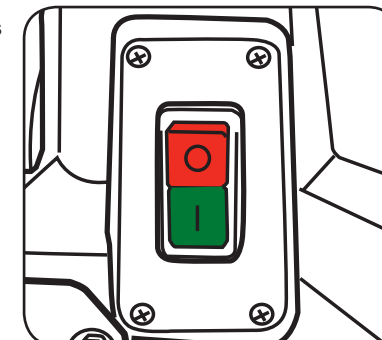

### Blade Guard

- The blade guard must be able to move freely, adjust if necessary (refer to Assembly Manual).

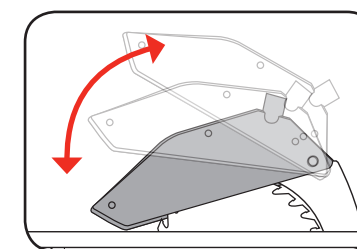

**IMPORTANT!** THE BLADE GUARD MUST ALWAYS BE LOWERED OVER THE WORK PIECE AND MOUNTED SECURELY BEFORE YOU BEGIN TO CUT.

**IMPORTANT!** AFTER EVERY NEW ADJUSTMENT WE RECOMMEND YOU TO MAKE A TRIAL CUT IN ORDER TO CHECK THE NEW SETTINGS.

## 5. MAKING A CUT

### Making Longitudinal Cuts / Ripping

Press one edge of the workpiece against the rip fence while the flat side lies on the saw table. The blade guard must always be lowered over the workpiece.

When you make a longitudinal cut, never adopt a working position that is in line with the cutting direction.

- Set the rip fence in accordance with the workpiece height and the desired width. (See **Stop Height, Cutting Width**).
- Switch on the saw by pressing the ON button "I".
- Place your hands (with fingers closed ensuring they will be clear of the blade) flat on the workpiece and push the workpiece along the rip fence and into the blade.
- Guide at the side with your left or right hand (depending on the position of the rip fence) only as far as the front edge of the blade guard.
- Always push the workpiece through to the end of the riving knife.
- The off cut piece remains on the saw table until the blade is back in its position of rest.
- Secure long work pieces against falling off at the end of the cut (e.g. with a roller stand etc.).

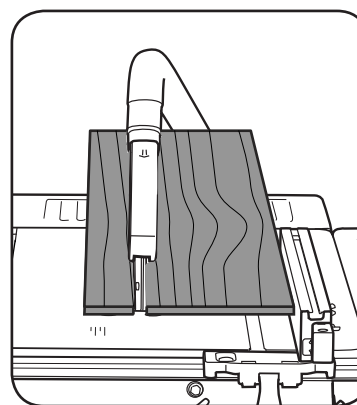
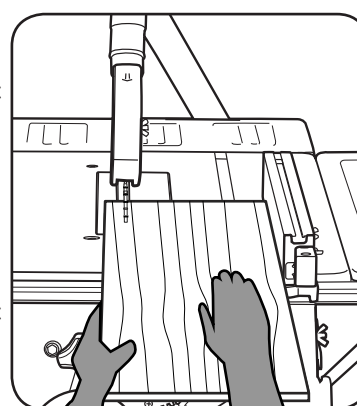

### Cutting Narrow Work Pieces

**IMPORTANT!** BE SURE TO USE A PUSH STICK WHEN MAKING LONGITUDINAL CUTS.

Be sure to use a push stick when making longitudinal cuts in work pieces smaller than 120mm in width. A push stick is supplied with the saw.

Replace a worn or damaged push stick immediately.

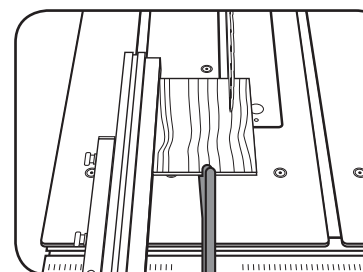

### Making Bevel Cuts

Bevel cuts must always be done using the rip fence.

- Set the blade to the desired angle. (See **Setting the Bevel Angle**)
- Set the rip fence in accordance with the workpiece width and height (see **Stop Height**)
- Carry out the cut in accordance with the workpiece width.

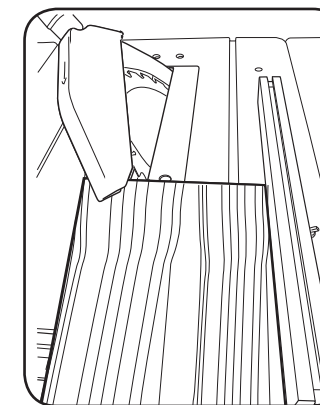

### Making Cross Cuts

- Slide the sliding mitre gauge into one of the grooves in the table and adjust to the required angle (see **Sliding Mitr Gauge**).

**IMPORTANT!** DO NOT PUSH THE MITRE GAUGE STOP RAIL TOO FAR TOWARD THE BLADE. THE DISTANCE BETWEEN THE STOP RAIL AND THE BLADE SHOULD BE APPROX. 20MM.

- Press the workpiece firmly against the sliding mitre gauge.
- Switch on the saw by pressing the ON button "I".
- Push the sliding mitre gauge and the workpiece toward the blade in order to make the cut.
- Push the sliding mitre gauge forward until the workpiece is cut all the way through.
- Switch off the saw again. Do not remove the off-cut until the blade has stopped rotating.

