

# STAPLE/ NAIL SELECTION

	Common Applications for Staple Length
5/16" (8mm)	Insulation, Upholstery, Weather Stripping, Wall Decorations, Crafts, Covering Cornices, Webbing, Light Fabrics.
3/8" (10mm)	Insulation, Carpeting, Wire Mesh, Plastic or Canvas Coverings, Roofing Paper, Felt Stripping, Weather Stripping.
1/2" (12mm)	Insulation, Carpet Underlay, Porch Screens, Picture Frames, Wire Mesh, Netting, Roofing Paper, Panelling.
9/16" (14mm)	Ceiling Tile, Heavy Insulation, Insulation Board, Trellises, Roofing, Carpeting.
	<b>Common applications: C1 Brads</b>
9/16" (15mm)	Trim Moulding, Panelling, Picture Frames, Model Work, Any Finish Nailing Application.

## TYPE 53 STAPLE SIZE

The SNG-2050U accepts staples with the below measurements

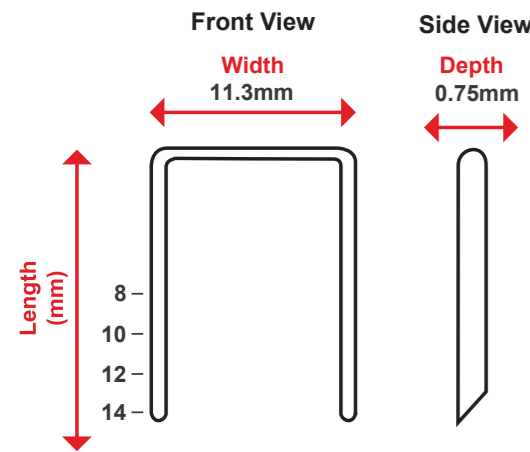

## 18 GAUGE C1 BRAD NAIL SIZE

The SNG-2050U accepts nails with the below measurements

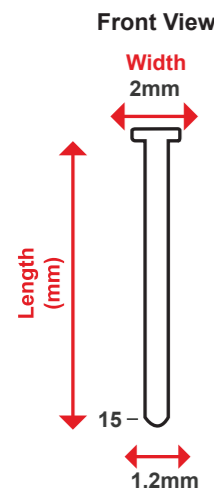

# MAINTENANCE

- When not in use, the staple nail gun should be stored in a dry, frost free location, keep out of children's reach.
- If the housing of the staple nail gun requires cleaning, do not use solvents. Use of a cloth only is recommended. Never immerse any part of the staple nail gun into liquid.

**Note:** Ozito Industries will not be responsible for any damage or injuries caused by repair of the staple nail gun by an unauthorised person or by mishandling.

# DESCRIPTION OF SYMBOLS

V	Volts	Hz	Hertz
ac/~	Alternating current	W	Watts
ga	Gauge		Read instruction manual
/min	Impacts per minute		Wear eye protection
	Warning		

# SPARE PARTS

Spare parts can be ordered from the Special Orders Desk at your local Bunnings Warehouse or Homebase store.

For further information, or any parts visit

[www.ozito-diy.co.uk](http://www.ozito-diy.co.uk) or contact Ozito Customer Service:

Great Britain: 0151 294 4488

Ireland: 1850 882711

E-mail: [enquires@ozito-diy.co.uk](mailto:enquires@ozito-diy.co.uk)

# ELECTRICAL SAFETY

**WARNING!** When using mains-powered tools, basic safety precautions, including the following, should always be followed to reduce risk of fire, electric shock, personal injury and material damage.  
Read the whole manual carefully and make sure you know how to switch the tool off in an emergency, before operating the tool.  
Save these instructions and other documents supplied with this tool for future reference.  
Before you connect the charger to the mains supply make sure that the data on the rating plate are identical to the mains data.

This tool is double insulated; therefore no earth wire is required.

If the supply cord is damaged, it must be replaced by an electrician or a power tool repairer in order to avoid a hazard.

**Note:** Double insulation does not take the place of normal safety precautions when operating this tool. The insulation system is for added protection against injury resulting from a possible electrical insulation failure within the tool.

### Using an Extension Lead

Always use an approved extension lead suitable for the power input of this tool. Before use, inspect the extension lead for signs of damage, wear and ageing. Replace the extension lead if damaged or defective. When using an extension lead on a reel, always unwind the lead completely. Use of an extension lead not suitable for the power input of the tool or which is damaged or defective may result in a risk of fire and electric shock.

# GENERAL POWER TOOL SAFETY WARNINGS - PERSONAL SAFETY

**WARNING!** Read all safety warnings and all instructions. Failure to follow the warnings and instructions may result in electric shock, fire and/or serious injury. Save all warnings and instructions for future reference. The term "power tool" in the warnings refers to your mains-operated (corded) power tool or battery-operated (cordless) power tool.

- Work area safety**
  - Keep work area clean and well lit. Cluttered or dark areas invite accidents.
  - Do not operate power tools in explosive atmospheres, such as in the presence of flammable liquids, gases or dust. Power tools create sparks which may ignite the dust or fumes.
  - Keep children and bystanders away while operating a power tool. Distractions can cause you to lose control.
- Electrical safety**
  - Power tool plugs must match the outlet. Never modify the plug in any way. Do not use any adapter plugs with earthed (grounded) power tools. Unmodified plugs and matching outlets will reduce risk of electric shock.
  - Avoid body contact with earthed or grounded surfaces, such as pipes, radiators, ranges and refrigerators. There is an increased risk of electric shock if your body is earthed or grounded.
  - Do not expose power tools to rain or wet conditions. Water entering a power tool will increase the risk of electric shock.
  - Do not abuse the cord. Never use the cord for carrying, pulling or unplugging the power tool. Keep cord away from heat, oil, sharp edges or moving parts. Damaged or entangled cords increase the risk of electric shock.
  - When operating a power tool outdoors, use an extension cord suitable for outdoor use. Use of a cord suitable for outdoor use reduces the risk of electric shock.
  - If operating a power tool in a damp location is unavoidable, use a residual current device (RCD) protected supply. Use of an RCD reduces the risk of electric shock.
- Personal safety**
  - Stay alert, watch what you are doing and use common sense when operating a power tool. Do not use a power tool while you are tired or under the influence of drugs, alcohol or medication. A moment of inattention while operating power tools may result in serious personal injury.
  - Use personal protective equipment. Always wear eye protection. Protective equipment such as dust mask, non-skid safety shoes, hard hat, or hearing protection used for appropriate conditions will reduce personal injuries.
  - Prevent unintentional starting. Ensure the switch is in the off-position before connecting to power source and/or battery pack, picking up or carrying the tool. Carrying power tools with your finger on the switch or energising power tools that have the switch on invites accidents.
- Remove any adjusting key or wrench before turning the power tool on. A wrench or a key left attached to a rotating part of the power tool may result in personal injury.
- Do not overreach. Keep proper footing and balance at all times. This enables better control of the power tool in unexpected situations.
- Dress properly. Do not wear loose clothing or jewellery. Keep your hair, clothing and gloves away from moving parts. Loose clothes, jewellery or long hair can be caught in moving parts.
- If devices are provided for the connection of dust extraction and collection facilities, ensure these are connected and properly used. Use of dust collection can reduce dust-related hazards.
- Power tool use and care**
  - Do not force the power tool. Use the correct power tool for your application. The correct power tool will do the job better and safer at the rate for which it was designed.
  - Do not use the power tool if the switch does not turn it on and off. Any power tool that cannot be controlled with the switch is dangerous and must be repaired.
  - Disconnect the plug from the power source and/or the battery pack from the power tool before making any adjustments, changing accessories, or storing power tools. Such preventive safety measures reduce the risk of starting the power tool accidentally.
  - Store idle power tools out of the reach of children and do not allow persons unfamiliar with the power tool or these instructions to operate the power tool. Power tools are dangerous in the hands of untrained users.
  - Maintain power tools. Check for misalignment or binding of moving parts, breakage of parts and any other condition that may affect the power tool's operation. If damaged, have the power tool repaired before use. Many accidents are caused by poorly maintained power tools.
  - Keep cutting tools sharp and clean. Properly maintained cutting tools with sharp cutting edges are less likely to bind and are easier to control.
  - Use the power tool, accessories and tool bits etc. in accordance with these instructions, taking into account the working conditions and the work to be performed. Use of the power tool for operations different from those intended could result in a hazardous situation.
- Service**
  - Have your power tool serviced by a qualified repair person using only identical replacement parts. This will ensure that the safety of the power tool is maintained.

# STAPLE NAIL GUN SAFETY WARNINGS

- Always assume that the tool contains fasteners. Careless handling of the nailer or stapler can result in unexpected firing of fasteners and personal injury.
- Do not point the tool towards yourself or anyone nearby. Unexpected triggering will discharge the fastener causing an injury.
- Do not actuate the tool unless the tool is placed firmly against the workpiece. If the tool is not in contact with the workpiece, the fastener may be deflected away from your target.
- Disconnect the tool from the power source when the fastener jams in the tool. While removing a jammed fastener, the nailer or stapler may be accidentally activated if it is plugged in.
- Do not use this nailer or stapler for fastening electrical cables. It is not designed for electric cable installation and may damage the insulation of electric cables thereby causing electric shock or fire hazards.

# ozito

## ELECTRIC STAPLE NAIL GUN

**8MM - 14MM**

**ORIGINAL INSTRUCTIONS**

### SPECIFICATIONS

Input:	230-240V ~ 50Hz
Power:	45W
Impact Rate:	30/min
Staple Size:	8-14mm, Type 53
Nail Size:	15mm, C1 Brad
Magazine Capacity:	80 Pcs
Weight:	0.73kg

[ozito-diy.co.uk](http://ozito-diy.co.uk)

**3 YEAR REPLACEMENT WARRANTY**

## WHAT'S IN THE BOX

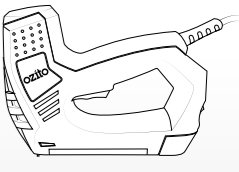

Staple Nail Gun



Staples x 1500



Nails x 100

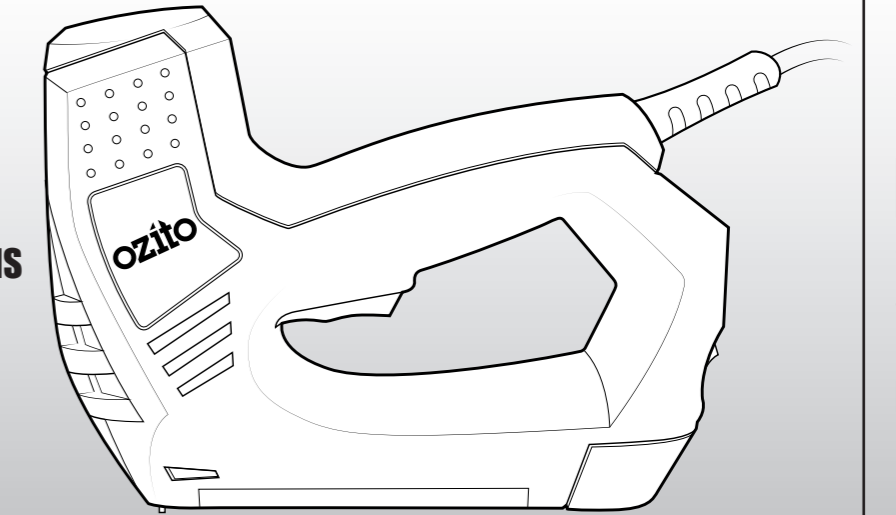

## WARRANTY

All of our products undergo strict quality checks to ensure that they reach you in perfect condition. In the unlikely event that your device develops a fault, please contact our service department at the address shown on this guarantee card. You can also contact us by telephone using the customer service number shown. Please note the following terms under which guarantee claims can be made:

1. These warranty terms regulate additional warranty services, which the manufacturer mentioned below promises to buyers of its new products in addition to their statutory guarantee claims are not affected by this guarantee. Our guarantee is free of charge to you.

2. The warranty services only covers defects due to material or manufacturing faults on a product which you have bought from the manufacturer mentioned below are limited to either the rectification of said defects on the product or the replacement of the product, whichever we prefer. Please note that our devices are not designed for use in commercial, trade or professional applications. A guarantee contract will not be created if the device has been used by commercial, trade or industrial business or has been exposed to similar stresses during the guarantee period.

3. The following are not covered by our guarantee:  
- Damage to the device caused by a failure to follow the assembly instructions or due to incorrect installation, a failure to follow the operating instructions (for example connecting it to an incorrect mains voltage or current type) or a failure to follow the maintenance and safety instructions or by exposing the device to abnormal environmental conditions or by lack of care and maintenance.  
- Damage to the device caused by abuse or incorrect use (for example overloading the device or the use of unapproved tools or accessories), ingress of foreign bodies into the device (such as sand, stones or dust, transport damage), the use of force or damage caused by external forces (for example by dropping it).

- Damage to the device or parts of the device caused by normal or natural wear or tear or by normal use of the device.

4. Your Product is guaranteed for a period of 36 months from the original date of purchase and is intended for DIY (Do It Yourself) use only. Lithium Ion batteries and chargers are covered by a 12 month warranty. Warranty excludes consumable parts, for example: staples and nails. Guarantee claims should be submitted before the end of the guarantee period within two weeks of the defect being noticed. No guarantee claims will be accepted after the end of the guarantee period. The original guarantee period remains applicable to the device even if repairs are carried out or parts are replaced. In such cases, the work performed or parts fitted will not result in an extension of the guarantee period, and no new guarantee will become active for the work performed or parts fitted. This also applies if an on-site service is used.

IN ORDER TO MAKE A CLAIM UNDER THIS WARRANTY YOU MUST RETURN THE PRODUCT TO THE PLACE OF PURCHASE WITH YOUR REGISTER RECEIPT.

Please refer to the restrictions of this warranty concerning wearing parts, consumables and missing parts as set out in the service information in these operating instructions.

CUSTOMER SERVICE HELPLINE  
GB: 0151 294 4488  
IRL: 1850 882711  
[Ozito-diy.co.uk](http://Ozito-diy.co.uk)

# KNOW YOUR PRODUCT

## ELECTRIC STAPLE NAIL GUN

- |                      |                    |
|----------------------|--------------------|
| 1 Safety Striker Pin | 5 Sure Grip Handle |
| 2 Nose Piece         | 6 Magazine Latch   |
| 3 Magazine Window    | 7 On/Off Switch    |
| 4 Trigger            | 8 Power Cord       |

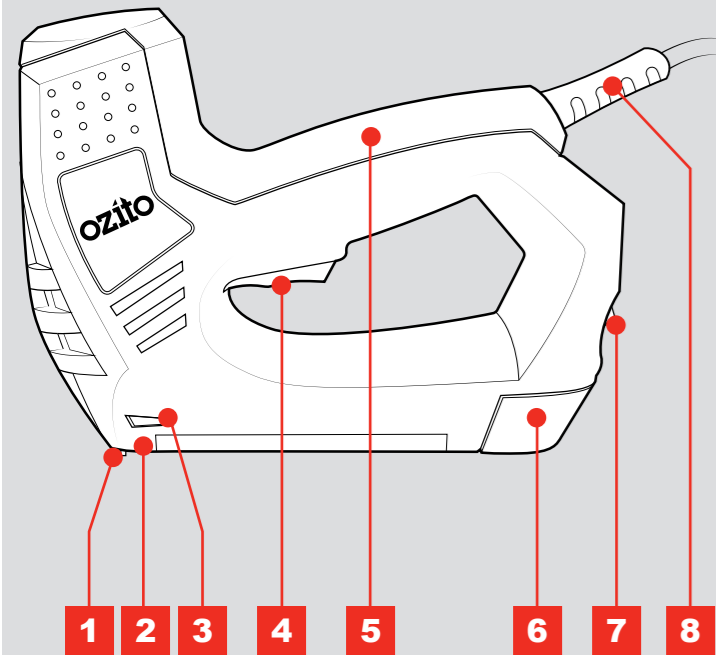

## ACCESSORIES

- |                  |                |
|------------------|----------------|
| 9 Staples x 1500 | 10 Nails x 100 |
|------------------|----------------|

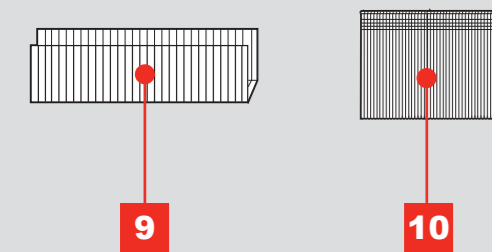

## ONLINE MANUAL

Scan this QR Code with your mobile device to take you to the online manual.



# SETUP & PREPARATION

## 1. LOADING STAPLES

This staple nailer only accepts Type 53 staples. Other types of staples, including paper staples, will jam the unit.

**CAUTION!** ENSURE THE TOOL IS SWITCH OFF AND DISCONNECTED FROM THE POWER SUPPLY BEFORE PERFORMING THE FOLLOWING PROCEDURES.

- 1 Hold the tool upside down.

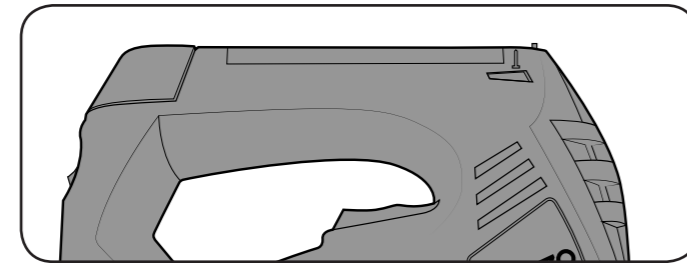

- 2 Squeeze the magazine latches on either side of the tool and pull the magazine out of the tool.

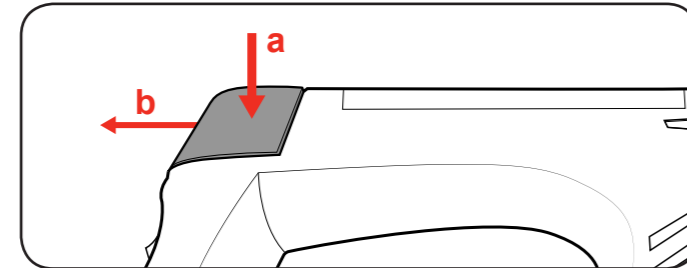

- 3 Insert a row of staples into the opening behind the nose piece.

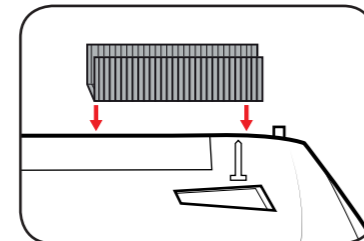

**Note:** Rows of staples longer than 120mm do not fit in the staple nail gun.

- 4 Push the loaded magazine back into the unit until it clips into place.

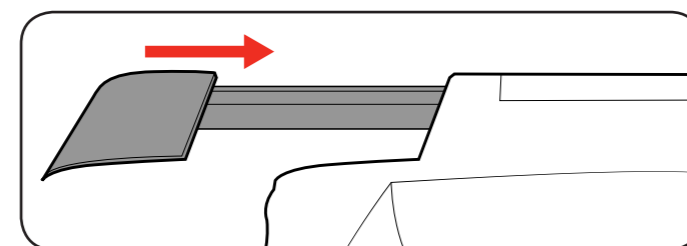

## 2. LOADING NAILS

This staple nailer only accepts 18 Gauge C1 Brad nails up to 15mm in length. Other types of nails will jam the unit.

- 1 Hold the tool upside down.

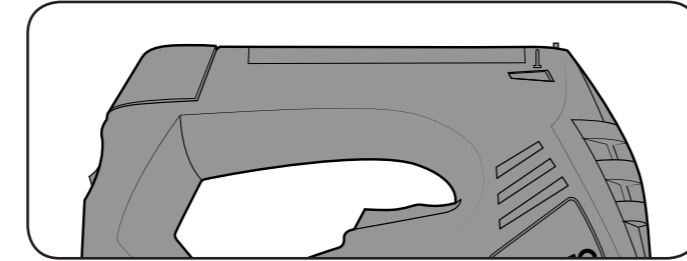

- 2 Squeeze the magazine latches on either side of the tool and pull the magazine out of the tool.

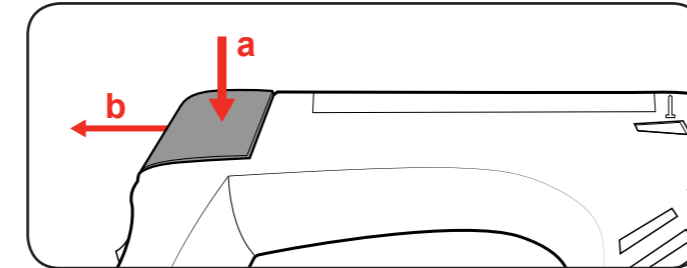

- 3 Insert a row of nails into the opening behind the nose piece. Be sure to align them to the side marked with a nail marker so that the nail head is against the internal groove.

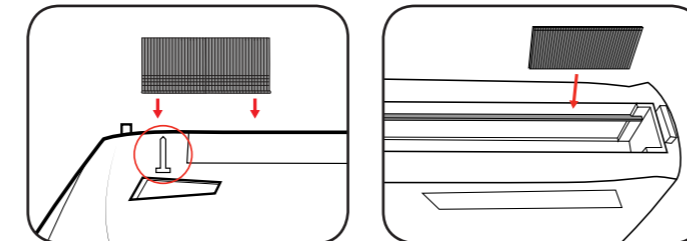

- 4 Push the loaded magazine back into the unit until it clips into place.

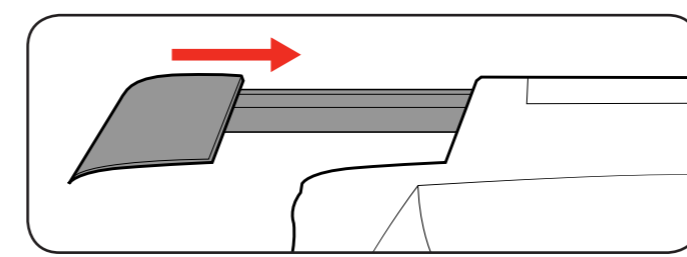

# OPERATION

## 4. OPERATING THE STAPLE NAIL GUN

### Firing a Staple or Nail

A staple or nail will only fire when the trigger is pressed if the safety striker pin is pushed against the material to be fastened.

- 1 Switch the on/off switch into the on position.

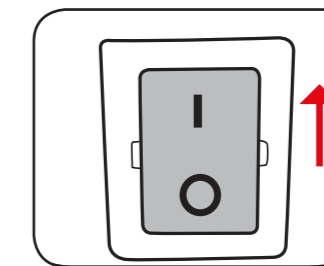

- 2 Place the staple nail gun against the work surface so that the nosepiece of the tool is where you want the staple/nail to be located. Push the safety striker pin and nosepiece down onto the surface to be fastened.

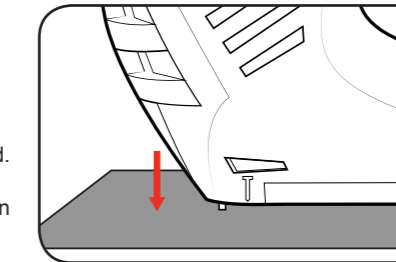

- 3 To fire the staple nail gun, squeeze the trigger.

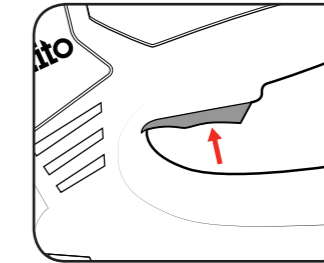

## 3. CONTROLS

**CAUTION!** THE POWER SUPPLY FOR THIS PRODUCT SHOULD BE PROTECTED BY A RESIDUAL CURRENT DEVICE (RATED AT 30MA OR LESS).

### Switching On and Off

- 1 To supply the tool with power, push the power switch to the "I" position.

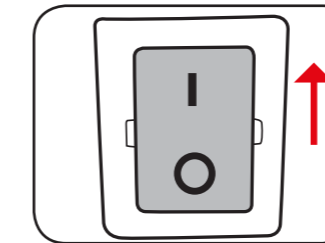

- 2 To turn off, push the power switch to the "O" position.

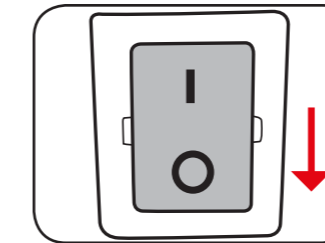

## 5. TROUBLESHOOTING

### Jammed Staple Nail Gun

- 1 Squeeze the magazine latches on either side of the tool and pull the magazine out of the tool.

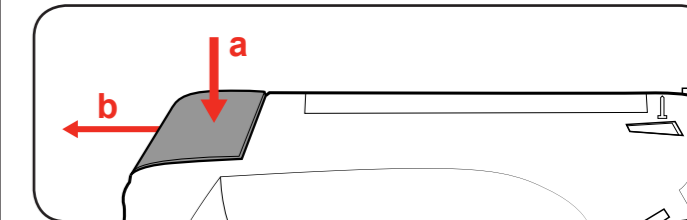

- 2 Using a pair of pliers, remove any jammed staples or nails.

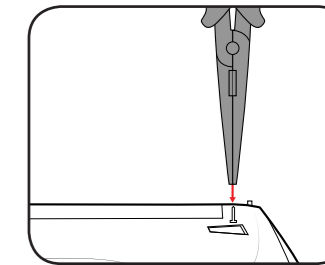

**Note:** Be careful not to bend the end of the magazine. If this occurs the unit will be inoperable.

- 3 With the magazine still open, tap the safety striker pin against a surface to dislodge any loose staples.

