

KNOW YOUR PRODUCT

ROTARY HAMMER DRILL

- 1 SDS-Plus Accessory Holder
- 2 Accessory Locking Sleeve
- 3 Depth Rod Locking Hole
- 4 Side Handle
- 5 Side Mode Selector
- 6 Grease Cap
- 7 Rear Mode Selector
- 8 On/Off Switch
- 9 Rear Handle

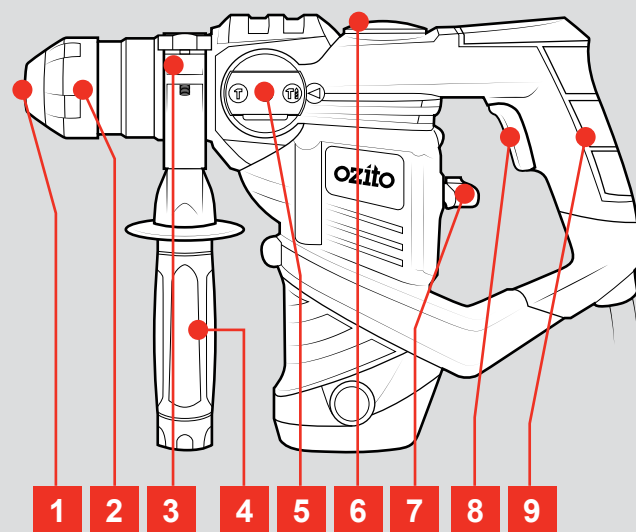

ACCESSORIES

- 10 Depth Rod
- 11 3 x SDS-Plus 150mm Drill Bits
- 12 1 x SDS-Plus Flat Chisel 14 x 250mm
- 13 1 x SDS-Plus Point Chisel 14 x 250mm
- 14 Dust Cover
- 15 Pin Spanner

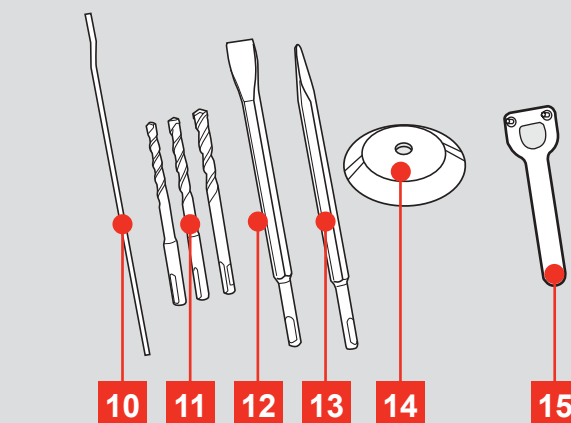

ONLINE MANUAL

Scan this QR Code with your mobile device to take you to the online manual.

SETUP & PREPARATION

1. BEFORE USE

Items Supplied

Please check that the article is complete as specified in the scope of delivery. If parts are missing, please contact our service center or the sales outlet where you made your purchase at the latest within 5 working days after purchasing the product and upon presentation of a valid bill of purchase. Also, refer to the warranty table in the service information at the end of the operating instructions.

- Open the packaging and take out the equipment with care.
- Remove the packaging material and any packaging and/or transportation braces (if available).
- Check to see if all items are supplied.
- Inspect the equipment and accessories for transport damage.
- If possible, please keep the packaging until the end of the guarantee period.

Danger!

The equipment and packaging material are not toys. Do not let children play with plastic bags, foils or small parts. There is a danger of swallowing or suffocating!

Proper Use

The tool is designed for drilling with hammer action in concrete, rock and brick, as well as for chiselling work, always using the respective correct drill or chisel bit.

The equipment is to be used only for its prescribed purpose. Any other use is deemed to be a case of misuse. The user / operator and not the manufacturer will be liable for any damage or injuries of any kind caused as a result of this.

Please note that our equipment has not been designed for use in commercial, trade or industrial applications. Our warranty will be voided if the machine is used in commercial, trade or industrial businesses or for equivalent purposes.

Caution!

Residual risks

Even if you use this electric power tool in accordance with instructions, certain residual risks cannot be ruled out. The following hazards may arise in connection with the equipment's construction and layout:

1. Lung damage if no suitable protective dust mask is used.
2. Damage to hearing if no suitable ear protection is used.
3. Health damage caused by hand-arm vibrations if the equipment is used over a prolonged period or is not properly guided and maintained.

2. USING THE DEPTH ROD

WARNING! ENSURE THE TOOL IS DISCONNECTED FROM THE POWER SUPPLY BEFORE PERFORMING ANY OF THE FOLLOWING OPERATIONS.

The depth rod allows you to drill to a predetermined depth.

- 1 Loosen the depth rod securing nut then insert depth rod.

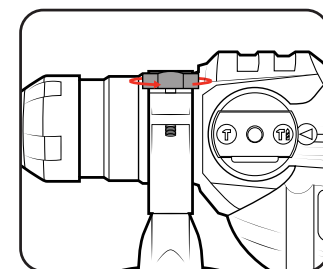

- 2 Adjust the depth rod so the drill bit extends beyond the end of the depth rod to the required drilling depth.

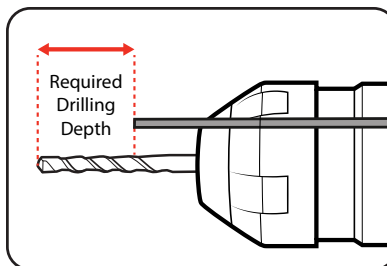

- 3 Tighten the depth rod securing nut to lock the depth rod into place.

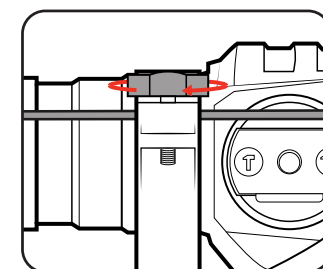

- 4 Drill the hole until the end of the depth rod touches the workpiece.

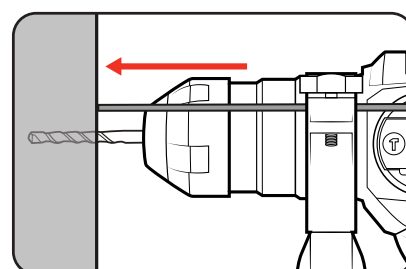

3. SDS-Plus ACCESSORIES



- 1 Prior to insertion into chuck, ensure the SDS-Plus accessory is clear of dust and debris.

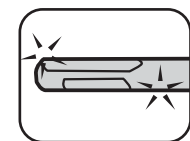

- 2 Prior to insertion into drill add supplied lubricant to the SDS-Plus accessory.



- 3 Pull locking sleeve back and hold.

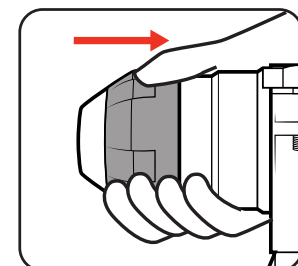

- 4 Insert SDS-Plus Accessory.

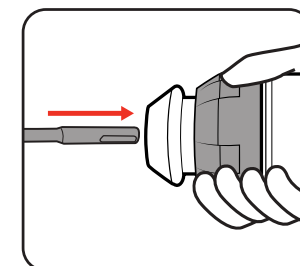

- 5 Rotate and continue to insert as far as possible.

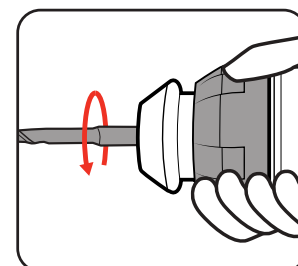

- 6 Release locking sleeve.

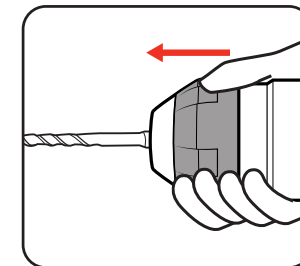

- 7 Checked SDS-Plus accessory is locked. Try to pull it out. Note: It should have approx 10 – 20mm movement. This is normal.

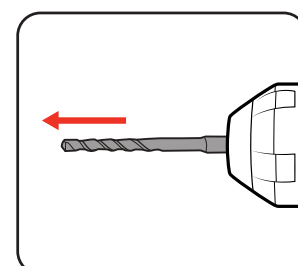

- 8 To remove the SDS-Plus accessory pull back the locking sleeve and pull accessory out.

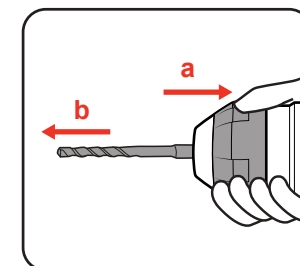

4. FITTING AND USING THE DUST COVER

The cover catches dust and debris - while using the drill upright or overhead - to avoid dust entering the air vents.

- 1 Slide dust cover over accessory.

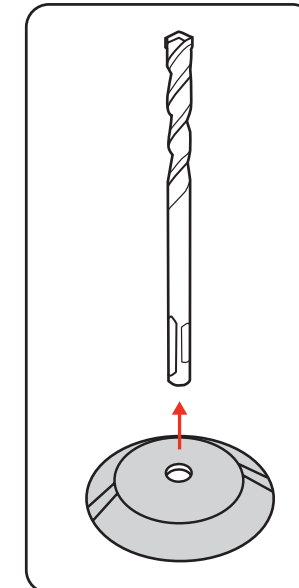

- 2 Add lubrication grease.

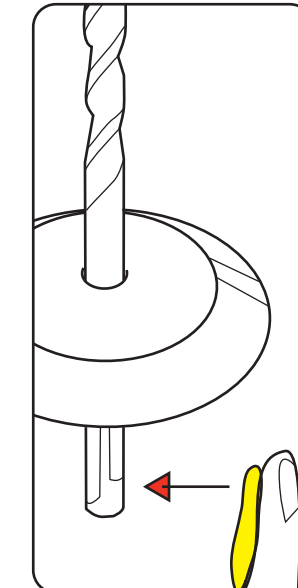

- 3 Insert drill bit in locking sleeve.

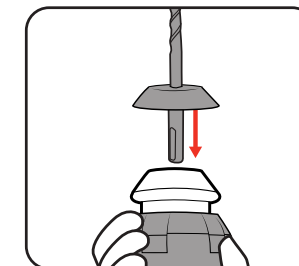

- 4 Press dust cover to the end of locking sleeve.

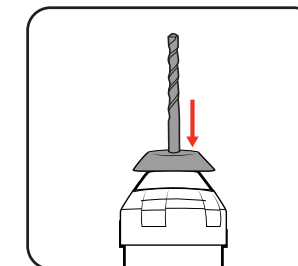

OPERATION

5. OPERATING THE HAMMER DRILL

1. Choose an operation mode:

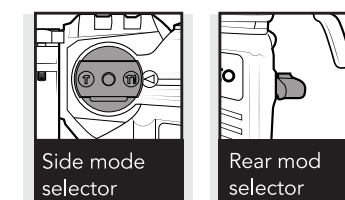

Hammer Drill

Rotate the side mode selector to the hammer and drill icon, and rotate the rear mode selector to the drill and hammer icon. This setting is recommended for use when drilling holes in concrete and other masonry products. The hammer action will be in operation while simultaneously the drill bit rotates.

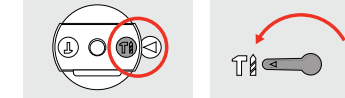

Chiselling

Rotate the side mode selector to the hammer icon, and rotate the rear mode selector to the drill and hammer icon. This setting is recommended for use when you desire a hammer action without the accessory rotating which is ideal for "chiselling or chipping" away at masonry products, pick or chisel accessory bits should be used.

Note: In chiselling mode, the drill bit is fixed in position and cannot be rotated.

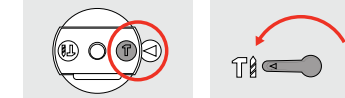

Drilling

Rotate the side mode selector to the hammer and drill icon, and rotate the rear mode selector to the drill icon. This setting is recommended for use when you desire the accessory to rotate without hammer action. Ideal for drilling into timber or steel when correct accessories for such materials are used.

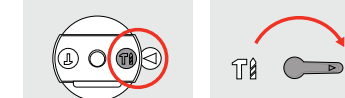

- 2 Ensure your workpiece is securely clamped where possible.
- 3 Connect the tool to the mains power supply.

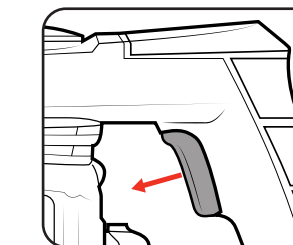
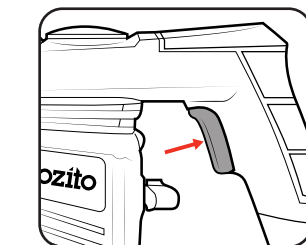

- 4 To start drilling squeeze the On/Off switch.

- 5 To stop drilling release the On/Off switch.

NOTE: PRIOR TO CHANGING MODES, THE ON/OFF SWITCH SHOULD BE RELEASED AND THE DRILL SHOULD HAVE COME TO A COMPLETE STOP.