

CLEANING PROCEDURE

If coating material was water based (acrylic paint), use **ONLY** water when performing the cleaning procedure. Use of solvent based cleaning materials on water based paints will result in a new substance that will be extremely difficult to clean.

If coating material was oil based (enamel paint, lacquer etc.) use **ONLY** the appropriate cleaning solution. Read the cleaning instructions printed on the coating material's label to determine which cleaning material you need. The following solvent based cleaning products are safe to use in the paint sprayer:

- Diggers Easy Cleanup Turpentine Substitute (highly recommended)
- Mineral Turpentine
- Paint Thinner

- 1 Empty the paint pot of remaining material.
- 2 Rinse paint pot, suction tube & nozzle with cleaning solution. Wipe all parts with a clean cloth.

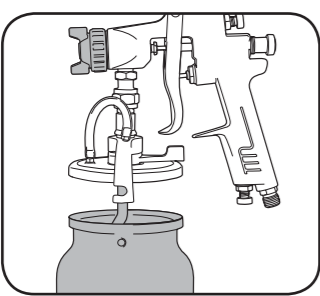
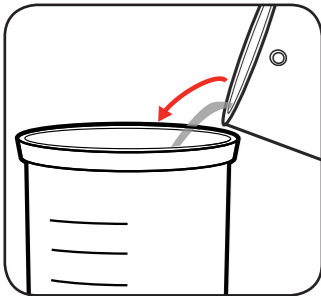

- 3 Fill paint pot with appropriate cleaning solution.
- 4 Connect the spray gun to the air supply then spray solution into a bucket.

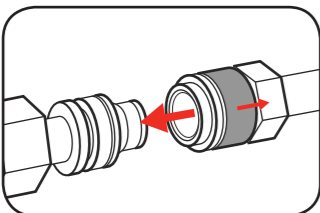
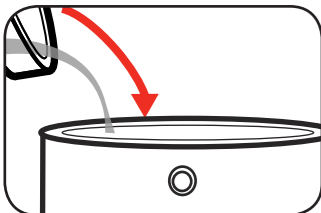

5 Repeat steps 3-4 until the cleaning solution runs clear from gun.

- 6 Unscrew and remove fluid adjustment dial, needle & spring. Clean all parts in cleaning solution.
- 7 Unscrew and remove nozzle. Clean in cleaning solution.

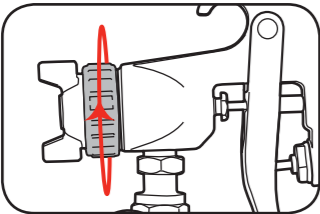
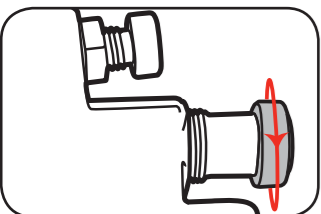

8 Take note of the 4 holes on the nozzle, if blocked clean carefully using a small needle.

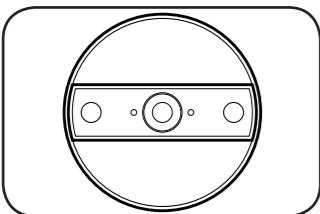

9 Dry all components and then re-assemble the spray gun.

TROUBLESHOOTING

PROBLEM	CAUSE	REMEDY
Little or no material flow	Fluid adjustment dial too limited	Turn fluid adjustment dial further out by rotating anti-clockwise
	Air pressure too low	Increase air pressure at the compressor
		Turn air regulator valve further out clockwise on gun
	Material too thick	Thin material
Material leaking	Nozzle clogged	Clean nozzle
	Nozzle loose	Tighten nozzle
	Nozzle worn	Contact Ozito for replacement spare parts
Spray pattern is heavy in the middle	Fan requires adjustment	Turn fan adjustment dial further out anti-clockwise
	Air pressure too low	Increase air pressure at the compressor
		Turn air regulator valve further out clockwise on gun
Spray pattern heavy at the edges	Fan requires adjustment	Turn fan adjustment dial in clockwise
	Air pressure too high	Reduce air pressure at the compressor
		Turn air regulator valve further in clockwise on gun
Spray jet pulsates	Material in paint pot running out	Refill paint pot
	Nozzle clogged	Clean nozzle
	Material too thick	Thin material
Pattern runs or sags	Too much material is being applied	Turn fluid adjustment dial further in clockwise
		Increase spray speed
	Material is too thin	Thicken material by adding more paint
Too much overspray	Gun too far from the spray surface	Reduce distance & turn fluid adjustment dial further in clockwise to reduce the amount of paint being applied.
	Material is too thick	Thin the material
Pattern is very light and splotchy	Material is too thick	Thin the material
	Moving the spray gun to fast	Decrease spray speed

SPARE PARTS

Spare parts can be ordered from the **Special Orders Desk** at your local **Bunnings Warehouse** or **Homebase** store.

For further information, or any parts visit

www.ozito-diy.co.uk or contact **Ozito Customer Service:**

Great Britain: 0151 294 4488

Ireland: 1850 882711

E-mail: enquires@ozito-diy.co.uk

GENERAL AIR TOOL SAFETY WARNINGS

WARNING! Read all safety warnings and all instructions. Failure to follow the warnings and instructions may result in electric shock, fire and/or serious injury.

Save all warnings and instructions for future reference. The term "power tool" in the warnings refers to your mains-operated (corded) power tool or battery-operated (cordless) power tool.

1. Work area safety
 - a. Keep work area clean and well lit. Cluttered or dark areas invite accidents.
 - b. Do not operate power tools in explosive atmospheres, such as in the presence of flammable liquids, gases or dust. Power tools create sparks which may ignite the dust or fumes.
 - c. Keep children and bystanders away while operating a power tool. Distractions can cause you to lose control.
 - d. Dress properly. Do not wear loose clothing or jewellery. Keep your hair, clothing and gloves away from moving parts. Loose clothes, jewellery or long hair can be caught in moving parts.
 - e. Check the maximum pressure rating of any tools or accessories that you intend using with the compressor. The output pressure of the air from the compressor must be regulated so that it never exceeds the rated pressure of the tool or accessory.
 - f. Always wear safety goggles or glasses when using the air compressor. Never point the nozzle of an accessory towards any part of your body or towards another person.
 - g. Use safety equipment including safety goggles or shield, ear protection, breathing or respirator mask and protective clothing.
 - h. The tool must be used only for its prescribed purpose. Any use other than those mentioned in this Manual will be considered a case of misuse. The user and not the manufacturer shall be liable for any damage or injury resulting from such cases of misuse.

WARNING! In the event that an air line is cut or broken, the air supply must be turned off at the compressor. A broken air line which is not supported is extremely dangerous and can whip around very quickly, both with the capability of striking people, and blowing foreign particles into the air.

- Do not attempt to catch the air line but immediately keep bystanders well clear and turn off the air supply to the hose, turn off the compressor at the On / Off button, and then remove the hose from the compressor.
- This appliance is not intended for use by persons (including children) with reduced physical, sensory or mental capabilities, or lack of experience and knowledge, unless they have been given the supervision or instruction concerning use of the appliance by a person responsible for their safety.
- Children should be supervised to ensure that they do not play with the appliance.

SPRAY GUN SAFETY WARNINGS

WARNING! This appliance is not intended for use by persons (including children) with reduced physical, sensory or mental capabilities, or lack of experience and knowledge, unless they have been given supervision or instruction concerning use of the appliance by a person responsible for their safety.

Using an Extension Hose

Always use an approved extension hose suitable for the air input of this tool. Before use, inspect the hose for signs of damage, wear and ageing. Replace the extension hose if damaged or defective.

When using an hose on a reel, always unwind the lead completely.

It is recommended that the hose is a maximum of 25m in length.

NEVER under any circumstances aim the nozzle at another person or animal.

- In the event of an injury occurring, seek medical advice immediately.
- The spray gun must not be used for spraying flammable paints and solvents with a flash point of less than 21°C.
- Always ensure there is adequate ventilation when spraying.
- The use of ear protection is recommended.
- Eye protection is recommended to keep hazardous vapours and liquids out of eyes.
- Always wear a face mask when spraying.
- Always read the paint manufacturers thinning instructions before using.
- Always keep the spray nozzle in place during use. Never allow the spray to come in direct contact with the skin.
- Never immerse the spray gun in liquid.

DESCRIPTION OF SYMBOLS

	Warning		Read instruction manual
	Wear ear protection		Wear eye protection and breathing mask
ml/min	Millilitres per minute	cfm	Cubic feet per minute

ozito

DELUXE SPRAY GUN

160-240 ml/min

ORIGINAL INSTRUCTIONS

SPECIFICATIONS

Working Air Pressure:	3.5Bar (50psi)
Max Air Pressure:	6Bar (87psi)
Av. Air Consumption:	85-226l/min (3-8cfm)
Nozzle Size:	ø1.8mm
Spray Width:	40-70mm
Flow Rate:	160-240ml/min
Feed Type:	Suction
Paint Pot Size:	1000ml
Air Inlet:	1/4" BSP
Weight (tool only):	0.84kg

ozito-diy.co.uk

3 YEAR REPLACEMENT WARRANTY

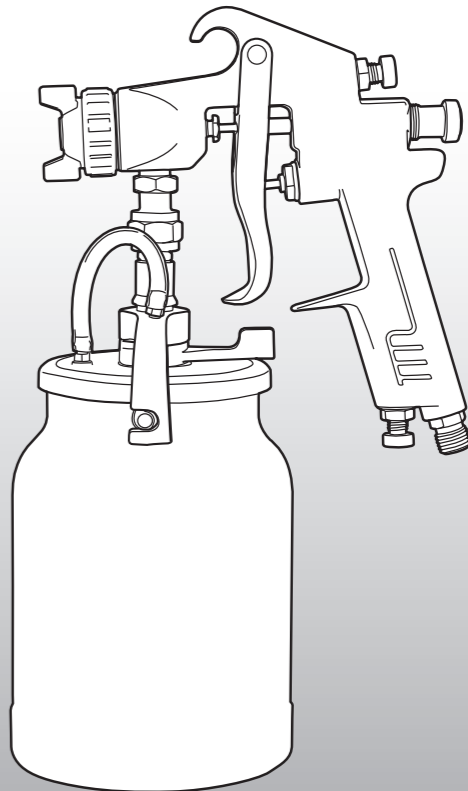

WHAT'S IN THE BOX



Spray Gun

WARRANTY

All of our products undergo strict quality checks to ensure that they reach you in perfect condition. In the unlikely event that your device develops a fault, please contact our service department at the address shown on this guarantee card. You can also contact us by telephone using the customer service number shown. Please note the following terms under which guarantee claims can be made:

1. These warranty terms regulate additional warranty services, which the manufacturer mentioned below promises to buyers of its new products in addition to their statutory guarantee claims are not affected by this guarantee. Our guarantee is free of charge to you.

2. The warranty services only covers defects due to material or manufacturing faults on a product which you have bought from the manufacturer mentioned below are limited to either the rectification of said defects on the product or the replacement of the product, whichever we prefer. Please note that our devices are not designed for use in commercial, trade or professional applications. A guarantee contract will not be created if the device has been used by commercial, trade or industrial business or has been exposed to similar stresses during the guarantee period.

3. The following are not covered by our guarantee:
- Damage to the device caused by a failure to follow the assembly instructions or due to incorrect installation, a failure to follow the operating instructions (for example connecting it to an incorrect mains voltage or current type) or a failure to follow the maintenance and safety instructions or by exposing the device to abnormal environmental conditions or by lack of care and maintenance.
- Damage to the device caused by abuse or incorrect use (for example overloading the device or the use of unapproved tools or accessories), ingress of foreign bodies into the device (such as sand, stones or dust, transport damage), the use of force or damage caused by external forces (for example by dropping it).

- Damage to the device or parts of the device caused by normal or natural wear or tear or by normal use of the device.

4. Your Product is guaranteed for a period of 36 months from the original date of purchase and is intended for DIY (Do It Yourself) use only. Lithium Ion batteries and chargers are covered by a 12 month warranty. Warranty excludes consumable parts. Guarantee claims should be submitted before the end of the guarantee period within two weeks of the defect being noticed. No guarantee claims will be accepted after the end of the guarantee period. The original guarantee period remains applicable to the device even if repairs are carried out or parts are replaced. In such cases, the work performed or parts fitted will not result in an extension of the guarantee period, and no new guarantee will become active for the work performed or parts fitted. This also applies if an on-site service is used.

IN ORDER TO MAKE A CLAIM UNDER THIS WARRANTY YOU MUST RETURN THE PRODUCT TO THE PLACE OF PURCHASE WITH YOUR REGISTER RECEIPT.

Please refer to the restrictions of this warranty concerning wearing parts, consumables and missing parts as set out in the service information in these operating instructions.

CUSTOMER SERVICE HELPLINE
GB: 0151 294 4488
IRL: 1850 882711
Ozito-diy.co.uk

KNOW YOUR PRODUCT

DELUX SPRAY GUN

- | | |
|----------------------------|-------------------------|
| 1 Nozzle | 6 Variable Trigger |
| 2 Nozzle Collar | 7 Air Regulator Valve |
| 3 Paint Pot | 8 Air Inlet |
| 4 Suction Tube Locking Nut | 9 Fluid Adjustment Dial |
| 5 Paint Pot Locking Lever | 10 Fan Adjustment Dial |

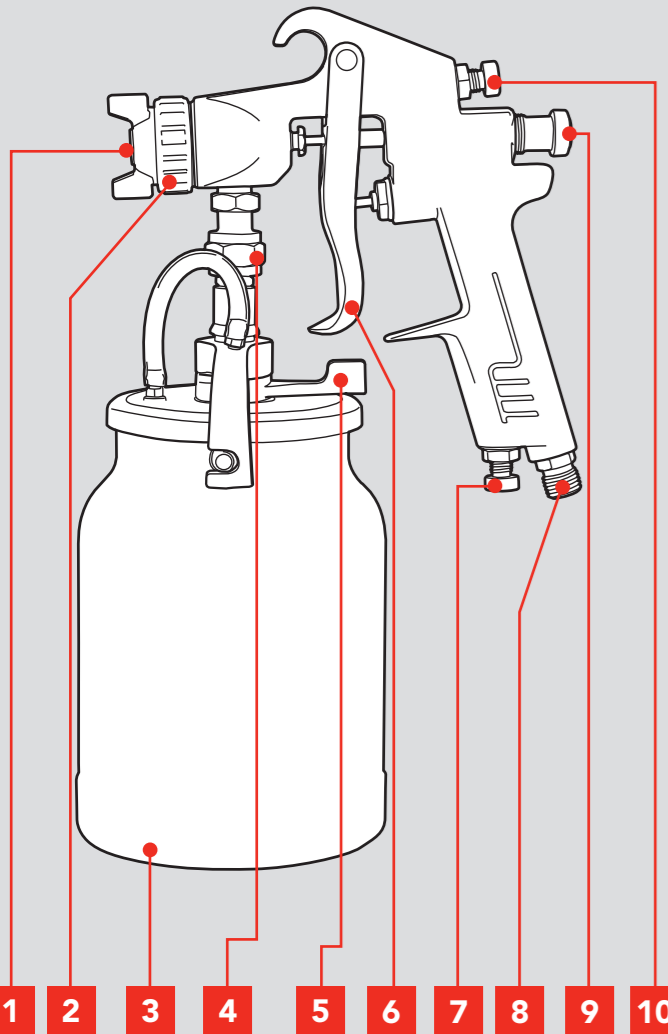

ONLINE MANUAL

Scan this QR Code with your mobile device to take you to the online manual.



SETUP & PREPARATION

1. ASSEMBLY

WARNING! ENSURE THE TOOL IS DISCONNECTED FROM THE AIR SUPPLY BEFORE PERFORMING ANY OF THE FOLLOWING OPERATIONS.

Installing the Paint Pot

- Slide the paint pot over the suction tube and align with the head.
- Tighten the paint pot locking lever.

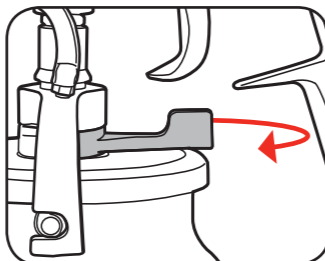
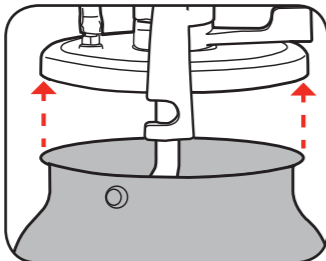

- To remove, simply undo the paint pot locking lever and remove the pot.

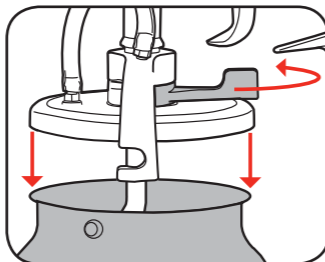

Attaching to Compressor

- Wrap the threaded male air inlet of the spray gun with teflon tape in a clockwise direction.
- Screw the female fitting clockwise onto the male end of the air inlet.

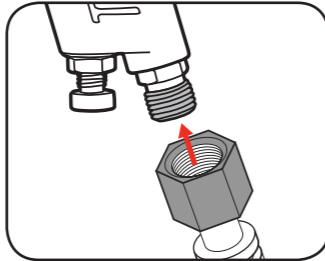
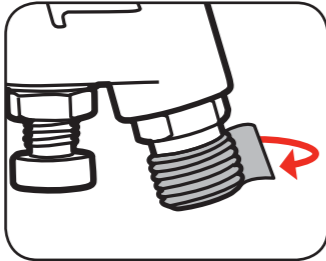

- Pull back the sleeve on hose fitting, insert male end & release sleeve on hose fitting.

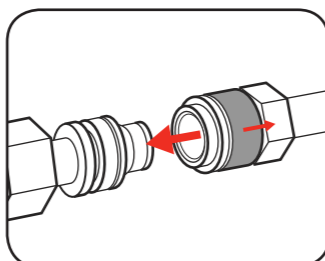

2. PREPARATION

NOTE: FOR BEST RESULTS, SURFACE PREPARATION AND PAINT THINNING ARE THE TWO MOST IMPORTANT AREAS. ENSURE ALL SURFACES ARE FREE OF DUST, DIRT AND GREASE.

Thinning

Thinning is particularly important when spraying. Most paints are supplied ready for brush application and need to be diluted sufficiently for spraying purposes. Follow the manufacturers guide for thinning ratios which should be labelled on the paint container.

- Before pouring any paint or thinners work out how much of each substance is needed.

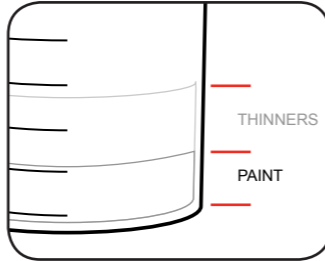

- Pour the required paint and thinners through a filter into a mixing cup and then mix thoroughly.

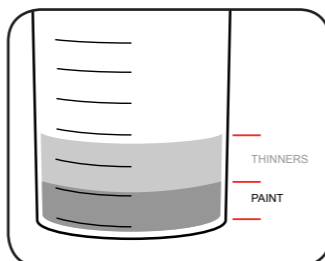

- Once the correct viscosity is obtained, pour the mixture into the paint pot.

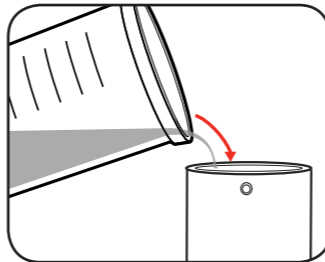

IMPORTANT! THE SPRAY GUN CANNOT BE USED WITH MATERIALS CONTAINING ABRASIVE SUBSTANCES, GLAZES, CAUSTIC AND ALKALINE SUBSTANCES.

OPERATION

3. ADJUSTING THE SPRAY GUN

Variable Trigger

- Squeeze the variable trigger to start spraying.
- Release the variable trigger to stop spraying.

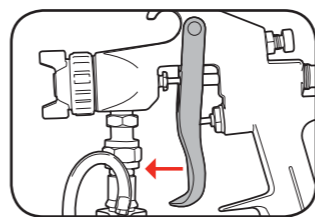
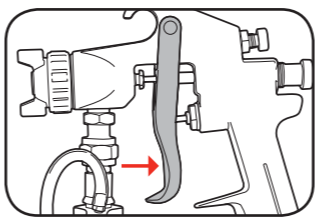

Note: The further the variable trigger is pressed, the more fluid will flow through the gun.

Fluid Adjustment Dial

The fluid adjustment dial is a stop that limits the distance the trigger can be pressed, thereby limiting the amount of paint being sprayed.

- Fully tighten the fluid adjustment dial.
- Slightly loosen the dial then test setting on a scrap piece of material.

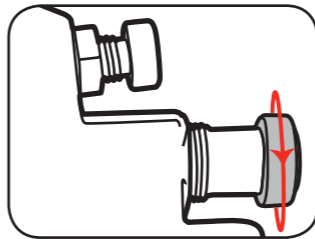
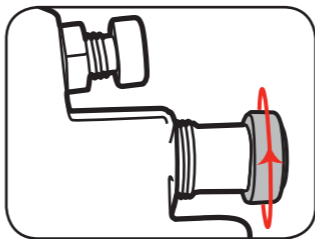

- Repeat step 2 until desired fluid output is reached.

Choosing Spray Patterns

- To change the spray pattern, loosen the nozzle collar and rotate the nozzle to the desired position. Tighten nozzle collar to secure nozzle in place.

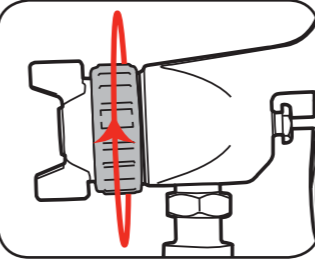

For vertical surfaces:

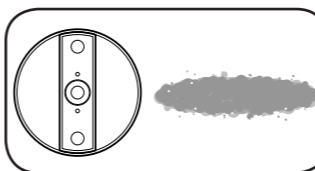

For horizontal surfaces:

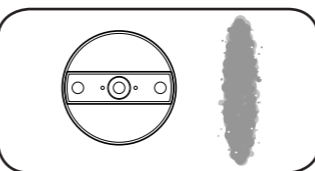

4. ADJUSTING THE SPRAY GUN CONT.

Fan Adjustment Dial

The fan adjustment dial controls the distribution of paint in the fan. Turned all the way clockwise, paint is concentrated in the centre of the fan. As the dial is turned anti-clockwise more paint is distributed toward the edges.

- Start with the fan adjustment dial completely loosened.
- Partly tighten the dial then test setting on a scrap piece of material.

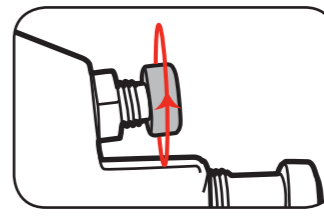
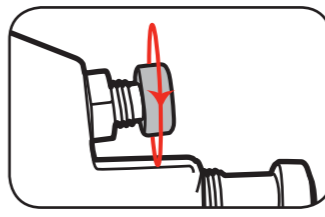

- Repeat step 2 until desired fan pattern is reached.

Air Regulator Valve

The air regulator valve controls the air pressure entering the gun.

- To restrict the air pressure entering the gun turn the valve clockwise.
- To increase air pressure entering the gun, turn the air valve anti-clockwise.

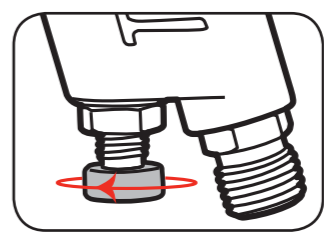
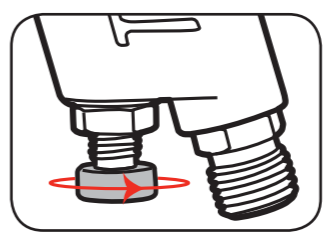

Adjusting the Suction Tube

- Loosen the suction tube locking nut then rotate suction tube to appropriate position.

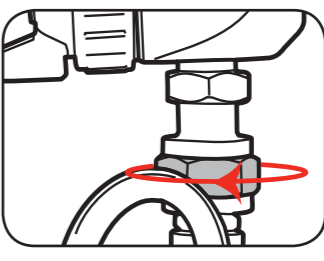

For a low workpiece:

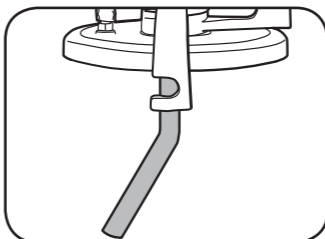

For a high workpiece:

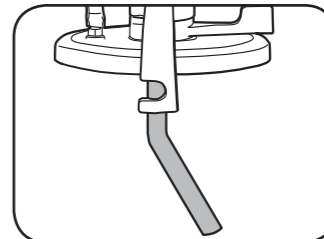

Ensure the suction tube locking nut is tightened after adjusting.

5. SPRAYING TECHNIQUE

- Move the gun with the entire arm, not by flexing the wrist. This will keep the spray gun at right angles to the surface, keeping the pattern even.

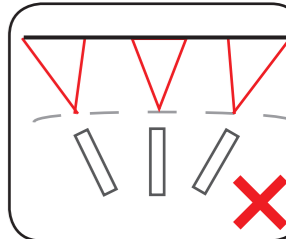
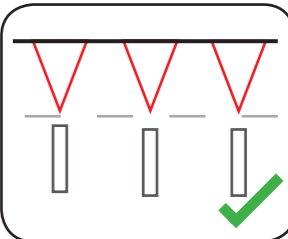

- Keep the spray gun perpendicular to the surface, so spray distance is consistent.

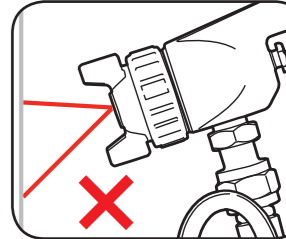
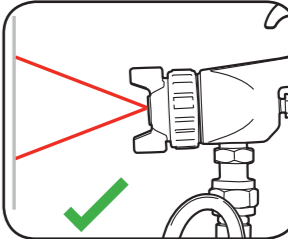

- Begin 15cm off the edge of the area being sprayed. Start the movement of the stroke before squeezing the trigger. Release trigger once passed the opposite edge of the workpiece.

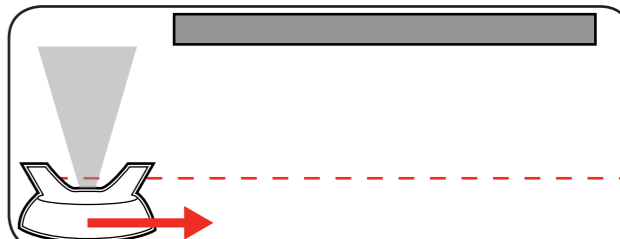

Helpful Hints

- Maintain the same distance from workpiece (approx 15cm) throughout each pass.
- Maintain the same speed throughout each pass.
- Always allow a coat to completely dry before adding another coat.
- Avoid stopping and starting in the middle of workpiece as this can lead to a patchy finish.
- Overlap each stroke by half the width of the previous stroke for even coverage.

NOTE: After each use it is essential that the spray gun is cleaned thoroughly. Failure to do so will likely cause blockages which will prevent the tool from working. FAILURE TO CLEAN THE TOOL WILL VOID THE WARRANTY.