

IMPORTANT!



For convenience and ease of assembly, the chain is pre-fitted over the guide bar with the cutters facing in the direction of rotation.

1. Carefully remove all packaging leaving the **Cable Ties** in place that secures bar and chain together.
2. Refer to the supplied User **Manual Assembly Instructions** for fitting the Guide Bar and Chain.
3. Once fitted to the chainsaw, remove all **Cable Ties** before adjusting the chain tension.

ALWAYS WEAR PROTECTIVE GLOVES WHEN HANDLING THE CHAIN. THE CHAIN CUTTERS ARE SHARP AND COULD CUT YOU.

Ensure the Chain Cutters are facing the direct of rotation whenever fitting the chain to the bar.





CHAINSAW

INSTRUCTION MANUAL

SPECIFICATIONS

Input:	18V
Bar Length:	250mm (10")
Cutting Length Max.:	230mm
Chain Speed Max.:	4.5m/s
Chain Pitch:	9.53mm (3/8")
Chain Gauge:	1.1mm (0.043")
Oil Tank Max.:	200ml max.
Weight:	3.0kg

ozito.com.au

5 YEAR
REPLACEMENT WARRANTY

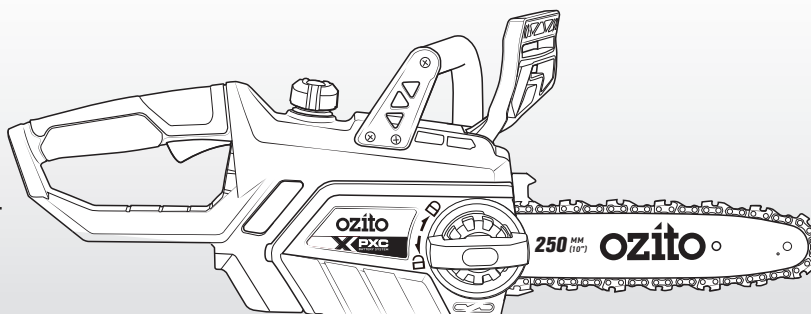

This product is intended for use by a competent trained person. This user manual is a guide only and should not be treated as a training manual.

- Please seek professional training before use.
- This product is designed for limbing of branches and or pruning of trees, cutting firewood and felling small trees while user is firmly footed on the ground.

STANDARD EQUIPMENT

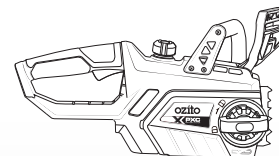

Chainsaw



Guide Bar & Chain



Guide Bar Cover

PXCSS-1825

WARRANTY

IN ORDER TO MAKE A CLAIM UNDER THIS WARRANTY YOU MUST RETURN THE PRODUCT TO YOUR NEAREST BUNNINGS WAREHOUSE WITH YOUR BUNNINGS REGISTER RECEIPT. PRIOR TO RETURNING YOUR PRODUCT FOR WARRANTY PLEASE TELEPHONE OUR CUSTOMER SERVICE HELPLINE:

Australia 1800 069 486

New Zealand 0508 069 486

TO ENSURE A SPEEDY RESPONSE PLEASE HAVE THE MODEL NUMBER AND DATE OF PURCHASE AVAILABLE. A CUSTOMER SERVICE REPRESENTATIVE WILL TAKE YOUR CALL AND ANSWER ANY QUESTIONS YOU MAY HAVE RELATING TO THE WARRANTY POLICY OR PROCEDURE.

WARNING

The following actions will result in the warranty being void.

- If the tool has been operated on a supply voltage other than that specified on the tool.
- If the tool shows signs of damage or defects caused by or resulting from abuse, accidents or alterations.
- Failure to perform maintenance as set out within the instruction manual.
- If the tool is disassembled or tampered with in any way.
- Professional, industrial or high frequency use.

The benefits provided under this warranty are in addition to other rights and remedies which are available to you at law.

Our goods come with guarantees that cannot be excluded at law. You are entitled to a replacement or refund for a major failure and for compensation for any other reasonably foreseeable loss or damage. You are also entitled to have the goods repaired or replaced if the goods fail to be of acceptable quality and the failure does not amount to a major failure.

Generally you will be responsible for all costs associated with a claim under this warranty, however, where you have suffered any additional direct loss as a result of a defective product you may be able to claim such expenses by contacting our customer service helpline above.

5 YEAR REPLACEMENT WARRANTY

Your Product is guaranteed for a period of 60 months from the original date of purchase and is intended for DIY (Do It Yourself) use only. If a product is defective it will be replaced in accordance with the terms of this warranty. **Lithium Ion batteries and chargers are covered by a 36 month warranty** Warranty excludes consumable parts, for example: guide bar, chain and included accessories.

KNOW YOUR PRODUCT

CHAINSAW

- | | |
|------------------------------|---------------------|
| 1. Rear Handle | 9. Guide Bar |
| 2. On/Off Trigger | 10.Chain |
| 3. Oil Level Window | 11.Bucking Spikes |
| 4. Side Cover | 12.Motor Cover |
| 5. Guide Bar Lock Knob | 13.Oil Tank Cap |
| 6. Front Handle/Carry Handle | 14.Lock-Off Button |
| 7. Chain Brake/Hand Guard | 15.Battery Seating |
| 8. Chain Tensioning Dial | 16.Guided Bar Cover |

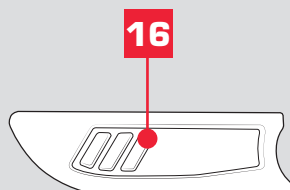
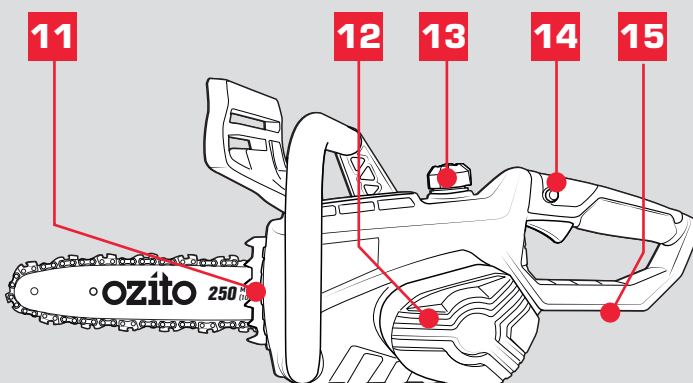
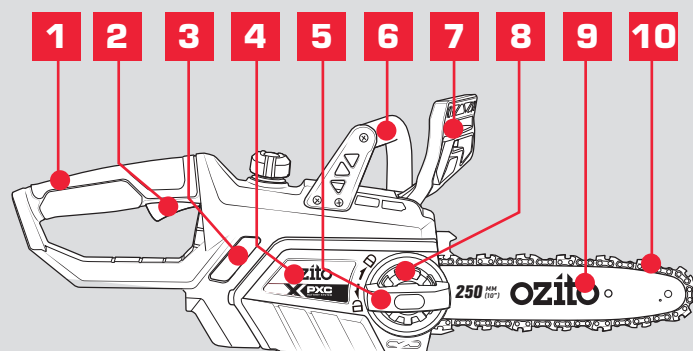

BATTERY & CHARGER

This tool is compatible with all battery and chargers from the Ozito PXC Range.

ONLINE MANUAL

Scan this QR Code with your mobile device to take you to the online manual.



5 YEAR
REPLACEMENT WARRANTY

SETUP & PREPARATION

1. ASSEMBLY

Fitting the Chain & Bar

WARNING! ENSURE THE CHAINSAW IS SWITCHED OFF AND THE BATTERY IS DISCONNECTED BEFORE PERFORMING ANY OF THE FOLLOWING TASKS.

WARNING! ALWAYS WEAR GLOVES WHEN HANDLING THE CHAIN. THE CHAIN CUTTERS ARE SHARP AND COULD CUT YOU.

For convenience and ease of assembly, the chain is pre-fitted over the guide bar with the cutters facing in the direction of rotation. Refer to the supplied A5 insert for further information before fitting the bar & chain for the first time.

1. Completely unscrew the guide bar lock knob, rotating in a counter clockwise direction.
2. Remove the side cover.

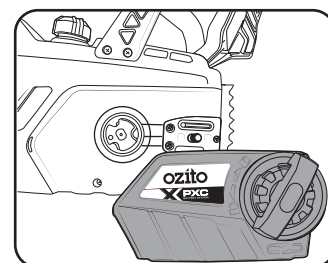
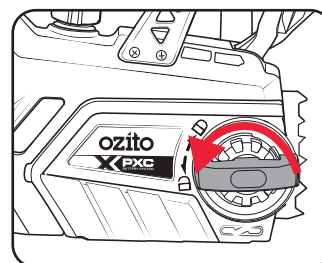

3. Fit the chain over the guide bar, making sure that the cutters are facing in the direction of rotation.

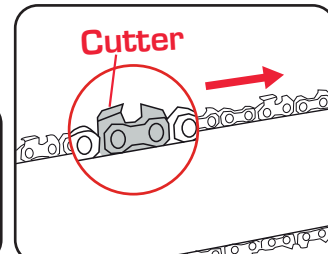

IMPORTANT: IF THE CHAIN IS INSTALLED BACKWARDS (CHAIN CUTTERS ARE FACING IN THE OPPOSITE DIRECTION OF ROTATION) THE CHAINSAW WILL VIBRATE EXCESSIVELY AND NOT CUT.

4. Place the guide bar and chain in position, ensuring that the chain is around sprocket (A). Also ensure that the threaded pin (B) fits into the guide bar tension dial. If it does not fit, it can be adjusted slightly by turning the dial.

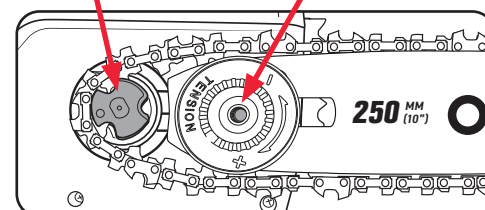
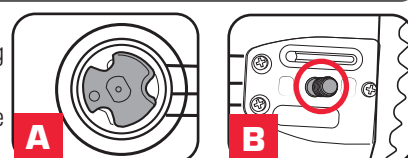

5. Attach the side cover and secure it with the guide bar lock knob. Do not fully tighten the guide bar lock knob until after adjusting the chain tension.

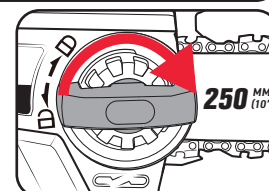

Adjusting the Chain Tension

1. Loosen the guide bar lock knob, rotating in a counter clockwise direction.

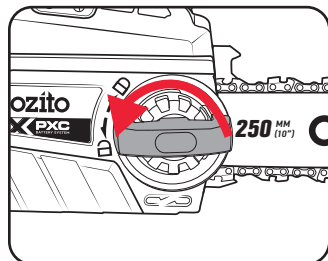

IMPORTANT: IF YOU TRY TO ROTATE THE CHAIN TENSIONING DIAL WHILST THE GUIDE BAR LOCK KNOB IS TIGHT, IT WILL RESULT IN THE CHAIN NOT LOOSENING AND POSSIBLE DAMAGE TO THE MECHANISM.

2. Adjust the chain tension with the chain tensioning dial. Turning the dial CLOCKWISE increases the chain tension, turning it COUNTER-CLOCKWISE decreases the chain tension.

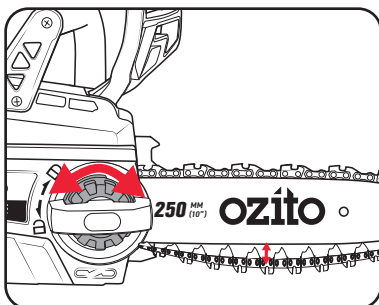

For the correct chain tension, firmly pull up on the chain at the middle of the top of the exposed guide bar. When the chain is pulled up to its highest point, the bottom tip of the links should only just stay in the track [middle of the guide bar].

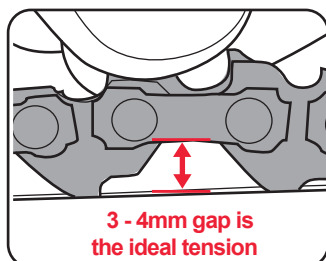

3. After the chain has been accurately tensioned, lock the guide bar in place with the guide bar lock knob.

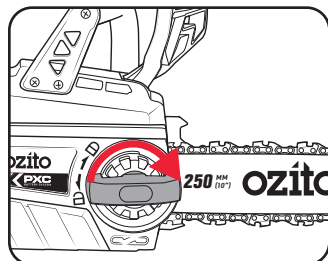

Note: Proper tension of the chain is extremely important and must be checked before starting, as well as during any cutting operation. Taking the time to make adjustments to the chain will result in improved cutting performance and prolonged chain life.

IMPORTANT: IT IS VITAL FOR THE PROPER AND SAFE OPERATION OF THE CHAINSAW THAT THE CHAIN IS TENSIONED CORRECTLY.

2. OIL

IMPORTANT: ONLY USE OIL THAT IS EXPRESSLY LABELLED 'CHAIN BAR OIL'.

1. Unscrew the chain bar oil cap.
2. Fill the tank with chain bar oil. The capacity of the chain oil tank is 200ml. Do not over fill.

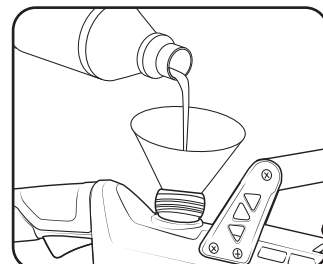
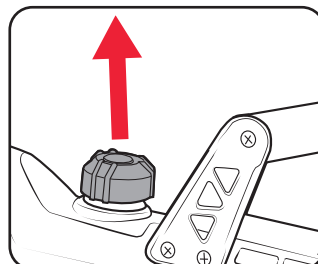

3. Refit cap and clean any oil spillage.
4. Always fill the oil tank when the oil level is below the minimum mark on the oil level window.

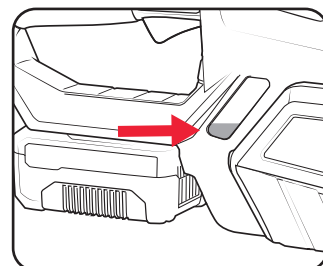

Note: Always clean up any oil spillage from product or area with an absorbent towel before use. Always discard waste according to your Local government policies and laws.

WARNING! NEVER START WORK UNLESS THE CHAIN AND BAR ARE LUBRICATED. USE OF THE CHAINSAW WITHOUT SAW CHAIN OIL OR IF THE OIL LEVEL IS BELOW THE 'MIN' MARK WILL DAMAGE THE CHAINSAW.

5. To check the lubricating system, switch on the chainsaw and hold it with the guide bar and chain above some light coloured paper such as newspaper. A steadily increasing stain caused by oil spray shows the lubricating system is working.

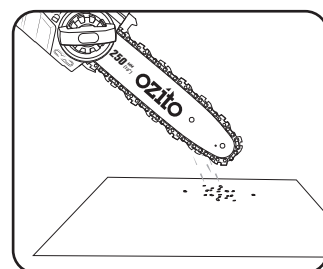

Note: Chain bar oil may leak if the chainsaw is left for long periods. This is normal. If the chainsaw is to be left unused for an extended time, drain the oil from the oil tank. Refill before use.

Running in the Chain

Prior to operation, a new chain should be run in for 2–3 minutes and then its tension should be checked and adjusted as detailed in 'ASSEMBLY - Adjusting the Chain Tension'.

OPERATION

3. BATTERY AND CHAIN BRAKE

Align the ribs of the battery with the recess below the rear handle and slide the battery in so that it clicks into place.

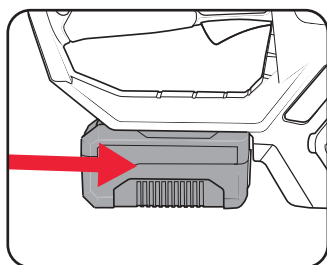

To remove, press and hold the battery release tab **(a)** to release, then slide the battery out **(b)**.

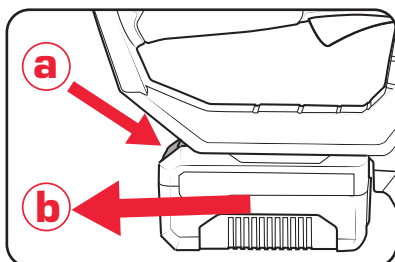

Run Time

The operating time of the PXC battery (the amount that can be cut with a single battery charge) is largely dependent on the type of the timber (e.g. hardness, moisture, thickness, etc.) the sharpness of the chain and your rate of work.

Frequently turning the equipment on and off will also reduce the runtime and amount that you can cut. If the operating time of the PXC battery (runtime) is still unsatisfactory in spite of the above measures, you can remedy the problem by using a PXC battery with a larger capacity (Ah).

Chain Brake

The chainsaw is fitted with a hand guard/chain brake which when engaged brings the chain to a stop within a tenth of a second.

The chain brake can be operated manually by pushing it forward as a result of kickback.

Kickback occurs if the chain catches on the wood being cut and the chainsaw recoils back suddenly.

In the event of kickback, your hand (which is on the front handle during operation) jerks forward causing the back of your hand to push the hand guard forward, engaging the chain brake and quickly stopping the chain.

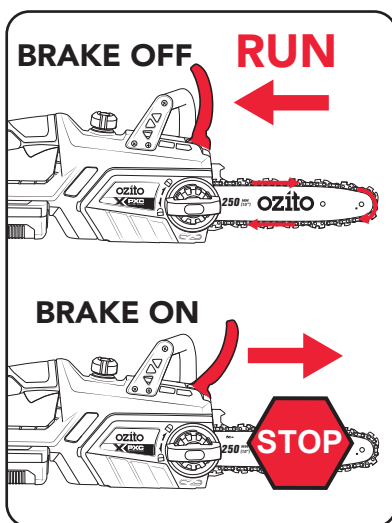

4. SWITCHING ON & OFF



WARNING! ALWAYS WEAR APPROPRIATE PERSONAL PROTECTIVE EQUIPMENT (PPE) WHEN USING THE CHAINSAW, SUCH AS STURDY SAFETY CHAPS, NON-SLIP FOOTWEAR, LONG TROUSERS, LEATHER GLOVES, SAFETY GLASSES, HEAD AND EAR PROTECTION. NEVER USE THE EQUIPMENT BAREFOOT OR IN SANDALS.

Switching ON

1. Pull the hand guard/chain brake towards you.

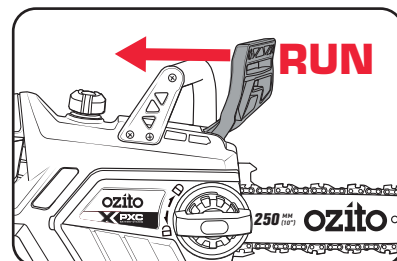

2. Hold the front handle with your left hand and the rear handle with your right hand.

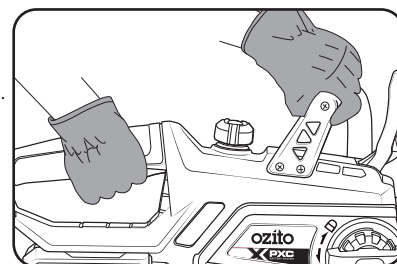

3. Press the Safety Lock-off **(a)** with your thumb, then squeeze the On/Off Trigger **(b)**. The chainsaw starts after a short delay.

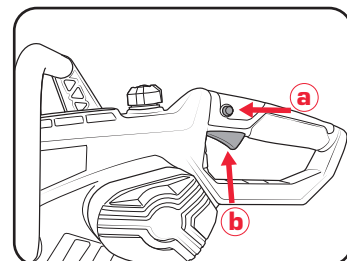

4. The chain will now be running, ready to make a cut. Release the Safety Lock-off.

Switching OFF

Release the On/Off Trigger, the chain and motor will quickly stop.

Note: The motor brakes the saw chain as soon as the On/Off Trigger is released.

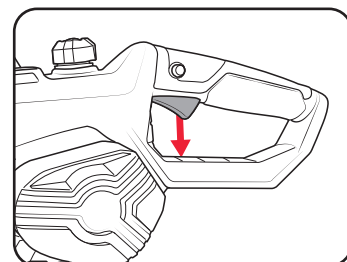

WARNING! DO NOT OPERATE THIS CHAINSAW WITH LONG LOOSE HAIR OR LOOSE FITTING JEWELLERY. TIE LONG LOOSE HAIR BACK AND REMOVE LOOSE FITTING JEWELLERY.



WARNING! WHEN TRANSPORTING THE CHAINSAW FROM ONE LOCATION TO ANOTHER, ALWAYS ENGAGE THE CHAIN BRAKE AND CARRY USING THE FRONT HANDLE ONLY. NEVER CARRY HOLDING THE GUIDE BAR & CHAIN AS THE CHAIN CUTTERS ARE VERY SHARP AND WILL CUT YOU.

5. CUTTING

WARNING! THIS PRODUCT IS INTENDED FOR USE BY A COMPETENT TRAINED PERSON. THIS USER MANUAL IS A GUIDE ONLY AND SHOULD NOT BE TREATED AS A TRAINING MANUAL. PLEASE SEEK PROFESSIONAL TRAINING BEFORE USE.

Hints and Tips

- Do not force the saw into the cut. Apply only light pressure whilst running the chain.
- If the saw chain gets caught in the cut, do not try to remove it by twisting the guide bar or pulling forcibly. Use a lever or wedge to open up the cut so that the saw chain is freed.
- Keep your left arm with elbow locked in a "straight arm" position to withstand any kickback force.

- Before cutting press the bucking spikes against the timber ensuring the chain is not making contact with the material being cut.

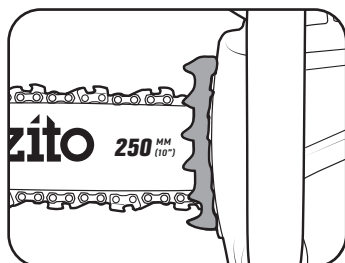

- While cutting, always:

- Run the chainsaw motor at full speed. This makes the job safer, as there is less chance of pull-in or kick-back.
- Position your body to the left of the chainsaw so if it kicks back uncontrollably, it goes over your right shoulder, never stand in the cutting line of the saw.
- Keep a firm grip with your left hand on the side handle, with your thumb securely below the handle.

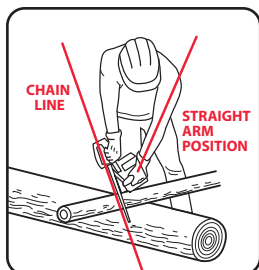

WARNING! DO NOT OPERATE THIS CHAINSAW IN A TREE, ON A LADDER, FROM A ROOFTOP, EWP (ELEVATED WORK PLATFORM) OR UNSTABLE SUPPORT. THIS IS EXTREMELY DANGEROUS.

WARNING! ALWAYS USE THIS CHAINSAW WITH BOTH HANDS. NEVER HOLD LIMBS WITH ONE HAND AND OPERATE THE CHAINSAW WITH THE OTHER. FAILURE TO HEED THIS WARNING MAY RESULT IN SERIOUS INJURY.

- Two hands **MUST** be always used when in use.
- This Product **MUST NOT** be used if user is in a tree, hanging from branch/branches, off roof tops or buildings, ladder/s or EWP (Elevated Work Platform) of any kind.
- PPE (Goggles, Ear protection, Gloves, Coveralls, Chaps, etc..) **MUST** be always used when using this product.
- This Product **MUST NOT** be attached to any extension device or apparatus when in use. i.e. pole.
- This Product **MUST NOT** be attached to a rope or any hoisting device.

Limbing

WARNING! DO NOT STAND ON THE LOG. BE ALERT TO THE FACT THAT THE LOG MAY ROLL OVER. WHEN WORKING ON A SLOPE, ALWAYS STAND ON THE UP HILL SIDE OF THE LOG.

Limbing is the process of removing the branches from a fallen tree. Check the direction in which a branch will bend before cutting it. Always cut on the opposite side to the bending direction so that the guide bar is not pinched in the cut. For large limbs that cannot be removed in one cut, make an initial cut from the bent side and finish by sawing from the opposite direction. Do not remove limbs that are supporting the fallen tree on the ground until the tree has been cut into lengths.

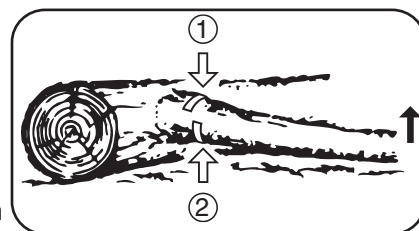

Bucking

Bucking is cutting a log into lengths for easier handling. To saw a log lying on the ground, first saw halfway, then roll the log over and cut from the opposite side. To saw the end of a log supported off the ground, first saw up from the bottom one-third through the log then finish by sawing down from the top. To saw a log in the middle of two supports holding it off the ground, first saw down from the top one-third through the log then finish by sawing up from the bottom.

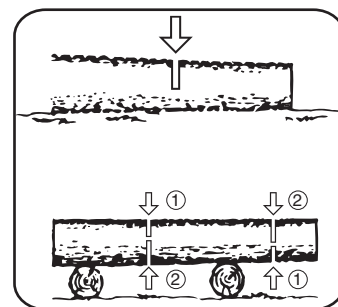

CAUTION: FIRST AVOID CUTTING THE GROUND AS THIS WILL VERY QUICKLY DULL THE SAW CHAIN.

Pruning

WARNING! DO NOT USE AN UNSTABLE FOOTHOLD OR LADDER. DO NOT OVERREACH. DO NOT SAW ABOVE SHOULDER HEIGHT. ALWAYS USE BOTH HANDS TO HOLD THE SAW. FIRST CUT UP FROM THE BOTTOM AND FINISH DOWN FROM THE TOP.

Pruning is the removal of a limb or branch from a standing tree.

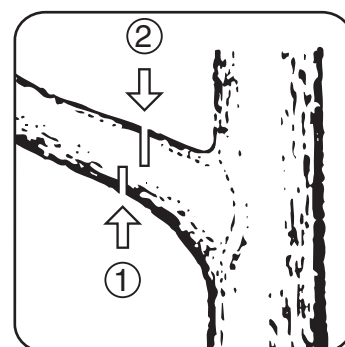

OPERATION (cont).

Felling a Tree

WARNING! FELLING A TREE SHOULD ONLY BE DONE BY TRAINED OPERATORS.

Decide the direction in which you wish the tree to fall, taking into account the direction of the wind, the position of branches, lean of the tree, ease of subsequent limbing and bucking and other factors prevalent at the time.

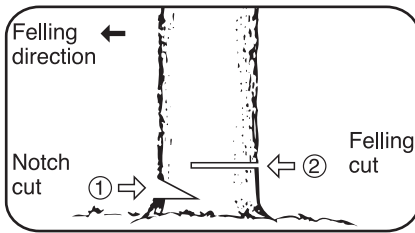

MAINTENANCE

WARNING! BEFORE CLEANING YOUR CHAINSAW OR CARRYING OUT ANY MAINTENANCE PROCEDURE, MAKE SURE THE BATTERY IS REMOVED TO PREVENT ACCIDENTAL STARTING.

WARNING! ALWAYS WEAR GLOVES WHEN HANDLING THE CHAIN. THE CHAIN CUTTERS ARE SHARP AND COULD CUT YOU.

Replacing the Chain & Bar

The same procedure should be followed when replacing the bar and chain as detailed in 'ASSEMBLY - Fitting the Bar & Chain'.

Adjusting the Chain Tension

The same procedure should be followed when adjusting the chain tension as detailed in 'ASSEMBLY - Adjusting the Chain Tension'.

Guide Bar

The guide bar needs to be replaced if

- the guide groove of the guide bar is worn.
- the nose sprocket in the guide rail is damaged or worn.

Note: The guide bar can be flipped upside down to achieve even wear before being replaced for the first time.

1. Remove the guide bar tension dial from the guide bar by removing the screw.
2. Fit the guide bar tension dial to the new guide bar using the screw removed in step 1.

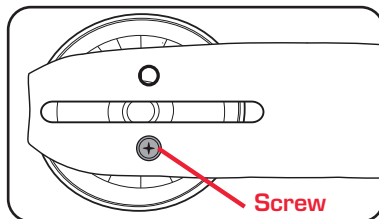

MAINTENANCE (cont).

Chain Sharpening

Chain File: 3.96mm (5/32")

Chain Pitch: 9.53mm (3/8")

Chain Gauge: 1.1mm (0.043")

Sharpen the chain regularly to maintain optimum performance of the saw. Signs of a dull chain are:

- The sawdust becomes powder-like
- Extra force is required to execute a cut
- The cut does not track in a straight line
- Increased vibration

Sharpen each cutter using a round 3.96mm (5/32") chain file. Keep the file level with the top plate of the tooth. Always use outward strokes and maintain a 30° angle between the chain and file. After sharpening, the cutters must all have the same width and length.

After every 3–4 uses get an authorised repair centre to professionally sharpen your chain. They have the special tools necessary to ensure the correct cutting angles and depths.

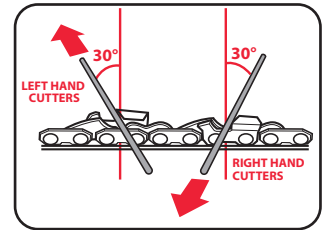

Cleaning and Storing

- Keep the handles free of grease so that you can maintain a firm grip.
- Keep air intake clean and air vents free of debris to avoid overheating the motor.
- After each use, blow it with compressed air at low pressure through the motor housing to ensure it is free from all dust particles which may build up. Build up of dust particles may cause the unit to overheat and shorten the life of the chainsaw.
- If the chainsaw is not to be used for an extended period of time then you should remove the chain oil from the tank. Briefly immerse the chain and the cutter rail in an oil bath and then wrap them in oil paper.
- Ensure that the guide bar cover is in place when storing.
- If the enclosure of the chainsaw requires cleaning do not use solvents but a moist soft cloth or soft brush only. Never let any liquid get inside the chainsaw; never immerse any part of the chainsaw into liquid.
- Replace worn or damaged parts for safety
- Remove the battery from the chainsaw when in storage.
- Store the equipment and its accessories in a dark and dry place at above freezing temperature. The ideal storage temperature is between 5°C and 30°C.

Note: Chain bar oil may leak if the chainsaw is left for long periods. This is normal. If the chainsaw is to be left unused for an extended time, drain the oil from the oil tank. Refill before use.

WARNING! NEVER IMMERSE THE UNIT IN WATER OR OTHER LIQUIDS IN ORDER TO CLEAN IT.

WARNING! STORE THE CHAINSAW IN A SAFE AND DRY PLACE OUT OF THE REACH OF CHILDREN.

Note: Ozito Industries will not be responsible for any damage or injuries caused by the repair of the Chainsaw by an unauthorised person or by mishandling of the Chainsaw. This machine is designed for DIY use - use in commercial or industrial environments will void the warranty.

TROUBLESHOOTING

PROBLEM	CAUSE	REMEDY
Chainsaw will not work	Chain brake engaged	Disengage brake
	Battery low in charge	Charge battery
	Battery not inserted properly	Insert battery packs correctly
Dry chain	No oil in oil tank	Fill oil tank with chain bar oil
	Oil tank cap breather blocked	Clean oil tank cap
	Oil outlet blocked	Clear oil outlet
Chain or guide rail hot	No oil in oil tank	Fill oil tank with chain bar oil
	Oil tank cap breather blocked	Clean oil tank cap
	Oil outlet blocked	Clear oil outlet
	Blunt chain	Sharpen or replace chain
Chainsaw will not cut	Blunt chain	Sharpen or replace chain
	Chain on backwards (chain teeth pointing in the wrong direction)	Remove chain and reinstall with the teeth facing in the correct direction
	Worn chain	Replace the chain
Chainsaw vibrating or not cutting properly	Chain tension too loose	Adjust chain to correct tension
	Blunt chain	Sharpen or replace chain
	Worn chain	Replace the chain
	Chain on backwards (chain teeth pointing in the wrong direction)	Remove chain and reinstall with the teeth facing in the correct direction
Chain bar oil leaking	This is normal. If the chainsaw is to be left unused for an extended time, drain the oil from the oil tank. Refill before use.	

Sparkling visible through the housing air vents

A small amount of sparking may be visible through the housing vents. This is normal and does not indicate a problem.

Battery protection system

The tool/machine is equipped with the battery protection system, which helps to ensure a long service life.

The output power automatically cuts off during operation when the tool and/or battery are placed under the following situations:

- When the tool/machine is overloaded:**

If this occurs, release the trigger switch and remove causes of overload, then pull the switch trigger again to restart.

- When the remaining battery capacity becomes low:**



Recharge the battery pack.

Note: The battery protection system does not in any way damage the tool/machine.

SPARE PARTS

Chain Replacement:

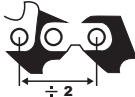
The chain can be purchased through Ozito spare parts or from your local Bunnings Warehouse. The correct chain can be purchased by matching the pitch, gauge and number of links as shown below:

Pitch	Gauge	Drive Links
		
9.53mm (3/8)	1.1mm (.043")	40

Spare parts can be ordered from the Special Orders Desk at your local Bunnings Warehouse.











For further information, visit www.ozito.com.au or contact Ozito Customer Service:

Australia 1800 069 486

New Zealand 0508 069 486

E-mail: hello@ozito.com.au

DESCRIPTION OF SYMBOLS

V	Volts	Hz	Hertz
~	Alternating current	W	Watts
dc/---	Direct current	Ø	Diameter
Ah	Ampere hour	nº	No load speed
/min	Revolutions or reciprocation per minute	m/s	Metres per second
	Warning!	mm	Millimetre
	Regulatory compliance mark (RCM)	ml	Millilitre
	Wear safety gloves		Chain drive links 40
	Do not saw in the rain or leave the chainsaw outdoors while raining		Wear ear & eye protection
	Read instruction manual to reduce the risk of injury		
	Always hold the saw with both hands		
	IMPORTANT! When placing the chain on the guide bar, ensure the chain direction is the same as the image on the guide bar		
	Beware of chain saw kickback and avoid contact with bar tip		Sound power level 100dB

CARING FOR THE ENVIRONMENT



Power tools that are no longer usable should not be disposed of with household waste but in an environmentally friendly way. Please recycle where facilities exist. Check with your local council authority for recycling advice.



Recycling packaging reduces the need for landfill and raw materials. Reuse of recycled material decreases pollution in the environment. Please recycle packaging where facilities exist. Check with your local council authority for recycling advice.



ELECTRICAL SAFETY



WARNING! When using electric machines, basic safety precautions, including the following, should always be followed to reduce risk of fire, electric shock, personal injury and material damage.

-Read the whole manual carefully and make sure you know how to switch the machine off in an emergency, before operating the machine. Save these instructions and other documents supplied with this machine for future reference.

-This appliance is not intended for use by persons (including children) with reduced physical, sensory or mental capabilities, or lack of experience and knowledge, unless they have been given supervision or instruction concerning use of the appliance by a person responsible for their safety.



GENERAL MACHINE SAFETY WARNINGS



WARNING! Read all safety warnings, instructions, illustrations and specifications provided with this machine. Failure to follow all instructions listed below may result in electric shock, fire and/or serious injury.

Save all warnings and instructions for future reference.

The term "machine" in the warnings refers to your mains-operated (corded) machine or battery-operated (cordless) machine.

1) Work area safety

- a) **Keep work area clean and well lit.** Cluttered or dark areas invite accidents.
- b) **Do not operate machines in explosive atmospheres, such as in the presence of flammable liquids, gases or dust.** Machines create sparks which may ignite the dust or fumes.
- c) **Keep children and bystanders away while operating a machine.** Distractions can cause you to lose control.

2) Electrical safety

- a) **Machine plugs must match the outlet. Never modify the plug in any way. Do not use any adapter plugs with earthed (grounded) machines.** Unmodified plugs and matching outlets will reduce risk of electric shock.
- b) **Avoid body contact with earthed or grounded surfaces, such as pipes, radiators, ranges and refrigerators.** There is an increased risk of electric shock if your body is earthed or grounded.
- c) **Do not expose machines to rain or wet conditions.** Water entering a machine will increase the risk of electric shock.
- d) **Do not abuse the cord. Never use the cord for carrying, pulling or unplugging the machine. Keep cord away from heat, oil, sharp edges or moving parts.** Damaged or entangled cords increase the risk of electric shock.
- e) **When operating a machine outdoors, use an extension cord suitable for outdoor use.** Use of a cord suitable for outdoor use reduces the risk of electric shock.
- f) **If operating a power tool in a damp location is unavoidable, use a residual current device (RCD) protected supply.** Use of an RCD reduces the risk of electric shock.

3) Personal safety

- a) **Stay alert, watch what you are doing and use common sense when operating a machine. Do not use a machine while you are tired or under the influence of drugs, alcohol or medication.** A moment of inattention while operating machines may result in serious personal injury.
- b) **Use personal protective equipment. Always wear eye protection.** Protective equipment such as a dust mask, non-skid safety shoes, hard hat or hearing protection used for appropriate conditions will reduce personal injuries.
- c) **Prevent unintentional starting. Ensure the switch is in the off-position before connecting to power source and/or battery pack, picking up or carrying the machine.** Carrying machines with your finger on the switch or energising machines that have the switch on invites accidents.
- d) **Remove any adjusting key or wrench before turning the machine on.** A wrench or a key left attached to a rotating part of the machine may result in personal injury.
- e) **Do not overreach. Keep proper footing and balance at all times.** This enables better control of the machine in unexpected situations.
- f) **Dress properly. Do not wear loose clothing or jewellery. Keep your hair and clothing away from moving parts.** Loose clothes, jewellery or long hair can be caught in moving parts.
- g) **If devices are provided for the connection of dust extraction and collection facilities, ensure these are connected and properly used.** Use of dust collection can reduce dust-related hazards.
- h) **Do not let familiarity gained from frequent use of machines allow you to become complacent and ignore machine safety principles.** A careless action can cause severe injury within a fraction of a second.

Children should be supervised to ensure that they do not play with the appliance.

-This appliance is compatible and only to be used with all batteries & chargers from the Ozito PXC range. Refer to the PXC battery and charger manuals for information regarding charging, use and storage.

-Remove the batteries from the appliance before being charged.

-Do not combine different types of batteries or new and used batteries.

-If the appliance is to be stored unused for a long period, the batteries should be removed.

-Do not use modified or damaged batteries.

4) Machine use and care

- a) **Do not force the machine. Use the correct machine for your application.** The correct machine will do the job better and safer at the rate for which it was designed.
- b) **Do not use the machine if the switch does not turn it on and off.** Any machine that cannot be controlled with the switch is dangerous and must be repaired.
- c) **Disconnect the plug from the power source and/or remove the battery pack, if detachable, from the machine before making any adjustments, changing accessories, or storing machines.** Such preventive safety measures reduce the risk of starting the machine accidentally.
- d) **Store idle machines out of the reach of children and do not allow persons unfamiliar with the machine or these instructions to operate the machine.** Machines are dangerous in the hands of untrained users.
- e) **Maintain machines and accessories. Check for misalignment or binding of moving parts, breakage of parts and any other condition that may affect the machine's operation. If damaged, have the machine repaired before use.** Many accidents are caused by poorly maintained machines.
- f) **Keep cutting machines sharp and clean.** Properly maintained cutting machines with sharp cutting edges are less likely to bind and are easier to control.
- g) **Use the machine, accessories and machine bits etc. in accordance with these instructions, taking into account the working conditions and the work to be performed.** Use of the machine for operations different from those intended could result in a hazardous situation.
- h) **Keep handles and grasping surfaces dry, clean and free from oil and grease.** Slippery handles and grasping surfaces do not allow for safe handling and control of the machine in unexpected situations.

5) Battery machine use and care

- a) **Recharge only with the charger specified by the manufacturer.** A charger that is suitable for one type of battery pack may create a risk of fire when used with another battery pack.
 - b) **Use machines only with specifically designated battery packs.** Use of any other battery packs may create a risk of injury and fire.
 - c) **When battery pack is not in use, keep it away from other metal objects, like paper clips, coins, keys, nails, screws or other small metal objects, that can make a connection from one terminal to another.** Shorting the battery terminals together may cause burns or a fire.
 - d) **Under abusive conditions, liquid may be ejected from the battery; avoid contact. If contact accidentally occurs, flush with water. If liquid contacts eyes, additionally seek medical help.** Liquid ejected from the battery may cause irritation or burns.
 - e) **Do not use a battery pack or machine that is damaged or modified.** Damaged or modified batteries may exhibit unpredictable behaviour resulting in fire, explosion or risk of injury.
 - f) **Do not expose a battery pack or machine to fire or excessive temperature.** Exposure to fire or temperature above 130 °C may cause explosion.
 - g) **Follow all charging instructions and do not charge the battery pack or machine outside the temperature range specified in the instructions.** Charging improperly or at temperatures outside the specified range may damage the battery and increase the risk of fire.
- ## 6) Service
- a) **Have your machine serviced by a qualified repair person using only identical replacement parts.** This will ensure that the safety of the machine is maintained.
 - b) **Never service damaged battery packs.** Service of battery packs should only be performed by the manufacturer or authorized service providers.



CHAINSAW SAFETY WARNINGS



WARNING! This appliance is not intended for use by persons (including children) with reduced physical, sensory or mental capabilities, or lack of experience and knowledge, unless they have been given supervision or instruction concerning use of the appliance by a person responsible for their safety.

Young children should be supervised to ensure that they do not play with the appliance.

1) General chain saw safety warnings:

- **Keep all parts of the body away from the saw chain when the chain saw is operating. Before you start the chain saw, make sure the saw chain is not contacting anything.** A moment of inattention while operating chain saws may cause entanglement of your clothing or body with the saw chain.
- **Always hold the chain saw with your right hand on the rear handle and your left hand on the front handle.** Holding the chain saw with a reversed hand configuration increases the risk of personal injury and should never be done.
- **Hold the chain saw by insulated gripping surfaces only, because the saw chain may contact hidden wiring or its own cord.** Saw chains contacting a "live" wire may make exposed metal parts of the chain saw "live" and could give the operator an electric shock.
- **Wear eye protection. Further protective equipment for hearing, head, hands, legs and feet is recommended.** Adequate protective equipment will reduce personal injury from flying debris or accidental contact with the saw chain.
- **Do not operate a chain saw in a tree, on a ladder, from a rooftop, or any unstable support.** Operation of a chain saw in this manner could result in serious personal injury.
- **Always keep proper footing and operate the chain saw only when standing on fixed, secure and level surface.** Slippery or unstable surfaces may cause a loss of balance or control of the chain saw.
- **When cutting a limb that is under tension, be alert for spring back.** When the tension in the wood fibres is released, the spring loaded limb may strike the operator and/or throw the chain saw out of control.
- **Use extreme caution when cutting brush and saplings.** The slender material may catch the saw chain and be whipped toward you or pull you off balance.
- **Carry the chain saw by the front handle with the chain saw switched off and away from your body. When transporting or storing the chain saw, always fit the guide bar cover.** Proper handling of the chain saw will reduce the likelihood of accidental contact with the moving saw chain.
- **Follow instructions for lubricating, chain tensioning and changing the bar and chain.** Improperly tensioned or lubricated chain may either break or increase the chance for kickback.
- **Cut wood only. Do not use chain saw for purposes not intended. For example: do not use chain saw for cutting metal, plastic, masonry or non-wood building materials.** Use of the chain saw for operations different than intended could result in a hazardous situation.

- **Do not attempt to fell a tree.** Serious injury could occur to the operator or bystanders while felling a tree.
- **This product is NOT a Toy.** Not for use from persons under 16yrs of age.

2) Causes and operator prevention of kickback:

Kickback may occur when the nose or tip of the guide bar touches an object, or when the wood closes in and pinches the saw chain in the cut.

Tip contact in some cases may cause a sudden reverse reaction, kicking the guide bar up and back towards the operator.

Pinching the saw chain along the top of the guide bar may push the guide bar rapidly back towards the operator.

Either of these reactions may cause you to lose control of the saw which could result in serious personal injury. Do not rely exclusively upon the safety devices built into your saw. As a chain saw user, you should take several steps to keep your cutting jobs free from accident or injury.

Kickback is the result of chain saw misuse and/or incorrect operating procedures or conditions and can be avoided by taking proper precautions as given below:

- **Maintain a firm grip, with thumbs and fingers encircling the chain saw handles, with both hands on the saw and position your body and arm to allow you to resist kickback forces.** Kickback forces can be controlled by the operator, if proper precautions are taken. Do not let go of the chain saw.
- **Do not overreach and do not cut above shoulder height.** This helps prevent unintended tip contact and enables better control of the chain saw in unexpected situations.
- **Only use replacement guide bars and saw chains specified by the manufacturer.** Incorrect replacement guide bars and saw chains may cause chain breakage and/or kickback.
- **Follow the manufacturer's sharpening and maintenance instructions for the saw chain.** Decreasing the depth gauge height can lead to increased kickback.



WARNING! When servicing, use only identical replacement parts. Use of any other parts may create a hazard or cause product damage. To ensure safety and reliability, all repairs should be performed by a qualified service technician.



Danger! Always remove the battery from the chainsaw:

- when the equipment is left unattended,
- when the equipment is being checked, cleaned, or having maintenance work done,
- after striking a foreign object. Inspect the appliance for damage and make repairs as necessary.
- or if the equipment vibrates abnormally.