

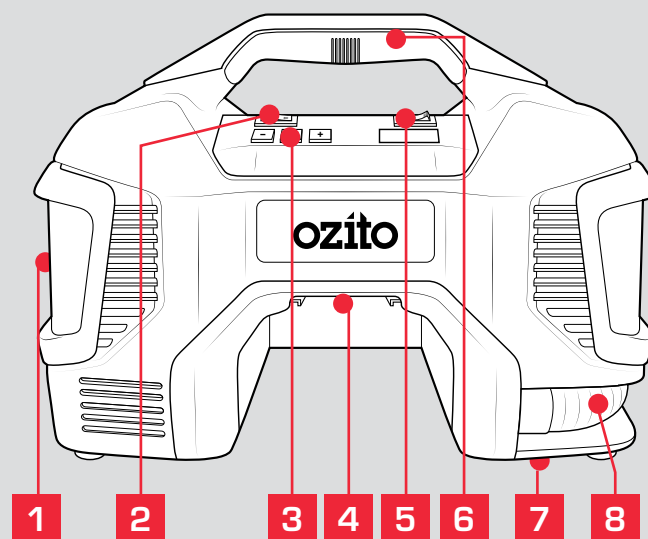

## KNOW YOUR PRODUCT

### HYBRID INFLATOR / DEFLATOR

- |                              |                          |
|------------------------------|--------------------------|
| 1 Adapter Compartment        | 5 Operation Mode Switch  |
| 2 Power Mode Switch          | 6 Carry Handle           |
| 3 Pressure Selection Buttons | 7 Power Cord Compartment |
| 4 Battery Seating            | 8 High Volume Air Hose   |



### ACCESSORIES

- |                  |                            |                 |
|------------------|----------------------------|-----------------|
| 9 Presta Adapter | 10 General Purpose Adapter | 11 Ball Adapter |
|------------------|----------------------------|-----------------|

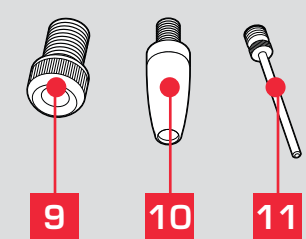

### BATTERY & CHARGER

This tool is compatible with all batteries and chargers from the Ozito Power X Change Range.

#### ONLINE MANUAL

Scan this QR Code with your mobile device to take you to the online manual.



## SETUP & PREPARATION

### 1. BEFORE USE

#### Items Supplied

Please check that the article is complete as specified in the scope of delivery. If parts are missing, please contact our service centre or the sales outlet where you made your purchase at the latest within 5 working days after purchasing the product and upon presentation of a valid bill of purchase. Also, refer to the warranty table in the service information at the end of the operating instructions.

- Open the packaging and take out the equipment with care.
- Remove the packaging material and any packaging and/or transportation braces (if available).
- Check to see if all items are supplied.
- Inspect the equipment and accessories for transport damage.
- If possible, please keep the packaging until the end of the guarantee period.

#### Danger!

The equipment and packaging material are not toys. Do not let children play with plastic bags, foils or small parts. There is a danger of swallowing or suffocating!

#### Proper Use

This device is intended for inflating car, motorcycle and bicycle tires as well as sports balls, water balls, air mattresses and other similar items. In addition the device is also intended for suctioning volumes of air from objects with low pressure, such as water balls, air mattresses and other similar items.

This device is not suitable for tires with very large volumes, such as truck or tractor tires for example.

The equipment can be operated from the mains power supply using the power cable or alternatively in battery-powered mode using a suitable rechargeable battery.

The equipment is to be used only for its prescribed purpose. Any other use is deemed to be a case of misuse. The user / operator and not the manufacturer will be liable for any damage or injuries of any kind as a result of this.

Please note that our equipment has not been designed for use in commercial, trade or industrial businesses or for equivalent purposes.

#### Caution!

##### Residual risks

Even if you use this electric power tool in accordance with instructions, certain residual risks cannot be ruled out. The following hazards may arise in connection with the equipment's construction and layout:

1. Damage to hearing if no suitable ear protection is used.

### 2. CONNECTING TO POWER



#### Inserting & Removing the Battery

- 1 Align the ribs of the battery with the recess at the front of the unit and push in until it clicks into place.

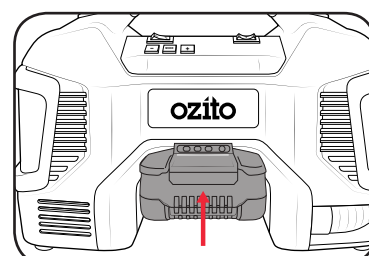

- 2 To switch the unit on, press the power mode switch into the DC position.

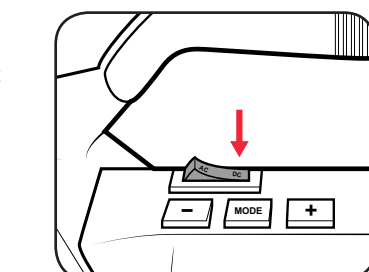

- 3 To remove, press and hold the battery release tab and pull the battery away from the tool.

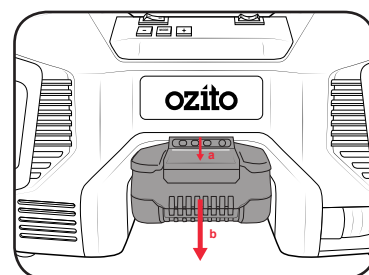

#### Connecting to a 240V (AC) Outlet



- 1 Remove the power cord from the compartment at the base of the inflator and connect to a 240V outlet.

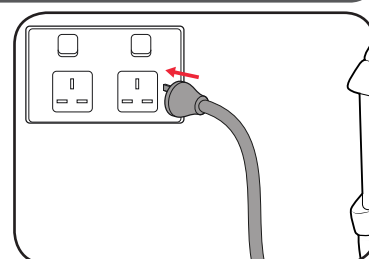

- 2 To switch the unit on, press the power mode switch into the AC position.

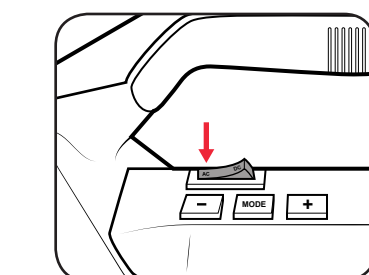

### 3. ADAPTORS & DIGITAL DISPLAY

#### Attaching Inflation Adapters

The inflator unit has 3 adapters to allow a range of functions. All the adapters are secured in the compartment at the side of the unit.

- 1 Open the side compartment and remove the desired inflation adapter.

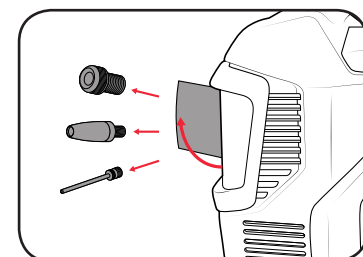

- 2 Remove the high pressure air hose from the back of the tool and unlock the nozzle by lifting the locking lever.

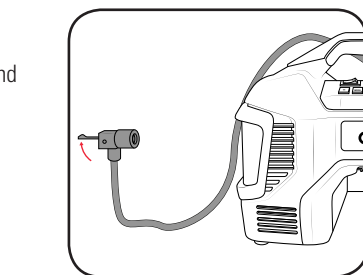

- 3 Insert the adapter into the hose nozzle and lock by pushing down the locking lever.

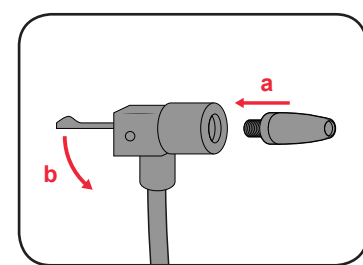

#### Digital Display

While inflating a high pressure item, the current pressure will be displayed on the digital display.

**Note:** When using the inflator to inflate or deflate a high volume item, the digital display will show "0.00".

- 1 To change between the 3 pressure modes (Bar, PSI or kPa), press the pressure mode button.

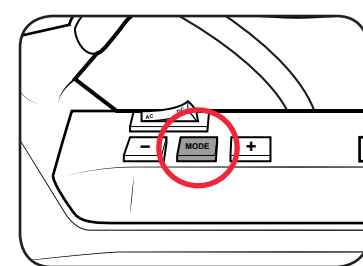
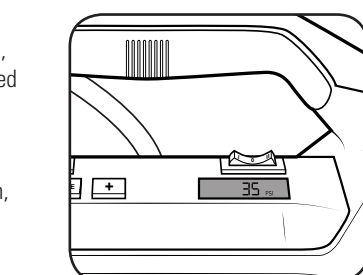

### 4. CONTROLS

#### Preset Pressure

When using the high pressure hose, a preset pressure can be set so that the inflator will automatically shut-off once the desired pressure is reached.

- 1 Press the pressure mode button until the desired pressure unit is displayed on the screen.

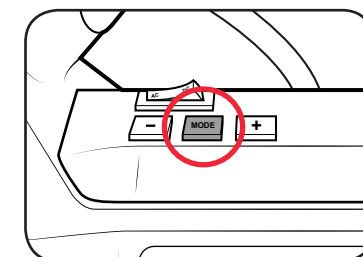

- 2 Increase the preset pressure using the "+" button or decrease the pressure using the "-" button. The preset pressure will be displayed on the digital display as it is adjusted.

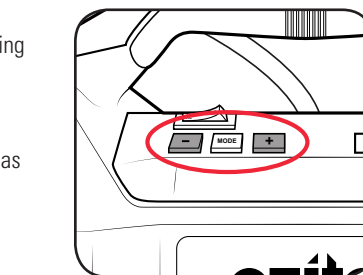

#### Memory Function

The inflator features a memory function so that once a preset pressure is set, this value will be remembered until the power supply is disconnected or the power mode switch is changed. This function allows you to easily inflate multiple items to the same pressure.

- 1 Follow the steps in the 'Inflating high pressure items' section of this manual to inflate the first item.

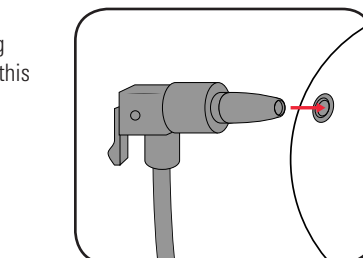

- 2 Once the operation mode switch is in the off position "0", disconnect the air hose. Connect the next item and switch back into mode "I" to inflate the item to the same preset pressure.

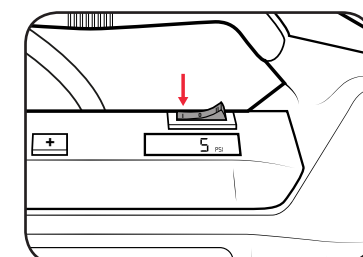

**Note:** If the power supply is disconnected or the power mode switch is changed, the memory of the tool will be reset.

## OPERATION

### 5. INFLATING HIGH PRESSURE ITEMS

The high pressure air hose can be used to inflate high pressure items such as car and bike tyres or sporting equipment.

- 1 Attach the required inflation adaptor to the high pressure hose and secure using the locking lever.

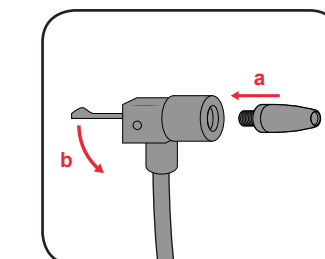

- 2 Insert / attach the hose adaptor to the item to be inflated.

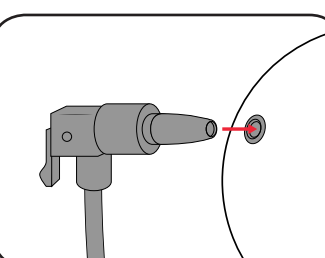

- 3 Adjust the target pressure using the "+" and "-" pressure adjustment buttons.

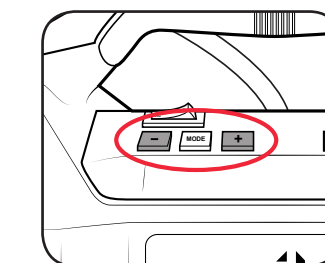

**Note:** The required pressure should be written on the item.



- 4 Press the operating mode switch into "I" position to start inflating the high pressure item.

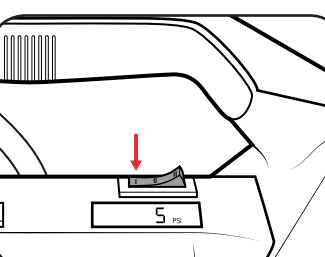

- 5 Once the preset pressure is reached, the tool will automatically shut-off. After the tool has automatically shut off, press the operation mode switch into the off position "0".

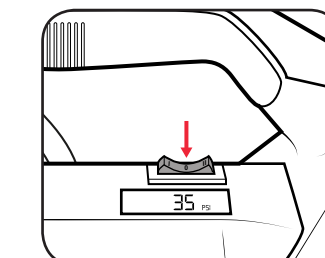

**Note:** For sporting equipment due to the small size and low pressure, the inflator may automatically cut-off prior to reaching the desired pressure. In this case, cycle the unit on and off until the required pressure is reached.

### 6. INFLATING HIGH VOLUME ITEMS

The high volume air hose can be used to inflate high volume items by connecting to the air outlet, or deflate high volume items by connecting to the air inlet.

An example of a high volume item is an air mattress or pool toy.

#### Inflating

- 1 Remove the high volume air hose from the housing and attach to the outlet port.

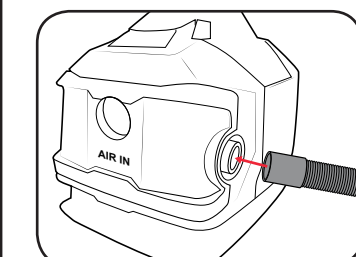

- 2 Insert the adaptor into the inflatable item.

#### Deflating

- 1 Remove the high volume air hose from the housing and attach to the inlet port.

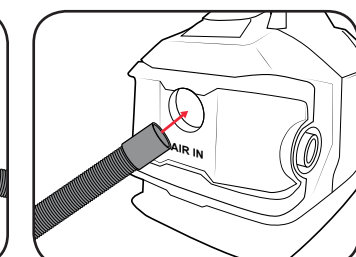

**Note:** If the inflatable item has a cap or air lock, ensure it is removed or unlocked to allow air to flow into the item.



- 3 Press the operating mode switch into "II" position to start inflating the high volume item.

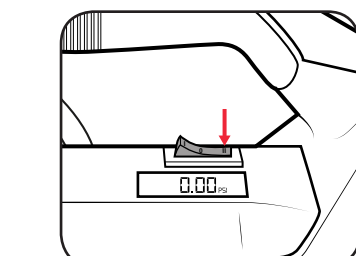

- 4 Once the item is completely inflated, press the operation mode switch into the off position "0".

