

MAINTENANCE

- When not in use, the radio should be stored in a dry, frost free location, keep out of children's reach.
- Keep ventilation slots of the radio clean at all times and prevent anything from entering.
- If the housing of the radio requires cleaning, do not use solvents. Use of a cloth only is recommended.
- Blow out the ventilation slots with compressed air periodically .

Note: Ozito Industries will not be responsible for any damage or injuries caused by repair of the drill by an unauthorised person or by mishandling.

Battery protection system

The tool is equipped with the battery protection system, which helps to ensure a long service life.

The output power automatically cuts off during operation when the tool and/or battery are placed under the following situations:

- When the tool is overloaded:**
If this occurs, release the trigger switch and remove causes of overload, then pull the switch trigger again to restart.
- When the remaining battery capacity becomes low:**
Recharge the battery pack.

Note: The battery protection system does not in any way damage the tool.

Note: The indicated capacity may be lower than the actual level during use or immediately after using the tool.

TROUBLESHOOTING

LED lights do not illuminate on charger

Check the charging adaptor is securely plugged into the wall outlet.

Check the battery is firmly connected to the charging cradle.

Check that the charging jack is securely connected to the charging cradle.

The radio turns off after 4-5 hours

The battery pack may have gone into sleep mode, so turn power switch on & off, or check battery power.

SPARE PARTS

Spare parts can be ordered from the Special Orders Desk at your local Bunnings Warehouse or Homebase store.

For further information, or any parts visit

www.ozito-diy.co.uk or contact Ozito Customer Service:

Great Britain: 0151 294 4488

Ireland: 1850 882711

E-mail: enquires@ozito-diy.co.uk

BATTERY AND CHARGER SAFETY WARNINGS

! THIS MANUAL CONTAINS IMPORTANT SAFETY AND OPERATING INSTRUCTIONS FOR YOUR BATTERY CHARGER.

- Before using the charger read all instructions and cautionary markings on the charger, battery pack and the product using the battery pack.
- This charger is not intended for any uses other than charging rechargeable batteries. Any other use may result in risk of fire, electric shock or electrocution.
- Do not place any object on top of the charger or place the charger on a soft surface that may result in excessive internal heat. Place the charger in a position away from any heat source.
- To reduce risk of damage to the electric plug and cord, pull by the plug rather than the cord when disconnecting the charger.
- Make sure the cord is located so that it will not be stepped on, tripped over, or otherwise subjected to damage or stress.
- An extension cord should not be used unless absolutely necessary. Use of an improper extension cord could result in the risk of fire, electric shock or electrocution.
- Do not operate the charger if it has received a sharp blow, been dropped or otherwise damaged in any way. Have it checked by an electrician or power tool repairer.
- Do not disassemble charger. Take it to an electrician or power tool repairer when service or repair is required. Incorrect reassembly may result in a risk of electric shock, electrocution or fire.
- To reduce risk of electric shock, unplug the charger from the outlet before attempting any cleaning. Removing the battery pack will not reduce this risk.
- Never attempt to connect 2 chargers together.
- DO NOT store or use the tool and battery pack in locations where the temperature may reach or exceed 40°C (such as inside sheds or metal buildings in summer).
- The charger is designed to operate on standard household electrical power (240 volts). Do not attempt to use it on any other voltage!
- The battery pack is not fully charged out of the carton. First read the safety instructions and then follow the charging notes and procedures.
- The longest life and best performance can be obtained if the battery pack is charged when the air temperature is between 18 - 24°C. Do not charge the battery pack in an air temperature below 10°C or above 40°C. This is important and will prevent damage to the battery pack.
- Do not incinerate the battery pack even if it is seriously damaged or is completely worn out. The battery can explode in a fire.
- Never attempt to open the battery pack for any reason. If the plastic housing of the battery pack breaks or cracks, immediately discontinue use and do not recharge.
- During charging, the battery must be placed in a well ventilated area.

! RADIO SAFETY WARNINGS

! WARNING! Keep the radio housing and handle dry, clean and free from grease and oil. Always use a clean cloth cleaning. Never use brake fluid, gasoline, petroleum-based products, or any strong solvents to clean your radio. Following this rule will reduce the risk of loss of control and deterioration of the enclosure plastic.

Do not use radio near water.

Do not install near any heat sources such as radiators, heat registers or other products (including amplifiers) that produce heat.

Only use attachments/accessories specified by the manufacturer.

To reduce the risk of personal injury and electric shock, do not expose to water or rain.

Do not use the radio or listen to music or other audio programs while operating machinery. Doing so may cause distractions that could result in personal injury.

This radio is capable of producing sound levels that can be dangerous to long-term hearing. Listening to music at a high volume for any period of time may cause the listener noise-induced hearing loss. The higher the volume, the less time required before your hearing may be affected.

This appliance is not intended for use by young or infirm persons unless supervised by a responsible person to ensure that they can use the appliance safely. Young children should be supervised to ensure that they do not play with the appliance.



18V LITHIUM ION

CORDLESS RADIO

ORIGINAL INSTRUCTIONS

SPECIFICATIONS

Input: 18V
AM Frequency: 522-1620KHz
FM Frequency: 87.5-108MHz
Auxiliary Jack: 3.5mm
Speaker Output: 3W
Weight: 0.6kg

ozito-diy.co.uk

5 YEAR
REPLACEMENT WARRANTY

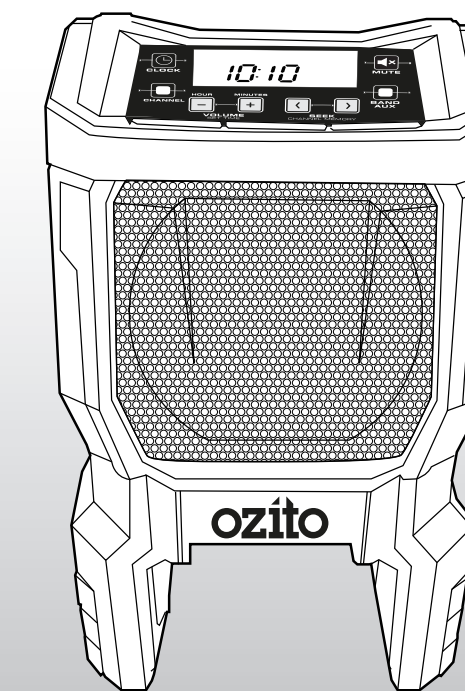

WHAT'S IN THE BOX

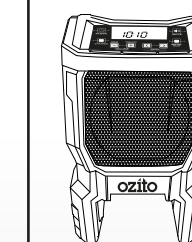

Cordless Radio

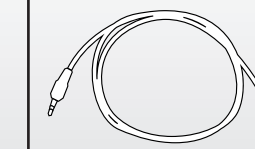

400mm Auxiliary Cable

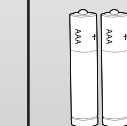

3 x AAA Batteries

PXRDS-300U

DESCRIPTION OF SYMBOLS

V	Volts	Hz	Hertz
ac/~	Alternating current	W	Watts
dc/—	Direct current	∅	Diameter
mA	Milliamperes	Ah	Amp hour
Nm	Newton Meters	Πo	No load speed
/min	Revolutions or reciprocation per minute		
	Warning		Read instruction manual
	Double insulated		Indoor use only
	Thermal cut-out protection		Polarity
	Lithium ion battery		Do not use or store battery in temperatures exceeding 50°C
	Recycle battery		Do not put in the rubbish
	Do not incinerate		Do not get battery wet

WARRANTY

All of our products undergo strict quality checks to ensure that they reach you in perfect condition. In the unlikely event that your device develops a fault, please contact our service department at the address shown on this guarantee card. You can also contact us by telephone using the customer service number shown. Please note the following terms under which guarantee claims can be made:

1. These warranty terms regulate additional warranty services, which the manufacturer mentioned below promises to buyers of its new products in addition to their statutory guarantee claims are not affected by this guarantee. Our guarantee is free of charge to you.

2. The warranty services only covers defects due to material or manufacturing faults on a product which you have bought from the manufacturer mentioned below are limited to either the rectification of said defects on the product or the replacement of the product, whichever we prefer. Please note that our devices are not designed for use in commercial, trade or professional applications. A guarantee contract will not be created if the device has been used by commercial, trade or industrial business or has been exposed to similar stresses during the guarantee period.

3. The following are not covered by our guarantee:

- Damage to the device caused by a failure to follow the assembly instructions or due to incorrect installation, a failure to follow the operating instructions (for example connecting it to an incorrect mains voltage or current type) or a failure to follow the maintenance and safety instructions or by exposing the device to abnormal environmental conditions or by lack of care and maintenance.
- Damage to the device caused by abuse or incorrect use (for example overloading the device or the use of unapproved tools or accessories), ingress of foreign bodies into the device (such as sand, stones or dust, transport damage), the use of force or damage caused by external forces (for example by dropping it).
- Damage to the device or parts of the device caused by normal or natural wear or tear or by normal use of the device.

4. Your Product is guaranteed for a period of 60 months from the original date of purchase and is intended for DIY (Do It Yourself) use only. Lithium Ion batteries and chargers are

covered by a 12 month warranty. Warranty excludes consumable parts. Guarantee claims should be submitted before the end of the guarantee period within two weeks of the defect being noticed. No guarantee claims will be accepted after the end of the guarantee period. The original guarantee period remains applicable to the device even if repairs are carried out or parts are replaced. In such cases, the work performed or parts fitted will not result in an extension of the guarantee period, and no new guarantee will become active for the work performed or parts fitted. This also applies if an on-site service is used.

IN ORDER TO MAKE A CLAIM UNDER THIS WARRANTY YOU MUST RETURN THE PRODUCT TO THE PLACE OF PURCHASE WITH YOUR REGISTER RECEIPT.

Please refer to the restrictions of this warranty concerning wearing parts, consumables and missing parts as set out in the service information in these operating instructions.

CUSTOMER SERVICE HELPLINE
GB: 0151 294 4488
IRL: 1850 882711
Ozito-diy.co.uk

KNOW YOUR PRODUCT

CORDLESS RADIO

- 1 Control Panel
- 2 On/Off Switch
- 3 AAA Battery Compartment
- 4 Speaker
- 5 Carry Handle
- 6 LCD Display Screen
- 7 3.5mm Auxiliary Jack
- 8 Rear MP3 Player/Phone Holder (not shown)

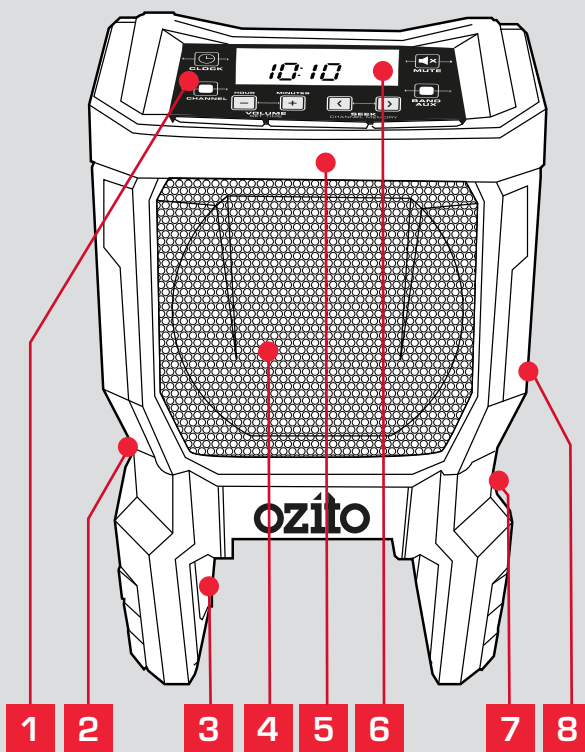

- 9 400mm Auxiliary Cable
- 10 3 x AAA Batteries

BATTERY & CHARGER (sold separately)

This tool is compatible with all battery and chargers from the Ozito Power X Change Range.

ONLINE MANUAL
Scan this QR Code with your mobile device to take you to the online manual.



SETUP & PREPARATION

1. BATTERY & CHARGING

CAUTION: THE CHARGER FOR THIS PRODUCT SHOULD BE PROTECTED BY A RESIDUAL CURRENT DEVICE (RATED AT 30mA OR LESS).

The purchased battery will be shipped in a low charge condition, and requires charging prior to use. Allow several cycles of charging and discharging (through use of the tool) for the battery to reach its optimum performance / runtime.

Charging your lithium ion battery - Fast Charger

- 1 Connect the charger into a mains power outlet.

- 2 The charger LED will flash green showing power is being supplied to the charger.



- 3 With the charger sitting on a flat surface, align the raised ribs on the battery with the recess in the charger and slide onto the charger ensuring a firm connection.

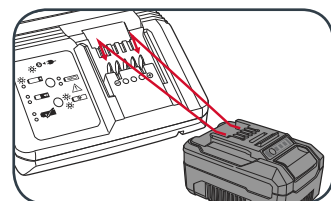

- 4 The charger LED will illuminate red signifying that the battery is charging.

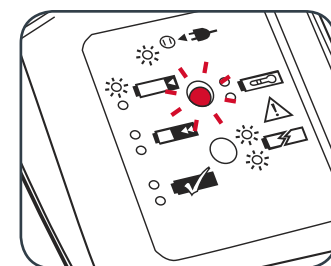

- 5 The charger LED will illuminate green once the battery is charged.

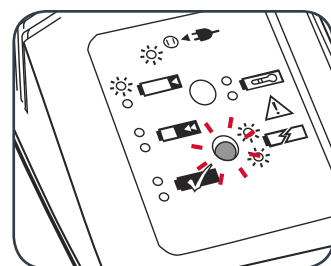

Charger LED Indicator

LED Indicator	Situation
GREEN (Flashing)	Stand By (no battery pack is inserted)
RED (Flashing)	Battery is charging (low charge)
RED (Illuminated)	Battery is charging (mid charge)
GREEN (Illuminated)	Battery is 85% - 100% charged and ready for use
BOTH (Illuminated)	Battery pack is too hot or too cold (charging will begin automatically when battery reaches correct charging temperature).
BOTH (Flashing)	Defective battery. Never charge a defective battery pack! Remove battery pack from charger.

Charging your lithium ion battery - Eco Charger

- 1 Connect the charger into a mains power outlet.

- 2 The charger LED will flash green showing power is being supplied to the charger.

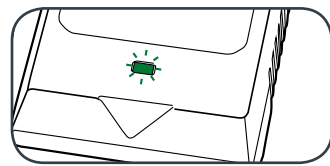

- 3 With the battery sitting on a flat surface, align the raised ribs on the battery with the recess in the charger and slide onto the battery ensuring a firm connection.

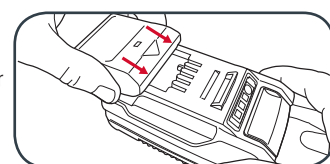

- 4 The charger LED will illuminate red signifying that the battery is charging.

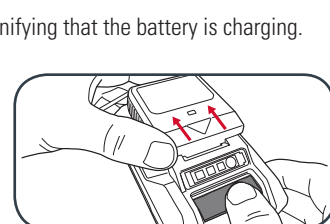

- 5 When removing the charger from the battery, first press the battery release tab, then slide the charger from its position.

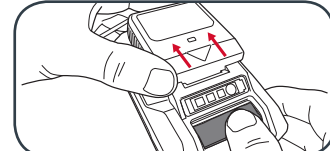

Battery Charge Indicator

LED Indicator	Situation
GREEN (Flashing)	Stand By (no battery pack is inserted)
RED (Illuminated)	Battery is charging (low charge)
GREEN (Illuminated)	Battery is charged and ready for use
RED (Flashing)	Battery or Charger fault
RED & GREEN (Flashing)	Battery pack is too hot or too cold (remove battery from charger and store at room temperature 20°C. Insert battery again when at correct charging temperature). If this happens again, the battery is defective and needs to be replaced.

Battery Charge Indicator

The purchased battery is equipped with a battery charge indicator to show the state of the battery charge.

Press the charge indicator button and look to see which LED lights.

- Battery requires immediate charging
- Low state of charge, requires charging soon.
- Mid state of charge
- Full state of charge.

Note: The battery needs to be removed from the tool to check the state of charge.

2. BATTERY INSTALLATION

Installing AAA Batteries (for clock & memory function)

1. AAA Batteries sit in compartment at base of radio housing. AAA batteries must be installed prior to 18V battery pack.

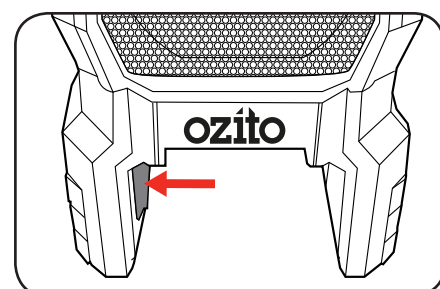

2. Open AAA battery compartment housing

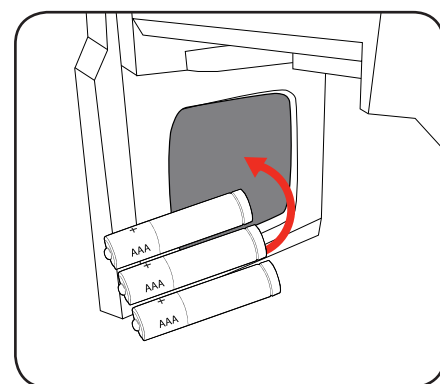

3. Install AAA batteries

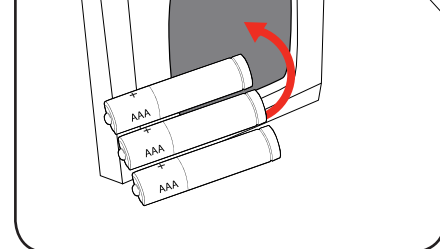

Installing the 18V Battery Pack

1. Holding the radio housing, slide the battery into the base of the radio until it clicks into place.

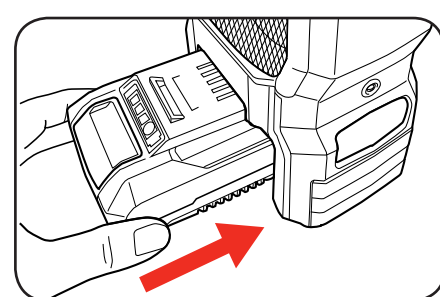

Removing the Battery Pack

1. Press down on the battery release button.
2. Holding the radio housing, slide the battery pack out.

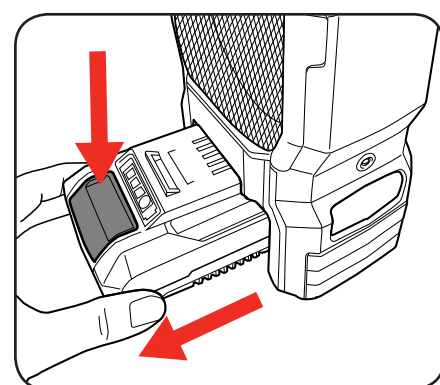

OPERATION

3. OPERATION

On/off Switch

1. To turn the radio on, flick the on/off switch up and display will illuminate.
2. To turn off, flick the on/off switch.

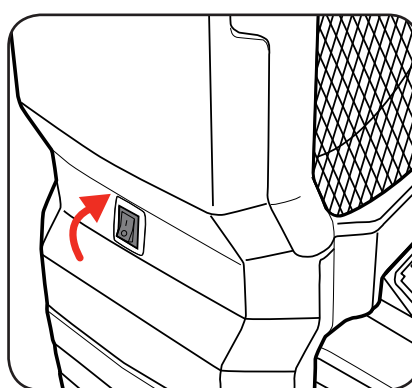

Note: The time will still be shown on the LCD display even when radio is switched off.

Volume

1. To increase the volume, press the Volume + button until desired volume is reached.
2. To decrease the volume, press the Volume - button until desired volume is reached.



3. To mute the sound, press Mute button.

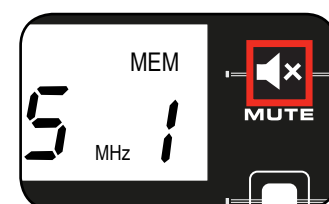

4. To return sound to previous volume, press Mute button again or any other button on the display panel.

Mode & Tuning

1. To alternate between AM or FM frequencies and Auxiliary mode, press the Band AUX button.

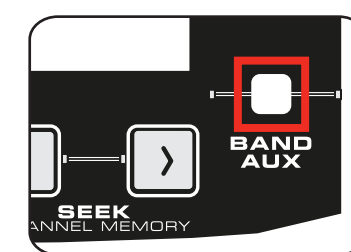

2. To find a station, scroll through a frequency by pressing the Seek buttons.

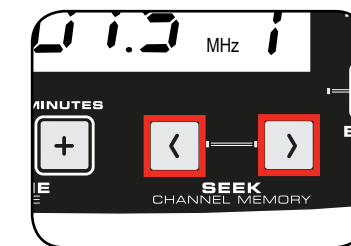

Note: Radio will automatically change to AUX mode when auxiliary cord with device are connected to AUX jack. To switch back to radio, press Band AUX button.

4. SETTING THE TIME

1. Turn the radio off.

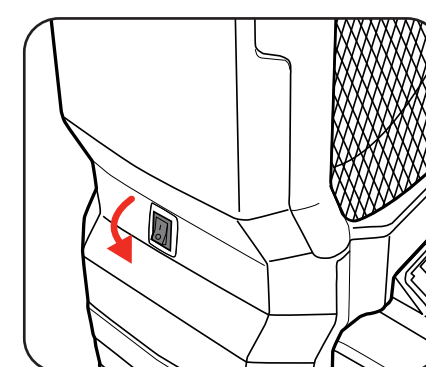

2. Press and hold the Clock button until the time starts flashing on the LCD display screen.

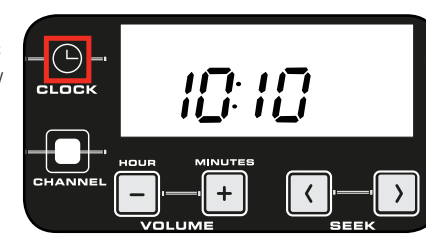

3. Use the Hour (or Volume -) button to change the hour.

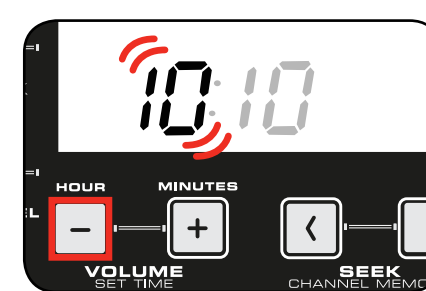

4. Use the Minutes (or Volume +) button to change the minutes.

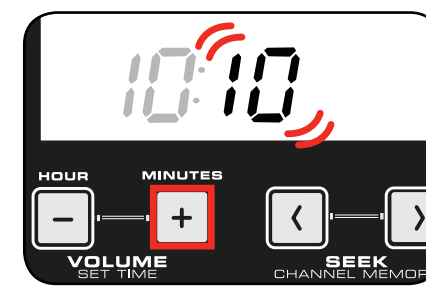

5. Once desired time is reached, press the Clock button again to save.



5. PROGRAMMING

Setting up Favourite Stations

You can program this product to remember up to ten radio stations on both the AM and FM modes using the Channel memory system.

1. Turn the radio on.
2. Press the Channel button once to open the first memory setting - Mem 1.

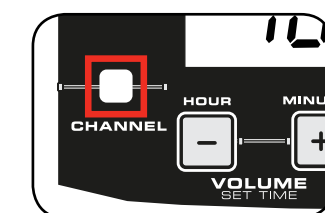

3. Using the Seek buttons, find a radio station you would like to save.

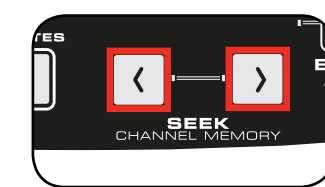

4. Press and hold the Channel button until the memory number flashes.

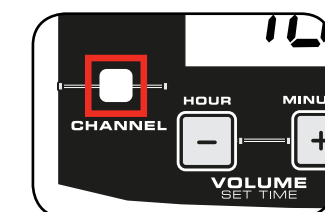

5. Press the Channel button again to save the radio station as this memory number.

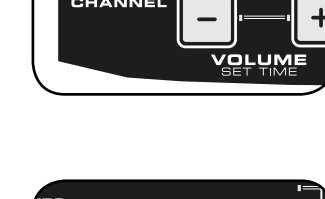

6. To save the next station, press Channel button once until next memory number shows on LCD display screen.

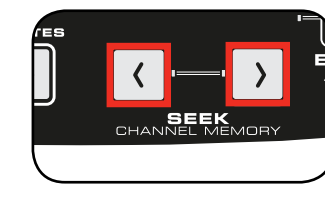

7. Using the Seek buttons, find the next radio station to save.

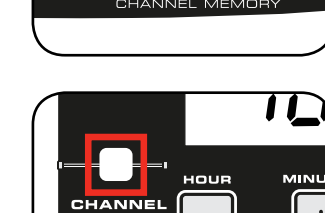

8. Press and hold the Channel button until the memory number flashes. Press Channel button again to save this station.

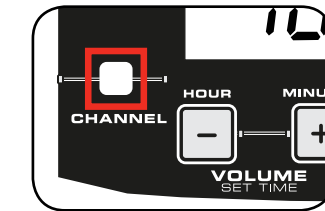

Note: Up to 10 radio stations can be saved on both the AM and FM modes. Repeat steps 6 to 8 as necessary to program more stations to the radio's memory.

9. After programming stations to memory, press the Channel button to search through the saved radio stations.

Note: The radio is able to automatically search and save radio stations to memory. Press and hold the Band button.