

KNOW YOUR PRODUCT

CORDLESS POLE HEDGE TRIMMER

1. Blade
2. Trimmer Head

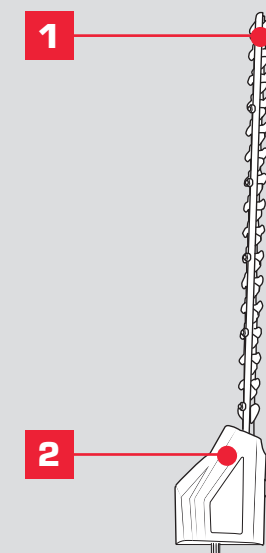

BATTERY & CHARGER

3. Battery Charge LED's
4. Battery Charge Indicator Button
5. Battery Release Tab
6. Charger LED's
7. Charger

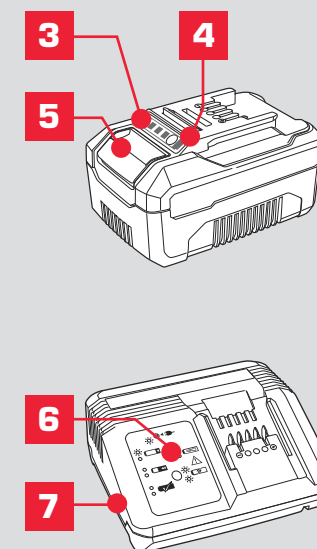

ONLINE MANUAL
Scan this QR Code with your mobile device to take you to the online manual.



SETUP & PREPARATION

1. BEFORE USE

Items Supplied

Please check that the article is complete as specified in the scope of delivery. If parts are missing, please contact our service centre or the sales outlet where you made your purchase at the latest within 5 working days after purchasing the product and upon presentation of a valid bill of purchase. Also, refer to the warranty table in the service information at the end of the operating instructions.

- Open the packaging and take out the equipment with care.
- Remove the packaging material and any packaging and/or transportation braces (if available).
- Check to see if all items are supplied.
- Inspect the equipment and accessories for transport damage.
- If possible, please keep the packaging until the end of the guarantee period.

! DANGER! THE EQUIPMENT AND PACKAGING MATERIAL ARE NOT TOYS. DO NOT LET CHILDREN PLAY WITH PLASTIC BAGS, FOILS OR SMALL PARTS. THERE IS A DANGER OF SWALLOWING OR SUFFOCATION!

Proper Use

Hedge trimmer

The hedge trimmer mounting kit is allowed to be used only on the supplied motor head.

Caution! This hedge trimmer is suitable for cutting hedges, bushes and shrubs. Caution! Do not use this equipment to cut grass.

The equipment is to be used only for its prescribed purpose. Any other use is deemed to be a case of misuse. The user/operator and not the manufacturer will be liable for any damage or injuries of any kind caused as a result of this.

Please note that our equipment has not been designed for use in commercial, trade or industrial applications. Our warranty will be voided if the machine is used in commercial, trade or industrial businesses or for equivalent purposes.

2. ASSEMBLY

! CAUTION! ENSURE THE TOOL IS OFF & THE BATTERY REMOVED BEFORE PERFORMING ANY OF THE FOLLOWING OPERATIONS.

Fitting Rear Handle

1. Push the rear handle fully onto tube aligning the internal prongs.

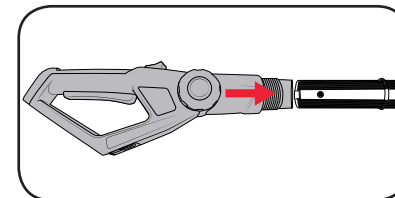

2. Screw tight with the assembly nut.

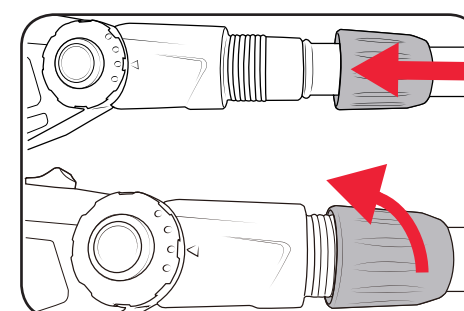

Fitting Auxiliary Handle

1. Place the Auxiliary Handle onto the mounting attachment.

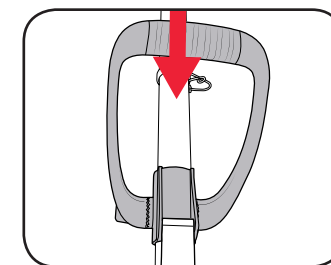

2. Pass the bolt through the auxiliary handle and screw the lever to the end of the bolt.

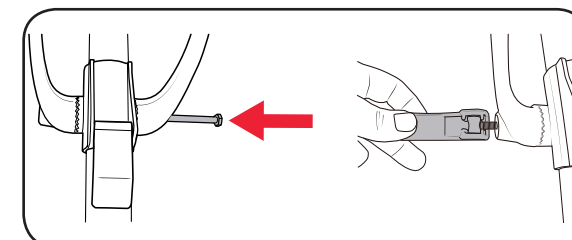

3. Select the most comfortable position and close the lever to lock the auxiliary handle in position.

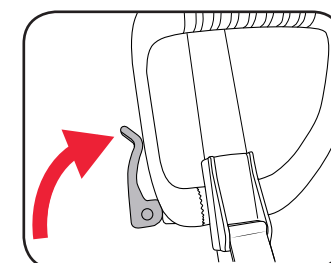

Fitting Trimmer Head

! CAUTION! THE BLADE HAS SHARP EDGES. FOR YOUR OWN SAFETY, PLEASE WEAR WORK GLOVES.

1. Align the Trimmer head and the motor head so the arrows on both coincide.

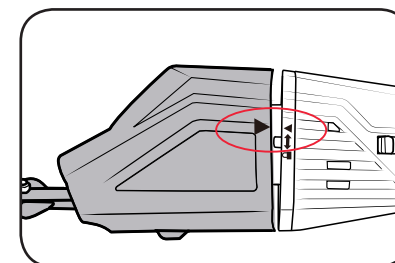

2. (a) Press the trimmer head against the motor head. This will cause the lock button to be pushed to the right.
(b) Turn the trimmer head clockwise. The trimmer head will lock onto the motor head and is then secured in place.

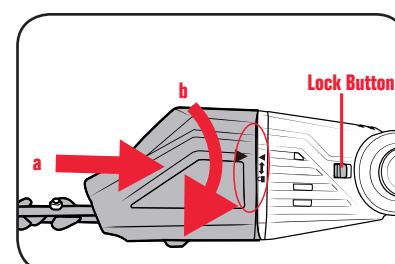

Note: The Lock Button will "CLICK" back to the left (original position) when the trimmer head is correctly secured in place.

Removing Trimmer Head

1. (a) Pull and hold the Lock Button to the right.
(b) Turn the Trimmer Head anti-clockwise so the arrows on the Motor Head and the Trimmer Head coincide, allowing the Trimmer Head to be removed.

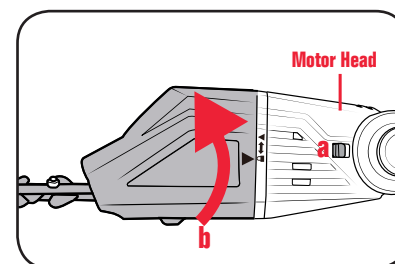

3. BATTERY & CHARGING

! CAUTION! THE CHARGER FOR THIS PRODUCT SHOULD BE PROTECTED BY A RESIDUAL CURRENT DEVICE (RATED AT 30mA OR LESS).

The purchased battery will be shipped in a low charge condition, and requires charging prior to use. Allow several cycles of charging and discharging (through use of the tool) for the battery to reach its optimum performance / runtime.

Charging your lithium ion battery - Fast Charger

1. Connect the charger into a mains power outlet.

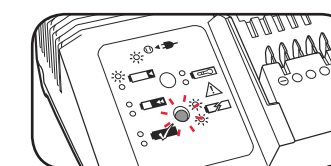

2. The charger LED will flash green showing power is being supplied to the charger.

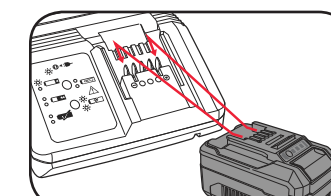

3. With the charger sitting on a flat surface, align the raised ribs on the battery with the recess in the charger and slide onto the charger ensuring a firm connection.

4. The charger LED will illuminate red signifying that the battery is charging.



5. The charger LED will illuminate green once the battery is fully charged.

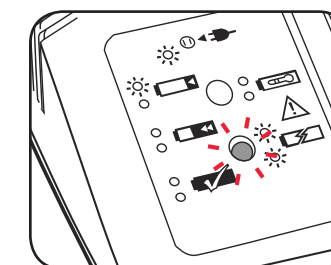

LED Indicator	Situation
GREEN (Flashing)	Stand By (no battery pack is inserted)
RED (Flashing)	Battery is charging (low charge)
RED (Illuminated)	Battery is charging (mid charge)
GREEN (Illuminated)	Battery is fully charged
BOTH (Illuminated)	Battery pack is too hot or too cold (charging will begin automatically when battery reaches correct charging temperature).
BOTH (Flashing)	Defective battery. Never charge a defective battery pack! Remove battery pack from charger.

Battery Charge Indicator

The purchased battery is equipped with a battery charge indicator to show the state of the battery charge. Press the charge indicator button and look to see which LED lights.

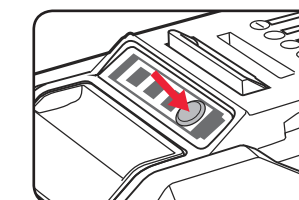

- Battery requires immediate charging
- Low state of charge, requires charging soon.
- Mid state of charge
- Full state of charge.

Note: The battery needs to be removed from the tool to check the state of charge.

4. PREPARATION

Adjusting the Telescope Length

1. To unlock the telescopic tube lock, twist it in a clockwise direction while pointing the trimmer blade away from the user.

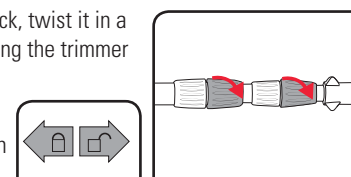

Note: The locking and unlocking directions are indicated on the locking collar.



2. Pull out the telescopic tubes to suit the required working height.

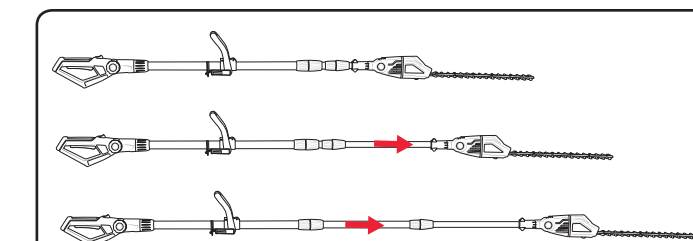

3. To lock in the desired position, twist the telescopic tube lock in a counter-clockwise direction.

Adjusting the Rear Handle

1. Press the two pivoting handle releases, one each side and adjust the angle of the handle up or down to any of 4 positions.

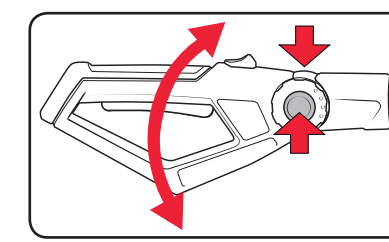

Adjusting the Additional Handle

1. (a) Open the handle lever and set the required (b) tilt of the additional handle, close to lock into position.

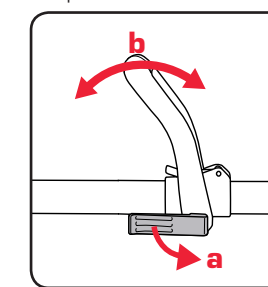

2. (a) Open the mounting bracket lever and (b) slide the additional handle into the required position, close to lock into position.

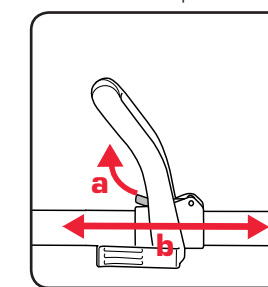

Pivoting the Trimmer Head

1. Press the two pivoting head releases, one each side and adjust the angle of the trimmer head up or down to any of 7 positions.

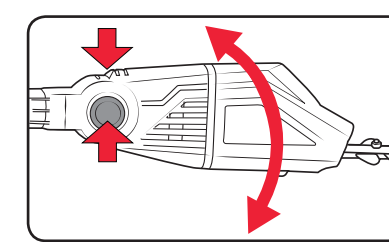

Attaching the Shoulder Strap

1. Fasten to the shoulder strap holder on the main tube.
2. Wear the shoulder strap so that it lies over the left shoulder.

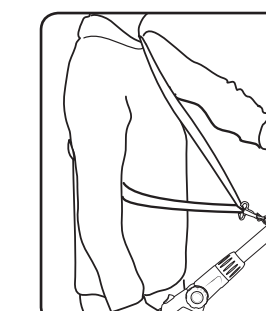
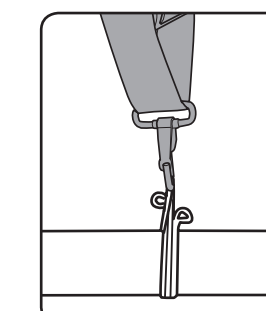

Installing a Battery into the Pole Trimmer

1. Align the ribs of the battery with the recess below the handle.

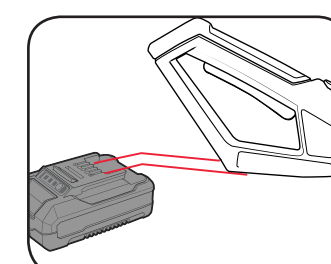

2. Slide the battery in so that it clicks into place.

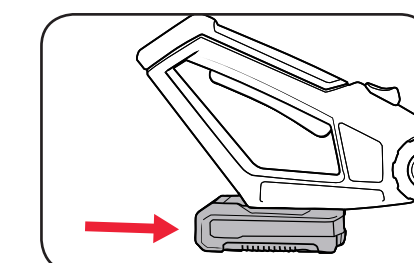

Removing a Battery from the Pole Trimmer

1. Press and hold the battery release tab to release the battery.

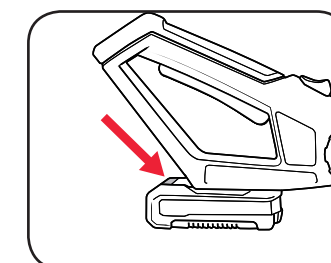

2. Slide the battery out.

