

KNOW YOUR PRODUCT

LINE TRIMMER

- | | |
|----------------------------|-------------------------------|
| 1. Secondary Handle | 8. Cord Retainer |
| 2. Locking Knob | 9. Main Handle |
| 3. Edging Guide | 10. Head Angle Release Button |
| 4. On/Off Trigger | 11. Edging Wheel |
| 5. Rotating Head Collar | 12. Cutter Head |
| 6. Telescopic Shaft Collar | 13. Safety Guard |
| 7. Telescopic Shaft | |

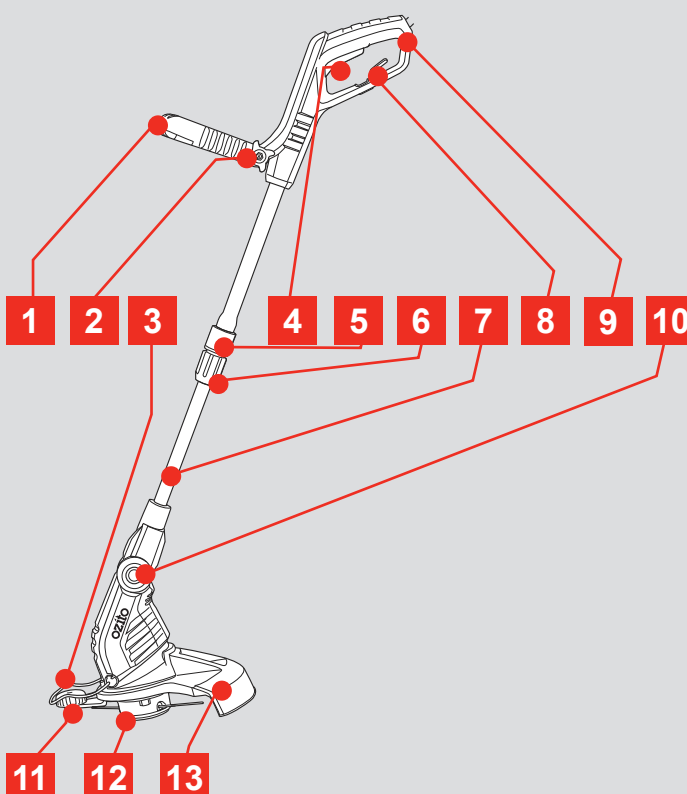

ACCESSORIES:

15. Assembly Screws x 4

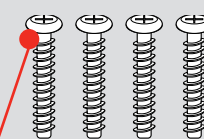

14

ONLINE MANUAL

Scan this QR Code with your mobile device to take you to the online manual.



SETUP & PREPARATION

1. BEFORE USE

Items Supplied

Please check that the article is complete as specified in the scope of delivery. If parts are missing, please contact our service centre or the sales outlet where you made your purchase at the latest within 5 working days after purchasing the product and upon presentation of a valid bill of purchase. Also, refer to the warranty table in the service information at the end of the operating instructions.

- Open the packaging and take out the equipment with care.
- Remove the packaging material and any packaging and/or transportation braces (if available).
- Check to see if all items are supplied.
- Inspect the equipment and accessories for transport damage.
- If possible, please keep the packaging until the end of the guarantee period.

Danger!

The equipment and packaging material are not toys. Do not let children play with plastic bags, foils or small parts. There is a danger of swallowing or suffocating!

Proper Use

The equipment is designed for cutting lawns and small areas of grass in private and hobby gardens.

Equipment designed for use in private and hobby gardens is regarded as unsuitable for use in public facilities, parks and sports centers, along roadways, or in agriculture and forestry. The operating instructions as supplied by the manufacturer must be kept and referred to in order to ensure that the equipment is properly used and maintained.

Important. This equipment must not be used for composting purposes (shredding) as this could result in injury or damage to property.

The equipment is to be used only for its prescribed purpose. Any other use is deemed to be a case of misuse. The user / operator and not the manufacturer will be liable for any damage or injuries of any kind caused as a result of this.

Please note that our equipment has not been designed for use in commercial, trade or industrial applications. Our warranty will be voided if the machine is used in commercial, trade or industrial businesses or for equivalent purposes.

Caution! Residual risks

Even if you use this electric power tool in accordance with instructions, certain residual risks cannot be ruled out. The following hazards may arise in connection with the equipment's construction and layout:

1. Lung damage if no suitable protective dust mask is used.
2. Damage to hearing if no suitable ear protection is used.
3. Health damage caused by hand-arm vibrations if the equipment is used over a prolonged period or is not properly guided and maintained.

2. ASSEMBLY

WARNING! ENSURE THE TOOL IS DISCONNECTED FROM THE POWER SUPPLY BEFORE PERFORMING ANY OF THE FOLLOWING OPERATIONS.

Fitting the Safety Guard

1. Turn the trimmer upside down and place the safety guard over the cutting head.
2. Rotate the guard into the correct position and secure with the supplied screws.

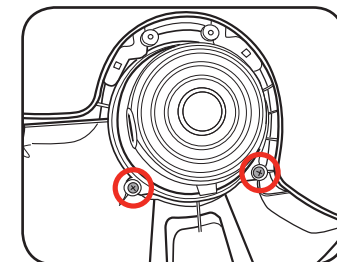
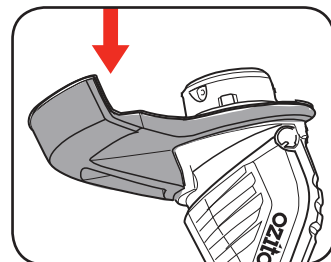

3. Align the edging wheel with the screw holes at the underside front of the safety guard and secure with the remaining supplied screws.

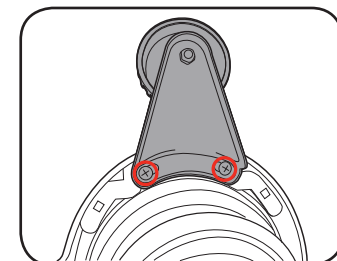

WARNING! NEVER USE THE LINE TRIMMER UNLESS THE SAFETY GUARD IS PROPERLY FITTED AND SECURED.

Fitting the Secondary Handle

1. Place the adjustable handle onto the line trimmer so that the holes align.
2. Pass the bolt through the handle and screw the locking knob loosely onto bolt.

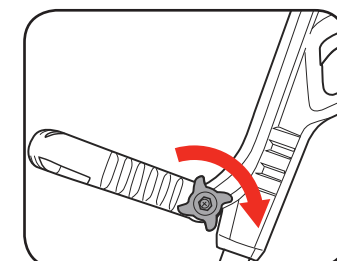
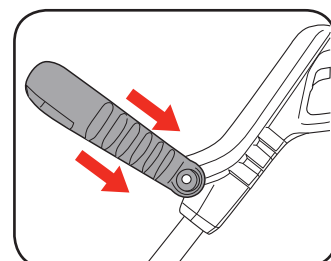

3. Rotate the handle into the most comfortable position and tighten the locking knob.

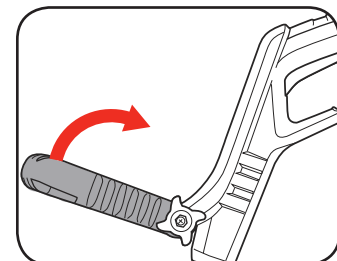

3. ADJUSTMENTS

Adjusting the Working Height

1. Loosen the Telescopic Shaft Collar by rotating in a clockwise direction.
2. Adjust the Telescopic Shaft up or down to the appropriate height.

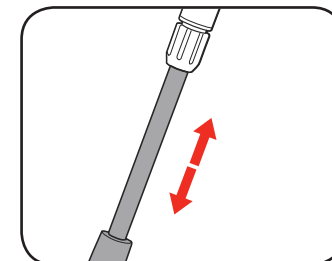
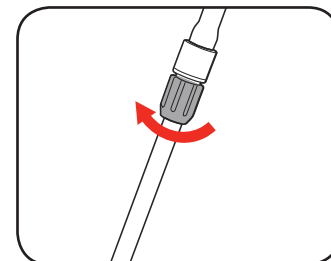

3. Tighten the Telescopic Shaft Collar once adjustment is complete.

Rotating the Cutting Head

1. Pull the Rotating Head Collar and turn the Telescopic shaft 180° anti-clockwise.

Note: The head will only rotate in one direction.

2. Release the Collar to lock in place.

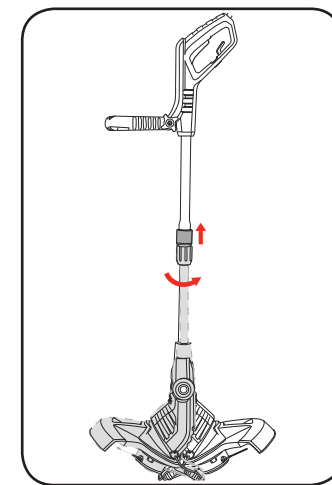

Adjusting the Cutter Head Angle

1. Depress the Head Angle Release Button.
2. Move the Telescopic Shaft into the desired position and release the Button.

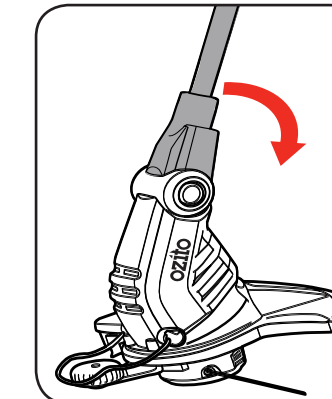
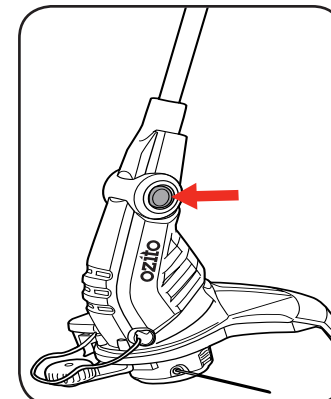

OPERATION

4. CONTROLS

CAUTION! TO REDUCE THE RISK OF ELECTRICAL SHOCK, A RESIDUAL CURRENT DEVICE (RATED 30mA OR LESS) SHOULD BE USED.

On/Off Trigger

1. To turn on squeeze the on/off trigger.
2. To turn off release the on/off trigger.

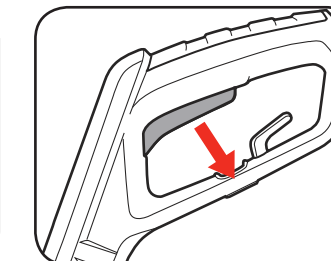
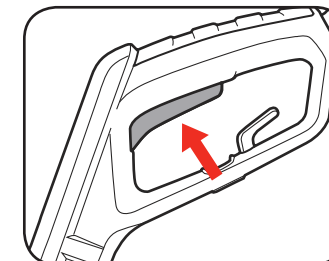

WARNING! THE LINE TRIMMER MAY RUN FOR A FEW SECONDS AFTER IT HAS BEEN SWITCHED OFF. LET THE MOTOR COME TO A COMPLETE STANDSTILL BEFORE SETTING THE TOOL DOWN.

Lengthening the Line

This line trimmer is equipped with Automatic Line Advancement which automatically feeds the additional line to the correct length as it wears down.

- To automatically advance the line, allow the line trimmer to come to a complete stop. When the head comes to a stop, a "Click" can be heard. The line will have automatically advanced approximately 5cm. If a longer length of line is required, repeat the automatic line advancement instruction.

- To manually advance the line, ensure the line trimmer is off and turn the line trimmer upside down. Push the tab on the side of the cutter head and then pull on the end of both pieces of line protruding from the cutter head.

Cutting Modes

The Cutter Head should be adjusted so that the trimmer can be held in this position comfortably as shown.

Edging Mode

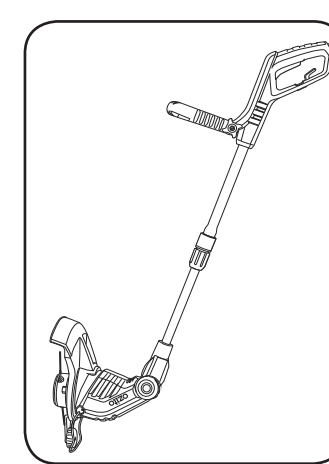

Trimming Mode

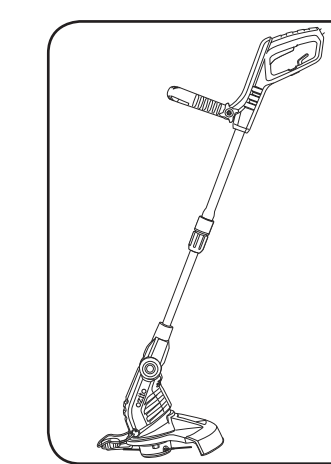

5. USING THE LINE TRIMMER

WARNING! MAKE SURE THAT THE WORK AREA IS FREE OF ROCKS, DEBRIS, LINES AND OTHER FOREIGN OBJECTS.

Using the Line Trimmer

CAUTION! DO NOT CONTINUALLY TAP, BUMP OR HOLD THE SPOOL HOLDER ON THE GROUND AS THIS MAY RESULT IN DAMAGE TO THE SPOOL HOLDER OR OVERLOAD THE UNIT.

1. Wear eye protection and stout shoes at all times while operating the line trimmer.
2. Start cutting nearest the mains power source and work away to make it easier to avoid the extension cord.

3. Do not push the line against hard material (rocks or concrete) during cutting as this may result in damaged line.

4. Never use the line trimmer without its safety devices.

5. Do not cut grass that is wet (The best results are achieved on dry grass).

6. Wait until the line trimmer reaches full speed before cutting the grass

7. Keep the line trimmer away from hard objects in order to avoid unnecessary wear to the line.

8. Several passes will be required to cut long grass.

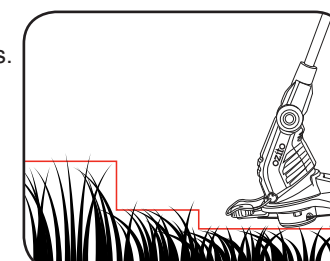

9. To prevent the line from breaking ensure you approach the edge/object slowly.

10. Watch out for kickbacks in the event of impact with hard objects

11. After finishing the cutting operation, keep the head close to ground level, release the switch and allow the motor to come to a complete standstill. Unplug and place the line trimmer on the ground.

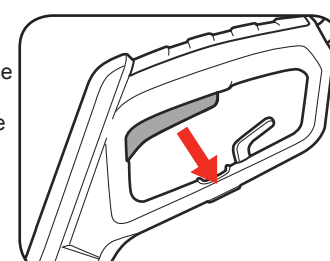

12. Keep ventilation slots of the trimmer clean at all times. Periodically clean out the grass from the cutting head and the rim of the safety guard to ensure efficient operation at all times.

6. TRIMMING AND EDGING

Trimming

Move the line trimmer from side to side as you walk forward, holding it at an angle of approx. 30° (Light cuts are better than heavy cuts as they allow the cut grass to fall away from the cutting head).

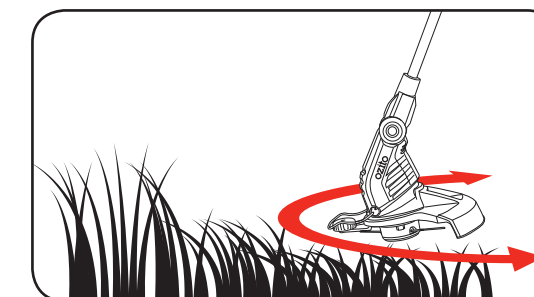

Edging

Place the edging wheel along the ground and roll the line trimmer along the edge of the path.

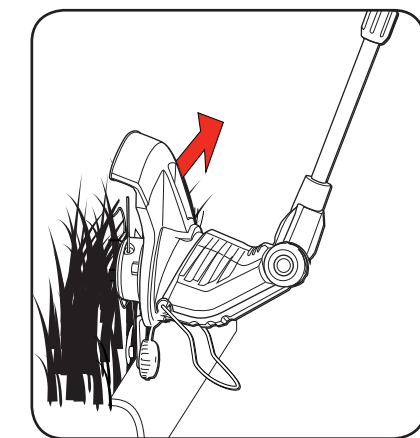

NOTE: DO NOT CUT GRASS WHEN WET. (THE BEST RESULTS ARE ACHIEVED ON DRY GRASS.)

NOTE: BEFORE STORING FEED EXTRA CUTTING LINE TO AVOID LOSING THE LINE COMPLETELY.

3 YEAR REPLACEMENT WARRANTY