

MAINTENANCE

WARNING! ENSURE THE TOOL IS DISCONNECTED FROM THE POWER SUPPLY BEFORE PERFORMING ANY OF THE FOLLOWING OPERATIONS.

After each use it is essential that the spray gun is cleaned thoroughly. This will prevent any blockages occurring and provide reliable performance when you next come to use it.

Cleaning

- Unscrew the paint pot and return remaining material into a container.
- Fill the paint pot with solvent or water. *Note: Only use solvents with a flash point over 21°C*

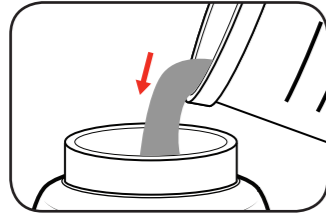
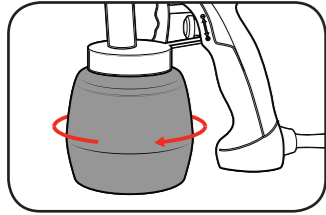

- Clean the paint pot and suction tube with a brush and then screw the pot back into the gun.
- Plug the gun back in and spray the solvent into a container. Repeat until clear solvent comes out.

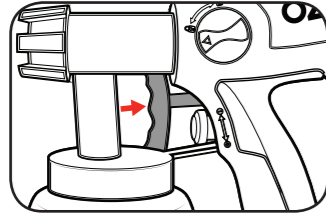
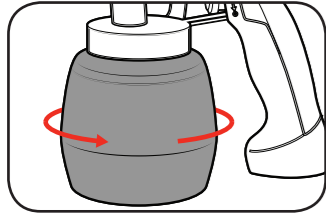

- Remove the paint pot and empty any remaining solvent.

Cleaning Parts

- Unscrew the air cap nut to remove the air cap.
- Turn both quick release knobs to remove the paint head.

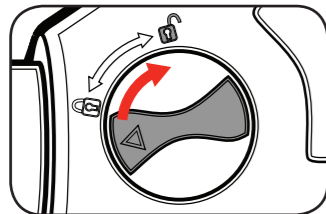
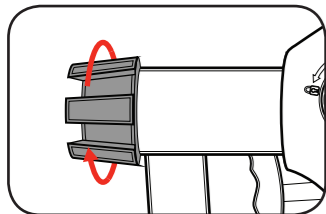

- Remove and dismantle the suction tube by turning clockwise.

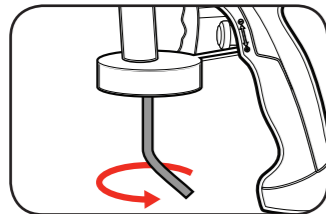

- Dip a cloth in solvent or water and clean the air cap, nozzle, gun housing, rear of the paint head and suction tube.

- Take note of the 3 holes on the suction tube, if blocked clean using the provided cleaning needle.

- Prior to storing the spray gun, ensure it is completely dry.

- Keep the vents of the spray gun clean at all times. If possible, prevent foreign matter from entering the vents.
- If the body of the spray gun requires cleaning, do not use solvents but a moist soft cloth only. Never let any liquid get inside the gun body; never immerse any part of the spray gun into a liquid.

Note: Ozito Industries will not be responsible for any damage or injuries caused by the repair of the sander by an unauthorised person or by mishandling of the spray gun.

TROUBLE SHOOTING

Problem	Cause	Remedy
Little or no material flow	Nozzle / Suction tube clogged Spray regulator dial to low Suction tube loose No pressure build up in paint pot Air filter clogged	Clean Increase regulator dial Insert Tighten paint pot Clean or replace
Material leaking	Nozzle loose Nozzle worn Material build up on air cap and nozzle	Tighten Replace Clean
Atomization is too coarse	Viscosity of material too high Material volume too large Nozzle clogged Air filter clogged Too little pressure build up in container	Thin material Decrease spray regulator dial Clean Clean or replace Tighten paint pot
Spray jet pulsates	Material in paint pot running out Air filter clogged	Refill Clean or replace
Pattern runs or sags	Applying to much material	Decrease spray regulator dial or increase movement speed
Too much overspray	Gun too far from spray object Too much material applied	Reduce distance Decrease spray regulator dial
Pattern is very light and splotchy	Moving the spray gun to fast	Decrease spray regulator dial or decrease movement speed

DESCRIPTION OF SYMBOLS

V	Volts	Hz	Hertz
~	Alternating current	W	Watts
°C	Degrees Celsius	BAR	Pressure rating
/min	Revolutions or reciprocation per minute		
	Do not use in raining		Double insulated
	Read Instruction manual		Wear eye, breathing, ear protection
	Warning		

SPARE PARTS

Spare parts can be ordered from the Special Orders Desk at your local Bunnings Warehouse or Homebase store.

For further information, or any parts visit

www.ozito-diy.co.uk or contact Ozito Customer Service:

Great Britain: 0151 294 4488

Ireland: 1850 882711

E-mail: enquires@ozito-diy.co.uk

ELECTRICAL SAFETY

WARNING! When using mains-powered tools, basic safety precautions, including the following, should always be followed to reduce risk of fire, electric shock, personal injury and material damage.
Read the whole manual carefully and make sure you know how to switch the tool off in an emergency, before operating the tool.
Save these instructions and other documents supplied with this tool for future reference.
Before you connect the equipment to the mains supply make sure that the data on the rating plate are identical to the mains data.

This tool is double insulated therefore no earth wire is required.

If the supply cord of this power tool is damaged, it must be replaced by a specially prepared cord available through the service organization.
Note: Double insulation does not take the place of normal safety precautions when operating this tool. The insulation system is for added protection against injury resulting from a possible electrical insulation failure within the tool.

Using an Extension Lead
Always use an approved extension lead suitable for the power input of this tool. Before use, inspect the extension lead for signs of damage, wear and ageing. Replace the extension lead if damaged or defective.
When using an extension lead on a reel, always unwind the lead completely. Use of an extension lead not suitable for the power input of the tool or which is damaged or defective may result in a risk of fire and electric shock.
To reduce the risk of electrical shock, a residual current device (rated 30mA or less) must be used.

GENERAL POWER TOOL SAFETY WARNINGS

WARNING! Read all safety warnings and all instructions. Failure to follow the warnings and instructions may result in electric shock, fire and/or serious injury.
Save all warnings and instructions for future reference. The term "power tool" in the warnings refers to your mains-operated (corded) power tool or battery-operated (cordless) power tool.

- Work area safety
 - Keep work area clean and well lit. Cluttered or dark areas invite accidents.
 - Do not operate power tools in explosive atmospheres, such as in the presence of flammable liquids, gases or dust. Power tools create sparks which may ignite the dust or fumes.
 - Keep children and bystanders away while operating a power tool. Distractions can cause you to lose control.
- Electrical safety
 - Power tool plugs must match the outlet. Never modify the plug in any way. Do not use any adapter plugs with earthed (grounded) power tools. Unmodified plugs and matching outlets will reduce risk of electric shock.
 - Avoid body contact with earthed or grounded surfaces, such as pipes, radiators, ranges and refrigerators. There is an increased risk of electric shock if your body is earthed or grounded.
 - Do not expose power tools to rain or wet conditions. Water entering a power tool will increase the risk of electric shock.
 - Do not abuse the cord. Never use the cord for carrying, pulling or unplugging the power tool. Keep cord away from heat, oil, sharp edges or moving parts. Damaged or entangled cords increase the risk of electric shock.
 - When operating a power tool outdoors, use an extension cord suitable for outdoor use. Use of a cord suitable for outdoor use reduces the risk of electric shock.
 - If operating a power tool in a damp location is unavoidable, use a residual current device (RCD) protected supply. Use of an RCD reduces the risk of electric shock.
- Personal safety
 - Stay alert, watch what you are doing and use common sense when operating a power tool. Do not use a power tool while you are tired or under the influence of drugs, alcohol or medication. A moment of inattention while operating power tools may result in serious personal injury.
 - Use personal protective equipment. Always wear eye protection. Protective equipment such as dust mask, non-skid safety shoes, hard hat, or hearing protection used for appropriate conditions will reduce personal injuries.
 - Prevent unintentional starting. Ensure the switch is in the off-position before connecting to power source and/or battery pack, picking up or carrying the tool. Carrying power tools with your finger on the switch or energising power tools that have the switch on invites accidents.
- Remove any adjusting key or wrench before turning the power tool on. A wrench or a key left attached to a rotating part of the power tool may result in personal injury.
- Do not overreach. Keep proper footing and balance at all times. This enables better control of the power tool in unexpected situations.
- Dress properly. Do not wear loose clothing or jewellery. Keep your hair, clothing and gloves away from moving parts. Loose clothes, jewellery or long hair can be caught in moving parts.
- If devices are provided for the connection of dust extraction and collection facilities, ensure these are connected and properly used. Use of dust collection can reduce dust-related hazards.
- Power tool use and care
 - Do not force the power tool. Use the correct power tool for your application. The correct power tool will do the job better and safer at the rate for which it was designed.
 - Do not use the power tool if the switch does not turn it on and off. Any power tool that cannot be controlled with the switch is dangerous and must be repaired.
 - Disconnect the plug from the power source and/or the battery pack from the power tool before making any adjustments, changing accessories, or storing power tools. Such preventive safety measures reduce the risk of starting the power tool accidentally.
 - Store idle power tools out of the reach of children and do not allow persons unfamiliar with the power tool or these instructions to operate the power tool. Power tools are dangerous in the hands of untrained users.
 - Maintain power tools. Check for misalignment or binding of moving parts, breakage of parts and any other condition that may affect the power tool's operation. If damaged, have the power tool repaired before use. Many accidents are caused by poorly maintained power tools.
 - Keep cutting tools sharp and clean. Properly maintained cutting tools with sharp cutting edges are less likely to bind and are easier to control.
 - Use the power tool, accessories and tool bits etc. in accordance with these instructions, taking into account the working conditions and the work to be performed. Use of the power tool for operations different from those intended could result in a hazardous situation.
- Service
 - Have your power tool serviced by a qualified repair person using only identical replacement parts. This will ensure that the safety of the power tool is maintained.

SPRAY GUN SAFETY WARNINGS

WARNING! Hold power tool by insulated gripping surfaces, when performing an operation where the cutting accessory may contact hidden wiring or its own cord. Cutting accessory contacting a "live" wire may make exposed metal parts of the power tool "live" and could give the operator an electric shock.

This appliance is not intended for use by persons (including children) with reduced physical, sensory or mental capabilities, or lack of experience and knowledge, unless they have been given supervision or instruction concerning use of the appliance by a person responsible for their safety.

Using an Extension Lead

Always use an approved extension lead suitable for the power input of this tool. Before use, inspect the extension lead for signs of damage, wear and ageing. Replace the extension lead if damaged or defective.

When using an extension lead on a reel, always unwind the lead completely. Use of an extension lead not suitable for the power input of the tool or which is damaged or defective may result in a risk of fire and electric shock.

It is recommended that the extension lead is a maximum of 25m in length. Do Not use multiple extension leads.

NEVER under any circumstances aim the nozzle at another person or animal.

- In the event of an injury occurring, seek medical advice immediately.
- The spray gun must not be used for spraying flammable paints and solvents with a flash point of less than 21°C.
- Always ensure there is adequate ventilation when spraying.
- The use of ear protection is recommended.
- Eye protection is recommended to keep hazardous vapours and liquids out of eyes.
- Always wear a face mask when spraying.
- Always read the paint manufacturers thinning instructions before using.
- Always keep the spray basket nozzle in place during use. Never allow the spray to come in direct contact with the skin.

DANGER! Never immerse the spray gun in liquid. This could lead to electric shock, personal injury and material damage.

- The spray gun must not be cleaned by using flammable liquids with a flash point of less than 21°C.

NEVER spray near a naked flame, including an appliance pilot light.

NEVER smoke whilst spraying.

NEVER allow children to operate or play with the spray gun.

- Before cleaning, always disconnect the appliance from the mains supply.

- Always disconnect from mains supply when refilling the paint pot.

- After every use ensure you clean your spray gun thoroughly.

NEVER use the spray gun outside when it is raining.

ozito

SPRAY GUN

400W

ORIGINAL INSTRUCTIONS

SPECIFICATIONS

Voltage:	220-240V ~ 50Hz
Power:	400W
Max. Flow Rate:	450ml/min
Max. Viscosity:	30DIN-s
Pot Capacity:	800ml
Nozzle:	ø2.5mm
Weight (tool only):	1.5kg

ozito-diy.co.uk

1 YEAR WARRANTY



WHAT'S IN THE BOX

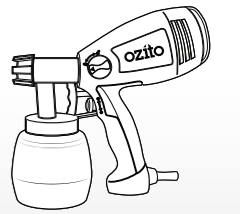

Spray Gun

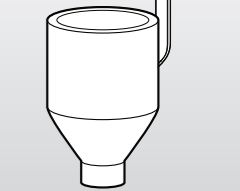

Viscosity Cup



Cleaning Needle

SGP-300U

WARRANTY

All of our products undergo strict quality checks to ensure that they reach you in perfect condition. In the unlikely event that your device develops a fault, please contact our service department at the address shown on this guarantee card. You can also contact us by telephone using the customer service number shown. Please note the following terms under which guarantee claims can be made:

1. These warranty terms regulate additional warranty services, which the manufacturer mentioned below promises to buyers of its new products in addition to their statutory guarantee claims are not affected by this guarantee. Our guarantee is free of charge to you.

2. The warranty services only covers defects due to material or manufacturing faults on a product which you have bought from the manufacturer mentioned below are limited to either the rectification of said defects on the product or the replacement of the product, whichever we prefer.

Please note that our devices are not designed for use in commercial, trade or professional applications. A guarantee contract will not be created if the device has been used by commercial, trade or industrial business or has been exposed to similar stresses during the guarantee period.

3. The following are not covered by our guarantee:
- Damage to the device caused by a failure to follow the assembly instructions or due to incorrect installation, a failure to follow the operating instructions (for example connecting it to an incorrect mains voltage or current type) or a failure to follow the maintenance and safety instructions or by exposing the device to abnormal environmental conditions or by lack of care and maintenance.

- Damage to the device caused by abuse or incorrect use (for example overloading the device or the use of unapproved tools or accessories), ingress of foreign bodies into the device (such as sand, stones or dust, transport damage), the use of force or damage caused by external forces (for example by dropping it).

- Damage to the device or parts of the device caused by normal or natural wear or tear or by normal use of the device.

4. Your Product is guaranteed for a period of 12 months from the original date of purchase and is intended for DIY (Do It Yourself) use only. Warranty excludes consumable parts. Guarantee claims should be submitted before the end of the guarantee period within two weeks of the defect being noticed. No guarantee claims will be accepted after the end of the guarantee period. The original guarantee period remains applicable to the device even if repairs are carried out or parts are replaced. In such cases, the work performed or parts fitted will not result in an extension of the guarantee period, and no new guarantee will become active for the work performed or parts fitted. This also applies if an on-site service is used.

IN ORDER TO MAKE A CLAIM UNDER THIS WARRANTY YOU MUST RETURN THE PRODUCT TO THE PLACE OF PURCHASE WITH YOUR REGISTER RECEIPT.

Please refer to the restrictions of this warranty concerning wearing parts, consumables and missing parts as set out in the service information in these operating instructions.

CUSTOMER SERVICE HELPLINE

GB: 0151 294 4488

IRL: 1850 882711

Ozito-diy.co.uk

KNOW YOUR PRODUCT

SPRAY GUN

- 1 Air Cap
- 2 Nozzle
- 3 On/Off Trigger
- 4 Paint Pot
- 5 Spray Regulator Dial
- 6 Soft Grip Handle
- 7 Quick Release Dial
- 8 Air filter

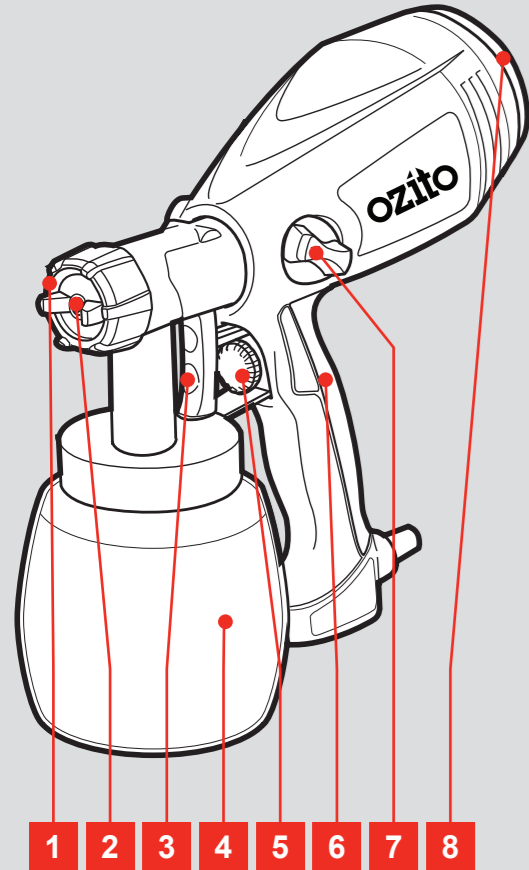

ACCESSORIES

- 9 Viscosity Cup
- 10 Cleaning Needle

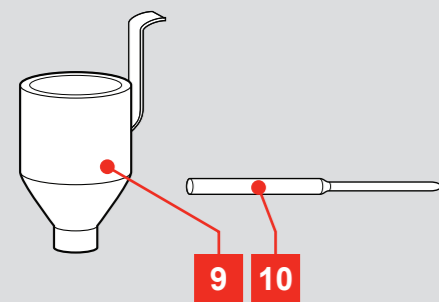

ONLINE MANUAL

Scan this QR Code with your mobile device to take you to the online manual.



SETUP & PREPARATION

1. ASSEMBLY

WARNING! ENSURE THE TOOL IS DISCONNECTED FROM THE POWER SUPPLY BEFORE PERFORMING ANY OF THE FOLLOWING OPERATIONS.

Inserting the Paint Head

- Turn the quick release knobs on both sides of the body to the unlock position.

Note: Ensure the paint head and spray gun body are aligned correctly for proper fitting

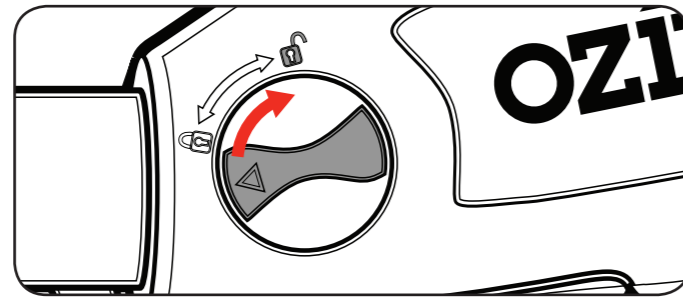

- Insert the paint head fully into the gun body.
- Turn the quick release knobs on both sides to the lock position to secure paint head

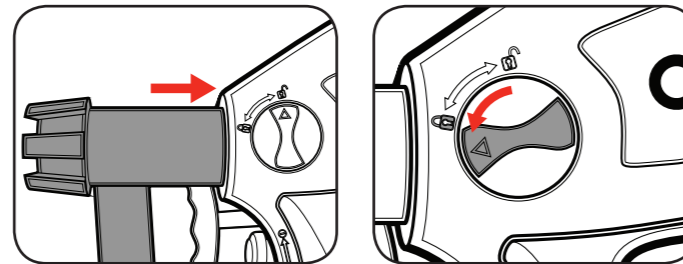

Aligning the Suction Tube

- When spraying horizontal or low objects turn the suction tube to the front.
- When spraying overhead objects turn the suction tube to the back.

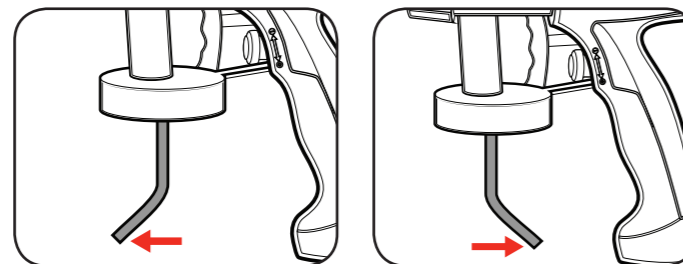

2. PREPARATION

NOTE: FOR BEST RESULTS, SURFACE PREPARATION AND PAINT THINNING ARE THE TWO MOST IMPORTANT AREAS. ENSURE ALL SURFACES ARE FREE OF DUST, DIRT AND GREASE.

Thinning

Thinning is particularly important when spraying. Most paints are supplied ready for brush application and need to be diluted sufficiently for spraying purposes. Follow the manufacturers guide for thinning ratios which should be labelled on the paint container.

- Before pouring any paint or thinners work out how much of each substance is needed.
- Pour the required paint and thinners using a filter into a mixing cup and mix thoroughly.

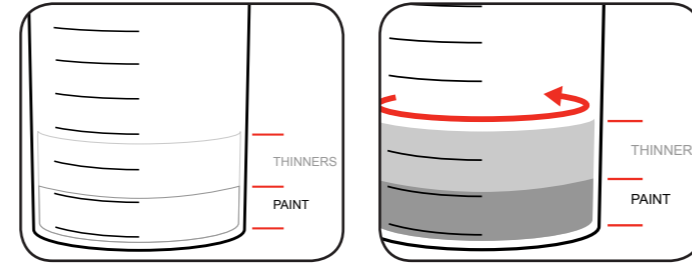

Determining Viscosity

It is vital to determine the viscosity of the coating material to see if it is suitable to be used in the spray gun.

- Submerge the viscosity cup into the material to fill.
- Raise the cup out of the material and start timing.

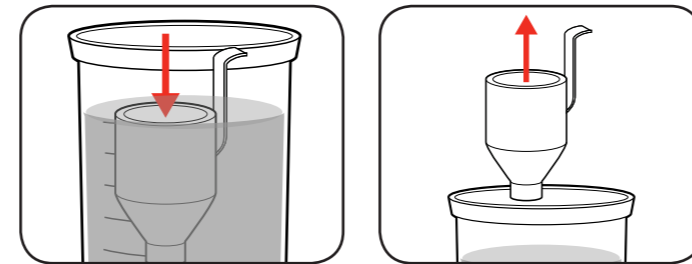

- Time how long it takes to empty the cup. This is referred to as DIN seconds.

- If the material is above 30 DIN-S the material will need to be thinned more and retested.

IMPORTANT! THE SPRAY GUN CANNOT BE USED WITH MATERIALS CONTAINING ABRASIVE SUBSTANCES, GLAZES, DISPERSION PAINTS, CAUSTIC AND ALKALINE SUBSTANCES OR TEXTURED COATINGS.

OPERATION

3. CONTROLS

CAUTION: TO REDUCE THE RISK OF ELECTRICAL SHOCK, A RESIDUAL CURRENT DEVICE (RATED 30MA OR LESS) MUST BE USED.

On/Off Trigger

- Squeeze the on/off trigger to start spraying.
- Release the on/off trigger to stop spraying.

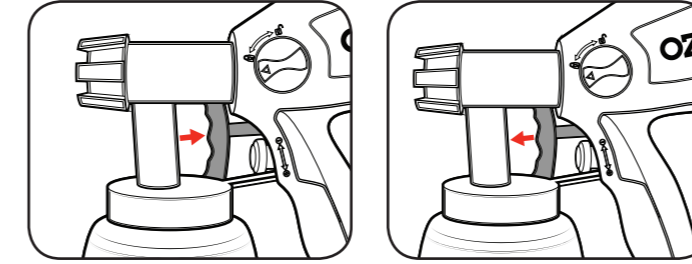

Spray Regulator Dial

The regulator dial is a stop that limits the distance the trigger can be pressed. This results in less material being sprayed.

- Squeeze the trigger while aiming at a piece of cardboard or scrap.
- Rotate the regulator dial to the required position for optimal results.

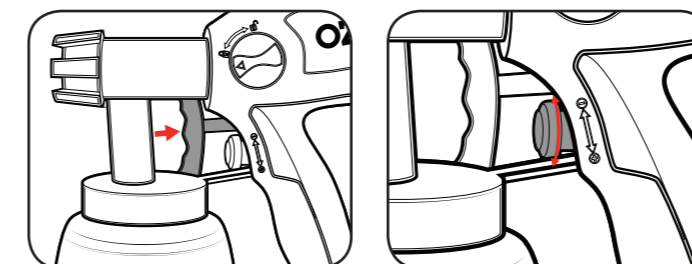

Replacing Air Filter

Filters can be purchased in packs of 2 (p/n: SPSPG300-03) and are available from the Special Orders Desk at any Bunnings Warehouse.

- Remove the filter cover with a flat screwdriver.
- Wash or replace the dirty filter and place inside the inner cover.

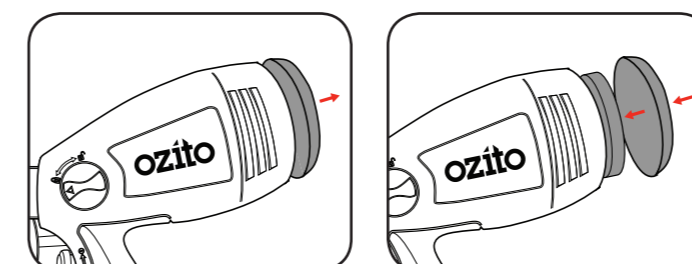

- Clip the inner cover and filter cover back onto the spray gun.

WARNING! NEVER OPERATE THE SPRAY GUN WITHOUT A FILTER. DIRT COULD BE SUCKED IN AND DAMAGE THE OPERATION OF THE UNIT.

4. ADJUSTING THE SPRAY GUN

Choosing Spray Patterns

To change spray patterns simply loosen the air cap and rotate to the desired position. Ensure that the air cap is tightened again to secure in place.

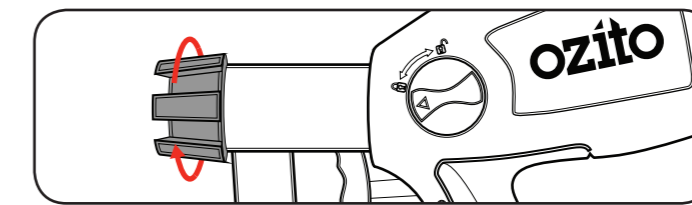

- For vertical surfaces use a horizontal fan. This is done by rotating the air cap into the position shown to the right.

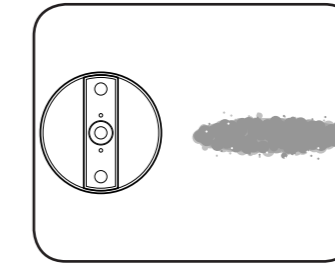

- For horizontal surfaces use a vertical fan. This is done by rotating the air cap into the position shown to the right.

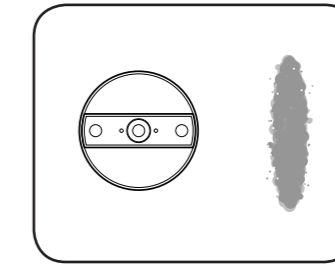

- For corners, edges and other hard to access places use a round fan. This is done by rotating the air cap into the position shown to the right.

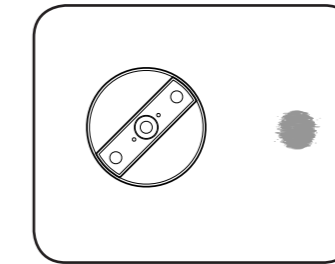

Spraying Technique

- Start off your workpiece and spray in a smooth speed maintaining a distance of roughly 20cm from the workpiece. Be sure to keep the spray gun at a perpendicular angle.

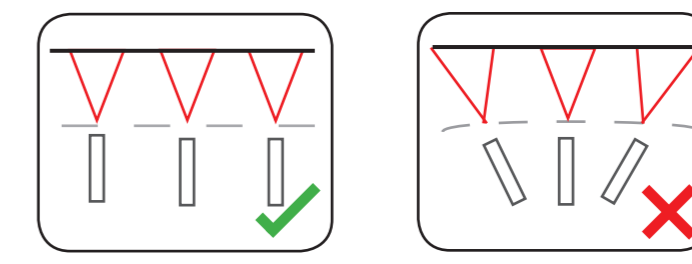

5. HOW TO SPRAY

Preparation

- Work out how much of each substance is needed.
- Filter and mix the material using the manufactures guide

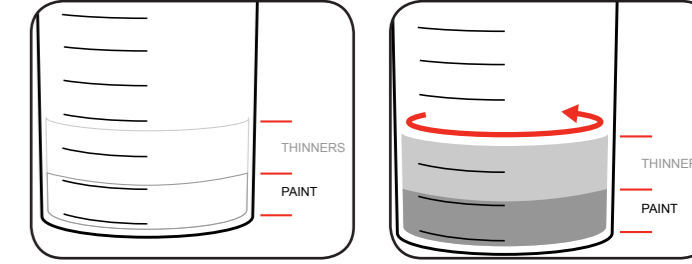

- Check the viscosity is less than 30 DIN-S to suit the spray gun.

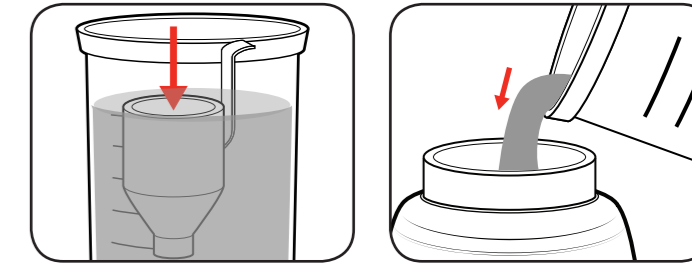

- Pour the material into the paint cup.

Adjustments

- Adjust the suction tube and air cap into the desired position for the job.
- Spray onto scrap material to check that the spray pattern is correct.

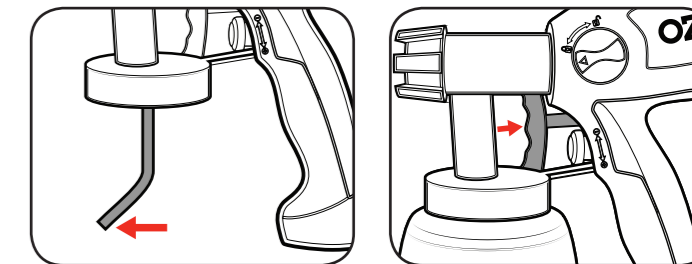

Spraying Technique

- Evenly control the speed of movement along the workpiece while maintaining distance and angle to the piece.
- Overlap each stroke by 2cm to achieve an even coat.

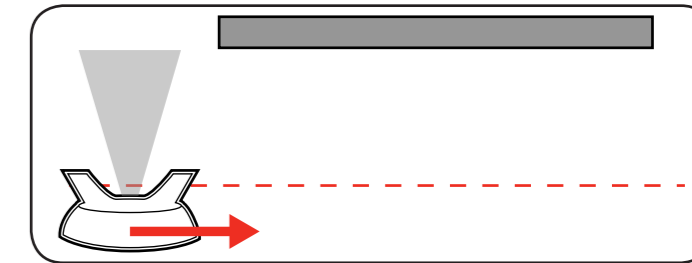

1 YEAR WARRANTY