

TROUBLESHOOTING

WARNING! ENSURE THE TOOL IS SWITCHED OFF AND THE BATTERY IS REMOVED BEFORE PERFORMING ANY OF THE FOLLOWING TASKS.

Short Battery Runtime

Ensure the battery is properly charge. It will take 4-5 charging cycles before the battery reaches optimum charge and run time.

Sanding Disc not sanding

If the sanding disc is no longer sanding, please change the sanding disc.

MAINTENANCE

WARNING! BEFORE CLEANING OR CARRYING OUT ANY MAINTENANCE PROCEDURE, ENSURE THAT THE BATTERIES HAVE BEEN REMOVED.

Cleaning

- Keep the ventilation slots of the tool clean at all times to ensure efficient operation.
- After each use, blow air through the tool housing to ensure it is free from all dust, dirt, etc. Build up of dust or dirt particles may cause the tool to overheat and shorten the life of the tool.
- If the housing of the tool requires cleaning, do not use solvents. Use of a cloth only is recommended.
- Never allow any liquid to get inside the tool, never immerse any part of the tool into liquid.

Carbon Brushes

When the carbon brushes wear out, the tool will spark and/or stop. Discontinue use as soon as this happens. They should be replaced prior to recommencing use. Carbon brushes are a wearing component of the tool therefore not covered under warranty. Continuing to use when carbon brushes need to be replaced may cause permanent damage to the tool. The tool to an electrician or a power tool repairer for a quick and low cost replacement. Always replace both carbon brushes at the same time.

Note: A small amount of sparking may be visible through the housing vents. This is normal and does not indicate a problem.

Replacing The Hook & Loop Sanding Pad

After considerable use, the hook and loop backing pad surface will become worn, and must be replaced when it no longer offers a firm grip. Contact Ozito Customer Service for replacement parts.

- To replace, remove the four Philips head screws on the base of the unit.
- Place the new backing pad on the tool and replace the screws to secure it.

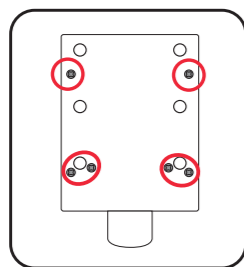

Storage

When not in use, the tool should be stored in a dry, frost free location, keep out of children's reach.

Note: Ozito Industries will not be responsible for any damage or injuries caused by repair of the tool by an unauthorised person or by mishandling.

DESCRIPTION OF SYMBOLS

V	Volts	⎓	Direct Current
n ₀	No Load Speed	mm	Millimetre
	Regulatory Compliance Mark (RCM)	/min	Per minute
	Wear eye, ear & breathing protection		Warning
	Read Instruction Manual		

CARING FOR THE ENVIRONMENT



Power tools that are no longer usable should not be disposed of with household waste but in an environmentally friendly way. Please recycle where facilities exist. Check with your local council authority for recycling advice.



Recycling packaging reduces the need for landfill and raw materials. Reuse of recycled material decreases pollution in the environment. Please recycle packaging where facilities exist. Check with your local council authority for recycling advice.

SPARE PARTS

Spare parts can be ordered from the Special Orders Desk at your local Bunnings Warehouse.

For further information, or any parts not listed here, visit www.ozito.com.au or contact Ozito Customer

Service:

Australia 1800 069 486

New Zealand 0508 069 486

E-mail: enquiries@ozito.com.au

ELECTRICAL SAFETY

WARNING! When using electric tools basic safety precautions should always be followed to reduce the risk of fire, electric shock and personal injury.

! Read the whole manual carefully and make sure you know how to switch the tool off in an emergency, before operating the tool. Save these instructions and other documents supplied with this tool for future reference.

- This appliance is not intended for use by persons (including children) with reduced physical, sensory or mental capabilities, or lack of experience and knowledge, unless they have been given supervision or instruction concerning use of the appliance by a person responsible for their safety.
- Children should be supervised to ensure that they do not play with the appliance.

GENERAL POWER TOOL SAFETY WARNINGS

WARNING! Read all safety warnings, instructions, illustrations and specifications provided with this power tool. Failure to follow all instructions listed below may result in electric shock, fire and/or serious injury.

Save all warnings and instructions for future reference.

The term "power tool" in the warnings refers to your mains-operated (corded) power tool or battery-operated (cordless) power tool.

1) Work area safety

a) Keep work area clean and well lit. Cluttered or dark areas invite accidents.

b) Do not operate power tools in explosive atmospheres, such as in the presence of flammable liquids, gases or dust. Power tools create sparks which may ignite the dust or fumes.

c) Keep children and bystanders away while operating a power tool. Distractions can cause you to lose control.

2) Electrical safety

a) Power tool plugs must match the outlet. Never modify the plug in any way. Do not use any adapter plugs with earthed (grounded) power tools. Unmodified plugs and matching outlets will reduce risk of electric shock.

b) Avoid body contact with earthed or grounded surfaces, such as pipes, radiators, ranges and refrigerators. There is an increased risk of electric shock if your body is earthed or grounded.

c) Do not expose power tools to rain or wet conditions. Water entering a power tool will increase the risk of electric shock.

d) Do not abuse the cord. Never use the cord for carrying, pulling or unplugging the power tool. Keep cord away from heat, oil, sharp edges or moving parts. Damaged or entangled cords increase the risk of electric shock.

e) When operating a power tool outdoors, use an extension cord suitable for outdoor use. Use of a cord suitable for outdoor use reduces the risk of electric shock.

f) If operating a power tool in a damp location is unavoidable, use a residual current device (RCD) protected supply. Use of an RCD reduces the risk of electric shock.

3) Personal safety

a) Stay alert, watch what you are doing and use common sense when operating a power tool. Do not use a power tool while you are tired or under the influence of drugs, alcohol or medication. A moment of inattention while operating power tools may result in serious personal injury.

b) Use personal protective equipment. Always wear eye protection. Protective equipment such as a dust mask, non-skid safety shoes, hard hat or hearing protection used for appropriate conditions will reduce personal injuries.

c) Prevent unintentional starting. Ensure the switch is in the off-position before connecting to power source and/or battery pack, picking up or carrying the tool. Carrying power tools with your finger on the switch or energising power tools that have the switch on invites accidents.

d) Remove any adjusting key or wrench before turning the power tool on. A wrench or a key left attached to a rotating part of the power tool may result in personal injury.

e) Do not overreach. Keep proper footing and balance at all times. This enables better control of the power tool in unexpected situations.

f) Dress properly. Do not wear loose clothing or jewellery. Keep your hair and clothing away from moving parts. Loose clothes, jewellery or long hair can be caught in moving parts.

g) If devices are provided for the connection of dust extraction and collection facilities, ensure these are connected and properly used. Use of dust collection can reduce dust-related hazards.

1/4 SHEET SANDER SAFETY WARNINGS

WARNING! The appliance is not to be used by persons (including children) with reduced physical, sensory or mental capabilities, or lack of experience and knowledge, unless they have been given supervision or instruction.

Young children should be supervised to ensure that they do not play with the appliance.

- Disposing of dust. Be extremely careful of dust disposal, materials in fine particle form may be explosive. Do not throw sanding dust on an open fire. Spontaneous combustion, may in time, result from a mixture of oil or water with dust particles.
- Always wear eye protection and a dust mask for dusty applications and when sanding overhead. Sanding particles can be absorbed by your eyes and inhaled easily and may cause health complications.
- Use special precautions when sanding chemically pressure treated timber, paint that may be lead based, or any other materials that may contain carcinogens. A suitable breathing respirator and protective clothing must be worn by all persons entering the work area. Work should be sealed by plastic sheeting and persons not protected should be kept out until work area is thoroughly cleaned.
- Do not 'wet sand' with this sander. Liquids entering the motor housing are an electrical shock hazard.

- This appliance is compatible and only to be used with all batteries & chargers from the Ozito PXC range. Refer to the PXC battery and charger manuals for information regarding charging, use and storage.

WARNING! Always remove the battery from the tool:

- when the batteries are to be charged,
- when the tool is left unattended,
- when the tool is being checked, cleaned, or having maintenance work done,
- when the tool is to be stored, or if the tool vibrates abnormally,
- Do not combine different types of batteries or new and used batteries.
- Do not use modified or damaged batteries.



18V CORDLESS

1/4 SHEET SANDER

INSTRUCTION MANUAL

SPECIFICATIONS

Input:	18V
No Load Speed:	11,000/min
Sand Paper Size:	113x101mm(1/4 sheet)
Oscillatory Speed:	22,000/min
Oscillatory Circuit:	1.8mm
Weight:	1.03kg

ozito.com.au

5 YEAR
REPLACEMENT WARRANTY

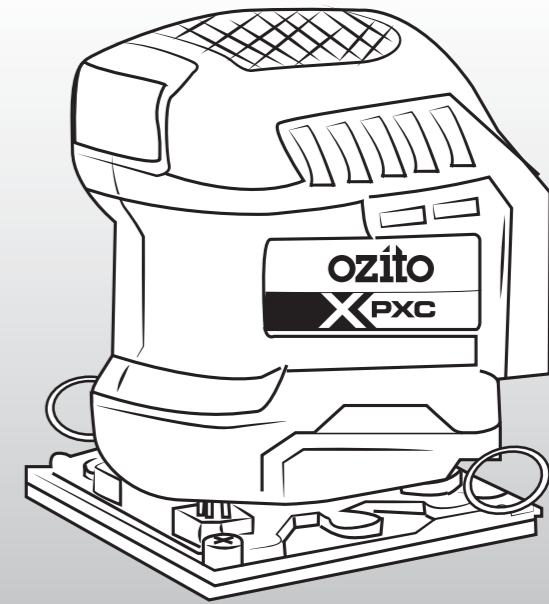

STANDARD EQUIPMENT



Cordless 1/4 Sheet Sander

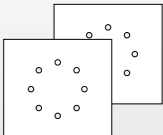

2 x 120grit Sandpaper

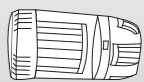

Dust Canister



Paper Punch Plate

PXQSS-018

WARRANTY

IN ORDER TO MAKE A CLAIM UNDER THIS WARRANTY YOU MUST RETURN THE PRODUCT TO YOUR NEAREST BUNNINGS WAREHOUSE WITH YOUR BUNNINGS REGISTER RECEIPT. PRIOR TO RETURNING YOUR PRODUCT FOR WARRANTY PLEASE TELEPHONE OUR CUSTOMER SERVICE HELPLINE:

Australia 1800 069 486
New Zealand 0508 069 486

TO ENSURE A SPEEDY RESPONSE PLEASE HAVE THE MODEL NUMBER AND DATE OF PURCHASE AVAILABLE. A CUSTOMER SERVICE REPRESENTATIVE WILL TAKE YOUR CALL AND ANSWER ANY QUESTIONS YOU MAY HAVE RELATING TO THE WARRANTY POLICY OR PROCEDURE.

WARNING

The following actions will result in the warranty being void.

- If the tool has been operated on a supply voltage other than that specified on the tool.
- If the tool shows signs of damage or defects caused by or resulting from abuse, accidents or alterations.
- Failure to perform maintenance as set out within the instruction manual.
- If the tool is disassembled or tampered with in any way.

The benefits provided under this warranty are in addition to other rights and remedies which are available to you at law.

Our goods come with guarantees that cannot be excluded at law. You are entitled to a replacement or refund for a major failure and for compensation for any other reasonably foreseeable loss or damage. You are also entitled to have the goods repaired or replaced if the goods fail to be of acceptable quality and the failure does not amount to a major failure.

Generally you will be responsible for all costs associated with a claim under this warranty, however, where you have suffered any additional direct loss as a result of a defective product you may be able to claim such expenses by contacting our customer service helpline above.

5 YEAR REPLACEMENT WARRANTY

Your Product is guaranteed for a period of 60 months from the original date of purchase and is intended for DIY (Do It Yourself) use only. If a product is defective it will be replaced in accordance with the terms of this warranty. **Lithium Ion batteries and chargers are covered by a 36 month warranty** and are excluded from the warranty extension. Warranty excludes consumable parts.

KNOW YOUR PRODUCT

CORDLESS 1/4 SHEET SANDER

1. On/Off Switch
2. Sure Grip Comfort
3. Battery Seating
4. Dust Extraction Port
5. Clamping Lever
6. Square Sanding Base

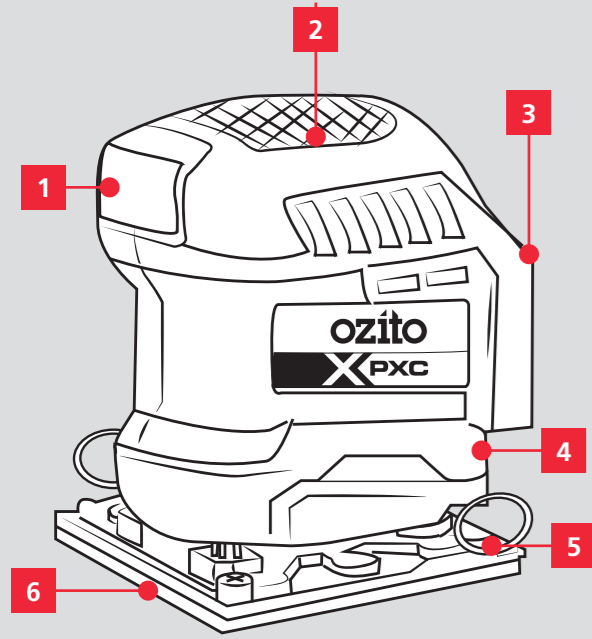

ACCESSORIES

7. 2 x 120grit Sandpaper
8. Dust Canister
9. Paper Punch Plate

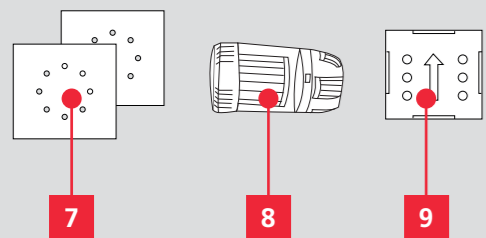

BATTERY & CHARGER

This tool is compatible with all batteries & chargers from the Ozito PXC range.

ONLINE MANUAL

Scan this QR Code with your mobile device to take you to the online manual.



SETUP & PREPARATION

1. ACCESSORIES

WARNING! ENSURE THE TOOL IS SWITCHED OFF AND THE BATTERY IS REMOVED BEFORE PERFORMING ANY OF THE FOLLOWING TASKS.

Installing The Dust Extraction Canister

1. Now connect the supplied dust canister to the dust extractor port.

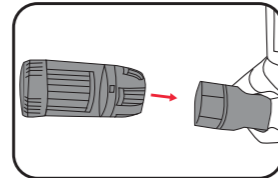

Note: You can also attach an Ozito Vacuum hose this dust extraction port with adaptor.

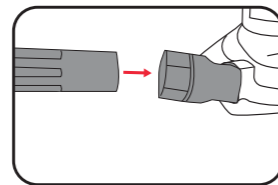

Note: Extraction takes place directly through the sanding paper and the sanding pad into the dust canister.

2. Open the dust canister lid and clean it from time to time once filled with dust.

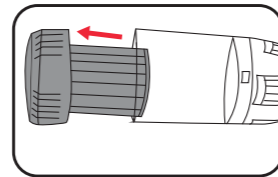

3. Fit the lid tightly again after emptying the dust from the dust canister.

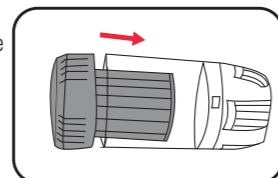

2. SANDPAPER FITMENT

Using Hook & Loop Sandpaper

Use this method of paper fitment with the supplied sheet of 120 grit sandpaper. Replacement sanding sheets with hook & loop backing can also be attached via this method.

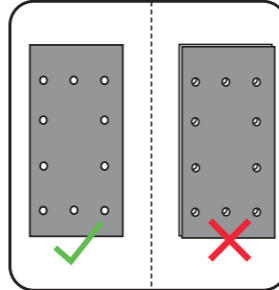

1. Align the holes on the sanding sheet with the holes on the sanding pad.
2. Press the hook & loop side of the sandpaper firmly against the sanding pad.

Using The Wire Clamps

Normal sheets of sandpaper at various grits can also be trimmed to size and used with this unit. The sandpaper base is 113x101mm.

1. If the replacement sandpaper already has holes in it, align these holes with the holes in the sanding pad, otherwise refer to the instructions below regarding the paper punch plate.

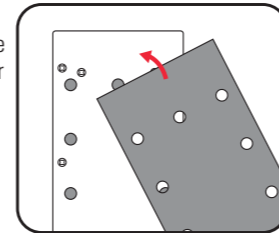

2. Unlock the spring clamps on both sides of the unit.

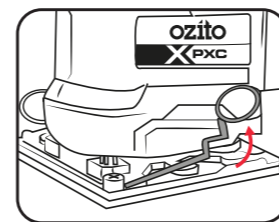

3. Fold the sandpaper to match the contours of the sanding pad.

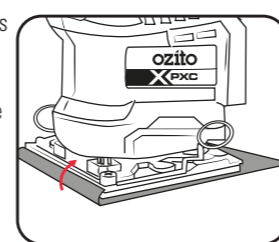

4. Slide the end of the sandpaper under the clamp at the front of the sander and lock the corresponding spring clamp down.

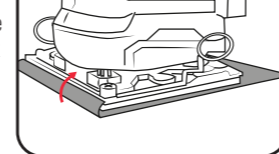

5. Repeat step 4 for the rear spring clamp.

Note: Ensure that the sandpaper is firmly clamped and held flat against the base of the sanding pad.

3. STARTING THE SANDER

WARNING! DO NOT LEAVE THE TOOL UNATTENDED WHILE THE ON/OFF SWITCH IS IN THE ON POSITION.

Installing The Battery Pack

1. Slide the battery into the tool base until it clicks into place.

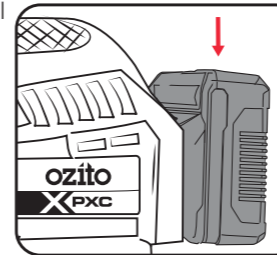

Removing The Battery Pack

1. Hold down the battery release button (a) and then slide the battery out(b).

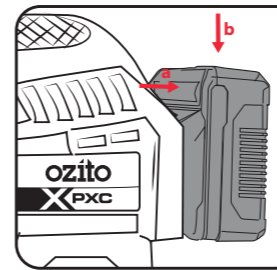

On/Off Trigger

1. To switch on the tool, move the on/off trigger to (I).

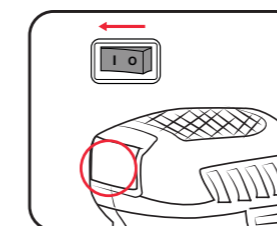

2. To switch off the tool, move the on/off trigger to (O).

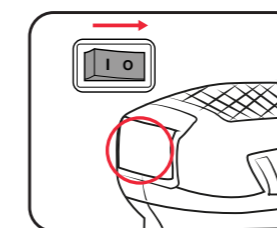

OPERATION

4. USAGE

WARNING! WEAR GLOVES, HEARING AND EYE PROTECTION DURING OPERATION. USE A DUST MASK FOR DUSTY OPERATIONS.

WARNING! WHOLD THE POWER TOOL BY INSULATED GRIPPING SURFACES

WARNING! DO NOT LEAVE THE TOOL UNATTENDED WHILE THE ON/OFF SWITCH IS IN THE ON POSITION.

Sanding

1. If required, secure the material to be sanded so that it doesn't slip from under the sander.

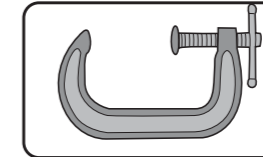

2. Firmly grasp the sander and turn the unit on.

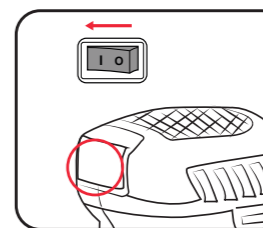

3. Let the motor build up to maximum speed. Gradually lower it onto the workpiece with a slight forward movement.

4. For optimum results, move the sander back and forth in steady strokes.

Note: Keep the entire sanding pad in contact with the workpiece at all times during sanding.

5. Upon completion of the sanding operation, remove the sander from the workpiece and then turn off the sander.

Sanding Tips

Never force the sander. The weight of the sander supplies adequate pressure, allowing the sandpaper to do the work. Applying additional pressure will slow the motor, rapidly wear the sandpaper, and greatly reduce the sander speed. This will slow the removal rate and produce an inferior quality surface..

Note: Excessive pressure will overload the motor, causing possible damage to the sander by overheating the motor; or damage to the workpiece.

Note: Be sure to check your workpiece often. The sander is capable of removing material rapidly, especially with coarse paper.

Note: Do not sand on one spot for too long. The sander's rapid action may remove too much material, creating an uneven surface.

Note: Use a coarse grit for coarse sanding and a finer grit for finish sanding. You can find the best grit size for the job by carrying out sanding tests.,

Sanding Paper Selection

Selecting the correct grit of sandpaper is an important step in achieving optimum results. Coarse grit will remove the most material. Finer grit will produce a smoother finish. The condition of the workpiece will determine the grit of the sandpaper to be used. The higher the grit number, the finer the grade of sandpaper.

If the surface is rough, start with a coarse grit and sand until the surface is uniform. Medium grit may then be used to remove scratches left by the coarser grit. Finer grit is then used to finish the surface. Always continue sanding with each grade of sandpaper until the surface is uniform.

MATERIAL	APPROPRIATE GRIT	
	Coarse Sanding	Fine Sanding
Paintwork	180	400
Wood: Softwood	60	240
Hardwood	60	180
Veneer	240	320

Note: If intermediate sanding is required, choose a grit rating between coarse and fine. The above table is intended as a guide only. To ensure a satisfactory result, a small, inconspicuous area should first be tested to ensure the grit of sandpaper chosen is suitable for the desired finish.

Note: The PXQSS-018 comes with (2 x 120 Grit) Sand Papers. Additional Grits are sold separately.

Using The Paper Punch Plate

The holes in the bottom of the sanding pad allow the motor to draw sanding dust away from the work area. Use the paper punch plate to create these dust extraction holes in replacement sandpaper that doesn't come pre-punched.

1. Fit a new sheet of sandpaper to the sander base.

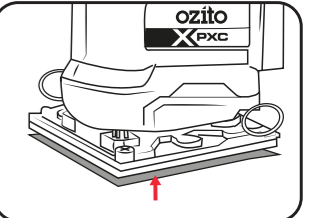

2. Align the sides of the sanding pad with the raised sides of the punch.

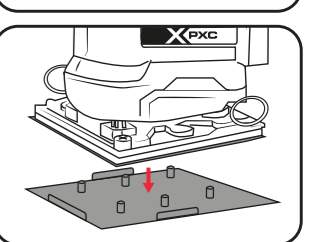

3. Press down on the tool to punch the holes.