

ozito

CROSS LINE LASER

10M RED

INSTRUCTION MANUAL

SPECIFICATIONS

Input:	3V DC (2 x AA Batteries)
Working Range:	10m
Accuracy:	±0.5mm/m
Self Levelling Time:	<5s
Self Levelling Range:	±3°
Laser:	Class II, <1mW
Laser Wavelength:	635nm (Red)
Battery Life:	16h
Weight:	0.4kg

ozito.com.au

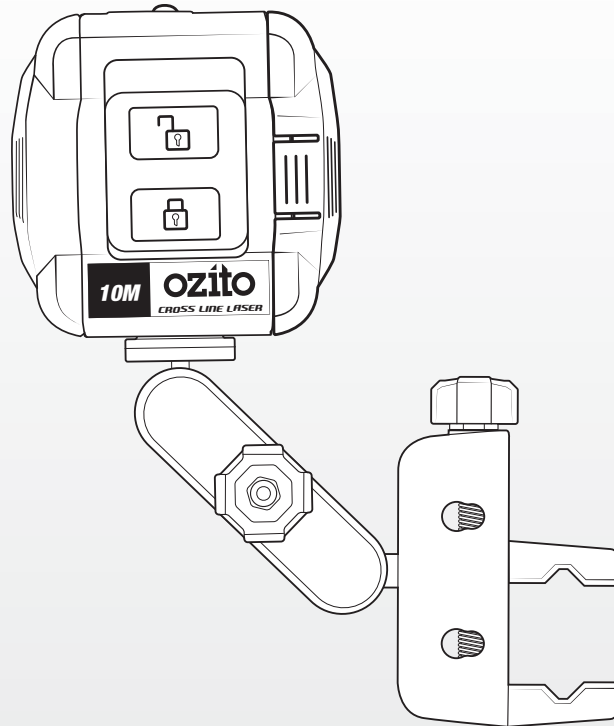

STANDARD EQUIPMENT

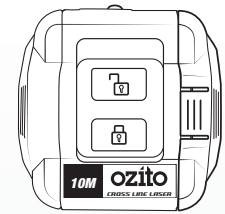

Cross Line Laser

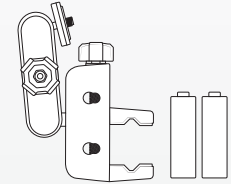

Multi-Axis Clamp & 2 x AA Batteries

3 YEAR
REPLACEMENT
WARRANTY*

LCL-10R

WARRANTY

IN ORDER TO MAKE A CLAIM UNDER THIS WARRANTY YOU MUST RETURN THE PRODUCT TO YOUR NEAREST BUNNINGS WAREHOUSE WITH YOUR BUNNINGS REGISTER RECEIPT. PRIOR TO RETURNING YOUR PRODUCT FOR WARRANTY PLEASE TELEPHONE OUR CUSTOMER SERVICE HELPLINE:

Australia: 1800 069 486

New Zealand: 0508 069 486

TO ENSURE A SPEEDY RESPONSE PLEASE HAVE THE MODEL NUMBER AND DATE OF PURCHASE AVAILABLE. A CUSTOMER SERVICE REPRESENTATIVE WILL TAKE YOUR CALL AND ANSWER ANY QUESTIONS YOU MAY HAVE RELATING TO THE WARRANTY POLICY OR PROCEDURE.

The benefits provided under this warranty are in addition to other rights and remedies which are available to you at law.

Our goods come with guarantees that cannot be excluded at law. You are entitled to a replacement or refund for a major failure and for compensation for any other reasonably foreseeable loss or damage. You are also entitled to have the goods repaired or replaced if the goods fail to be of acceptable quality and the failure does not amount to a major failure.

Generally you will be responsible for all costs associated with a claim under this warranty, however, where you have suffered any additional direct loss as a result of a defective product you may be able to claim such expenses by contacting our customer service helpline above.

3 YEAR REPLACEMENT WARRANTY*

Your product is guaranteed for a period of **36 months from the original date of purchase**. If a product is defective it will be replaced in accordance with the terms of this warranty. Warranty excludes consumable parts, for example: valve adapters and accessories.

*This product is intended for DIY use only and replacement warranty covers domestic use.

WARNING

The following actions will result in the warranty being void.

- If the tool has been operated on a supply voltage other than that specified on the tool.
- If the tool shows signs of damage or defects caused by or resulting from abuse, accidents or alterations.
- Failure to perform maintenance as set out within the instruction manual.
- If the tool is disassembled or tampered with in any way.
- Professional, industrial or high frequency use.

KNOW YOUR PRODUCT

CROSS LINE LASER

1. Pendulum Lock
2. Indicator LED
3. Power Button
4. Battery Cover
5. Clamping Screw
6. Clamping Jaw
7. Adjustment Screw
8. Thread Ring
9. Laser Lens

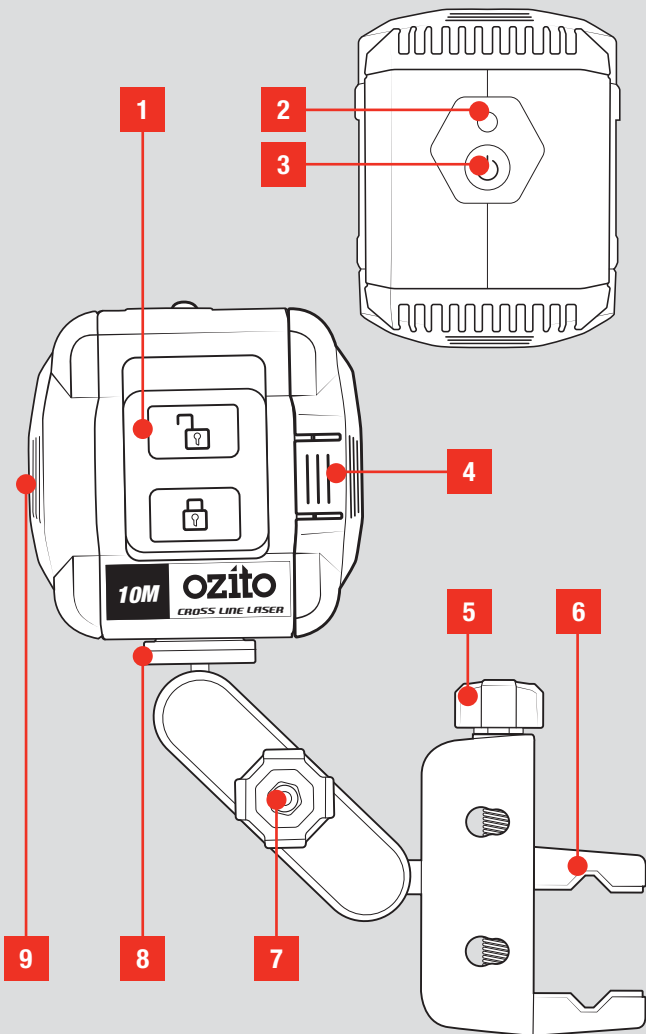

ONLINE MANUAL

Scan this QR Code with your mobile device to take you to the online manual.

3 YEAR REPLACEMENT WARRANTY*

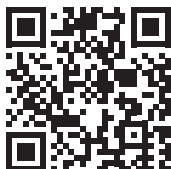

SETUP & PREPARATION

1. ASSEMBLY

Installing Batteries

1. Pinch the sides of the battery cover and pull it off the laser unit.

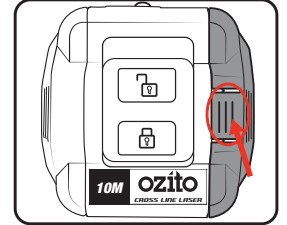

2. Insert two AA batteries. Follow the markings in the battery slot for the proper orientation.

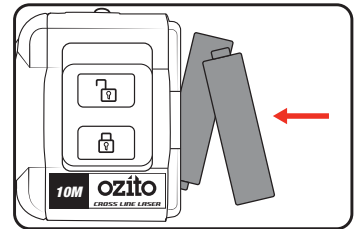

3. Pinch the battery cover and push it back onto the unit.

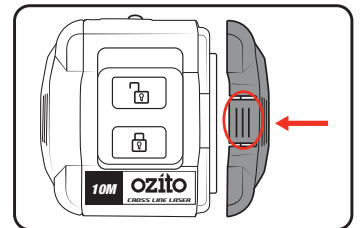

Mounting The Laser

1. Hold the thread ring on the multi-axis clamp and screw the laser onto the thread.

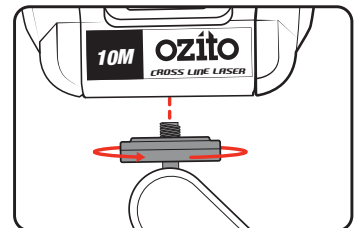

Note: The laser comes with a 1/4" thread slot, making it compatible with most universal camera mounts and stands on the market.

2. Rotate the clamping screw anti-clockwise to loosen the clamping jaws.

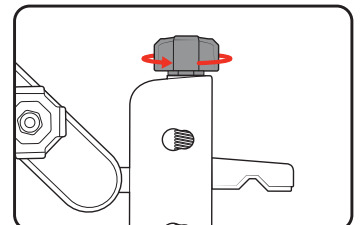

3. Place the jaws around the desired mounting surface.

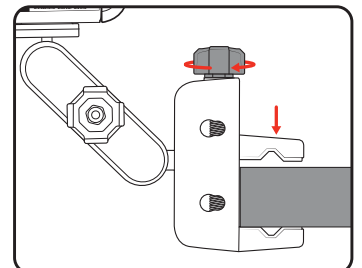

4. Rotate the clamping screw clockwise to lock the clamp in place.

OPERATION

2. ADJUSTMENTS

Adjusting The Clamp

1. Loosen the adjustment screw slightly.

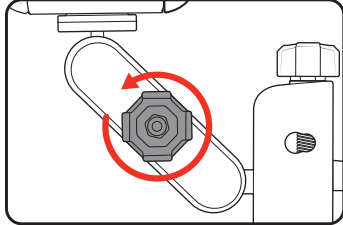

2. Move to laser and mounting arm to the desired position.

Note: The mounting arm has 2 ball joints, allowing the laser position to be adjusted in a range of directions.

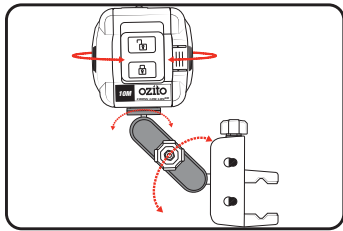

3. Tighten the adjustment screw to lock it in place.

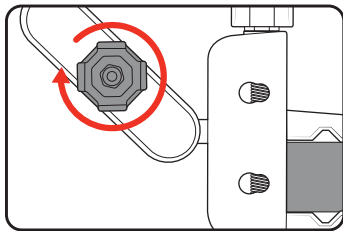

3. CONTROLS

Using The Auto-Levelling Function

1. To switch on the laser, slide the pendulum lock up to the unlock position.

Note: Remove the filament tape when using the tool for the first time.

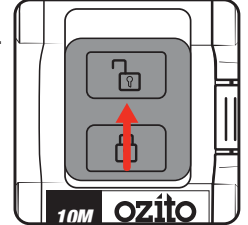

2. If the laser cross is within $\pm 3^\circ$ of horizontal, the laser will automatically self-correct, and the indicator LED on the top will turn green.

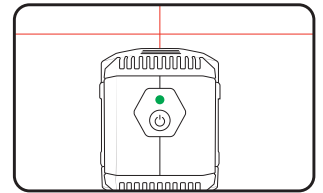

If there is more than a 3° tilt on the laser, the cross line will flash intermittently. The indicator LED will also turn red.

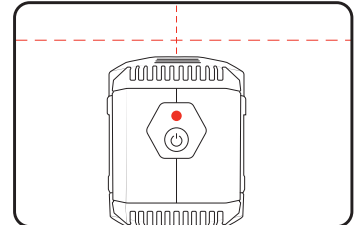

3. To switch the laser off, slide the pendulum lock down to the lock position.

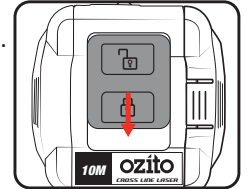

WARNING! ENSURE THE PENDULUM LOCK IS IN THE 'LOCK' POSITION AND THE LASER IS SWITCHED OFF WHEN NOT IN USE.

Setting The Cross Line Angle Manually

This setting is useful for aligning the laser to an existing feature or angle, such as projecting a line for a stair railing or ramp.

Note: For best results, use this feature on a freestanding tripod (not supplied).

1. Slide the pendulum lock down to the 'lock' position.

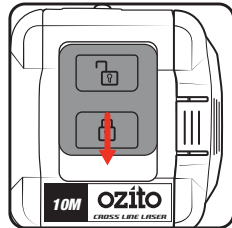

2. Press the power button to switch on the laser.

Note: The indicator LED will turn red to signal that the auto-levelling function is not in effect.

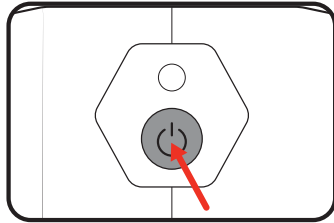

3. To switch off the laser, press the power button again.

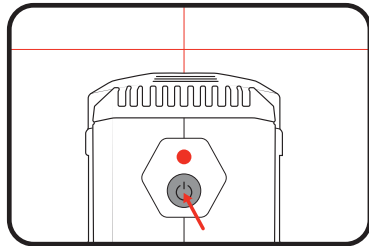

4. TROUBLESHOOTING

Symptom	Possible Cause	Suggested Solution
Laser will not switch on.	Batteries missing or depleted.	Change the batteries.
	Battery polarities are reversed.	Check the batteries' orientation.
Laser switches off after a short time.	Batteries depleted.	Replace the batteries.
Laser light is dim.	Batteries depleted.	Replace the batteries.
Laser light is blinking.	Laser light is out of self-levelling range.	Adjust the laser until it is within $\pm 3^\circ$ of horizontal.
Laser will not self-level	Laser light is out of self-levelling range.	Adjust the laser until it is within $\pm 3^\circ$ of horizontal.
	Pendulum lock is locked.	Slide the pendulum lock to the unlock position.

MAINTENANCE

5. APPLIANCE CARE



WARNING! BEFORE CLEANING THE APPLIANCE OR CARRYING OUT ANY MAINTENANCE PROCEDURE, MAKE SURE THAT IT IS DISCONNECTED FROM THE POWER SUPPLY TO PREVENT ACCIDENTAL STARTING.

Cleaning

1. We recommend that you clean the appliance immediately after you use it.
2. Keep the safety devices free of dirt and dust as much as possible. Wipe the equipment with a clean cloth.
3. Clean the appliance regularly with a damp cloth and some soft soap. Do not use cleaning agents or solvents; these may be aggressive to the plastic parts in the appliance. Ensure that no water can get into the interior of the appliance.
4. Keep lens clean of dust and debris.

Storage

Switch off the laser, set the level switch to the lock position, remove the batteries and make sure that it is secured in such a way that it cannot be started up again by any unauthorised person.

Store the tool in a dry location which is not accessible to unauthorised persons.

Note: Ozito Industries will not be responsible for any damage or injuries caused by the repair of the tool by an unauthorised person or by mishandling of the tool.

DESCRIPTION OF SYMBOLS

V	Volts	DC	Direct Current
m	Metres	mm	Millimetres
nm	Nanometres	°	Degrees
s	Seconds	mW	Milliwatts
λ	Wavelength	P₀	Power Output
	Regulatory Compliance Mark (RCM)		Warning
	Read Instruction Manual		Laser Light

CARING FOR THE ENVIRONMENT



Power tools that are no longer usable should not be disposed of with household waste but in an environmentally friendly way. Please recycle where facilities exist. Check with your local council authority for recycling advice.



Recycling packaging reduces the need for landfill and raw materials. Reuse of recycled material decreases pollution in the environment. Please recycle packaging where facilities exist. Check with your local council authority for recycling advice.

SPARE PARTS

Spare parts can be ordered from the Special Orders Desk at your local Bunnings Warehouse.

For further information, or any parts not listed here, visit

www.ozito.com.au or contact Ozito Customer Service:

Australia 1800 069 486

New Zealand 0508 069 486

E-mail: enquiries@ozito.com.au

ELECTRICAL SAFETY

 **WARNING!** When using electric tools basic safety precautions should always be followed to reduce the risk of fire, electric shock and personal injury.

- Read the whole manual carefully and make sure you know how to switch the tool off in an emergency, before operating the tool. Save these instructions and other documents supplied with this tool for future reference.
- This appliance is not intended for use by persons (including children) with reduced physical, sensory or mental capabilities, or lack of experience and knowledge, unless they have been given supervision or instruction concerning use of the appliance by a person responsible for their safety. Children should be supervised to ensure that they do not play with the appliance.

- This appliance is compatible and only to be used with AA Alkaline batteries.
- **WARNING!** Always remove the battery from the tool:
 - when the tool is left unattended,
 - when the tool is being checked, cleaned, or having maintenance work done,
 - when the tool is to be stored,
 - or if the tool vibrates abnormally.
- Do not combine different types of batteries or new and used batteries.
- Do not use modified or damaged batteries.

GENERAL POWER TOOL SAFETY WARNINGS

 **WARNING!** Read all safety warnings, instructions, illustrations and specifications provided with this power tool. Failure to follow all instructions listed below may result in electric shock, fire and/or serious injury.

Save all warnings and instructions for future reference.

The term "power tool" in the warnings refers to your mains-operated (corded) power tool or battery-operated (cordless) power tool.

1) Work area safety

- a) **Keep work area clean and well lit.** Cluttered or dark areas invite accidents.
- b) **Do not operate power tools in explosive atmospheres, such as in the presence of flammable liquids, gases or dust.** Power tools create sparks which may ignite the dust or fumes.
- c) **Keep children and bystanders away while operating a power tool.** Distractions can cause you to lose control.

2) Electrical safety

- a) **Power tool plugs must match the outlet. Never modify the plug in any way. Do not use any adapter plugs with earthed (grounded) power tools.** Unmodified plugs and matching outlets will reduce risk of electric shock.
- b) **Avoid body contact with earthed or grounded surfaces, such as pipes, radiators, ranges and refrigerators.** There is an increased risk of electric shock if your body is earthed or grounded.
- c) **Do not expose power tools to rain or wet conditions.** Water entering a power tool will increase the risk of electric shock.
- d) **Do not abuse the cord. Never use the cord for carrying, pulling or unplugging the power tool. Keep cord away from heat, oil, sharp edges or moving parts.** Damaged or entangled cords increase the risk of electric shock.
- e) **When operating a power tool outdoors, use an extension cord suitable for outdoor use.** Use of a cord suitable for outdoor use reduces the risk of electric shock.
- f) **If operating a power tool in a damp location is unavoidable, use a residual current device (RCD) protected supply.** Use of an RCD reduces the risk of electric shock.

3) Personal safety

- a) **Stay alert, watch what you are doing and use common sense when operating a power tool. Do not use a power tool while you are tired or under the influence of drugs, alcohol or medication.** A moment of inattention while operating power tools may result in serious personal injury.
- b) **Use personal protective equipment. Always wear eye protection.** Protective equipment such as a dust mask, non-skid safety shoes, hard hat or hearing protection used for appropriate conditions will reduce personal injuries.
- c) **Prevent unintentional starting. Ensure the switch is in the off-position before connecting to power source and/or battery pack, picking up or carrying the tool.** Carrying power tools with your finger on the switch or energising power tools that have the switch on invites accidents.
- d) **Remove any adjusting key or wrench before turning the power tool on.** A wrench or a key left attached to a rotating part of the power tool may result in personal injury.
- e) **Do not overreach. Keep proper footing and balance at all times.** This enables better control of the power tool in unexpected situations.
- f) **Dress properly. Do not wear loose clothing or jewellery. Keep your hair and clothing away from moving parts.** Loose clothes, jewellery or long hair can be caught in moving parts.
- g) **If devices are provided for the connection of dust extraction and collection facilities, ensure these are connected and properly used.** Use of dust collection can reduce dust-related hazards.
- h) **Do not let familiarity gained from frequent use of tools allow you to become complacent and ignore tool safety principles.** A careless action can cause severe injury within a fraction of a second.

4) Power tool use and care

- a) **Do not force the power tool. Use the correct power tool for your application.** The correct power tool will do the job better and safer at the rate for which it was designed.
- b) **Do not use the power tool if the switch does not turn it on and off.** Any power tool that cannot be controlled with the switch is dangerous and must be repaired.
- c) **Disconnect the plug from the power source and/or remove the battery pack, if detachable, from the power tool before making any adjustments, changing accessories, or storing power tools.** Such preventive safety measures reduce the risk of starting the power tool accidentally.
- d) **Store idle power tools out of the reach of children and do not allow persons unfamiliar with the power tool or these instructions to operate the power tool.** Power tools are dangerous in the hands of untrained users.
- e) **Maintain power tools and accessories. Check for misalignment or binding of moving parts, breakage of parts and any other condition that may affect the power tool's operation. If damaged, have the power tool repaired before use.** Many accidents are caused by poorly maintained power tools.
- f) **Keep cutting tools sharp and clean.** Properly maintained cutting tools with sharp cutting edges are less likely to bind and are easier to control.
- g) **Use the power tool, accessories and tool bits etc. in accordance with these instructions, taking into account the working conditions and the work to be performed.** Use of the power tool for operations different from those intended could result in a hazardous situation.
- h) **Keep handles and grasping surfaces dry, clean and free from oil and grease.** Slippery handles and grasping surfaces do not allow for safe handling and control of the tool in unexpected situations.

5) Battery tool use and care

- a) **Recharge only with the charger specified by the manufacturer.** A charger that is suitable for one type of battery pack may create a risk of fire when used with another battery pack.
- b) **Use power tools only with specifically designated battery packs.** Use of any other battery packs may create a risk of injury and fire.
- c) **When battery pack is not in use, keep it away from other metal objects, like paper clips, coins, keys, nails, screws or other small metal objects, that can make a connection from one terminal to another.** Shorting the battery terminals together may cause burns or a fire.
- d) **Under abusive conditions, liquid may be ejected from the battery; avoid contact. If contact accidentally occurs, flush with water. If liquid contacts eyes, additionally seek medical help.** Liquid ejected from the battery may cause irritation or burns.
- e) **Do not use a battery pack or tool that is damaged or modified.** Damaged or modified batteries may exhibit unpredictable behaviour resulting in fire, explosion or risk of injury.
- f) **Do not expose a battery pack or tool to fire or excessive temperature.** Exposure to fire or temperature above 130 °C may cause explosion.
- g) **Follow all charging instructions and do not charge the battery pack or tool outside the temperature range specified in the instructions.** Charging improperly or at temperatures outside the specified range may damage the battery and increase the risk of fire.

6) Service

- a) **Have your power tool serviced by a qualified repair person using only identical replacement parts.** This will ensure that the safety of the power tool is maintained.
- b) **Never service damaged battery packs.** Service of battery packs should only be performed by the manufacturer or authorized service providers.

CROSS LINE LASER SAFETY WARNINGS

- The light/laser radiation used in the Ozito 10m Cross Line Laser LCL-10R laser is Class 2 with maximum 1mW and 635nm wavelengths. These lasers do not normally present an optical hazard, although staring at the beam may cause flash blindness.
- Do not stare directly at the laser beam. A hazard may exist if you deliberately stare into the beam. Please observe all rules as follows:
 - The laser shall be used and maintained in accordance with the manufacturer's instructions.
 - Never aim the beam at any person or an object other than the work piece.
 - The laser beam shall not be deliberately aimed at personnel and shall be prevented from being directed towards the eye of a person.
- Always ensure the laser beam is aimed at a sturdy work piece without reflective surface', i.e. wood or rough coated surfaces are acceptable. Bright shiny reflective sheet steel or the like is not suitable for laser use as the reflective surface could direct the beam back at the operator.

- Do not change the laser light assembly with a different type. Repairs must only be carried out by a power tool repairer.
- Never open the laser module. It is prohibited to increase its power.
- Switch off the laser when not in use.
- Use of controls or adjustments or performance of procedures other than those specified herein may result in hazardous radiation exposure. Please refer to the relevant Australian standards, IEC 60825-1 and IEC 60825-14 for more information on Lasers.
- Do not point LED at eyes of persons or animals.
- Do not store or use the tool and battery pack in locations where the temperature may reach or exceed 40°C (such as inside sheds or metal buildings in summer).
- Do not incinerate the battery pack even if it is seriously damaged or is completely worn out. The battery can explode in a fire.