

# Einhell

## EXPERT

## TE-XC 110

### Universal Circular Saw Cutmaxx

Art.-No. 43.310.00

#### Features

- Unique universal circular saw cutmaxx for cutting metal, wood, plastics, gypsum, stone, tiles
- Dust enclosed motor and switch
- High-torque Motor
- Ergonomic soft grip (1)
- Spindle lock (2)
- Laser for exact straight cuttings (3)
- High-quality TCT saw blade (4)
- For cutting metal, wood, plastics, gypsum
- High quality turbo diamond disc (6) for cutting stone and tiles
- Toolless cutting depth adjustment (7)
- Robust rubber cable

#### Standard accessories

- Parallel guide
- Dust extraction adapter (5)
- Key for saw blade change on the housing
- Einhell carrier bag (8)

#### Technical Data

- Mains: 230 V ~ 50 Hz
- Power: 730 W
- No-load speed: 4,300 min<sup>-1</sup>
- Cutting depth wood/ gypsum: 33 mm
- Cutting depth metal: 12 mm
- Cutting depth tile/ stone: 10 mm
- TCT saw blade: Ø 110 x Ø 22.2 x 1.4 mm / 24 teeth
- diamond disc: Ø 110 x Ø 22.2 (turbo)
- Product weight: 3.0 kg

#### Logistic Data

- Net weight: 3.9 kg
- Gross weight: 4.3 kg
- Packing dimensions: 420 x 270 x 235 mm
- Bar code: 4006825 584424
- Sales unit: 2 pcs

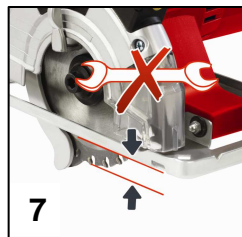

	CUT-MAXX		
METAL (STEEL, ALU)	✓	-	✓
WOOD PLASTICS	✓	✓	-
STONE TILES	✓	-	✓
GYPSUM	✓	-	-
EXACT CUT	✓	✓	-
PERFECT TOP	✓	✓	-
LOW DUST	✓	✓	-
SAFETY	✓	✓	-

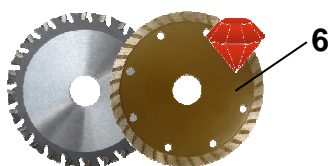

#### As special accessories available:

##### TCT saw blade

Ø 110 x Ø 22,2 x 1,4 mm, 24 Z

Art.-No.: 45.020.15

Bar code: 4006825 584615

##### Dia Turbo cutting disc

Ø 110 x Ø 22,2 mm

Art.-No.: 45.020.16

Bar code: 4006825 589801