

MAINTENANCE

WARNING! BEFORE CLEANING OR CARRYING OUT ANY MAINTENANCE PROCEDURE, ENSURE THAT THE BATTERIES HAVE BEEN REMOVED.

Cleaning the Filter Cover

The filter should be checked at regular intervals and cleaned if necessary.

1. Open the Filter cover by pushing the switch upwards.

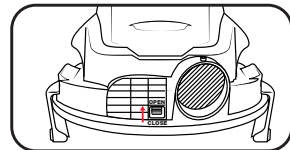

2. Remove the filter cover.

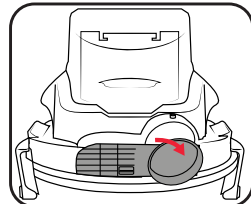

3. Remove the filter pad from inside and clean by tapping it or blowing it out.

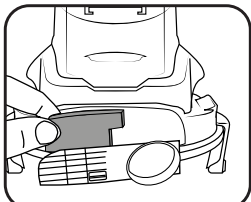

4. Assemble the cover back in place.

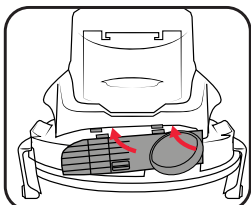

5. Secure it by pushing the switch downwards.

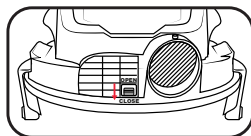

Cleaning

- Keep the ventilation slots of the tool clean at all times to ensure efficient operation.
- After each use, blow air through the tool housing to ensure it is free from all dust, dirt, etc. Build up of dust or dirt particles may cause the tool to overheat and shorten the life of the tool.
- If the housing of the tool requires cleaning, do not use solvents. Use of a cloth only is recommended.
- Never allow any liquid to get inside the tool, never immerse any part of the tool into liquid.

Storage

When not in use, the tool should be stored in a dry, frost free location, keep out of children's reach.

Note: Ozito Industries will not be responsible for any damage or injuries caused by repair of the tool by an unauthorised person or by mishandling.

- If the vacuum vibrates abnormally, stop motor immediately. Abnormal vibration usually indicates a mechanical problem continued operation could lead to injury or damage.

Short Battery Runtime

Ensure the battery is properly charged. It will take 4-5 charging cycles before the battery reaches optimum charge and run time.

TROUBLE SHOOTING

Problem	Cause	Remedy
Vacuum is not starting	Battery is low in charge	Charge battery
	Battery not inserted properly	Insert battery pack correctly
	Possible clogging	Empty the debris container and clean the filter.
Vacuum is not operating at full capacity	Possible clogging	Empty the debris container and clean the filter.
Motor stops while vacuuming	Battery has no power	Charge battery

DESCRIPTION OF SYMBOLS

dc/—	Direct current	Ø	Diameter
⚠	Warning	L	Litres
l/s	Litres per second	mbar	Pressure rating (millibar)
	Read instruction manual	v	Volts

CARING FOR THE ENVIRONMENT



Power tools that are no longer usable should not be disposed of with household waste but in an environmentally friendly way. Please recycle where facilities exist. Check with your local council authority for recycling advice.



Recycling packaging reduces the need for landfill and raw materials. Reuse of recycled material decreases pollution in the environment. Please recycle packaging where facilities exist. Check with your local council authority for recycling advice.

SPARE PARTS

Spare parts can be ordered from the Special Orders Desk at your local Bunnings Warehouse.

For further information, or any parts not listed here, visit www.ozito.com.au or contact Ozito Customer Service:

Australia 1800 069 486

New Zealand 0508 069 486

E-mail: hello@ozito.com.au

ELECTRICAL SAFETY



WARNING! When using electric tools basic safety precautions should always be followed to reduce the risk of fire, electric shock and personal injury.

- Read the whole manual carefully and make sure you know how to switch the tool off in an emergency, before operating the tool. Save these instructions and other documents supplied with this tool for future reference.
- This appliance is not intended for use by persons (including children) with reduced physical, sensory or mental capabilities, or lack of experience and knowledge, unless they have been given supervision or instruction concerning use of the appliance by a person responsible for their safety. Children should be supervised to ensure that they do not play with the appliance. This appliance is compatible and only to be used with all batteries & chargers from the Ozito

GENERAL POWER TOOL SAFETY WARNINGS



WARNING! Read all safety warnings, instructions, illustrations and specifications provided with this power tool. Failure to follow all instructions listed below may result in electric shock, fire and/or serious injury.

- Save all warnings and instructions for future reference. The term "power tool" in the warnings refers to your mains-operated (corded) power tool or battery-operated (cordless) power tool.
- 1) Work area safety**
 - a) **Keep work area clean and well lit.** Cluttered or dark areas invite accidents.
 - b) **Do not operate power tools in explosive atmospheres, such as in the presence of flammable liquids, gases or dust.** Power tools create sparks which may ignite the dust or fumes.
 - c) **Keep children and bystanders away while operating a power tool.** Distractions can cause you to lose control.
 - 2) Electrical safety**
 - a) **Power tool plugs must match the outlet. Never modify the plug in any way. Do not use any adapter plugs with earthed (grounded) power tools.** Unmodified plugs and matching outlets will reduce risk of electric shock.
 - b) **Avoid body contact with earthed or grounded surfaces, such as pipes, radiators, ranges and refrigerators.** There is an increased risk of electric shock if your body is earthed or grounded.
 - c) **Do not expose power tools to rain or wet conditions.** Water entering a power tool will increase the risk of electric shock.
 - d) **Do not abuse the cord. Never use the cord for carrying, pulling or unplugging the power tool. Keep cord away from heat, oil, sharp edges or moving parts.** Damaged or entangled cords increase the risk of electric shock.
 - e) **When operating a power tool outdoors, use an extension cord suitable for outdoor use.** Use of a cord suitable for outdoor use reduces the risk of electric shock.
 - f) **If operating a power tool in a damp location is unavoidable, use a residual current device (RCD) protected supply.** Use of an RCD reduces the risk of electric shock.
 - 3) Personal safety**
 - a) **Stay alert, watch what you are doing and use common sense when operating a power tool. Do not use a power tool while you are tired or under the influence of drugs, alcohol or medication.** A moment of inattention while operating power tools may result in serious personal injury.
 - b) **Use personal protective equipment. Always wear eye protection.** Protective equipment such as a dust mask, non-skid safety shoes, hard hat or hearing protection used for appropriate conditions will reduce personal injuries.
 - c) **Prevent unintentional starting. Ensure the switch is in the off-position before connecting to power source and/or battery pack, picking up or carrying the tool. Carrying power tools with your finger on the switch or energising power tools that have the switch on invites accidents.**
 - d) **Remove any adjusting key or wrench before turning the power tool on.** A wrench or a key left attached to a rotating part of the power tool may result in personal injury.
 - e) **Do not overreach. Keep proper footing and balance at all times.** This enables better control of the power tool in unexpected situations.
 - f) **Dress properly. Do not wear loose clothing or jewellery. Keep your hair and clothing away from moving parts.** Loose clothes, jewellery or long hair can be caught in moving parts.
 - g) **If devices are provided for the connection of dust extraction and collection facilities, ensure these are connected and properly used.** Use of dust collection can reduce dust-related hazards.
 - h) **Do not let familiarity gained from frequent use of tools allow you to become complacent and**

PXC range. Refer to the PXC battery and charger manuals for information regarding charging, use and storage.

- **WARNING!** Always remove the battery from the tool:
 - when the batteries are to be charged,
 - when the tool is left unattended,
 - when the tool is being checked, cleaned, or having maintenance work done,
 - when the tool is to be stored,
 - or if the tool vibrates abnormally.
- Do not combine different types of batteries or new and used batteries.
- Do not use modified or damaged batteries.

ignore tool safety principles. A careless action can cause severe injury within a fraction of a second.

- 4) Power tool use and care**
 - a) **Do not force the power tool. Use the correct power tool for your application.** The correct power tool will do the job better and safer at the rate for which it was designed.
 - b) **Do not use the power tool if the switch does not turn it on and off.** Any power tool that cannot be controlled with the switch is dangerous and must be repaired.
 - c) **Disconnect the plug from the power source and/or remove the battery pack, if detachable, from the power tool before making any adjustments, changing accessories, or storing power tools.** Such preventive safety measures reduce the risk of starting the power tool accidentally.
 - d) **Store idle power tools out of the reach of children and do not allow persons unfamiliar with the power tool or these instructions to operate the power tool.** Power tools are dangerous in the hands of untrained users.
 - e) **Maintain power tools and accessories. Check for misalignment or binding of moving parts, breakage of parts and any other condition that may affect the power tool's operation. If damaged, have the power tool repaired before use.** Many accidents are caused by poorly maintained power tools.
 - f) **Keep cutting tools sharp and clean.** Properly maintained cutting tools with sharp cutting edges are less likely to bind and are easier to control.
 - g) **Use the power tool, accessories and tool bits etc. in accordance with these instructions, taking into account the working conditions and the work to be performed.** Use of the power tool for operations different from those intended could result in a hazardous situation.
 - h) **Keep handles and grasping surfaces dry, clean and free from oil and grease.** Slippery handles and grasping surfaces do not allow for safe handling and control of the tool in unexpected situations.
- 5) Battery tool use and care**
 - a) **Recharge only with the charger specified by the manufacturer.** A charger that is suitable for one type of battery pack may create a risk of fire when used with another battery pack.
 - b) **Use power tools only with specifically designated battery packs.** Use of any other battery packs may create a risk of injury and fire.
 - c) **When battery pack is not in use, keep it away from other metal objects, like paper clips, coins, keys, nails, screws or other small metal objects, that can make a connection from one terminal to another.** Shorting the battery terminals together may cause burns or a fire.
 - d) **Under abusive conditions, liquid may be ejected from the battery; avoid contact. If contact accidentally occurs, flush with water. If liquid contacts eyes, additionally seek medical help.** Liquid ejected from the battery may cause irritation or burns.
 - e) **Do not use a battery pack or tool that is damaged or modified.** Damaged or modified batteries may exhibit unpredictable behaviour resulting in fire, explosion or risk of injury.
 - f) **Do not expose a battery pack or tool to fire or excessive temperature.** Exposure to fire or temperature above 130 °C may cause explosion.
 - g) **Follow all charging instructions and do not charge the battery pack or tool outside the temperature range specified in the instructions.** Charging improperly or at temperatures outside the specified range may damage the battery and increase the risk of fire.
- 6) Service**
 - a) **Have your power tool serviced by a qualified repair person using only identical replacement parts.** This will ensure that the safety of the power tool is maintained.
 - b) **Never service damaged battery packs.** Service of battery packs should only be performed by the manufacturer or authorized service providers.

WET & DRY VACUUM SAFETY WARNINGS



When using the equipment, a few safety precautions must be observed to avoid injuries and damage. Please read the complete operating manual with due care. Keep this manual in a safe place so that the information is available at all times. If you give the equipment to any other person, give them these operating instructions as well.

We cannot accept any liability for damage or accidents which arise due to a failure to follow these instructions and the safety information.

This appliance is not intended for use by persons (including children) with reduced physical, sensory or mental capabilities, or lack of experience and knowledge, unless they have been given supervision or instruction concerning use of the appliance by a person responsible for their safety. The appliance is not intended for use by young children or infirm persons without supervision. Young children should be supervised to ensure they do not play with the appliance.

- Do not leave appliance unattended when connected to the power supply. Remove battery when not in use and before servicing and cleaning.
- To avoid electric shock, do not expose to rain. Store indoors.
- Never use in the presence of explosive liquids, vapours or explosive dust – such as coal or grain.
- Use only manufacturer's recommended attachments and consumables.
- Never modify the cleaner in any way - this is dangerous and will invalidate the warranty.
- Do not use cleaner without the filter in place.
- If motor sound becomes higher pitched always check for the following:
 - Blocked hose or accessory.
 - Blocked filter.
 - Full container.

ozito
X PXC

36V CORDLESS
2X18V

WET & DRY VACUUM

INSTRUCTION MANUAL

SPECIFICATIONS

Input:	36V (2 x 18V)
Max. Suction Power:	150mbar
Tank Capacity:	25L
Air Flow:	25L/s
Suction Hose Length:	250cm
Suction Hose Diameter:	Ø36mm
IP Rating:	IPX4
Weight:	6.6kg

ozito.com.au

5 YEAR
REPLACEMENT WARRANTY

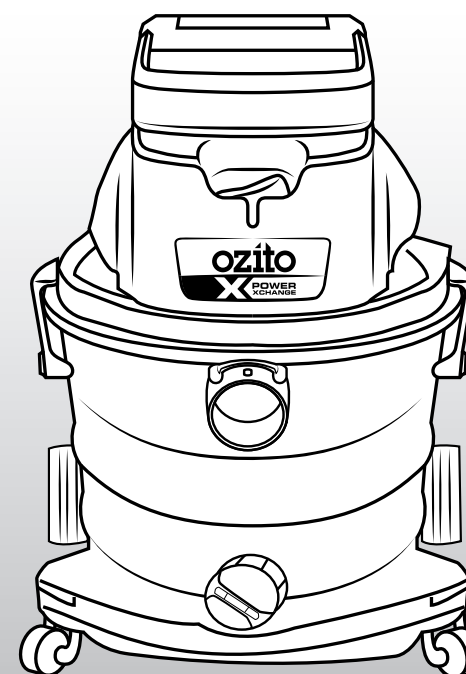

STANDARD EQUIPMENT



Cordless Wet & Dry Vacuum



Suction Hose, Premium Hardened Extension Tubes



Floor Tool, Service Tool, Brush Tool



Filter with Cap, Dust Bag, Foam Bag



2 x Castors, 2 x Split Pins, 4 x Washers, 2 x Wheels, 2 x Wheel Covers

PXVWDS-3625

WARRANTY

IN ORDER TO MAKE A CLAIM UNDER THIS WARRANTY YOU MUST RETURN THE PRODUCT TO YOUR NEAREST BUNNINGS WAREHOUSE WITH YOUR BUNNINGS REGISTER RECEIPT. PRIOR TO RETURNING YOUR PRODUCT FOR WARRANTY PLEASE TELEPHONE OUR CUSTOMER SERVICE HELPLINE:

Australia 1800 069 486

New Zealand 0508 069 486

TO ENSURE A SPEEDY RESPONSE PLEASE HAVE THE MODEL NUMBER AND DATE OF PURCHASE AVAILABLE. A CUSTOMER SERVICE REPRESENTATIVE WILL TAKE YOUR CALL AND ANSWER ANY QUESTIONS YOU MAY HAVE RELATING TO THE WARRANTY POLICY OR PROCEDURE.

WARNING

The following actions will result in the warranty being void.

- If the tool has been operated on a supply voltage other than that specified on the tool.
- If the tool shows signs of damage or defects caused by or resulting from abuse, accidents or alterations.
- Failure to perform maintenance as set out within the instruction manual.
- If the tool is disassembled or tampered with in any way.

The benefits provided under this warranty are in addition to other rights and remedies which are available to you at law.

Your goods come with guarantees that cannot be excluded at law. You are entitled to a replacement or refund for a major failure and for compensation for any other reasonably foreseeable loss or damage. You are also entitled to have the goods repaired or replaced if the goods fail to be of acceptable quality and the failure does not amount to a major failure.

Generally you will be responsible for all costs associated with a claim under this warranty, however, where you have suffered any additional direct loss as a result of a defective product you may be able to claim such expenses by contacting our customer service helpline above.

5 YEAR REPLACEMENT WARRANTY

Your Product is guaranteed for a period of 60 months from the original date of purchase and is intended for DIY (Do It Yourself) use only. If a product is defective it will be replaced in accordance with the terms of this warranty. **Lithium Ion batteries and chargers are covered by a 36 month warranty** and are excluded from the warranty extension. Warranty excludes consumable parts.

KNOW YOUR PRODUCT

CORDLESS WET & DRY VACUUM

- | | |
|--------------------------------|----------------------------|
| 1. Tank | 8. Battery Seating |
| 2. Motor Securing Clips | 9. Blower Outlet |
| 3. On/Off/Suction Level Switch | 10. Filter Cover |
| 4. Carry Handle | 11. Accessory Holder |
| 5. Vacuum Inlet | 12. Filter Cage |
| 6. Water Drain Screw | 13. Safety and Float Valve |
| 7. Castors | |

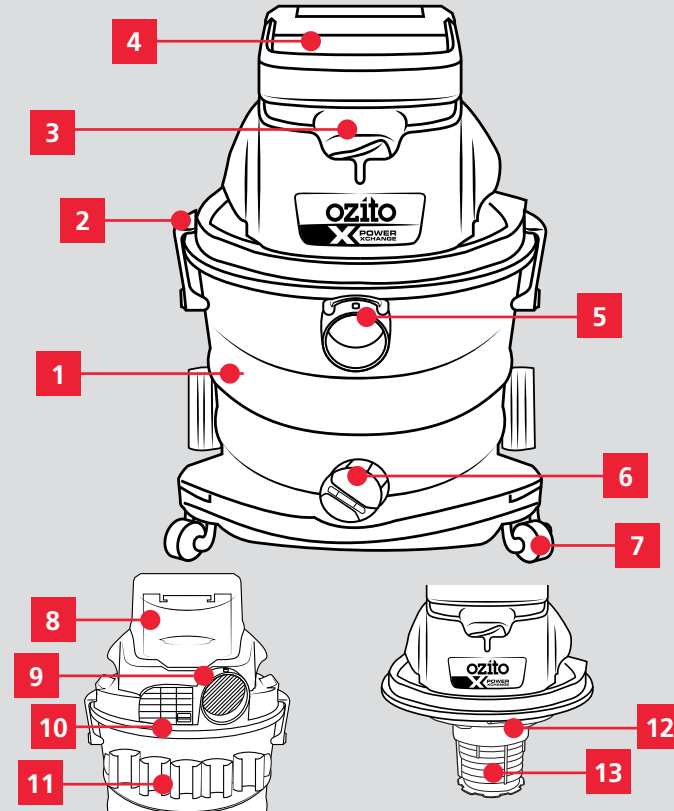

ACCESSORIES

- | | |
|--------------------------------------|----------------------|
| 14. Suction Hose | 21. 4 x washers |
| 15. Premium Hardened Extension Tubes | 22. 2 x split pins |
| 16. Air Regulator | 23. 2 x Wheels |
| 17. Crevice Tool | 24. 2 x Wheel Covers |
| 18. Floor Tool | 25. Filter with Cap |
| 19. Brush Tool | 26. Dust Bag |
| 20. Axle for back wheels | 27. Foam Filter |

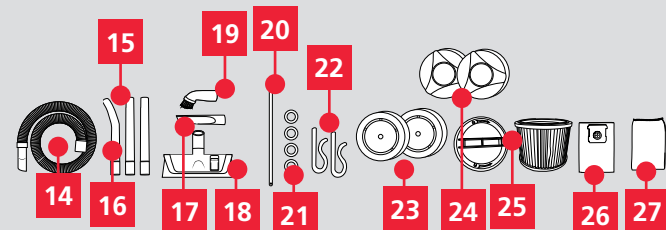

BATTERY & CHARGER

This tool is compatible with all batteries & chargers from the Ozito PXC range.

ONLINE MANUAL

Scan this QR Code with your mobile device to take you to the online manual.



SETUP & PREPARATION

1. FITTING THE BATTERY

WARNING! ALWAYS USE BATTERIES WITH THE SAME OUTPUT AND THE SAME AMOUNT OF CHARGE.

Installing The Battery Pack

1. Open the Battery Seating cover (a) and slide the batteries into the tool base (b) until it clicks into place.

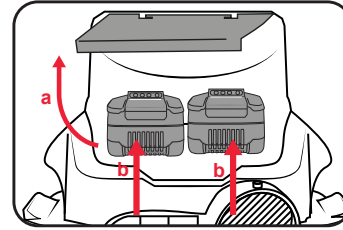

Removing The Battery Pack

1. Hold down the battery release button (a) and then slide the battery out (b) and close the battery seating cover.

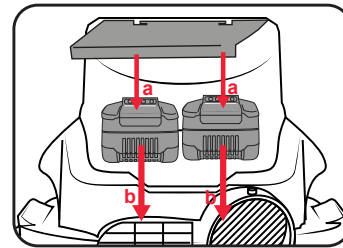

2. ASSEMBLY

WARNING! ENSURE THE TOOL IS SWITCHED OFF AND THE BATTERY IS REMOVED BEFORE PERFORMING ANY OF THE FOLLOWING TASKS.

Fitting the Castors

1. Turn the tank upside down and push the 2 castors into the front base of the tank.

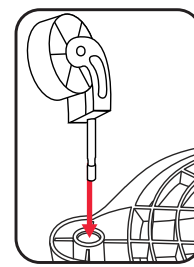

Fitting the Wheels

1. Place a split pin for fitting the wheels through the appropriate hole in the axle.
2. Fit a washer into the axle before and after the wheel after the wheels.

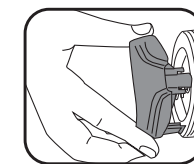
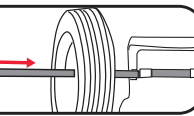
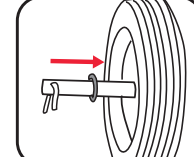
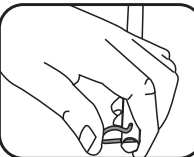

3. Push through the axle on the back side of the tank, then add a washer, the wheel, another washer and finally the last split pin.

4. Push the covers on to the outside of the wheels so that the detents engage on the covers for the wheel.

Fitting the Motor

1. When fitting the motor to the tank (a), position it so that the tank securing clips, hook the securing clips over the lip of the motor unit and then press lower end of the clips against the sides of the tank to lock them in place (b).

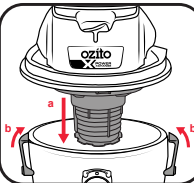

Fitting the Dust Bag

1. For vacuuming fine, dry dirt it is recommended that you fit the dust bag. This will ensure that the pleated filter does not clog up so quickly and help maintain the vacuuming power. Slip the dust bag over the vacuum inlet on the inside of the tank.

Note: A dust bag is suitable for dry vacuuming only. Using the dust bag makes it easier to dispose of the dust that has been collected.

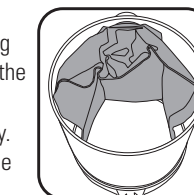

Note: Ensure the dust bag has been attached securely before operating the vacuum.

3. FILTER SELECTION

WARNING! NEVER USE THE VACUUM CLEANER WITHOUT A FILTER! ALWAYS ENSURE THAT THE FILTERS ARE PERFECTLY SECURE!

WARNING! WHEN WET VACUUMING, SWITCH OFF THE EQUIPMENT IF LIQUID OR FOAM IS EMITTED WITH THE EXHAUST AIR.

Foam Filter - Vacuuming Liquid

1. Turn filter cap anti-clockwise and remove pleated filter if it is on filter cage, slip the supplied foam filter over the filter basket.

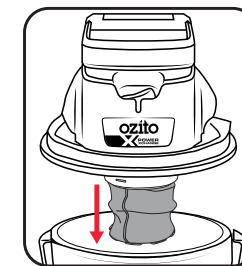

Note: Do not use the Pleated Filter and/or Dust Bag when vacuuming liquid.

Note: During wet vacuuming, tank capacity may vary due to safety float valve

Note: Empty the water after every use by rotating the water drain screw counter-clockwise.

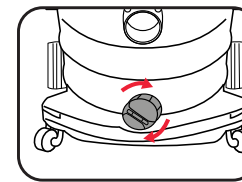

WARNING! WHEN WET VACUUMING, THE SAFETY FLOAT TURNS OFF THE VACUUM CLEANING AUTOMATICALLY WHEN THE MAXIMUM LEVEL IS REACHED.

WARNING! THE WET & DRY VACUUM CLEANING IS NOT SUITABLE FOR THE VACUUMING OF COMBUSTIBLE LIQUIDS.

Pleated Filter - Vacuuming Dry

1. For dry vacuum cleaning always use the pleated filter. Mount the filter so that no air is sucked through the filter cage without being filtered.

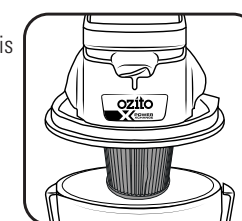

2. Place the cap on the base of the pleated filter, turn clockwise to lock in position.

Note: Do not use the Foam Filter when vacuuming dry matter.

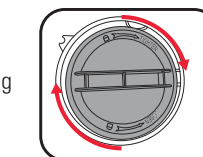

OPERATION

4. CONTROLS

On/Off/Section Level Switch

The Eco Feature helps to sustain the battery life more while the Boost mode helps to use the tool in its best form while decreasing the battery life.

1. To start vacuum, press the switch to the on position ('I') which is the Eco Mode.



2. To enable the boost mode, switch the position to ('II')



Note: To switch the tool off, switch the position to ('O')



Air regulator

The air regulator can be fitted between the suction hose and the suction tube. The suction power of the nozzle can be infinitely adjusted using the air regulator.

1. When wet vacuuming, make selective use of the air regulator to suck in air as well as liquids. This will help to take some strain off the equipment when vacuuming liquids.

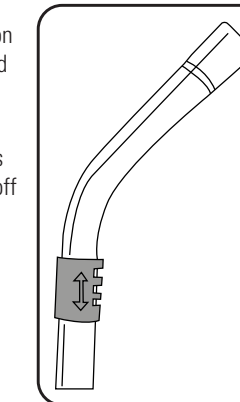

5. USAGE

WARNING! NEVER PUT YOUR HANDS AND FINGERS NEAR THE INLET OPENING.

Hoses & Nozzles

Connect the suction hose to the corresponding connector on the wet and dry vacuum, depending on the application required:

Vacuuming

1. Connect the suction hose to the vacuum inlet at the front of the tank and secure it by tightening it clockwise.

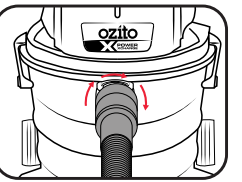

Blowing

1. Connect the suction hose to the blow outlet at the back of the unit and secure it by tightening it clockwise.

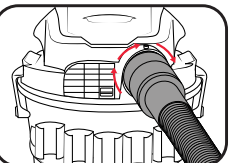

Extension Tube

1. The suction hose can be extended by attaching one or more sections of the 3 part extension tubes.

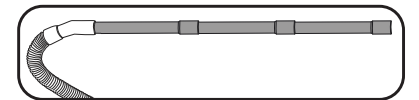

CAUTION! DURING NORMAL OPERATION OF THIS VACUUM, STATIC DISCHARGE MAY OCCUR.

Suction Tools

Floor Tool:

The floor tool is for vacuuming solids and liquids over medium to large areas.

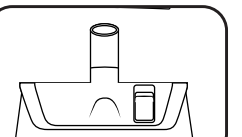

Crevice Tool:

The crevice tool is designed for cleaning crevices and edges.

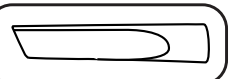

Brush Tool:

The brush tool with soft bristles can be used to vacuum windowsills, bookcases, framed art, lampshades, and blinds.

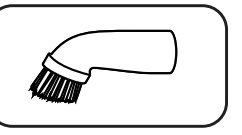

Note: All the accessories can be clipped on the accessory holder at the back of the tank.

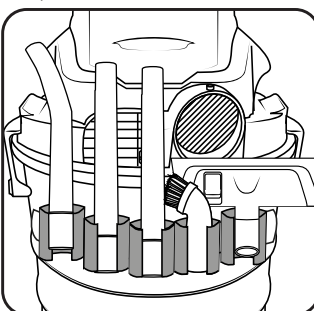

5 YEAR
REPLACEMENT WARRANTY