

5) Starting the 2 in 1 Petrol Grass Trimmer/Brush Cutter

IMPORTANT!

We recommend you wear goggles, protective clothing, and ear defenders.

- 1) Set the machine down on a hard, level surface.
- 2) Press the fuel pump (primer) (Fig. 1a/Item 7) 10 times.
- 3) Move the On/Off switch (Fig. 1b/Item 9) to 'I'.
- 4) Secure the throttle lever (Fig. 1b / Item 11). To do this, press the throttle lever lock (Fig. 1b/Item 12) and then press the throttle lever (Fig. 1b/Item 11) and lock the throttle lever by pressing the lock (Fig. 1b/Item 10) at the same time.
- 5) Set the choke lever (Fig. 1a/Item 5) to 'F'.
- 6) Hold the equipment firmly and pull out the starter cable (Fig. 1a/Item 4) until you feel it begin to resist. Then tug sharply on the starter cable 4 times. The engine should start.

IMPORTANT!

Never allow the starter line to snap back. This may result in damage.

IMPORTANT!

Since the throttle lever is secured, the cutting tool starts to operate when the engine is started. Immediately release the throttle lever by actuating it once. Actuating the throttle lever will also release the choke lever. (The engine returns to its idle state).

NOTE!

If the engine does not start up immediately, repeat steps 1-7 above. To stop the machine immediately, set the ON/OFF switch to 'STOP' 'o'.

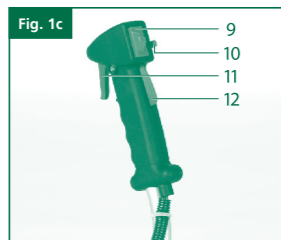
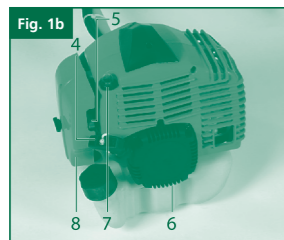

IMPORTANT!

Your safety is most important. Please read these safety rules before you use this machine.

Fig. 14



Explanation of the warning signs on the equipment (see Fig. 14)

- 1) Warning!
- 2) Read the instructions before using for the first time!
- 3) Wear protective headgear, goggles and ear defenders!
- 4) Wear sturdy, non-slip footwear!
- 5) Wear safety gloves!
- 6) Protect the equipment from rain and damp!
- 7) Be careful of objects being catapulted away!
- 8) Always switch off the equipment and pull out the spark boot plug before carrying out any maintenance work!
- 9) The distance between the equipment and persons in the vicinity must be at least 15 m!
- 10) The cutting tool (blade/cutting line) continues to rotate after the machine is switched off!
- 11) Caution: Hot equipment parts. Keep your distance!
- 12) Add a little grease (gear grease) after every 20 hours in operation!
- 13) Note: Left-handed thread. Turn clockwise to undo the tool, turn counter-clockwise to tighten it.

GARDENLINE

2 in 1 Petrol Grass Trimmer/Brush Cutter Quick Set-Up Guide



Before reading, unfold the pages containing the Important information, Warnings and illustrations and familiarise yourself with all functions of the device.

Using the 2 in 1 Petrol Grass Trimmer/Brush Cutter

NOTE!

This quick start guide is intended for experienced users who have already assembled the tool, please refer to the main Instruction Manual for further details.

NOTE!

Diagram numbers refer to those in the main Instruction Manual. Please refer to the main Instruction Manual if you are unsure.

Items Included

Fig. 2

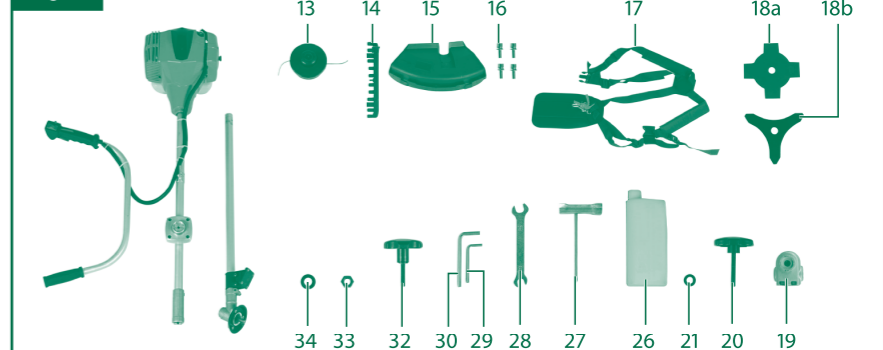

IMPORTANT!

Always read the safety warnings prior to use.

1) Unpack the 2 in 1 Petrol Grass Trimmer/Brush Cutter

- a) Open the carton carefully and remove all the contents.
- b) Ensure you have all the items – see above (including the soft carry case) before you discard the packaging.

2) Preparing and Assembling the 2 in 1 Petrol Grass Trimmer/Brush Cutter

Fit the steady grip (Fig. 3a-3c) and additional handle without fully tightening the screw (Fig.2/Item20). Re-adjust and fully tighten the screw, only when the harness (Fig.2/Item 17) has been fitted.

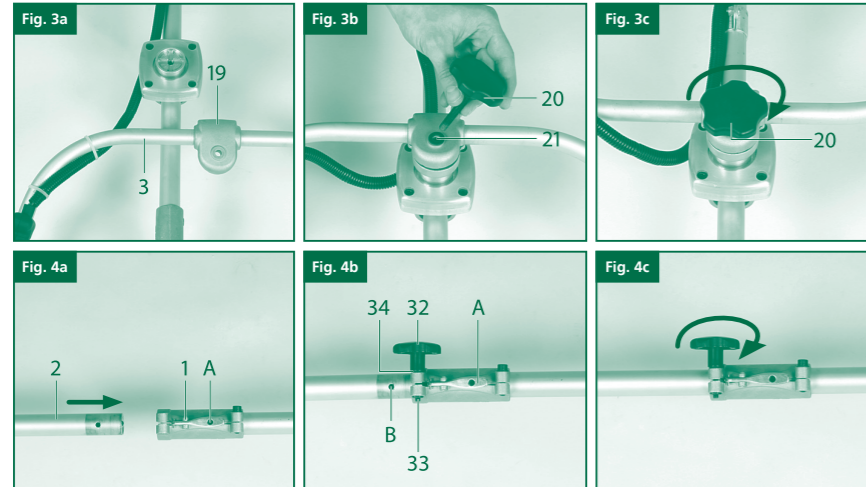

Connect the bottom shaft (2) to Upper shaft & engine (1) (See Figures 4a-4c) making sure the square drive shaft on lower shaft (2) is inserted into square drive on upper shaft (1) correctly and ensure the spring loaded locking clip is aligned with the hole provided and in place and the securing knob & washer (Fig.2/Items 32 & 33) are fitted and tightened. If the drive is not correctly inserted then the spool / blade will not turn.

IMPORTANT!

The cutting blade guard hood (15) must be fitted when you want to work with the cutting blade.

3) For your Safety

You must always fit the guards provided for your safety. Fit the 2 in 1 Petrol Grass Trimmer/Brush Cutter guard using the 4 screws provided, and also fit the brass coloured carrier plate (Fig. 6b/Item 22) over the splines on the drive shaft spindle.

Align the 'u' shaped cut-out (U), the round hole (V) and the hole in the Brass coloured carrier plate (22), and lock in position by using the small 4mm hexagon key (Fig. 7c-7e/Item 29).

- For the Brush Cutter - fit one of the Blades, Blade Clamp Collar & nut. Secure the drive shaft using the small 4mm hexagon key, and tighten the nut using the spark plug wrench (Fig.2/Item 27. See also Fig. 6f/6g). The cutting blades (18a/18b) are delivered with plastic protective caps fitted to them. Remove these caps before use and refit them after use.
- For the Grass trimmer – fit the cutting line guard hood as shown in Figures 7a – 7b. Make sure that the cutting line guard hood engages correctly. Secure the drive shaft using the small 4mm hexagon key, and screw on the line spool assembly (Fig. 7c).

IMPORTANT!

LH thread = rotate the line spool/nut/spanner counter-clockwise to tighten and clockwise to loosen).

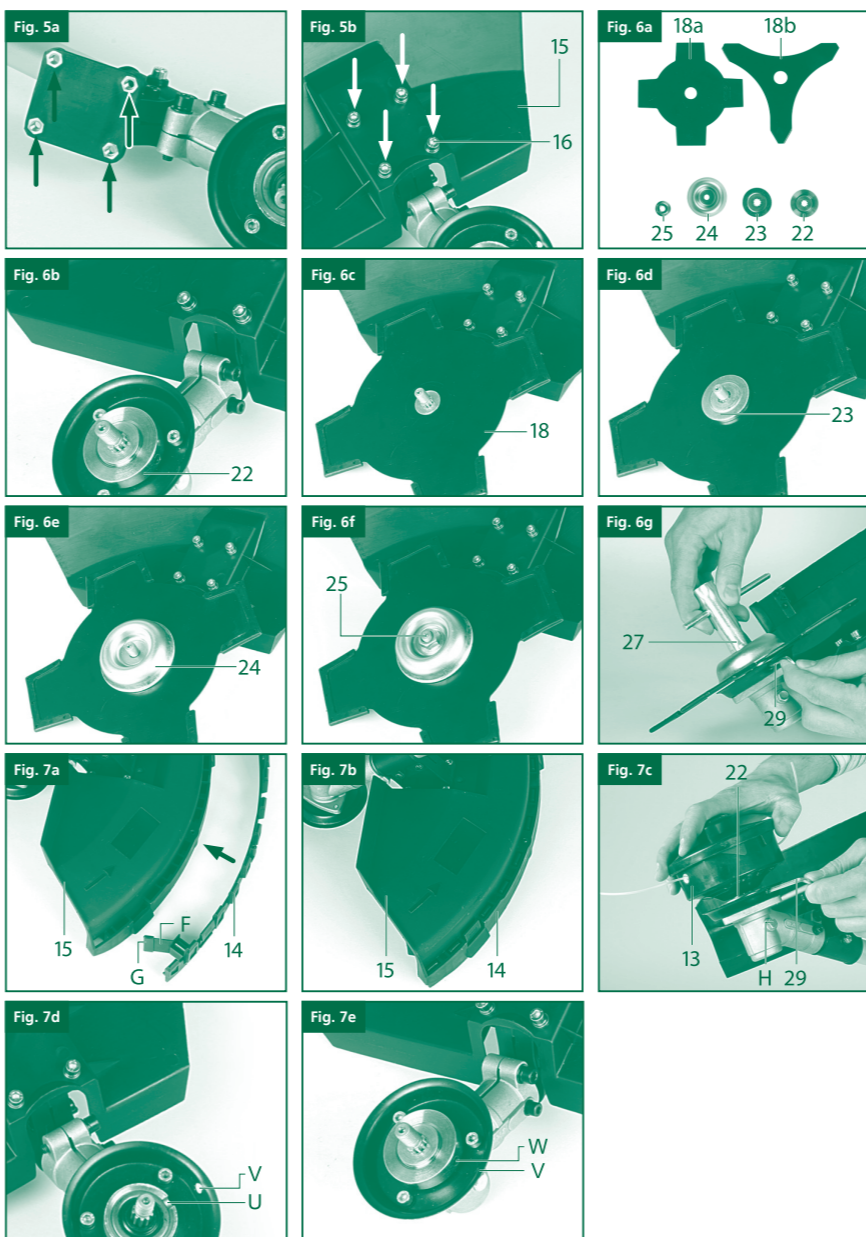

Fit the carry strap to the unit with the clip to the hook on the upper shaft (Fig 8a-8f), and adjust the handles / harness to suit the working height. Ensure the screw (Fig 3b/Item 20) is fully tightened to the steady grip.

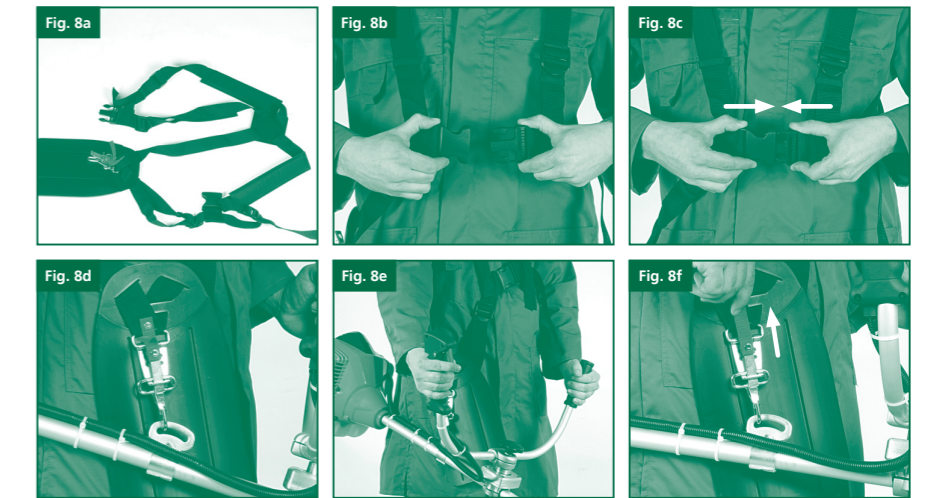

IMPORTANT!

If you are unsure, always refer to the user guide.

4) Fuel/Lubrication

- Mix the fuel in the mixer bottle provided.
- Shake the container gently to ensure that it is properly mixed.

IMPORTANT!

Failure to use the correct oil/fuel mixture will cause the engine to seize.

NOTE!



- Use regular grade unleaded petrol and quality 2 stroke oil.
- Fuel mixture is 40:1 (40 parts fuel to 1 part 2 stroke oil).