

# ozito

## AIRLESS PAINT SPRAYER

**700W**

**ORIGINAL INSTRUCTIONS**

### Assembly & Cleaning Manual

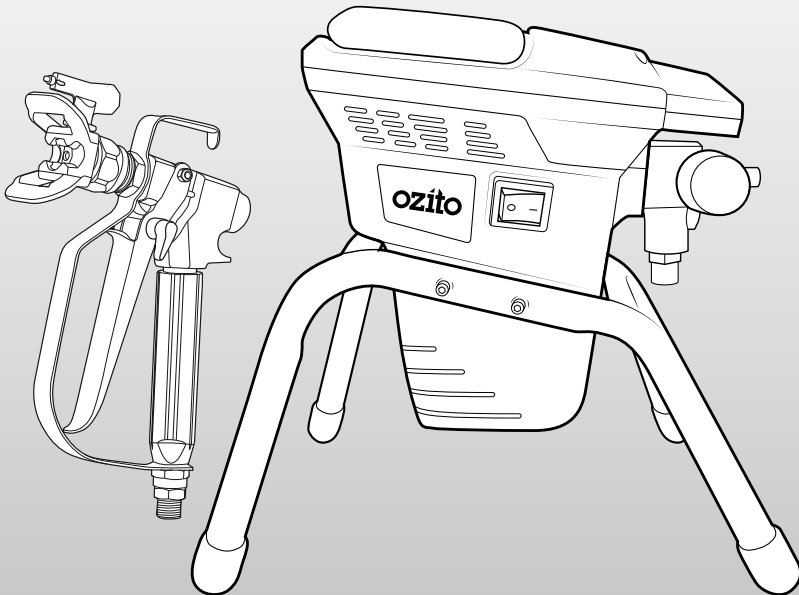

This cleaning process must be followed immediately after use to prevent paint from drying inside the pump and hose. Failure to follow this instruction may permanently seize the paint sprayer.

ASG-7000U

1117

# CONTENTS

Know Your Product .....	Page 2
Assembly & Set-up .....	Page 3
Painting Preparation .....	Page 5
Pressure Release Procedure .....	Page 7
Water Vs Oil Based .....	Page 8
Cleaning the Unit .....	Page 8
Cleaning the Inlet Hose .....	Page 10
Cleaning the Spray Gun .....	Page 10
Storage .....	Page 12
Spare Parts .....	Page 12

# KNOW YOUR PRODUCT

## AIRLESS SPRAY GUN

- |                         |                     |                       |
|-------------------------|---------------------|-----------------------|
| 1 On/Off Switch         | 5 Paint Outlet      | 11 Spray Gun          |
| 2 Pressure Control Dial | 6 Inlet Return Pipe | 12 High Pressure Hose |
| 3 Stand                 | 7 Inlet Hose        | 13 Spray Gun Filter   |
| 4 Filter                | 8 Priming Lever     | 14 Spanner x 3        |
| 9 Carry Handle          | 10 Nozzle Tip       | 15 Hex Key            |
|                         |                     | 16 Fine Needle        |
|                         |                     | 17 Cleaning Brush     |

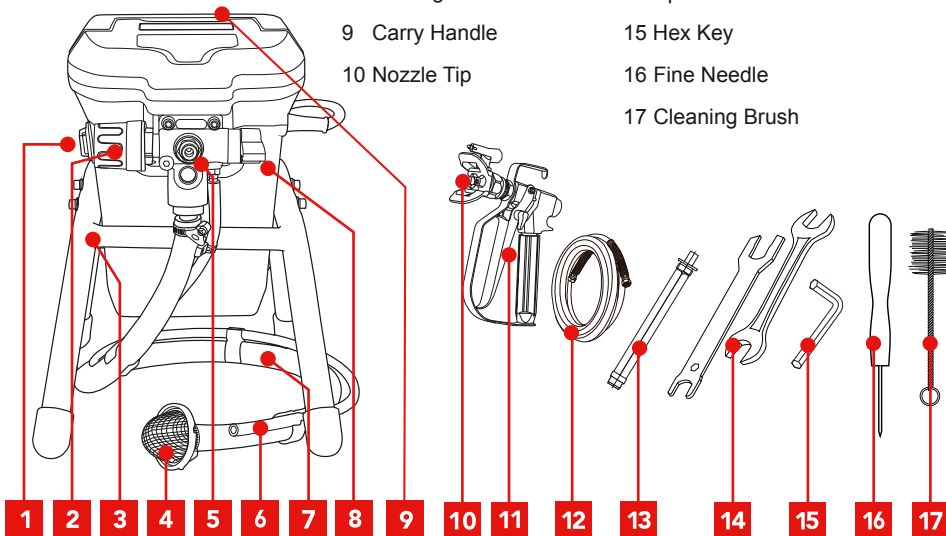

# ASSEMBLY & SET-UP



**WARNING!** ENSURE THE TOOL IS DISCONNECTED FROM THE POWER SUPPLY BEFORE PERFORMING ANY OF THE FOLLOWING OPERATIONS.

## Frame Connection

- 1 Insert the paint station into the frame, aligning the 4 bolt holes (2 either side).

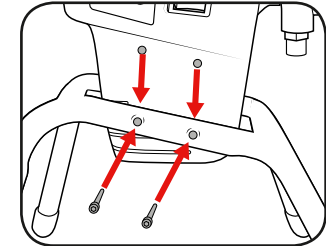

- 2 Insert the 4 bolts with washer and spring washer. Tighten the bolts using the included hex key.

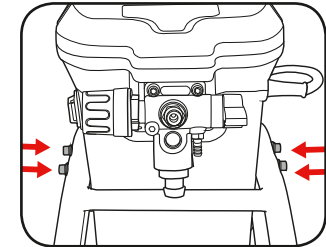

## Hose Connection

**Note:** The air caps on the paint station and air hose will need to be removed prior to connection.

- 1 Connect the high pressure hose to the paint outlet and tighten clockwise.

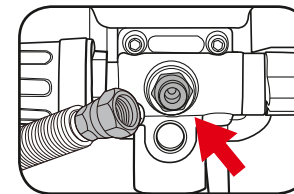

- 2 Connect the other end of hose to the gun inlet and tighten clockwise.

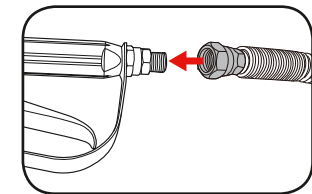

- 3 Ensure all connections have been correctly tightened with a 19mm spanner on the hose, and a 17mm spanner to hold the connection.

- 4 Connect the inlet hose and return pipe to the paint station. Secure the return pipe by releasing the tabs on the hose clamp.

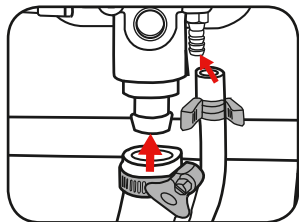

- 5 Secure inlet hose by tightening the screw on hose clamp with butterfly head clockwise.

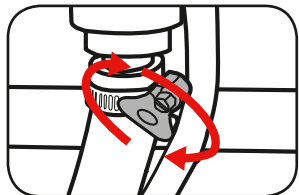

### Spray Tip & Guard

**Note:** The spray gun comes assembled from the factory. If the spray gun has been disassembled for cleaning, follow the steps below to re-assemble.

- 1 Push the mesh filter into the spray head and then insert the handle over the mesh filter.

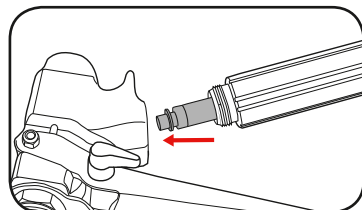

- 2 Ensure the trigger guard is attached to the handle and tighten the handle using a 19mm spanner.

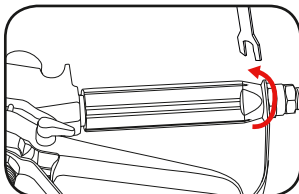

- 3 Insert the nozzle tip all the way into the nozzle.

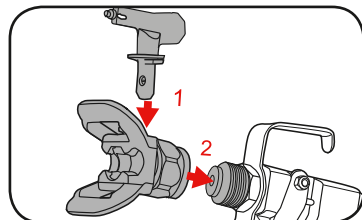

- 4 Attach and tighten the nozzle to the spray gun using a 27mm spanner.

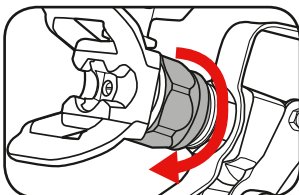

## PAINTING PREPARATION



**WARNING!** THIS TOOL IS RECOMMENDED FOR THE USE WITH RESIDUAL CURRENT DEVICE WITH A RATED RESIDUAL CURRENT OF 30MA OR LESS.

**Note:** You do not need to thin paint for use in this spray gun.

### Locking the Spray Gun Trigger

The spray gun trigger should be locked prior to preparing the spray station to ensure the trigger does not accidentally get released.

- 1 To lock the spray gun trigger, rotate the trigger locking lever clockwise.

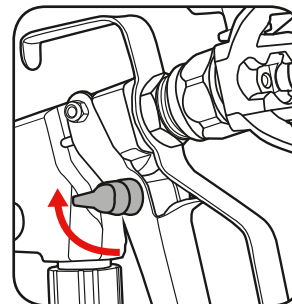

- 2 To unlock the trigger, rotate the trigger locking lever anti-clockwise.

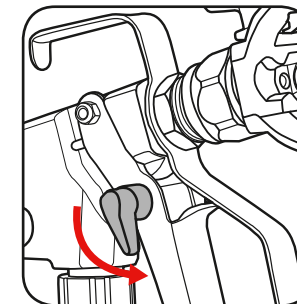

### Priming Operation

- 1 Fully submerge filter and return pipe in coating material.

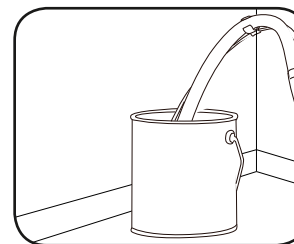

- 2 Set priming lever to the prime position.

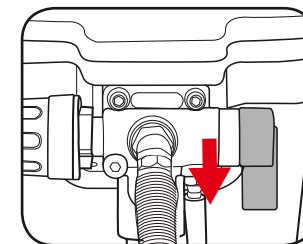

**Note:** When changing between different paint colours you may need to separate the return tube into a waste bucket to avoid the small amount of paint in the system discolouring the new paint.

- 3 Adjust the pressure dial to maximum position by rotating clockwise.

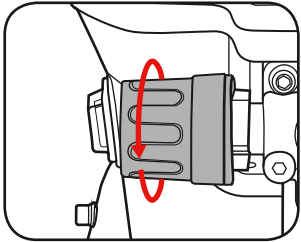

- 4 Turn the unit on and hold the trigger down to relieve pressure.

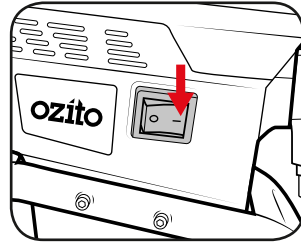

- 5 Wait for air bubbles to clear the return pipe, this is indicated by a steady stream of paint out of return pipe.

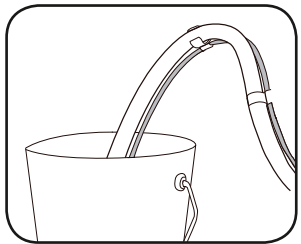

- 6 Release the trigger and switch the priming lever to the spray position.

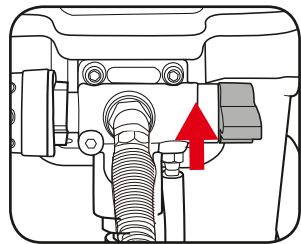

- 7 Wait for the Airless Sprayer to automatically cut out, after a few moments. The sprayer is now ready to use.

**Note:** The airless sprayer automatically shuts off once the operating pressure is reached and will start-up again when it drops below the cut-in pressure.

## PRESSURE RELEASE PROCEDURE



**WARNING!** BEFORE BEGINNING THE CLEANING PROCESS, ENSURE THE PRESSURE RELEASE PROCEDURE BELOW IS PERFORMED.

Follow this procedure diligently as a build-up of dried paint on the operating components can stop the unit from working.

### Pressure Release Procedure

- 1 Rotate the priming lever into the prime position.

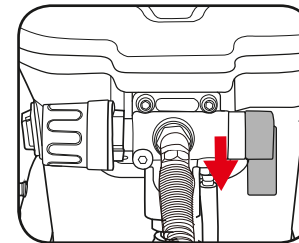

- 2 Aim the spray gun into the paint bucket and squeeze the trigger to release any remaining pressure in the gun.

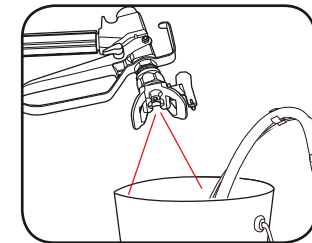

- 3 Lock the spray gun trigger.

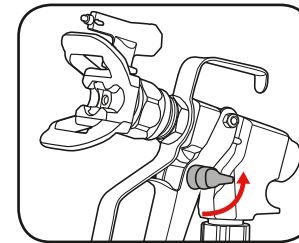

- 4 Switch the spray system off.

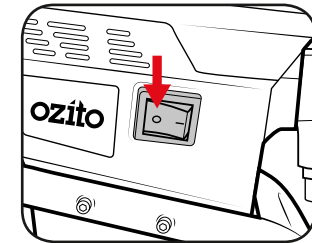

# WATER VS OIL BASED

If coating material was water based (acrylic paint), use ONLY water when performing the cleaning procedure. Use of solvent based cleaning materials on water based paints will result in a new substance that will be extremely difficult to clean.

If coating material was oil based (enamel paint etc.) use ONLY the appropriate cleaning solution. Read the cleaning instructions printed on the coating material's label to determine which cleaning material you need. The following solvent based cleaning products are safe to use in the airless paint sprayer:

- Mineral Turpentine
- Paint Thinner

# CLEANING THE UNIT

**Note:** Before beginning cleaning procedure ensure the pressure control dial is set to a medium to high setting and the priming lever is in the prime position.

- 1 Place the inlet hose into a bucket of appropriate cleaning solution. Place the return hose into an empty bucket or container.

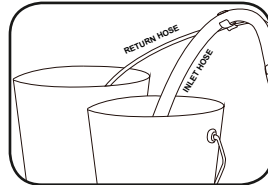

- 2 Turn the unit on, ensuring the priming lever is set to prime position. Check the return hose and wait for a constant stream of clear cleaning solution to pass out of it. Then set the priming lever to the spray position.

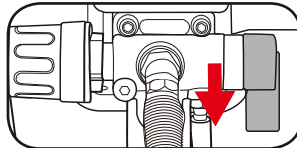

- 3 Aim the spray gun into an empty bucket or container. Squeeze and hold the spray gun trigger until most of the paint is removed from the high pressure hose.

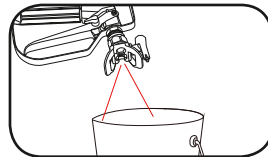

- 4 Lock the spray gun trigger. Rotate the spray tip 180° to the cleaning side. Unlock the spray gun trigger. Squeeze and hold the spray gun trigger to spray the cleaning solution through the system.

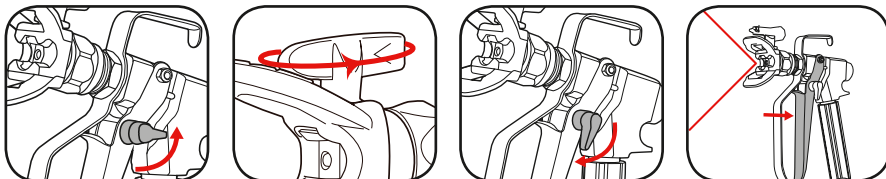

- 5 Continue this process until only cleaning solution is ejected from the spray tip. Add more cleaning solution if all of the paint has not been removed.

**Note:** If the cleaning solution bucket becomes cloudy with paint during cleaning, skip to section: **Cleaning of the inlet hose**. Once the inlet filter and hose are clean, re-assemble them and repeat steps 3-6.

- 6 Move the priming lever to the priming position. Then switch the unit off and disconnect it from the power supply.

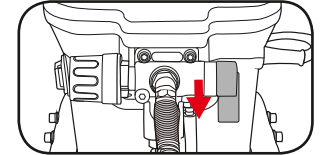

**Note:** This cleaning process must be followed immediately after use to prevent paint from drying inside the pump and hose. Failure to follow this instruction may permanently seize the paint sprayer.

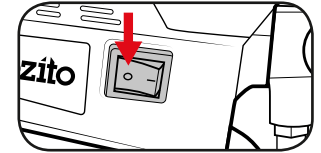

## For Water Based Cleaning

We recommend the use of 10-15 litres when performing the cleaning procedure.

## For Oil Based Cleaning

We recommend 1-2 litres of the appropriate solvent based cleaner when performing the cleaning procedure.

**Note:** If you have not finished painting with your airless sprayer and want to take a short break (30-60 minutes), do not leave paint sitting inside the pump. Perform steps 3-5 above to prevent paint from drying inside the pump & hose.

Once you're ready to begin work again simply follow the spraying instructions in the user manual. Once properly primed again, aim the spray gun into a waste bucket and allow 30 seconds for any leftover cleaning solution to be flushed out of the system. Then resume painting as normal.

**Note:** Mineral Turpentine SHOULD NOT be mixed with water at any stage during the cleaning process.

# CLEANING THE INLET HOSE

- 1 Unscrew the butterfly clamp on the inlet hose and slide the hose clamp away from the filter.
- 2 Pull the filter out and rinse under appropriate cleaning solution.

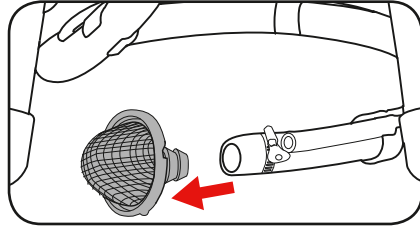
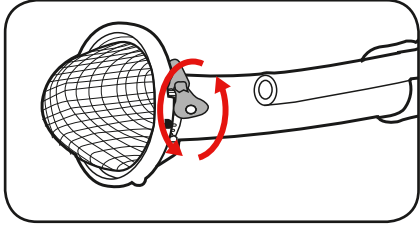

**Note:** If filter cannot be cleaned it must be replaced.

# CLEANING THE SPRAY GUN

**WARNING!** ENSURE THE UNIT IS OFF AND THE PRESSURE RELEASE PROCEDURE HAS BEEN PERFORMED.

- 1 Remove the spray gun from the high pressure hose by loosening the nut with a 19mm spanner.
- 2 Remove the nozzle guard and spray tip by loosening the retaining nut. Once the guard assembly has been removed, pull the nozzle tip out.

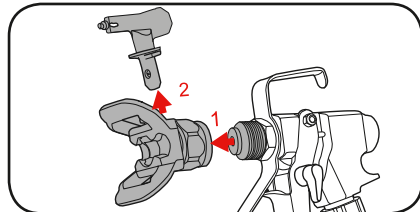
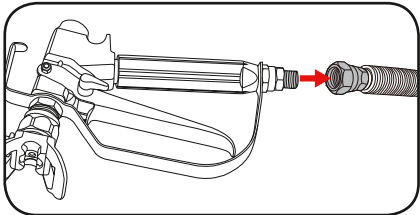

**Note:** A small spacer and washer are used to locate the nozzle tip within the guard. Be careful not to lose these components when the nozzle guard is removed.

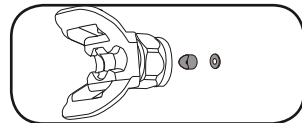

- 3 Loosen the nut below the handle using a 19mm spanner. Slide the tab out of its groove to free the trigger guard.

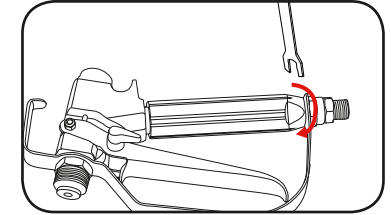

**Tip:** Using a shifter or bench vice to hold the upper part of the spray gun will make this step much easier.

- 4 Remove the mesh filter from the handle and clean all components in the cleaning solution.

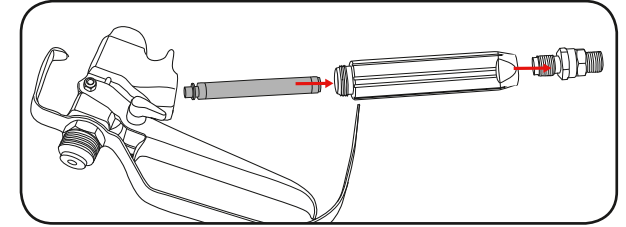

**Note:** If nozzle tip is blocked, use provided needle by inserting into the nozzle tip.

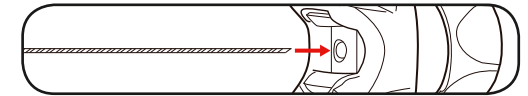

- 5 To clean the mesh filter, remove the cap at the end of the filter and then pull the mesh section out to disassemble the filter. Use the provided brush to scrub the inside of the mesh filter.

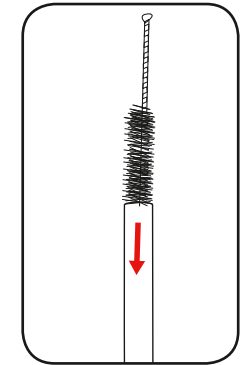
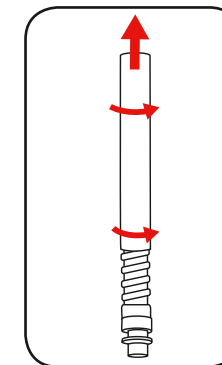
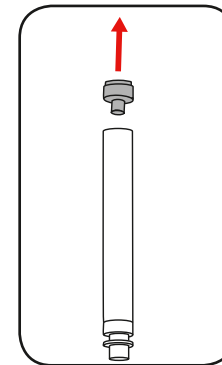

**Note:** After cleaning, inspect the condition of the filter. If the mesh is clogged with dried paint, has started fraying or has deformed out of shape it will need to be replaced.

- 6 Follow this procedure in reverse to re-assemble the spray gun.

# STORAGE

Once you have completed the cleaning procedure, it is important to protect the internal components of the pump before it is stored away. Failure to do so may result in premature wear and corrosion of the pump and various other components in your Airless Paint Sprayer. We recommend using a cleaning shield / liquid, available from Bunnings Warehouse. Refer to the manufacturer's instructions for use and follow accordingly.

# SPARE PARTS

Should an issue arise with your Airless Paint Sprayer or if you wish to make a claim under the 1 year Replacement Warranty, please call our Customer Service Helpline prior to returning your product.

*Note: There are a range of filters available to suit specific types of coating materials. To order a filter to suit your coating material please contact Ozito Customer Service.*

Spare parts can be ordered from the Special Orders Desk at your local Bunnings Warehouse or Homebase store.

For further information, or any parts visit

[www.ozito-diy.co.uk](http://www.ozito-diy.co.uk) or contact Ozito Customer Service:

Great Britain: 0151 294 4488

Ireland: 1850 882711

E-mail: [info@ozito-diy.co.uk](mailto:info@ozito-diy.co.uk)