



Table Saw BKS 315/400

Art.-No.: **43.071.41**

Bar Code: 4006825507089

Sales Unit: 1 pc

The table saw BKS 315/400 is powered by a strong 2,2 KW induction motor with mechanical brake. The saw is coated backed and is permanently protected against rusting.

The height adjustment based on ball-bearings allows simple and precise setting of the saw blade. The splitter is adjustable and enables one to make half or covered cuts.

The integrated magnifying glass at the length cut scaling makes reading the scale more comfortable. The aluminium slide is provided with a profile and can be positioned on angle ranging from 0-45°. The ball beared slide is set along the galvanized guard rail along the saw table. The fold-out undercarriage and few handle provide for mobile application of the table saw.

Features:

- Eccentric clamping locking(1) with aluminium guide
- Saw blade height adjustment (2)
- Handle for mobile use (3)
- Brackets for sliding stick and saw blade key (4)
- Undercarriage (5)
- Slide on ball-bearing with galvanized guide rail (6)
- Aluminium guide rail (7)
- End stop for repeat cut (8)
- Saw blade protection with chipping extractor socket (9)
- Eccentric clamping locking with aluminium guide (10)
- Splitter for covering cuts (11)
- Motor tiltable (12)
- Table extension
- Powder coated undercarriage and working table
- Powerful induction motor 2200 Watt with mechanical brake
- Robust double side gear rim guidance made of cast-iron
- Including dust extraction adaptor Ø 100 mm
- Carbide tipped saw blade

Technical data:

- | | |
|----------------------------------|---------------------------------|
| - Motor type: | Induction motor |
| - Table size: | 790 x 580 mm |
| - Working height: | 850 mm |
| - Size of additional side table: | 790 x 400 mm |
| - Machine size: | 1100 x 960 x 1150 mm |
| - Power: | 2200 Watts / S6 40% |
| - Idle speed: | 2860 min ⁻¹ |
| - Mains: | 400 V ~ 50 Hz |
| - Cutting height: | 90°:83 mm, 45°: 60 mm |
| - Saw blade: | Ø 315 x Ø 30 x 3,6 mm, 24 teeth |
| - Sliding carriage saw blade: | 0° - 45° |
| - Range of sliding carriage: | 0° - 45° |
| - Direct drive | |
| - Dust extraction adaptor: | 100 mm |
| - Weight: | 70 kg |
| - Packing dimensions: | 873 x 640 x 490 mm |

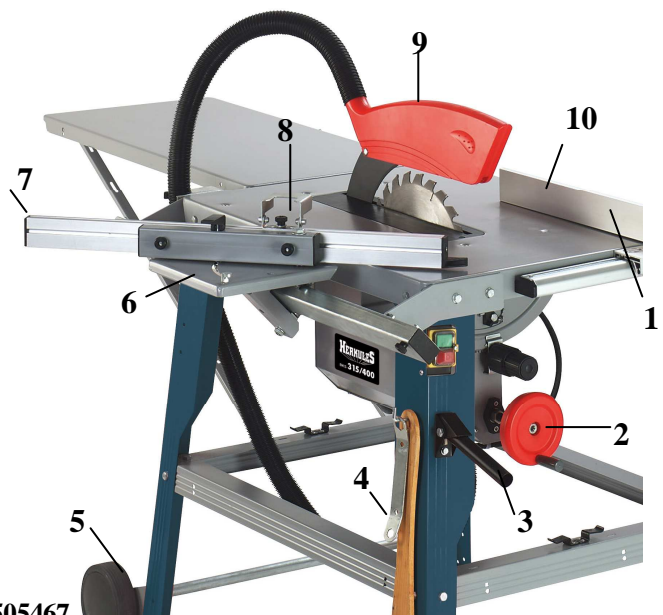
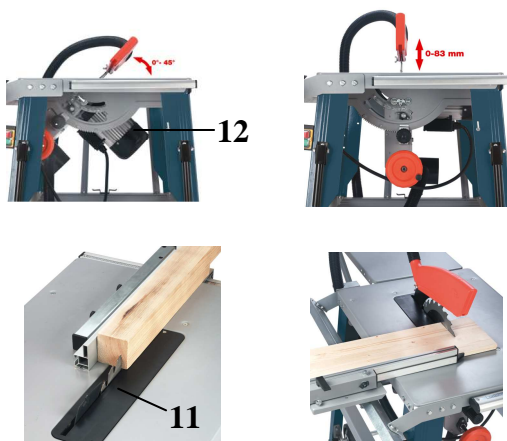

As special accessory available:

- | | |
|--|---|
| Carbide tipped saw blade
Ø 315 x Ø 30 x 3,0 mm 24 teeth | Art.-No.: 45.020.60
Bar Code: 4006825505467 |
| Carbide tipped saw blade
Ø 315 x Ø 30 x 3,0 mm 48 teeth | Art.-No.: 45.020.11
Bar Code: 4006825456295 |
| Carbide tipped saw blade
Ø 315 x Ø 30 x 3,0 mm 80 teeth | Art.-No.: 45.020.65
Bar Code: 4006825505917 |