

OPERATION

6. SWITCHING ON/OFF

Switching On

1. Hold the pruner firmly with both hands.

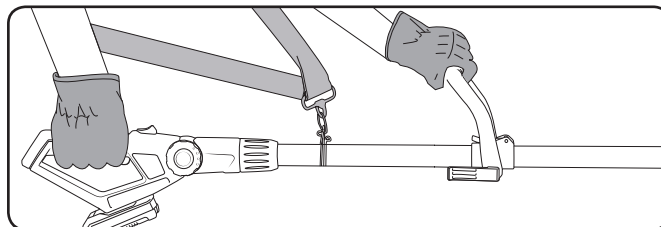

2. Slide the switch lock (a) to the front with your thumb and hold, then squeeze the trigger switch (b).
3. The chain will now be running ready to make a cut. Release the switch lock (a).

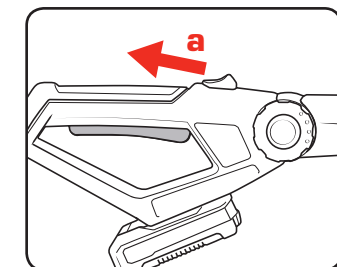
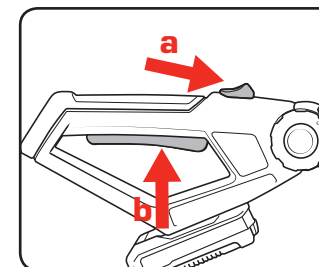

Switching Off

3. Release the trigger switch. The chain and motor will quickly stop.

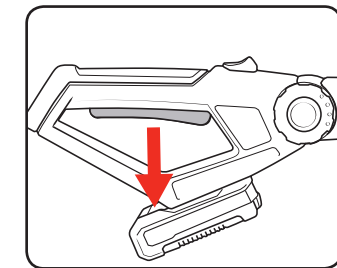

APPLICATIONS

WARNING! IF THE CHAIN COMES IN CONTACT WITH A HARD OBJECT, VISUALLY INSPECT THE CHAIN & BAR FOR DAMAGE. IF THE CHAIN OR BAR IS DAMAGED, DO NOT CONTINUE TO OPERATE THE POLE PRUNER.

WARNING! NEVER USE THE POLE PRUNER WHEN STANDING ON A LADDER OR UNEVEN GROUND. DO NOT OVERREACH. ALWAYS USE BOTH HANDS TO HOLD THE POLE PRUNER.

CAUTION! ALWAYS USE THE BUCKING SPIKES WHEN PERFORMING CUTS WITH THE POLE PRUNER TO AVOID KICKBACK (REFER TO OPERATION SECTION OF MANUAL).

CAUTION! ENSURE APPROPRIATE CARE IS TAKEN WHEN CUTTING ABOVE SHOULDER HEIGHT.

Limbing

- Limbing is the process of removing the branches from a fallen tree. Check the direction in which a branch will bend before cutting it. Always cut on the opposite side to the bending direction so that the guide bar is not pinched in the cut. For large limbs that cannot be removed in one cut, make an initial cut from the bent side and finish by sawing from the opposite direction. Do not remove limbs that are supporting the fallen tree on the ground until the tree has been cut into lengths.

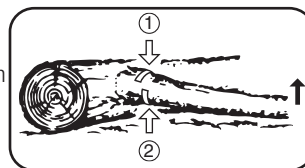

Pruning

- Pruning is the removal of a limb or branch from a standing tree.

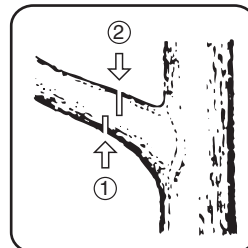

Sawing Techniques

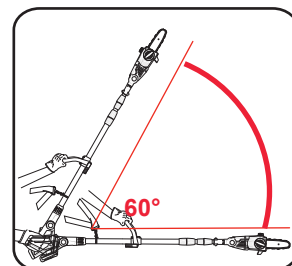

- When removing branches, hold the pruner at an angle ranging from a maximum 60° to horizontal in order to avoid being struck by a falling branch.

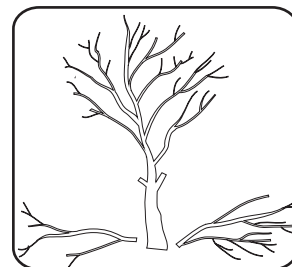

- Saw off the lower branches on the tree first. By doing so, it is easier for the cut branches to fall to the ground.

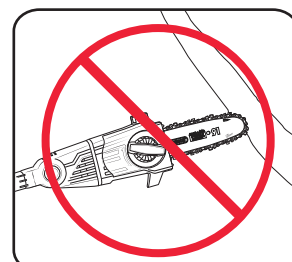

- Do not saw with the tip of the guide bar. This could lead to kick back and possible injury.

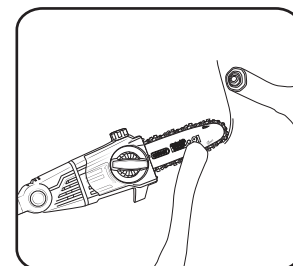

- At the end of the cut, the weight of the pruner suddenly increases for the user, because it is no longer supported on the branch. There is the risk of losing control of the pruner.

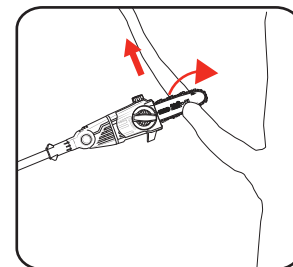

- Only pull the pruner out of the cut with the chain running. By doing so, you can prevent it from getting jammed.

MAINTENANCE

WARNING! BEFORE CLEANING YOUR POLE PRUNER, CARRYING OUT ANY MAINTENANCE PROCEDURE OR TROUBLESHOOTING, MAKE SURE THAT THE MOTOR IS OFF AND THE BATTERY REMOVED TO PREVENT ACCIDENTAL STARTING.

CAUTION! ALWAYS WEAR GLOVES WHEN HANDLING THE CHAIN AS IT IS VERY SHARP AND CAN CUT YOU WHEN IT IS NOT MOVING.

Maintaining the guide bar

1. Remove any sawdust from the guide bar, including the groove. Oil and sawdust combine and emit a burning smell during operation if the blade is not regularly cleaned.
2. Make sure that the oil port is not clogged. Grease the nose sprocket at the tip of the guide bar.
3. Check for oil leakage and loose fastenings, especially those securing the handles and the guide bar.
4. Reverse the guide bar every 8 working hours to ensure uniform wear. Check the guide rails frequently and if necessary remove burrs and square up the rails using a flat file.

Chain Sharpening

Chain File: 3.96mm (5/32")
Chain Pitch: 9.53mm (3/8")
Chain Gauge: 1.3mm (0.050")

Sharpen the chain regularly to maintain optimum performance of the saw. Signs of a dull chain are:

- The sawdust becomes powder-like
- Extra force is required to execute a cut
- The cut does not track in a straight line
- Increased vibration

Sharpen each cutter using a round 3.96mm (5/32") chain file. Keep the file level with the top plate of the tooth. Always use outward strokes and maintain a 30° angle between the chain and file. After sharpening, the cutters must all have the same width and length.

After every 3–4 uses get an authorised repair centre to professionally sharpen your chain. They have the special tools necessary to ensure the correct cutting angles and depths.

Troubleshooting Guide

The table below contains a list of fault symptoms and explains what you can do to remedy the problem if your equipment fails to work properly. If the problem still persists after working through the list, please contact your nearest service workshop.

| Fault | Possible cause | Remedy |
|---|--|--|
| The equipment does not work | - Battery empty - Battery is not correctly inserted | - Charge battery - Remove battery and insert again |
| Equipment operates intermittently | - Loose connection (external) - Loose connection (internal) - ON/OFF switch defective | - Consult a specialist workshop. - Consult a specialist workshop. - Consult a specialist workshop. |
| Saw chain is dry | - No oil in the tank - Vent in the oil tank cap is blocked - Oil outlet is blocked | - Top up with oil - Clean the oil tank cap - Clear the oil outlet |
| Chain/guide bar is hot | - No oil in the tank - Vent in the oil tank cap is blocked - Oil outlet is blocked - Chain is blunt - Chain is overtensioned | - Top up with oil - Clean the oil tank cap - Clear the oil outlet - Re-sharpen or replace the chain - Check the chain tension |
| Chainsaw judders, vibrates or does not saw properly | - Chain is undertensioned - Chain is blunt - Chain is worn - Saw teeth point in the wrong direction | - Adjust the chain tension - Re-sharpen or replace the chain - Replace the chain - Refit the chain with the teeth facing in the correct direction |

PROPER USE

Pole-mounted pruner (chainsaw with telescopic handle)

The chain saw mounting kit is allowed to be used only on the supplied motor head. The chainsaw with telescopic handle is designed for lopping off tree branches. It is not suitable for extensive sawing work, felling trees or sawing any materials other than wood.

The equipment is to be used only for its prescribed purpose. Any other use is deemed to be a case of misuse. The user / operator and not the manufacturer will be liable for any damage or injuries of any kind caused as a result of this. Please note that our equipment has not been designed for use in commercial, trade or industrial applications. Our warranty will be voided if the machine is used in commercial, trade or industrial businesses or for equivalent purposes.

SPARE PARTS

Spare parts can be ordered from the Special Orders Desk at your local Bunnings Warehouse or Homebase store. For further information, or any parts visit www.ozito-diy.co.uk or contact Ozito Customer Service: Great Britain: 0151 294 4488 Ireland: 1850 882711 E-mail: enquires@ozito-diy.co.uk

DESCRIPTION OF SYMBOLS

| | | | |
|-------------|--|-----------|---|
| v | Volts | Hz | Hertz |
| ~ | Alternating current | W | Watts |
| dc/— | Direct current | ∅ | Diameter |
| mA | Milliamperes | No | No load speed |
| /min | Revolutions or reciprocation per minute | ! | Warning! |
| | Wear sturdy, non-slip footwear. | | Wear safety goggles, a face guard and ear protection. |
| | Read the directions for use before operating the equipment. | | Watch out for falling and catapulting parts. |
| | Wear safety gloves | | Direction of the chain movement and teeth of the pole-mounted pruner. |
| | Protect the equipment from rain and damp. | | Maximum cutting length of the pole-mounted pruner. |
| | | | Keep your distance. |
| | Electric shock can cause fatal injury. Keep a distance of at least 10 m from power cables. | | |

ADDITIONAL INFORMATION

Danger! Sound and vibration

Sound and vibration values were measured in accordance with ISO 22868.

LpA sound pressure level 81.05 dB(A)
KpA uncertainty 3 dB
LWA sound power level measured 98.23 dB(A)
KWA uncertainty 3 dB
LWA sound power level guaranteed 102 dB(A)

Wear ear-muffs.

The impact of noise can cause damage to hearing. Total vibration values (vector sum of three directions) determined in accordance with ISO 22867.

Handle under load

Vibration emission value ah = 0.947 m/s²
K uncertainty = 1.5 m/s²
The specific ed vibration value was established in accordance with a standardized testing method. It may change according to how the electric equipment is used and may exceed the specific ed value in exceptional circumstances.

The specific ed vibration value can be used to compare the equipment with other electric power tools. The specific ed vibration value can be used for initial assessment of a harmful effect.

Keep the noise emissions and vibrations to a minimum.

- Only use appliances which are in perfect working order.
- Service and clean the appliance regularly.
- Adapt your working style to suit the appliance.
- Do not overload the appliance.
- Have the appliance serviced whenever necessary.
- Switch the appliance off when it is not in use.
- Wear protective gloves.

ISC GmbH · Eschenstraße 6 · D-94405 Landau/Isar



Cordless Pole Pruner PXCPPS-018U (Ozito)

2014/29/EU 2006/42/EC
 2005/28/EC, 2009/125/EC Annex IV
 2014/26/EU 2006/28/EC
 2014/30/EU 2000/14/EC, 2005/88/EC (Outdoor)
 2014/32/EU Annex V
 2014/33/EC Annex VI
 2014/68/EU 2006/42/EC
 90/396/EC, 2009/142/EC 2012/46/EU (Schadstoff - Abgas)
 2011/65/EU 2011/65/EU

Standard references: EN 60745-1:2009; EN ISO 12100:2010; EN ISO 11680-1:2011; EN 55014-1:2006+A1+A2; EN 55014-2:2015

Landau/Isar, den 28.09.2016

Werkzeughersteller/Manager

Key/Produkt Management

Archiv-File/Record: NAPR015300

Documents registry: B. Gubaud

Wiesenberg 22, D-94405 Landau/Isar

First CE: 16

Art.-No.: 43 108 16

I.-No.: 11016

Subject to change without notice



18V LITHIUM ION

CORDLESS POLE PRUNER

ORIGINAL INSTRUCTIONS

SPECIFICATIONS

Input: 18V
Bar Length: 200mm
Cutting Length Max.: 170mm
Chain Speed: 3.76m/s
Oil Tank Capacity: 125ml
Length: 1.83 - 2.77m
Weight (without battery): 3.9kg

ozito-diy.co.uk

5 YEAR REPLACEMENT WARRANTY

EH-Art. No.: 34.108.16

I-No.: 11016



WHAT'S IN THE BOX

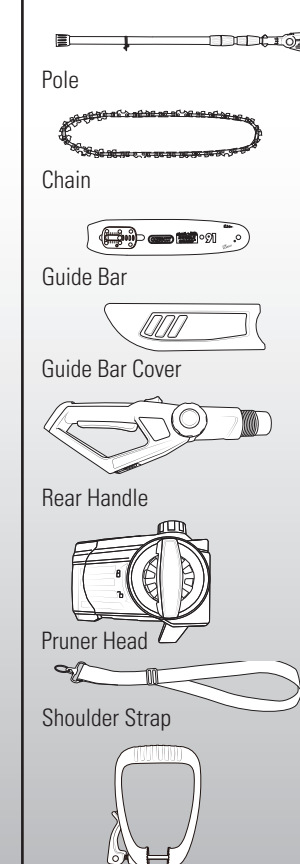

Battery & Charger sold separately

PXCPPS-018U

WARRANTY

All of our products undergo strict quality checks to ensure that they reach you in perfect condition. In the unlikely event that your device develops a fault, please contact our service department at the address shown on this guarantee card. You can also contact us by telephone using the customer service number shown. Please note the following terms under which guarantee claims can be made:

1. These warranty terms regulate additional warranty services, which the manufacturer mentioned below promises to buyers of its new products in addition to their statutory guarantee claims are not affected by this guarantee. Our guarantee is free of charge to you.

2. The warranty services only covers defects due to material or manufacturing faults on a product which you have bought from the manufacturer mentioned below are limited to either the rectification of said defects on the product or the replacement of the product, whichever we prefer. Please note that our devices are not designed for use in commercial, trade or professional applications. A guarantee contract will not be created if the device has been used by commercial, trade or industrial business or has been exposed to similar stresses during the guarantee period.

3. The following are not covered by our guarantee:
- Damage to the device caused by a failure to follow the assembly instructions or due to incorrect installation, a failure to follow the operating instructions (for example connecting it to an incorrect mains voltage or current type) or a failure to follow the maintenance and safety instructions or by exposing the device to abnormal environmental conditions or by lack of care and maintenance.
- Damage to the device caused by abuse or incorrect use (for example overloading the device or the use of unapproved tools or accessories), ingress of foreign bodies into the device (such as sand, stones or dust, transport damage), the use of force or damage caused by external forces (for example by dropping it).
- Damage to the device or parts of the device caused by normal or natural wear or tear or by normal use of the device.

4. Your Product is guaranteed for a period of 60 months from the original date of purchase and is intended for DIY (Do It Yourself) use only. Lithium Ion batteries and chargers are covered by a 12 month warranty. Warranty excludes consumable parts. Guarantee claims should be submitted before the end of the guarantee period within two weeks of the defect being noticed. No guarantee claims will be accepted after the end of the guarantee period. The original guarantee period remains applicable to the device even if repairs are carried out or parts are replaced. In such cases, the work performed or parts fitted will not result in an extension of the guarantee period, and no new guarantee will become active for the work performed or parts fitted. This also applies if an on-site service is used.

covered by a 12 month warranty. Warranty excludes consumable parts. Guarantee claims should be submitted before the end of the guarantee period within two weeks of the defect being noticed. No guarantee claims will be accepted after the end of the guarantee period. The original guarantee period remains applicable to the device even if repairs are carried out or parts are replaced. In such cases, the work performed or parts fitted will not result in an extension of the guarantee period, and no new guarantee will become active for the work performed or parts fitted. This also applies if an on-site service is used.

IN ORDER TO MAKE A CLAIM UNDER THIS WARRANTY YOU MUST RETURN THE PRODUCT TO THE PLACE OF PURCHASE WITH YOUR REGISTER RECEIPT.

Please refer to the restrictions of this warranty concerning wearing parts, consumables and missing parts as set out in the service information in these operating instructions.

CUSTOMER SERVICE HELPLINE
GB: 0151 294 4488
IRL: 1850 882711
Ozito-diy.co.uk

KNOW YOUR PRODUCT

CORDLESS POLE PRUNER

- Chain
- Guide Bar
- Oil Cap
- Side Cap
- Pivoting Pruner Head Release
- Telescopic Tube Lock
- Main Tube
- Auxiliary Handle
- Shoulder Strap Holder
- Assembly Nut
- Pivoting Handle Release
- Rear Handle
- Chain Cover Lock
- Chain Tension Adjustment Dial
- Switch Lock
- Auxiliary Handle Lever
- Trigger Switch
- Battery Seating
- Mounting Attachment Lever

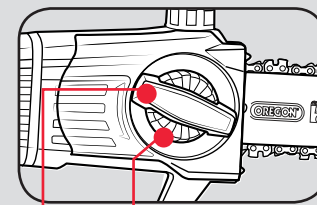
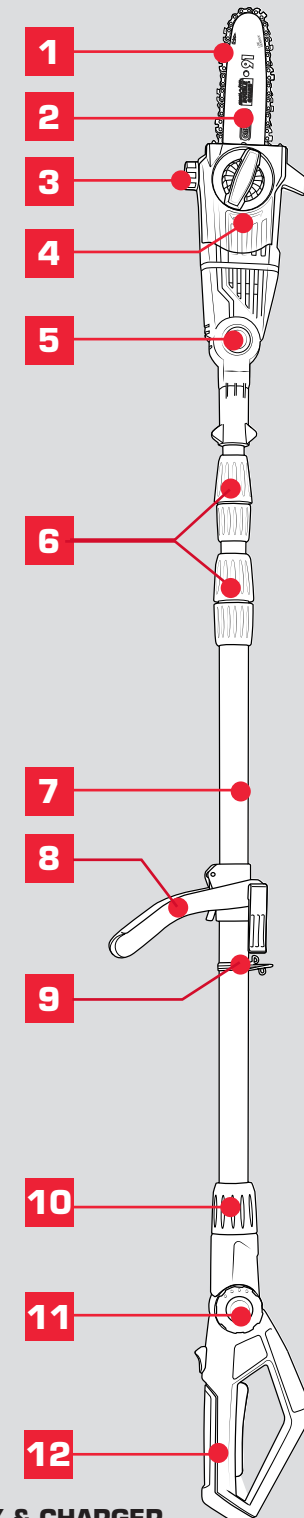

13 14 15

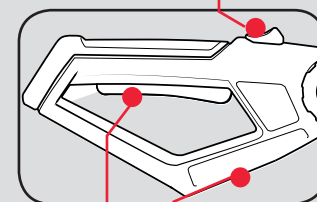

16 17 18 19

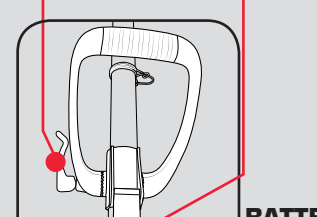

BATTERY & CHARGER (sold separately)

This tool is compatible with all battery and chargers from the Ozito Power X Change Range. For example: Batteries PXBP-200U (2Ah / 18V) & PXBP-400U (4Ah / 18V). Charger: PXCg-030U (18V).

ONLINE MANUAL

Scan this QR Code with your mobile device to take you to the online manual.



SETUP & PREPARATION

1. ASSEMBLY

CAUTION: ENSURE THE TOOL IS OFF & THE BATTERY REMOVED BEFORE PERFORMING ANY OF THE FOLLOWING OPERATIONS.

Fitting Rear Handle

1. Push the rear handle fully onto tube aligning the internal prongs.

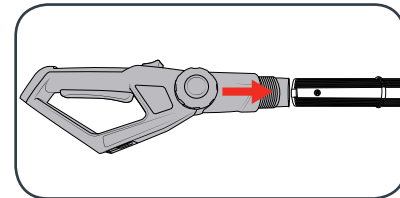

2. Screw tight with the assembly nut.

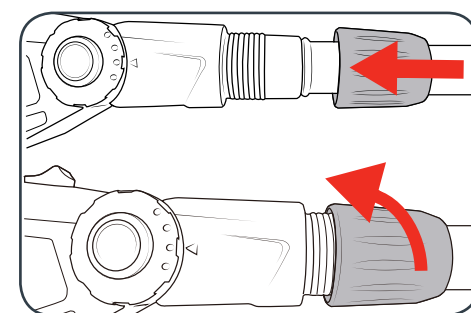

Fitting Auxiliary Handle

1. Place the Auxiliary Handle onto the mounting attachment.

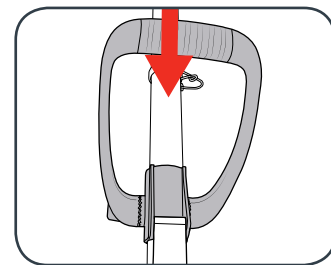

2. Pass the bolt through the auxiliary handle and screw the lever to the end of the bolt.

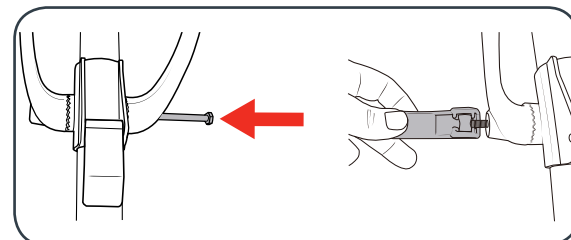

3. Select the most comfortable position and close the lever to lock the auxiliary handle in position.

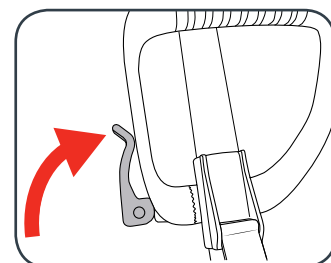

Fitting Pruner Head

1. Align the pruner head and the motor head so the arrows on both coincide.

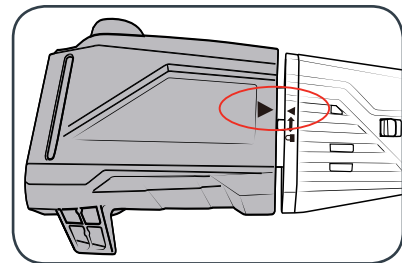

2. (a) Press the pruner head against the motor head. This will cause the lock button to be pushed to the right. (b) Turn the pruner head clockwise. The pruner head will lock onto the motor head and is then secured in place.

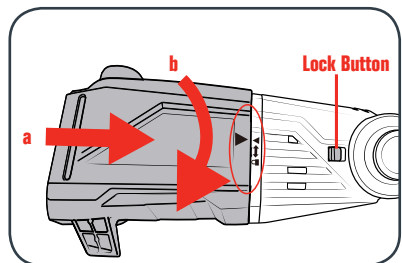

Note: The Lock Button will "CLICK" back to the left (original position) when the pruner head is correctly secured in place.

Fitting Guide Bar & Chain

1. Loosen the chain cover lock and remove the side cover.

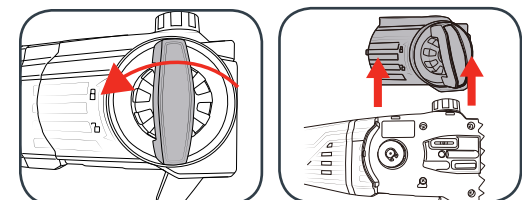

CAUTION: THE CHAIN HAS SHARP EDGES. FOR YOUR OWN SAFETY, PLEASE WEAR WORK GLOVES.

2. Place the chain in the groove of the guide bar as shown. Refer to the image printed on the guide bar that indicates the direction that the chain should face.

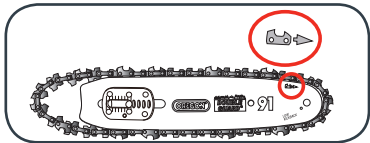

IMPORTANT: IF THE CHAIN IS INSTALLED BACKWARDS (CHAIN CUTTERS ARE FACING IN THE OPPOSITE DIRECTION OF ROTATION) THE POLE PRUNER WILL VIBRATE EXCESSIVELY AND NOT CUT.

3. Place onto the mount, ensuring that the chain sits around the chain sprocket.

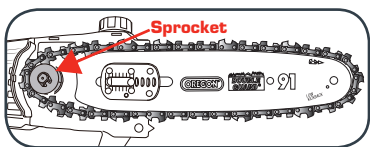

4. Re-mount and finger-tighten the side cover with the chain cover lock.

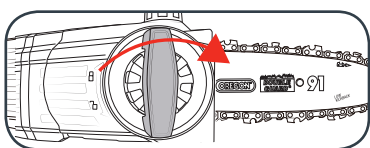

Note: Only tighten the chain cover locking knob securely once the chain tension has been adjusted (see: Tensioning the chain.)

2. TENSIONING THE CHAIN

CAUTION: THE CHAIN HAS SHARP EDGES. FOR YOUR OWN SAFETY, PLEASE WEAR WORK GLOVES.

1. Loosen the chain cover lock. Do not remove the side cover.

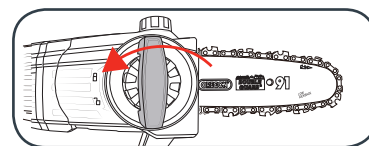

CAUTION: IF YOU TRY TO ROTATE THE CHAIN TENSIONING ADJUSTMENT DIAL WHILST THE CHAIN COVER LOCK IS TIGHT, IT WILL RESULT IN THE CHAIN NOT LOOSENING AND POSSIBLE DAMAGE TO THE MECHANISM.

2. Adjust the chain tension with the chain tensioning adjustment dial. Turning the dial CLOCKWISE increases the chain tension, turning it COUNTER-CLOCKWISE decreases the chain tension.

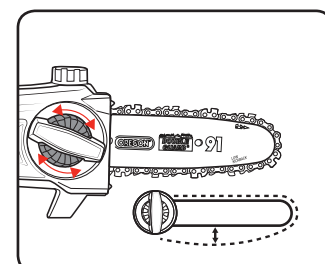

For the correct chain tension, firmly pull up on the chain at the middle of the top of the exposed guide bar. When the chain is pulled up to its highest point, the bottom tip of the links should only just stay in the track [middle of the guide bar]

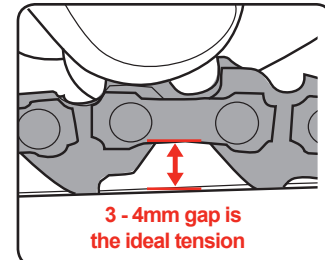

3 - 4mm gap is the ideal tension

3. After the chain has been accurately tensioned, lock the guide bar in place with the chain cover locking knob.

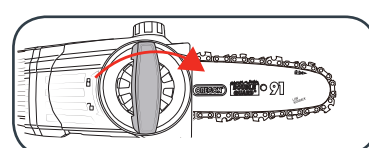

Note: Proper tension of the chain is extremely important and must be checked before starting, as well as during any cutting operation. Taking the time to make adjustments to the chain will result in improved cutting performance and prolonged chain life.

3. OIL

IMPORTANT: ONLY USE OIL THAT IS EXPRESSLY LABELLED "CHAIN BAR OIL".

1. Remove the chain bar oil cap.
2. Fill the tank with chain bar oil. The capacity of the chain oil tank is 125ml. Do not over fill.

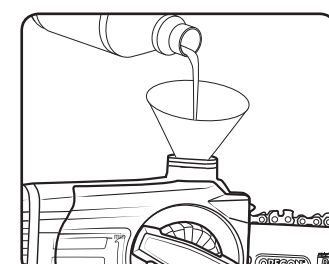
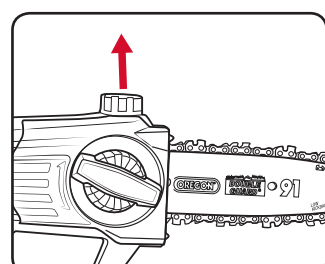

3. Refit cap and clean any oil spillage.

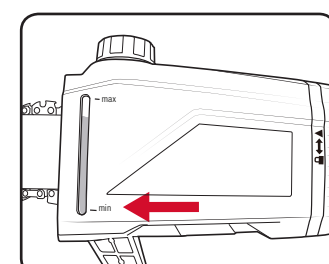

4. Always fill oil tank when the oil level is below the minimum mark on the oil level window.

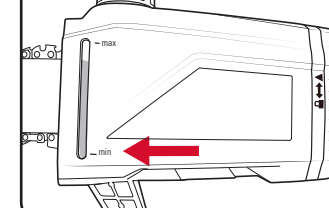

WARNING: NEVER START WORK UNLESS THE CHAIN AND BAR ARE LUBRICATED

4. To check the lubricating system, switch on the pole pruner and hold it with the guide bar and chain above some light coloured paper such as newspaper. A steadily increasing stain caused by oil spray shows the lubricating system is working.

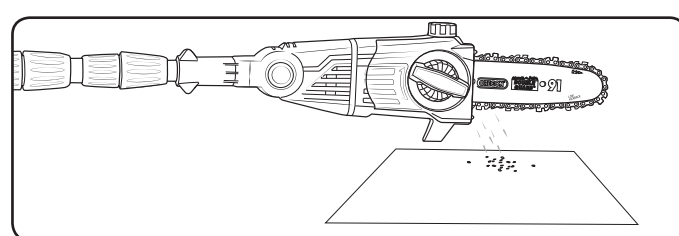

Note: Chain bar oil may leak if the tool is left for long periods. This is normal. If the tool is to be left unused for an extended time, drain the oil from the tool. Refill before use.

4. PREPARATION

Adjusting the telescope length

1. To unlock the telescopic tube lock, twist it in a clockwise direction while pointing the chain away from the user.

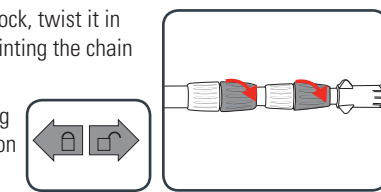

2. Pull out the telescopic tubes to suit the required working height.

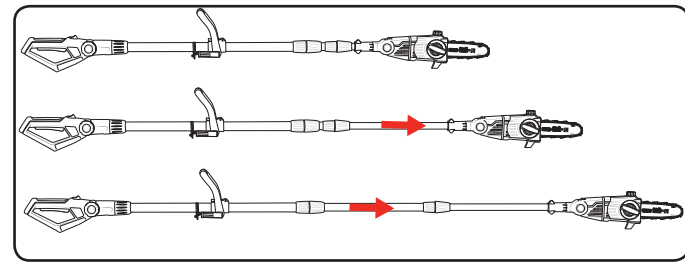

3. To lock in the desired position, twist the telescopic tube lock in a counter-clockwise direction.



Adjusting the Rear Handle

1. Press the two pivoting handle releases, one each side and adjust the angle of the handle up or down to any of 4 positions.

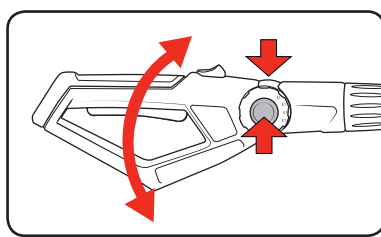

Adjusting the Auxiliary Handle

1. (a) Open the handle lever and set the required (b) tilt of the auxiliary handle, close to lock into position.

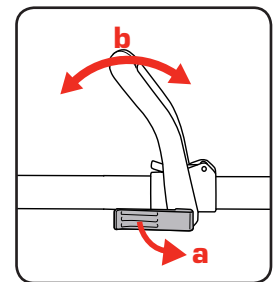

2. (a) Open the mounting bracket lever and (b) slide the auxiliary handle into the required position, close to lock into position.

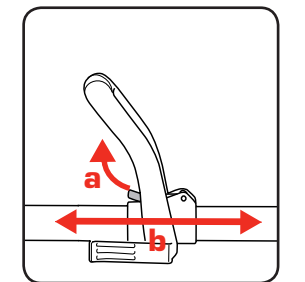

Adjusting the Pruner Head

Pivoting the Pruner Head

1. Press the two pivoting head releases, one each side and adjust the angle of the pruner head up or down to any of 7 positions.

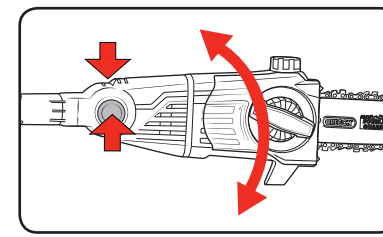

Adjusting the Pruner Head 90°

1. Pull the lock button to the right then rotate the pruner head 90° clockwise.

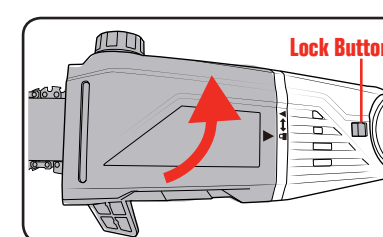

Note: Keep the pruner head pressed against the motor head when rotating.

2. The pruner head will lock onto the motor head and is then secured in place.

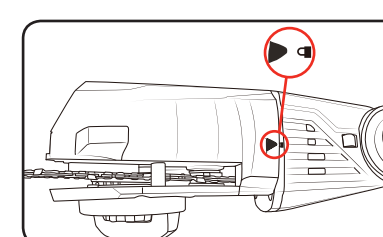

Note: The Lock Button will "CLICK" back to the left (original position) when the pruner head is correctly secured in place.

Attaching the Shoulder Strap

1. Fasten to the shoulder strap holder on the main tube.

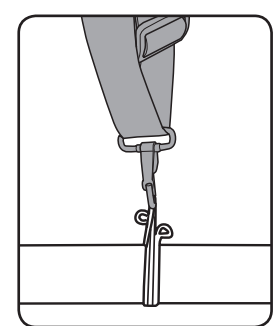

2. Wear the shoulder strap so that it lies over the left shoulder.

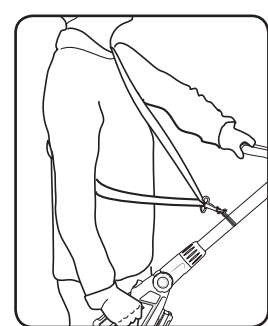

5. INSERTING & REMOVING THE BATTERY

Installing a Battery into the Pole Pruner

1. Align the ribs of the battery with the recess below the handle

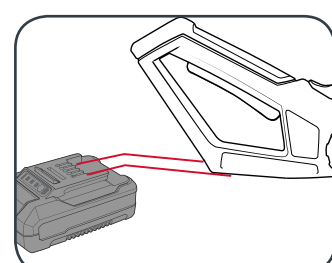

2. Slide the battery in so that it clicks into place.

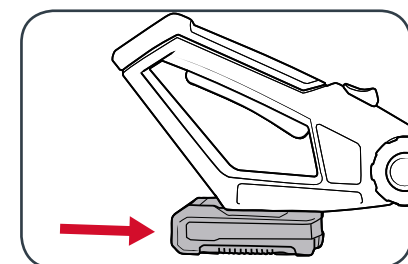

Removing a Battery from the Pole Pruner

1. Press and hold the battery release tab to release the battery.

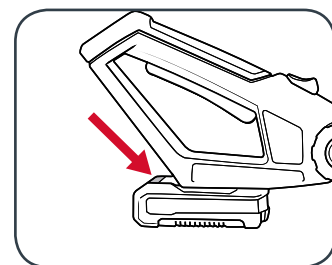

2. Slide the battery out.

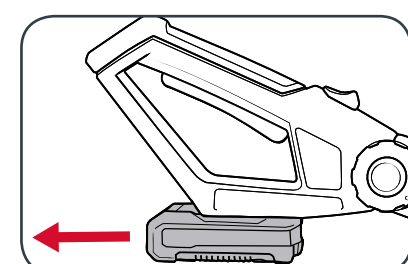

5 YEAR
REPLACEMENT WARRANTY