



# Einhell

# CLASSIC

Scroll Saw

**TC-SS 405 E**

**Item No.: 4309040**

Ident No.: 11049

Bar Code: 4006825589900

The TC-SS 405 E scroll saw is a useful helper for building models and for other occasional precision cutting jobs. The solid saw base ensure stability and quiet action. Thanks to the tiltable work table, individualization is easy. For really accurate results the blade speed is electronically controlled with high precision. The practical blow-off device of the TC-SS 405 E keeps the workpiece free of chips, making it easier to cut exactly along the marked contour. In addition, a dust extractor adapter can be used to keep the workplace agreeably clean. The saw blades can be changed quickly and safely using the clamping lever, not matter, if coping saw blades or blades with T-shaft.

## Features & Benefits

- A solid base guarantee a stable placing even during working
- Metal work table adjustable up to 45°
- Quick-release clamp makes it easy to change the saw blade
- the work piece hold-down enables accurate cuts and safety work
- Connection for dust extrator for a tidy workshop
- 1 additional spare saw blade is included in the packaging
- The unit can be affixed directly to the workbench.
- Perfect view to the workpiece due to the blow-off-function
- Works with saw blades with T-shaft and coping saw blades



## Technical Data

- |                               |                              |
|-------------------------------|------------------------------|
| - Mains supply                | 230 V   50 Hz                |
| - Max. power (S2   S2time)    | 120 W   10 min               |
| - Number of strokes           | 400 - 1600 min <sup>-1</sup> |
| - Stroke height               | 14 mm                        |
| - Saw blade length            | 127 mm                       |
| - Max. cutting height at 45°  | 20 mm                        |
| - Max. cutting height at 90°  | 52 mm                        |
| - Throat                      | 406 mm                       |
| - Diameter of suction adapter | 36 mm                        |
| - Size of working table       | 408 x 250 mm                 |
| - Table tiltable              | 45 °                         |

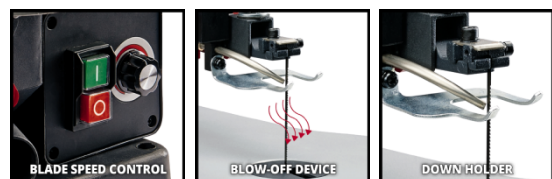

## Logistic Data

- |                                      |                    |
|--------------------------------------|--------------------|
| - Product weight                     | 12.15 kg           |
| - Gross weight single packaging      | 14.15 kg           |
| - Dimensions single packaging        | 656 x 326 x 329 mm |
| - Pieces per export carton           | 1 Pieces           |
| - Gross weight export carton         | 14.15 kg           |
| - Dimensions export carton           | 656 x 326 x 329 mm |
| - Container quantity (20"/40"/40"HC) | 441   882   1008   |

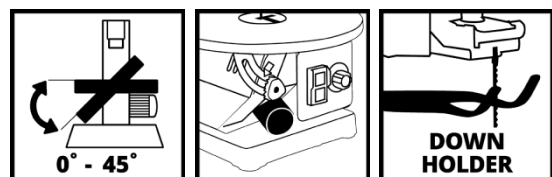

## Available as special accessories

saw blade kit 127mm, 5pcs.  
Scroll Saw Accessory  
Item No.: 4506200  
Bar Code: 4006825453928  
Einhell Grey