

Ⓜ Operating Instructions
Battery-powered Drill/Screwdriver

Einhell[®]
NEW GENERATION



N10024

Art.-No.: 45.106.42

I.-No.: 01016

screwmaxx
NGS 4,8



Ⓢ **Important:** Read and note the operating instructions and safety regulations before using!

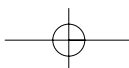
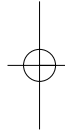
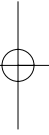

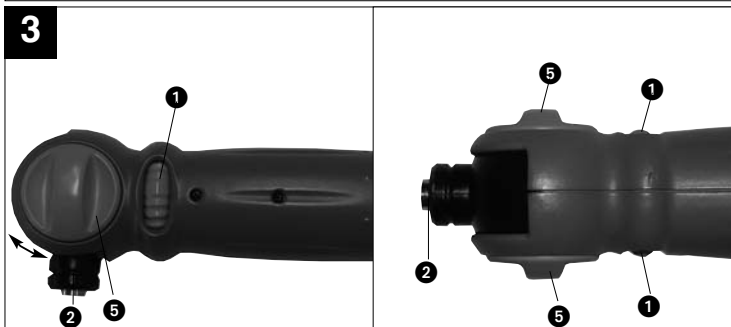
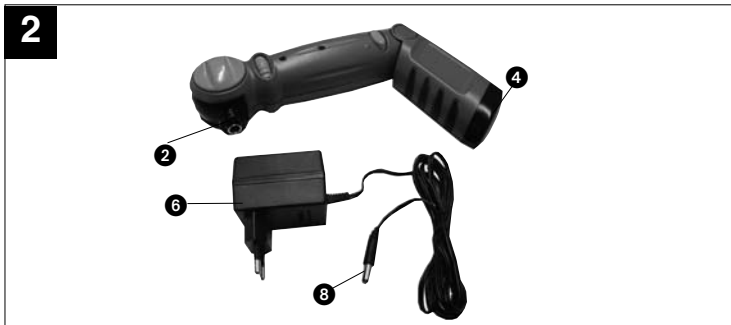
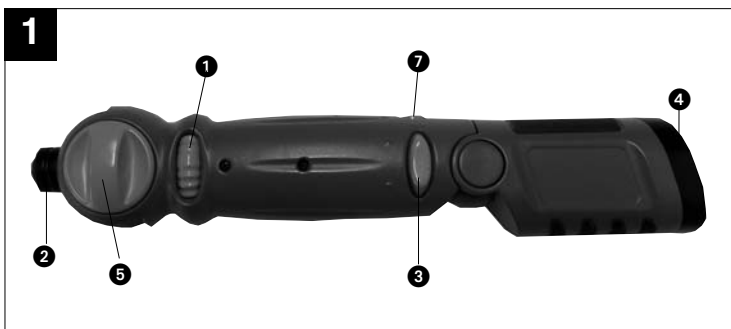

GB

GENERAL SAFETY REGULATIONS**CAUTION!** Read the instructions in full.

Any errors made in following the instructions set out below may result in an electric shock, fire and/or serious injury. The term "electric tool" used below refers to electric tools operated from the mains power supply (with a power cable) and to battery operated electric tools (without a power cable).

KEEP THESE REGULATIONS IN A SAFE PLACE!**1. WORK AREA**

- **Keep your work area clean and tidy.**
Disorder and insufficiently illuminated work areas can lead to accidents.
- **Do not use this tool in a potentially explosive environment containing combustible liquids, gases or dust.**
Electric tools generate sparks, which can in turn ignite dust or vapors.
- **Keep children and other persons away from the electric tool while it is being used.**
Allowing yourself to get distracted can cause you to lose control of the tool.

2. ELECTRICAL SAFETY

- **The tool's connector plug must be able to fit into the socket outlet. Do not modify the plug in any way! Do not use adapter plugs in conjunction with electrically grounded tools.**
Unmodified plugs and matching socket outlets reduce the risk of an electric shock.
- **Avoid touching grounded surfaces, such as those of pipes/tubes, heaters, cookers and refrigerators.**
There is an increased risk of getting an electric shock if you are electrically grounded.
- **Keep the tool away from rain and moisture/wet conditions.**
Penetration of water into an electric tool increases the risk of an electric shock.
- **Do not use the cable to carry the tool, hang it up or pull the plug out of the socket. Keep the cable away from sources of heat, oil, sharp edges and moving tool parts.**
Damaged or tangled cable increases the risk of an electric shock.
- **If you intend to use an electric tool outdoors, ensure that you only use extension cable that is approved for outdoor applications.**
Using extension cable that is approved for outdoor applications reduces the risk of an electric shock.
- **Connect the electric tool to the mains power supply (230V~, 50Hz) via a socket-outlet with earthing contact with maximum 16A**

protection. We recommend that you fit a residual-current protection device with a maximum nominal tripping current of 30 mA. Seek the advice of your electrician.

3. PERSONAL SAFETY

- **Be alert, work conscientiously and exercise appropriate caution when using the electric tool. Do not use the tool if you are tired or are under the influence of drugs/medication or alcohol.**

One moment of carelessness or lack of attention when using the electric tool can cause serious bodily injury!

- **Always wear personal protective equipment (PPE), including safety goggles.**

Wearing personal protective equipment such as a dust mask, non-slip footwear, protective headgear and ear muffs (depending upon the type of electric tool and the particular application) reduces the risk of sustaining injury.

**Wear ear-muffs.**

The impact of noise can cause damage to hearing.

**Wear a breathing mask.**

Dust which is injurious to health can be generated when working on wood and other materials. Never use the device to work on any materials containing asbestos!

**Wear safety goggles.**

Sparks generated during working or splinters, chips and dust emitted by the device can cause loss of sight.

- **Avoid unintentional startups. Ensure that the switch is in the "OFF" position before you insert the plug into the socket outlet.**

Physically touching the switch with your finger when carrying the tool or connecting the tool to the power supply switched on can lead to accidents.

- **Remove adjusting tools/wrench(es) prior to switching on the power tool.**

A tool or wrench that is positioned inside a rotating power tool part can cause injury.

- **Do not overestimate your abilities. Make sure you stand squarely and keep your balance at all times.**

This way, you will be able to have better control over the tool in unexpected situations.

- **Wear suitable clothes. Never wear loose fitting clothes or jewelry. Keep hair, clothes and gloves away from moving parts.**

Loose clothing, dangling jewelry and long hair can be caught by moving parts.

- **If dust extraction and dust collection devices can be mounted, ensure that these are connected and are properly used.**

Use of such equipment reduces the risk associated with dust accumulation.

4. CAREFUL HANDLING AND USE OF ELECTRIC TOOLS

- **Do not overload your tool. Only use suitable electric tools to perform your work.**

Using the right electric tool allows you to work better and safer within the tool's quoted capacity range.

- **Do not use an electric tool whose switch is defective.**

An electric tool that no longer can be switched on or off is dangerous and must be repaired.

- **Always pull the plug out of the socket outlet before making any adjustments. Exchange accessory parts or put away the tool.**

This precaution eliminates the possibility of inadvertently starting the tool.

- **When not in use, store electric tools out of the reach of children. Do not allow those persons to use this tool who are unfamiliar with it or who have not read these instructions.**

Electric tools are dangerous when they are used by inexperienced persons.

- **Take good care of your tool. Check that moving parts properly function and do not jam, that parts are not broken off or damaged in any way and that the tool can be used to its full capacity. Have damaged parts repaired prior to using the tool.**

The cause of many accidents can be traced back to poorly maintained electric tools.

- **Keep your blades sharp and clean.**

Properly maintained blades with sharp edges jam less frequently and are easier to use.

- **Use electric tools and plug-in tools, etc. in compliance with these instructions and in the manner that is prescribed for the model at hand. In so doing, pay due attention to working conditions and the job to be performed.**

Using electric tools for applications other than those intended can lead to dangerous situations.

- **If the power cable of the electric tool is damaged, it must be replaced by a specially**

prepared connection lead which can be obtained from the customer service center.

5. SERVICE

- **Have your tool repaired only by authorized specialists using original replacement parts.**
This will ensure that your tool remains safe to use.

Additional safety instructions

- The battery pack supplied with your cordless tool is not charged. The battery pack has to be charged before you use the tool for the first time.
- The battery pack does not reach its maximum capacitance until it has been charged and discharged approximately five times.
- Battery packs lose their charge even when they are not being used. Regular charging is therefore recommended.
- Please check the data marked on the rating plate of the battery charger. Be sure to connect the battery charger to a power supply with the voltage marked on the rating plate. Never connect it to a different mains voltage.
- Keep the battery charger and the cordless tool out of children's reach.
- Wear suitable work clothes. Wear safety goggles.
- Never open the battery pack. Avoid contact with a leaking battery pack. In case of accidental contact, wash the affected area of skin with soap and water. If battery acids gets in your eye, rinse out the eye with clear water for at least 10 minutes and seek a doctor's advice immediately. Neutralize other affected areas with a mild acid such as lemon juice or vinegar.
- Protect the battery charger and its cable from damage and sharp edges. Have damaged cables repaired without delay by a qualified electrician.
- Make sure that the contacts of the battery pack do not come into contact with other metallic objects such as nails or screws. There is a risk of short-circuiting!
- Use only battery chargers that are intended for the battery pack in question.
- Do not use damaged battery chargers.
- Leave repairs strictly to the appointed service center or authorized dealers.
- Do not use the supplied battery charger to charge other cordless tools.
- Never allow the battery pack to become fully discharged. This will cause it to develop a defect.

GB

- Timely recharging of the battery pack will help it serve you well for a long time. You must recharge the battery pack when you notice that the power of the cordless tool drops.
- In heavy use the battery pack will become warm. Allow the battery pack to cool to room temperature before commencing with the charging.
- Protect your cordless tool and the battery charger from moisture and rain.
- Do not use the cordless tool or the battery charger near vapors and inflammable liquids.
- Do not throw battery packs into an open fire. There is a risk of explosion!
- Use the battery charger only in dry conditions and an ambient temperature of 10-40°C.
- Do not keep the battery charger in places where the temperature is liable to reach 50°C. In particular, do not leave the battery charger in a car that is parked in the sunshine.
- Do not ignite the battery pack or expose it to fire.

Do not lose these safety instructions.



Rechargeable batteries and cordless electric machines and tools contain materials that are potentially harmful to the environment. Never place any cordless electric machines or tools in your household refuse. Please make sure, that the battery will be correctly disposed of according your national legislation.

1. Layout:

- 1 Setting ring
- 2 Bit chuck
- 3 Changeover switch for forward/reverse / ON/OFF switch
- 4 Charging connection
- 5 Locking screw
- 6 Battery charger
- 7 Locking button
- 8 Charging cable

2. Important information

Be sure to read the following information before you use your cordless screwdriver for the first time:

1. Charge the battery pack with the charger supplied. An empty battery pack requires a charging period of approximately 5-7 hours.
2. Only ever use sharp drill bits and screwdriver bits which are suitable for the purpose and in faultless condition.
3. Always check for concealed electric cables and gas and water pipes when drilling and screwing in walls.

3. Starting up

Charging the NC battery pack

1. Check that your mains voltage is the same as that marked on the rating plate of the battery charger. Plug the battery charger in the socket-outlet and connect the charging cable to the charging connection.
2. An empty battery pack requires a maximum charging period of 7 hours. The temperature of the battery pack may rise slightly during the charging operation. This is normal.

Important! The charger does not switch off automatically when the battery pack is fully charged!

Disconnect the charging cable from the screwdriver after charging.
Do not leave on charger for extended period.

If the battery pack fails to become charged, please check

- whether there is voltage at the socket-outlet
- whether there is proper contact at the charging contacts on the charger.

If the battery still fails to become charged, please return

- the charger
 - the screwdriver
- to our Customer Service Department.

Timely recharging of the Ni-Cd battery pack is recommended in the interest of long battery life. Recharging is always necessary when you notice that the power of the battery-powered drill/screwdriver is decreasing.

Never allow the battery pack to discharge completely. This will result in damage to the Ni-Cd battery pack!

ON/OFF direction switch (1)

The slide switch (7) over the ON/OFF direction switch can be used to secure the NGS 4,8 against being switched on unintentionally. The switch (3) can be used to reverse the direction of rotation. You should wait for the tool to stop before changing the direction of rotation. If not, the gearing may be damaged.

Setting the angle (Fig. 2)

The handle of the screwdriver can be locked into both end positions..

Adjusting the bit chuck (Fig. 3)

- The bit chuck (2) can be moved into different positions
- Slacken both locking screws (5)
- Move the bit chuck (2) to the desired position
- Re-tighten both locking screws (5).

Important! Before you use the screwdriver, make sure that the bit chuck is sufficiently secured in the desired position.

Adjusting the torque (Figure 1)

The Einhell battery-powered screwdriver is equipped with a 6-step mechanical torque adjustment facility. The torque for a specific size of screw is selected with the set-collar (Figure 1). The correct torque depends on several factors:

- on the type and hardness of material in question
- on the type and length screws used
- on the requirements needing to be met by the screwed joint.

The clutch disengages with a grating sound to indicate when the set torque is reached.

Screwdriving

We recommend using self-centering screws (e.g. Torx screws, recessed head screws) designed for reliable working. Be sure to use a bit that matches the screw in shape and size. Set the torque, as described elsewhere in these operating instructions, to suit the size of screw.

Technical data

Voltage supply	4,8 V =
Speed	180 rpm
Forward and reverse rotation	yes
Battery charging voltage	6 V =
Battery charging current	300 mA
Mains voltage for charger	230 V ~ 50 Hz
Sound pressure level LPA:	63,3 dB(A)
Sound power level LWA:	74,3 dB(A)
Weight	0,55 kg
Vibration \bar{a}_w	< 2,5 m/s ²

Ⓢ **WARRANTY CERTIFICATE**

The product described in these instructions comes with a 2 year warranty covering defects. This 2-year warranty period begins with the passing of risk or when the customer receives the product.

For warranty claims to be accepted, the product has to receive the correct maintenance and be put to the proper use as described in the operating instructions.

Your statutory rights of warranty are naturally unaffected during these 2 years.

This warranty applies in Germany, or in the respective country of the manufacturer's main regional sales partner, as a supplement to local regulations. Please note the details for contacting the customer service center responsible for your region or the service address listed below.

Ⓢ Technical changes subject to change
EH 04/2006