

OZITO

TABLE SAW

2000W 250mm

ASSEMBLY INSTRUCTIONS

PARTS

- | | |
|-----------------------------------|--------------------------------------|
| 1. Legs (A) - 4 pc | 7. Dust extractor hose - 1 pc |
| 2. Cross struts, long (B) - 2 pc | 8. Blade guard - 1 pc |
| 3. Cross struts, short (C) - 2 pc | 9. Stabilising brackets - 2 pc |
| 4. Side table extension - 2 pc | 10. Support strut, side table - 4 pc |
| 5. Rear table extension - 1 pc | 11. Support strut, rear table - 2 pc |
| 6. Feet - 4 pc | |

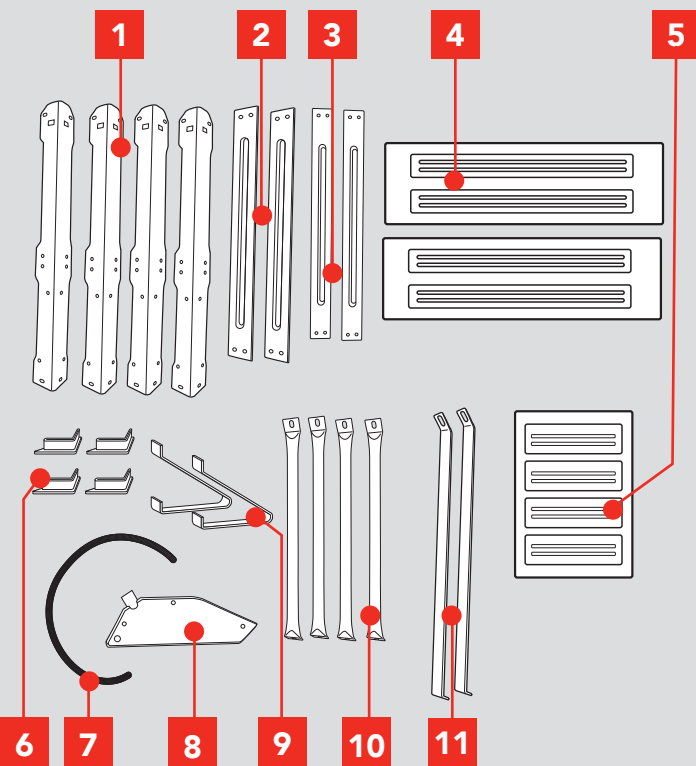

FASTENERS

- | | |
|---------------------------|-----------------------------|
| 12. Bolt - 32 pc | 15. Washer, Spring - 32 pc. |
| 13. Nut - 32 pc. | 16. Spanner 10/13 mm |
| 14. Washer, Flat - 32 pc. | 17. Spanner 10/21 mm |

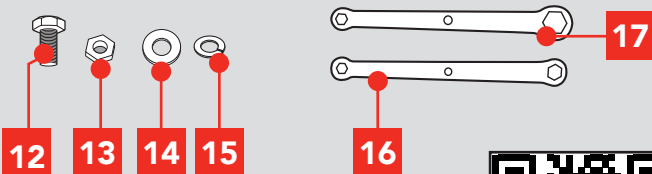

ONLINE MANUAL

Scan this QR Code with your mobile device to take you to the online manual.



ASSEMBLING THE FRAME

WARNING! BEFORE ASSEMBLING YOUR TABLE SAW OR REPLACING BLADES, MAKE SURE THAT THE MOTOR IS OFF AND THE TOOL DISCONNECTED FROM THE POWER SUPPLY TO PREVENT ACCIDENTAL STARTING.

1. Turn the table saw upside down and place it on the floor (Ensure the blade is wound fully down before turning the saw upside down).

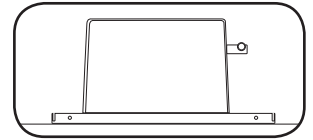

2. Remove the box of parts from behind the motor; it can be easily accessed by tilting the blade using the Blade Bevel Adjustment.

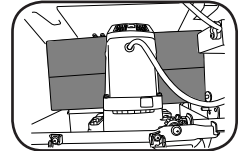

3. Attach the Base Frame Legs (A) to the bottom of the table saw, you will first need to remove the bolt and washers from the table saw.

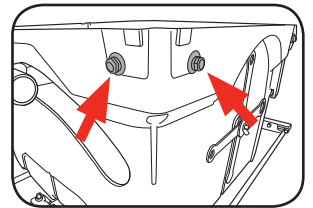
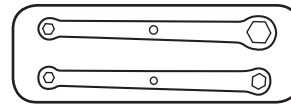

4. Ensure that the rectangular plastic cleats on the table saw sit within the rectangular slots at the top of the Base Frame Legs. These cleats assist in support as well as alignment. Use the bolts and washers removed in step 3 to fasten all four legs to the sides of the machine.

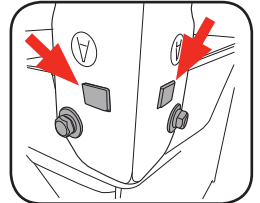

Note: Only hand tighten at this stage, as some movement in the legs will assist in aligning the cross struts.

5. When aligning the Cross Struts to the Base Frame Legs, ensure that the shorter edge is facing the table saw.

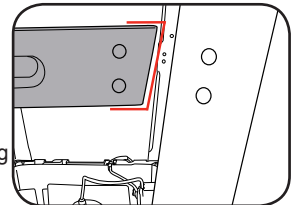

Note: The Short Cross Struts (C) need to be used on the sides of the table saw. Long Cross Struts (B) front & back

6. Loosely fix the 4 Cross Struts to the base frame legs, using the nuts, bolts and washers supplied.

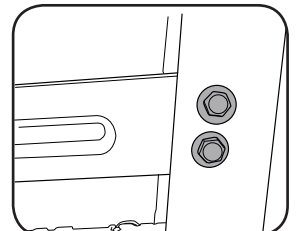
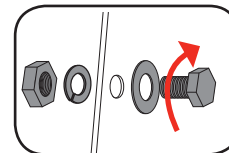

7. The Table Saw is supplied with 2 Stabilising Brackets. 2 bolts, 2 nuts, 2 flat washers and 2 spring washers are required to attach each bracket to the bottom of the rear Base Frame Legs.

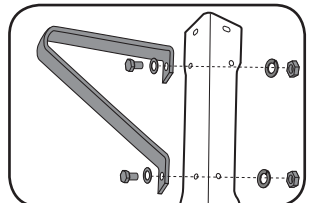

8. Mount the Rubber Feet on the legs.

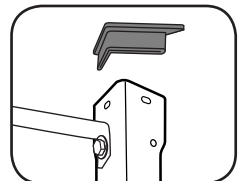

3 YEAR REPLACEMENT WARRANTY

TSF-1211U

ATTACHING TABLE EXTENSIONS

The table saw is supplied with one Rear Table Extension and two Side Table Extensions.

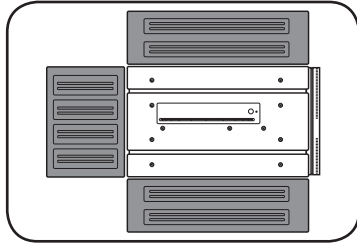

1. Using the nuts, bolts and washers supplied, attach a table extension to the main saw table. Each table extension will require 2 bolts, 2 flat washers, 2 spring washers and 2 nuts

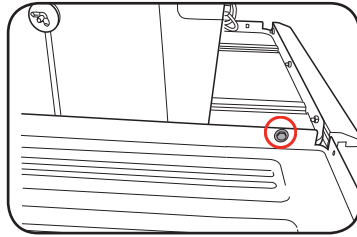

2. There are 2 support struts for each table extension. When attaching the support struts to the table extensions, use the nuts, bolts, flat washers and spring washers. Each support strut will require 1 bolt, 1 nut, 1 flat washer and 1 spring washer

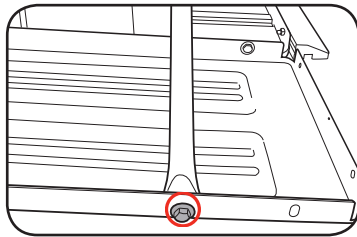

Note: There are 4 short and 2 long support struts. The 2 longer support struts are intended for the Rear Table Extension.

3. When attaching the support struts to the bottom of the table saw, you will first need to remove the bolt and washer that connect the leg to the table saw. Ensure that it is supported by one other bolt before attaching a strut.

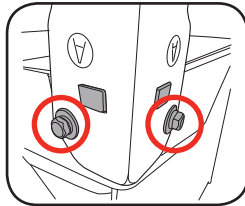

4. Each base frame leg and support strut share the same fixing hole

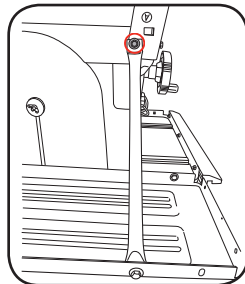

5. Finally, tighten all the nuts on the base frame and table extensions to ensure steadiness. Use the supplied spanner where required, but be careful not to over tighten as this may result in damage to the base frame legs.

FITTING THE BLADE GUARD

1. Mount the blade guard on the riving knife so that the bolt fits through the hole in the riving knife. Attach with locknut and washer.

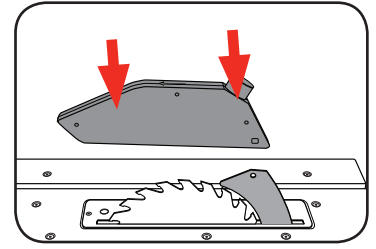

2. Do not tighten the bolt too far – the blade guard must be able to move freely.

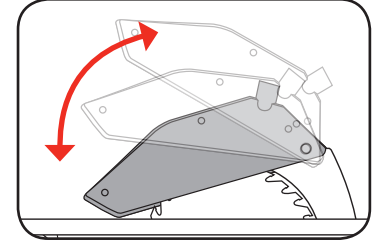

3. Fasten the dust extractor hose to the extractor adapter and to the extractor socket of the blade guard. A suitable extractor system has to be connected to the outlet of the extractor adapter.

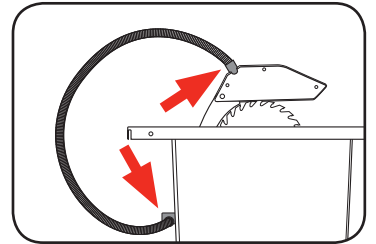

IMPORTANT! THE BLADE GUARD MUST ALWAYS BE LOWERED OVER THE WORK PIECE BEFORE YOU BEGIN TO CUT.

