

MAINTENANCE

WARNING! BEFORE CLEANING YOUR ECOMOW ELECTRIC MOWER OR CARRYING OUT ANY MAINTENANCE PROCEDURE, MAKE SURE THAT THE MOTOR IS OFF AND THE TOOL DISCONNECTED FROM THE POWER SUPPLY TO PREVENT ACCIDENTAL STARTING.

Removing the Blade

CAUTION! DO NOT TOUCH ROTATING BLADES.

CAUTION! ALWAYS HANDLE THE BLADE WITH CARE – SHARP EDGES COULD CAUSE SERIOUS INJURY. USE GLOVES.

Only replace the blade with a genuine Ozito replacement blade, as this will ensure top performance and safety under all conditions.

- To remove the blade bolt, hold the blade firmly and with a 13mm socket (not supplied) loosen the blade bolt by turning it anti-clockwise.

Note: A correctly positioned piece of timber will assist in holding the blade while removing or tightening the blade bolt.

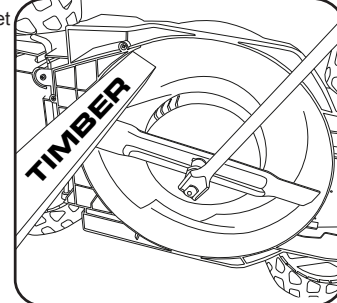

- Remove the blade bolt and blade.
- Inspect for damage and clean as necessary.

Replace the metal blade after 50 hours mowing or 2 years whichever is the sooner – regardless of condition. If the blade is cracked or damaged replace it with a new one. Never use a blade bolt if the insulated head is damaged, cracked or missing.

Fitting the Blade

- Fit the blade to the fan with the tilt edges of the blade facing towards the mower, ensuring the blade is located onto the fan location lugs correctly.

- Re-assemble blade bolt through blade and fan.

- Hold the blade firmly and tighten blade bolt with a (not supplied), by turning in a clockwise direction. The tightening torque should be approx. 25 Nm.

Ozito Industries will not be responsible for any damage or injuries caused by repair of the tool by an unauthorised person or mishandling or mistreatment of the tool. This tool is designed for Domestic Home Use only. Use in commercial or industrial environments will void the warranty.

- Keep all nuts, bolts and screws tight to be sure the lawn mower is in a safe working condition.
- Check the catcher frequently for wear or deterioration.
- Replace worn or damaged parts for safety.
- Only use the replacement blade, blade bolt, and impeller specified for this product.
- Be careful during adjustments of the lawn mower to prevent entrapment of the fingers between moving blade and fixed parts of the machine.
- Oil the wheel pins.
- When not in use, the mower should be stored in a dry, frost-free location, out of reach of children. If the housing of the mower requires cleaning, do not use solvents but a moist soft cloth and brush only.
- Frequently check the wheel threads are firm and tight.

TROUBLESHOOTING

Problem	Cause	Remedy
The motor fails to start	The capacitor is defective	The mower housing is clogged. Have repaired by the Customer Service Centre
	There is no electricity at the plug	Check the cable and the fuse
	The cable is defective	Check the cable
	The combined switch/plug is defective	Have repaired by the Customer Service Centre
	The connectors have become separated from the motor or the capacitor	Have repaired by the Customer Service Centre
	The mower is standing in high grass	Start in low grass or on an area that has already been mowed; change the cutting height if necessary
	Start in low grass or on an area that has already been mowed; change the cutting height if necessary	Clean the housing so that the blade moves freely
The motor performance drops	The grass is too high or too damp	Correct the cutting height
	The mower housing is clogged	Clean the housing
	The blade is severely worn	Replace the blade
Cutting is irregular	The blade is worn	Replace or re-sharpen the blade
	Wrong cutting height	Correct the cutting height

SERVICE INFORMATION

Please note that the following parts of this product are subject to normal or natural wear and that the following parts are therefore also required for use as consumables.

Category	Example
Wear parts*	Carbon brushes, V-belt
Consumables*	Blade
Missing parts	

* Not necessarily included in the scope of delivery!

ADDITIONAL INFORMATION

Danger!

Sound and vibration

Sound and vibration values were measured in accordance with the standards EN ISO 3744:1995, EN ISO 11201:1995 and EN ISO 20643:2005.

L_{pA} sound pressure level:	81.7 dB
K_{pA} uncertainty:	3 dB
L_{wA} sound power level	94.9 dB
K_{wA} uncertainty:	3 dB

Wear ear-muffs.

The impact of noise can cause damage to hearing.

Total vibration values (vector sum of three directions) determined in accordance with EN 60745.

Vibration at the handlebars ah:	4.5 m/s ²
K uncertainty:	1.5 m/s ²

Keep the noise emissions and vibrations to a minimum.

- Only use appliances which are in perfect working order.
- Service and clean the appliance regularly.
- Adapt your working style to suit the appliance.
- Do not overload the appliance.
- Have the appliance serviced whenever necessary.
- Switch the appliance off when it is not in use.
- Wear protective gloves.



For EU countries only

Never place any electric power tools in your household refuse.

To comply with European Directive 2012/19/EC concerning old electric and electronic equipment and its implementation in national laws, old electric power tools have to be separated from other waste and disposed of in an environment-friendly fashion, e.g. by taking to a recycling depot.

Recycling alternative to the return request:

As an alternative to returning the equipment to the manufacturer, the owner of the electrical equipment must make sure that the equipment is properly disposed of if he no longer wants to keep the equipment. The old equipment can be returned to a suitable collection point that will dispose of the equipment in accordance with the national recycling and waste disposal regulations. This does not apply to any accessories or aids without electrical components supplied with the old equipment.

The reprinting or reproduction by any other means, in whole or in part, of documentation and papers accompanying products is permitted only with the express consent of the ISC GmbH.

Subject to technical changes

SPARE PARTS

Spare parts can be ordered from the Special Orders Desk at your local Bunnings Warehouse or Homebase store.

For further information, or any parts visit www.ozito-diy.co.uk or contact Ozito Customer Service: Great Britain: 0151 294 4488 Ireland: 1850 882711 E-mail: info@ozito-diy.co.uk

DECLARATION OF CONFORMITY

ISC GmbH · Eschenstraße 6 · D-94405 Landau/Isar

explains the following conformity according to EU directives and norms for the following product

Electric Lawn Mower ELM-1536U (Ozito)	
<input type="checkbox"/> 2014/29/EU	<input checked="" type="checkbox"/> 2006/42/EC
<input checked="" type="checkbox"/> 2005/32/EC, 2009/125/EC	<input type="checkbox"/> Annex IV
<input type="checkbox"/> 2014/35/EU	Notified Body No.:
<input type="checkbox"/> 2006/28/EC	Reg. No.:
<input checked="" type="checkbox"/> 2014/30/EU	<input checked="" type="checkbox"/> 2000/4/EC, 2005/88/EC
<input type="checkbox"/> 2014/32/EU	<input type="checkbox"/> Annex V
<input type="checkbox"/> 2014/53/EC	<input checked="" type="checkbox"/> Annex VI
<input type="checkbox"/> 2014/68/EU	None; measured L_{pA} = 85.3 dB (A); guaranteed L_{pA} = 96 dB (A)
<input type="checkbox"/> 90/396/EC, 2009/142/EC	P = 1.5 kW, L/D = 36 cm
<input type="checkbox"/> 89/686/EC, 96/58/EC	Notified Body: Intertek Testing & Certification Ltd. (0359)
<input checked="" type="checkbox"/> 2011/65/EU	Emission No.:

Standard references: EN 60335-1; EN 60335-2-77; EN 62233; EN 55014-1; EN 55014-2; EN 61000-3-2; EN 61000-3-3

Landau/Isar, den 11.09.2017

First CE: 17 Art.-No.: 30.001.28 I.No.: 11017 Subject to change without notice

Archiv-File/Record: NÄP017646 Documents register: R. Gehard Wisenweg 22, D-94405 Landau/Isar

DESCRIPTION OF SYMBOLS

		Danger! Read the directions for use before operating the equipment.
		Caution! Keep all other persons away from the danger zone.
		Caution! Sharp blades! Pull out the safety plug before carrying out any repair work or if the power cable is damaged. The blades will continue to rotate after the motor is switched off.
		Caution! Keep the power cable away from the cutters!
		Danger! Read the operating instructions to reduce the risk of injury
		Protection class II
		Guaranteed sound power level: 96 dB

ELECTRICAL SAFETY

WARNING! When using mains-powered tools, basic safety precautions, including the following, should always be followed to reduce risk of fire, electric shock, personal injury and material damage.

Read the whole manual carefully and make sure you know how to switch the tool off in an emergency, before operating the tool.

Save these instructions and other documents supplied with this tool for future reference. Before you connect the equipment to the mains supply make sure that the data on the rating plate are identical to the mains data.

This tool is double insulated therefore no earth wire is required.

If the supply cord is damaged, it must be replaced by an electrician or a power tool repairer in order to avoid a hazard.

Note: Double insulation does not take the place of normal safety precautions when operating this tool. The insulation system is for added protection against injury resulting from a possible electrical insulation failure within the tool.

GENERAL POWER TOOL SAFETY WARNINGS

WARNING! Read all safety warnings, instructions, illustrations and specifications provided with this power tool. Failure to follow the warnings and instructions may result in electric shock, fire and/or serious injury. Save all warnings and instructions for future reference. The term "power tool" in the warnings refers to your mains-operated (corded) power tool or battery-operated (cordless) power tool.

- Work area safety
 - Keep work area clean and well lit. Cluttered or dark areas invite accidents.
 - Do not operate power tools in explosive atmospheres, such as in the presence of flammable liquids, gases or dust. Power tools create sparks which may ignite the dust or fumes.
 - Keep children and bystanders away while operating a power tool. Distractions can cause you to lose control.
- Electrical safety
 - Power tool plugs must match the outlet. Never modify the plug in any way. Do not use any adapter plugs with grounded (grounded) power tools. Unmodified plugs and matching outlets will reduce risk of electric shock.
 - Avoid body contact with earthed or grounded surfaces, such as pipes, radiators, ranges and refrigerators. There is an increased risk of electric shock if your body is earthed or grounded.
 - Do not expose power tools to rain or wet conditions. Water entering a power tool will increase the risk of electric shock.
 - Do not abuse the cord. Never use the cord for carrying, pulling or unplugging the power tool. Keep cord away from heat, oil, sharp edges or moving parts. Damaged or entangled cords increase the risk of electric shock.
 - When operating a power tool outdoors, use an extension cord suitable for outdoor use. Use of a cord suitable for outdoor use reduces the risk of electric shock.
 - If operating a power tool in a damp location is unavoidable, use a residual current device (RCD) protected supply. Use of an RCD reduces the risk of electric shock.
- Personal safety
 - Stay alert, watch what you are doing and use common sense when operating a power tool. Do not use a power tool while you are tired or under the influence of drugs, alcohol or medication. A moment of inattention while operating power tools may result in serious personal injury.
 - Use personal protective equipment. Always wear eye protection. Protective equipment such as dust mask, non-skid safety shoes, hard hat, or hearing protection used for appropriate conditions will reduce personal injuries.
 - Prevent unintentional starting. Ensure the switch is in the off-position before connecting to power source and/or battery pack, picking up or carrying the tool. Carrying power tools with your finger on the switch or energising power tools that have the switch on invites accidents.

ADDITIONAL SAFETY INSTRUCTIONS FOR LAWN MOWERS

General safety regulations for this electrical tool

This equipment is not allowed to be used by children. Children should be supervised so that they do not play with the equipment. Children are not allowed to carry out the cleaning or maintenance. This equipment is not allowed to be used by people with limited physical, sensory or mental capacities or by those with insufficient knowledge or experience unless they are supervised or instructed by a person who is responsible for them.

Safety instructions for hand mower

- Before use, check the mains cable and extension cable for signs of damage and aging.
- If the cable is damaged during operation, disconnect it immediately from the power supply.
- Check the machine for signs of damage before use. Repairs may only be carried out by our service workshop. If unusual vibrations occur during use, switch the machine off immediately and pull the plug. Check the cutters and clean them if necessary. If the machine continues to vibrate, switch it off, disconnect it from the mains supply and send it to our service workshop.
- The machine must not be tipped whilst it is being started. Both hands must be on the handle when you start the machine.
- Worn parts may only be replaced by our service workshop. If necessary contact the service address provided.

WARNINGS

- Do not use the mower if the connection cable is damaged or worn.
- Do not use a damaged cable to connect the machine to the mains supply and do not touch a damaged cable whilst it is connected to the mains. A damaged cable can result in contact with live parts.
- Do not touch the cutters until the machine has been disconnected from the mains and the cutters have reached a complete standstill.
- Keep extension cables away from the cutters. The cutters can damage the cables and result in contact with live parts.
- Break the connection with the mains supply (in other words pull the plug out of the socket):
 - whenever you leave the machine unattended;
 - before releasing a blocked cutter;
 - before inspecting or cleaning and before working on the machine;
 - if a foreign body has been struck;
 - whenever the machine starts to vibrate oddly.
- Carefully read the instructions for how to operate the machine safely.
- We recommend that the machine is only connected to a power supply protected by means of an earth leakage circuit breaker (RCD) with a maximum trip current of 30 mA.

Note

- Read the directions with due care. Familiarize yourself with the operator controls and proper operation of the machine.
- Never allow children or other persons who are not familiar with the operating instructions to use the mower. Contact your local governmental agency for information regarding minimum age requirements for the user.
- Never mow in the direct vicinity of persons:
 - especially children
 - or animals.
- Always keep in mind that the operator or user of the equipment is responsible for accidents involving other persons and/or their property.

Preliminary measures

- Always wear sturdy, non-slip footwear and long trousers when mowing. Never mow barefoot or in sandals. Avoid wearing loosely fitting clothes or clothing with hanging belts or cords.
- Check the ground on which the equipment will be used and remove all objects that could be caught up or violently flung out.
- Before using the scythe, visually inspect it to ensure that the blade, mounting bolts and the entire cutting apparatus are in good working order (i.e. not worn out or damaged). To prevent any imbalance, replace worn out or damaged blades and mounting bolts as a set only (if applicable). Worn or damaged cutting tools must be replaced.

Using an Extension Lead

Please only use power cables that are not damaged. The total length of the power cable should not exceed 40 meters; going beyond this distance will reduce the power output of the electric motor. The power cable must have a cross-section of 3 x 1.5 mm². The insulating sheath of lawn mower power cables is frequently damaged.

Some of the causes for this are:

- Cuts caused by running over the cable
 - Pinching when the power cable is dragging under doors and pulled through windows.
 - Cracking due to old age of the insulation
 - Kinking by improperly fastening or guiding the power cable.
- The power cables must, at the very minimum, be of type H05RN-F and 3-stranded. The cable type must be printed somewhere on the power cable. Only purchase power cables that are marked as such! Plugs and socket couplers for the power cables must be made from rubber and be splashproof. There is a limit to how long power cables can be. Longer power cables require larger conductor cross-sections. Power cables and connecting lines must be regularly checked for damage. Ensure that the lines are de-energized before checking them. Completely unwind the power cable. Also check power cable entry points, plugs and socket couplers for kinks.

ozito

ECOMOW ELECTRIC MOWER

1500W 360mm

ORIGINAL INSTRUCTIONS

SPECIFICATIONS

Voltage	220-240V-50Hz
Motor	1500W
No Load Speed	3400/min
Cutting Width	360mm
Cutting Heights	5 levels, 25-65mm
Catcher Capacity	38 litre
Protection Class	II
Power Cord Length	10m
Weight	10.75kg

ozito-diy.co.uk



3 YEAR REPLACEMENT WARRANTY

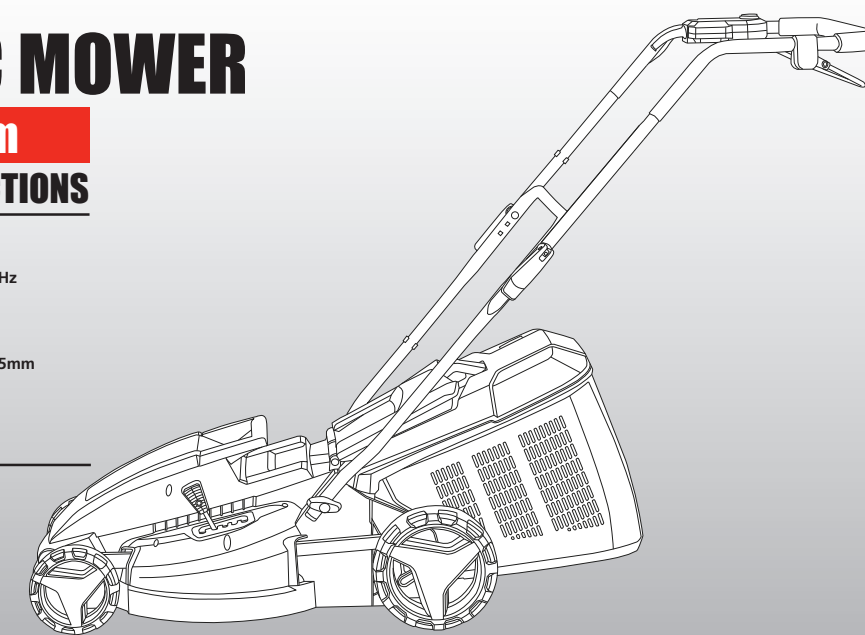

WHAT'S IN THE BOX



Electric Lawn Mower

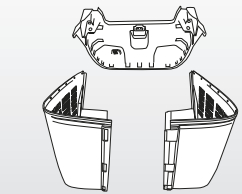

Grass Catcher

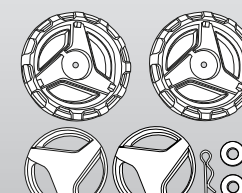

Handle Fasteners & Rear Wheels

ELM-1536U

WARRANTY

All of our products undergo strict quality checks to ensure that they reach you in perfect condition. In the unlikely event that your device develops a fault, please contact our service department at the address shown on this guarantee card. You can also contact us by telephone using the customer service number shown. Please note the following terms under which guarantee claims can be made:

- These warranty terms regulate additional warranty services, which the manufacturer mentioned below promises to buyers of its new products in addition to their statutory guarantee claims are not affected by this guarantee. Our guarantee is free of charge to you.

- The warranty services only covers defects due to material or manufacturing faults on a product which you have bought from the manufacturer mentioned below are limited to either the rectification of said defects on the product or the replacement of the product, whichever we prefer. Please note that our devices are not designed for use in commercial, trade or professional applications. A guarantee contract will not be created if the device has been used by commercial, trade or industrial business or has been exposed to similar stresses during the guarantee period.

- The following are not covered by our guarantee:
 - Damage to the device caused by a failure to follow the assembly instructions or due to incorrect installation, a failure to follow the operating instructions (for example connecting it to an incorrect mains voltage or current type) or a failure to follow the maintenance and safety instructions or by exposing the device to abnormal environmental conditions or by lack of care and maintenance.
 - Damage to the device caused by abuse or incorrect use (for example overloading the device or the use of unapproved tools or accessories), ingress of foreign bodies into the device (such as sand, stones or dust, transport damage), the use of force or damage caused by external forces (for example by dropping it).
 - Damage to the device or parts of the device caused by normal or natural wear or tear or by normal use of the device.

4. Your Product is guaranteed for a period of 36 months from the original date of purchase and is intended for DIY (Do It Yourself) use only. Warranty excludes consumable parts. Guarantee claims should be submitted before the end of the guarantee period within two weeks of the defect being noticed. No guarantee claims will be accepted after the end of the guarantee period. The original guarantee period remains applicable to the device even if repairs are carried out or parts are replaced. In such cases, the work performed or parts fitted will not result in an extension of the guarantee period, and no new guarantee will become active for the work performed or parts fitted. This also applies if an on-site service is used.

IN ORDER TO MAKE A CLAIM UNDER THIS WARRANTY YOU MUST RETURN THE PRODUCT TO THE PLACE OF PURCHASE WITH YOUR REGISTER RECEIPT.

Please refer to the restrictions of this warranty concerning wearing parts, consumables and missing parts as set out in the service information in these operating instructions.

CUSTOMER SERVICE HELPLINE
GB: 0151 294 4488
IRL: 1850 882711
Ozito-diy.co.uk

KNOW YOUR PRODUCT

ECOMOW ELECTRIC MOWER

- | | |
|-------------------|----------------------------|
| 1. Motor cover | 7. Height adjustment lever |
| 2. Lifting handle | 8. Handle securing knob |
| 3. Lower handle | 9. Grass catcher flap |
| 4. Cord retainer | 10. Grass catcher |
| 5. Safety switch | 11. Quick release handle |
| 6. Upper handle | 12. Start/stop lever |

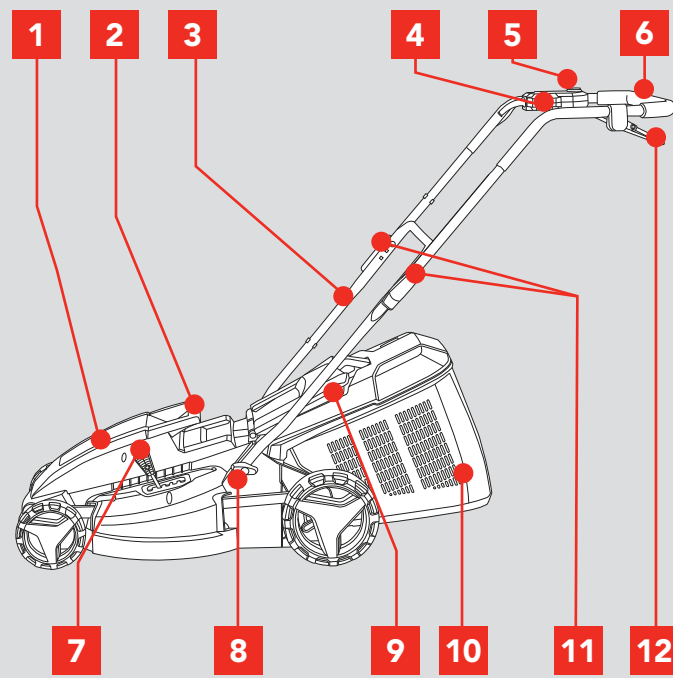

- | | |
|-------------------------------|-------------------------------|
| 13. Rear wheel set | 15. Upper handle securing set |
| 14. Lower handle securing set | |

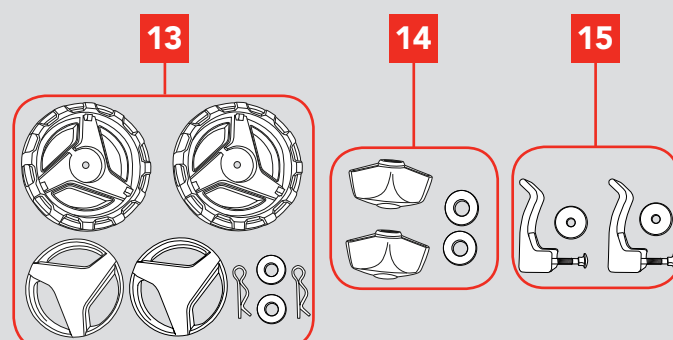

ONLINE MANUAL

Scan this QR Code with your mobile device to take you to the online manual.



SETUP & PREPARATION

2. ASSEMBLY

WARNING! ENSURE THE TOOL IS DISCONNECTED FROM THE POWER SUPPLY BEFORE ASSEMBLY.

Fitting the Rear Wheels

- Place a wheel onto the axle as shown.
- Secure the wheel with a washer and p-clip.

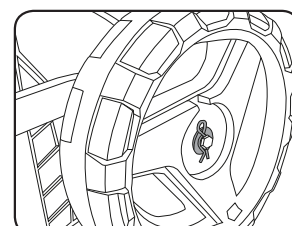
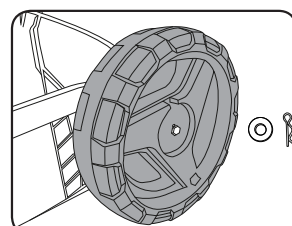

- Push the hub cap onto the centre of the wheel so it clicks into place.

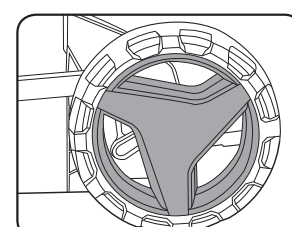

- Repeat this process for the remaining wheel.

Fitting the Lower Handle to Mower Body

- The lower handle with the cable clip attached must be assembled on the power cable side.
- Fit and secure in place with the lower handle washer and securing knob.

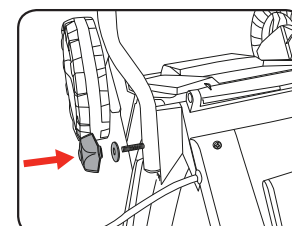
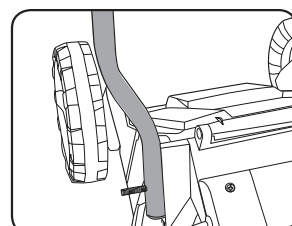

Fitting the Upper Handle to the Lower Handle

- Place the upper handle over the upper ends of the lower handle. From the handle securing set, fit the bolts through the inner side of the lower handle and then through the hole in the upper handle.

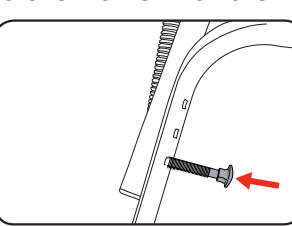

- Place a washer and secure in place by screwing the supplied handle securing lever over the protruding ends of the bolts.

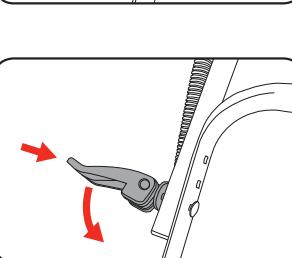

Note: When you fit the upper handle you can decide the height of the upper handle by selecting the appropriate fastening hole.

Securing the Power Cord to the Handles

Ensure the cord follows the handle smoothly from the switch to the body of the mower.

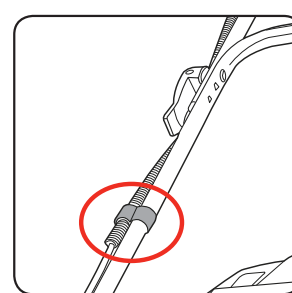

- Secure the power cord from the switch housing to the lower handle as shown.

Assembling the Grass Catcher

- Assemble the grass catcher handle onto the opening on the top half of the grass catcher. The handle will click into position when aligned and fitted correctly.
- To assemble the grass catcher align the two halves and push them together, one side at a time. Ensure the two halves click together around the entire middle section.

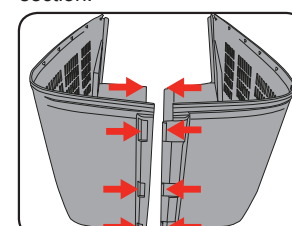
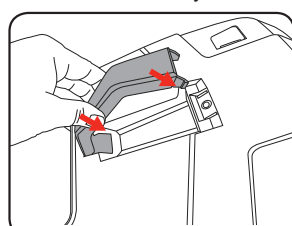

- Assemble the grass catcher top onto the bottom half of the grass catcher assembled in step 2. Align the two halves and push each individual plastic lug into its opposite location.

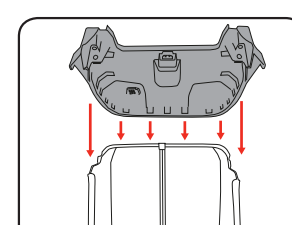

Fitting and Removing Grass Catcher

The catcher must be attached to the two raised hooks on the mower.

- Lift up the catcher flap with one hand and guide the catcher over the two hooks on the mower housing.
- Lower the grass catcher in place and lower the catcher flap. The catcher flap is held against the grass catcher by a spring.
- To empty the grass catcher, lift the catcher flap with one hand then lift the grass catcher with the other hand up off the two raised housing clips.

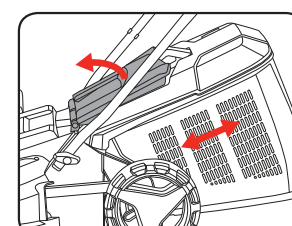

WARNING! WHEN ASSEMBLING THE GRASS CATCHER BACK TO THE MOWER AFTER EMPTYING, ALWAYS ENSURE THERE IS NO BUILD UP OF GRASS IN THE GRASS CHUTE. IF NEEDING TO CLEAR THE GRASS, ALWAYS ENSURE THE MOWER IS DISCONNECTED FROM THE POWER SUPPLY PRIOR TO CLEARING. A BUILD UP OF GRASS IN THE GRASS CHUTE MAY PREVENT GRASS FROM MOVING INTO THE GRASS CATCHER EFFECTIVELY.

3. ADJUSTMENTS

Cutting Height Adjustment

The height adjustment lever provides 5 cutting heights from 25mm to 65mm.

WARNING! DISCONNECT THE MOWER FROM THE POWER SUPPLY AND ENSURE THE BLADE HAS STOPPED COASTING BEFORE ADJUSTING THE HEIGHT.

- Push the lever inwards towards the mower body.
- Adjust the lever to the desired cutting height.
- Release lever check that it is securely seated in the required cutting height.

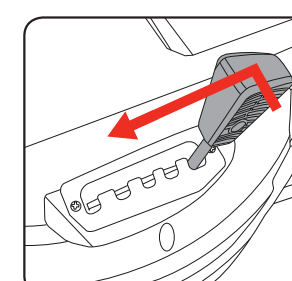

CAUTION: BE CAREFUL DURING CUTTING HEIGHT ADJUSTMENTS OF THE LAWN MOWER TO PREVENT ENTRAPMENT OF THE FINGERS BETWEEN MOVING HEIGHT ADJUSTMENT LEVER AND THE MOWER HOUSING.

Grass Catcher Volume Indicator

To alert you that the grass catcher is full, the mower provides a volume indicator.

Indicator floats up when empty. Indicator is down when full.

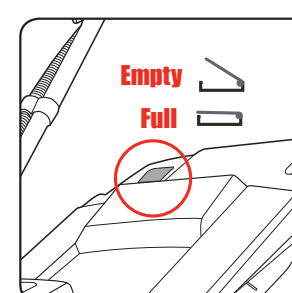

OPERATION

4. SWITCHING ON/OFF

CAUTION! TO REDUCE THE RISK OF ELECTRICAL SHOCK, WE RECOMMEND THE USE OF A RESIDUAL CURRENT DEVICE (RATED 30mA OR LESS).

To prevent accidental start up of the motor the mower is fitted with a dual action switch

- Press and hold the lock-off button.
- Pull the Start/stop lever towards the handle to start the motor and then release the lock-off button.

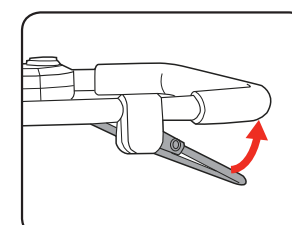
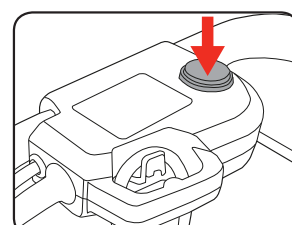

- Release the Start/stop lever to stop the mower.

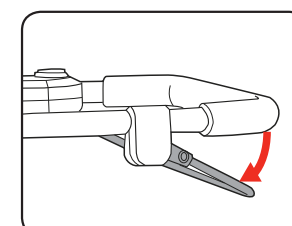

WARNING! THE BLADE WILL STOP A FEW SECONDS AFTER THE SWITCH HAS BEEN RELEASED. BE AWARE OF THE NECESSARY TIME IT TAKES FOR THE BLADE TO STOP. DO NOT ATTEMPT TO STOP THE BLADE.

Overload Protection

The mower has an internal cut off switch which will stop the operation of the motor temporarily if too high in temperature. This cut off switch will suddenly stop the motor from operating should the motor become too hot during the operation of the mower.

First disconnect the mower from the power supply and inspect blade for any obstructions.

A wait of 10 minutes in cooling time, or longer depending on ambient temperature and the operation being performed, before switching On the mower and resuming normal operation.

5. HOW TO MOW

- Always use an approved extension lead suitable for power input of this tool.
- Heavy duty power leads recommended not exceeding 25m.
- While using your lawn mower always wear substantial footwear and long trousers.
- Make sure the lawn is clear of sticks, stones, wire and debris; they could be thrown by the blade.
- Before using the lawn mower and after any impact, check for signs of wear or damage and repair as necessary.
- Replace a worn or damaged blade together with the blade bolt to preserve balance.

WARNING! KEEP POWER CORD AWAY FROM BLADES.

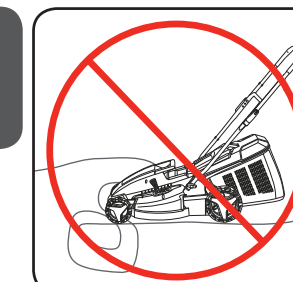

Start mowing the edge of the lawn nearest to the power point so the lead is laid out on the lawn you have already cut.

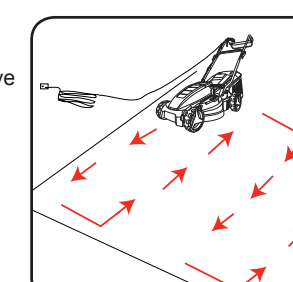

For optimum grass collection, always mow in a straight line; do not swing the lawn mower from side to side.

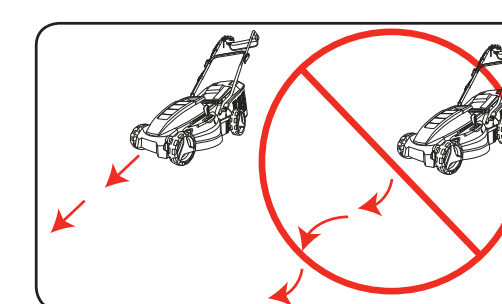

When mowing long grass be sure to not overload the motor. First cut with the highest cutting height and then to the desired height. This will help reduce the load.

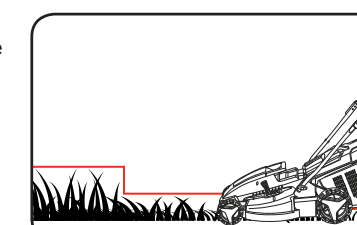

Do Not Overload the Mower

Mowing long thick grass may cause the motor speed to drop; you will hear a change in the motor sound. If the motor speed drops you may overload your lawn mower, which may cause damage. When mowing in long thick grass first cut with the cutting height set in the highest position, this will help reduce the load.

3 YEAR REPLACEMENT WARRANTY

ELM-1536U