

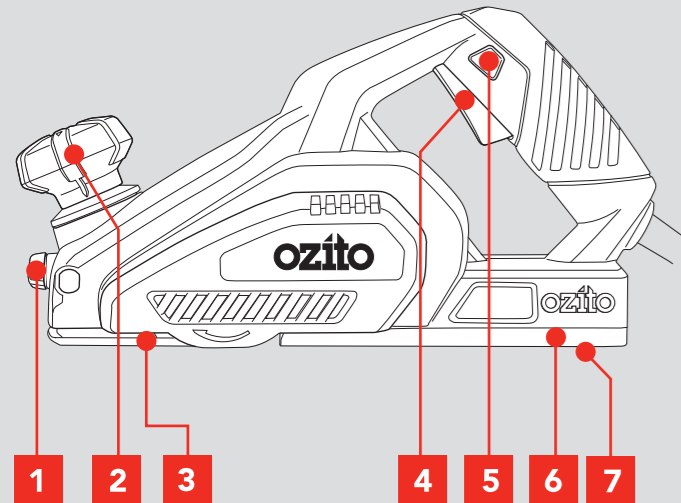

# KNOW YOUR PRODUCT

## PLANER

1. Fence Securing Knob
2. Depth Adjustment Knob
3. Front Shoe
4. On/Off Switch
5. Lock Off Button
6. Rear Shoe
7. Base Park Shoe



## ACCESSORIES

8. Guide Fence
9. Spanner

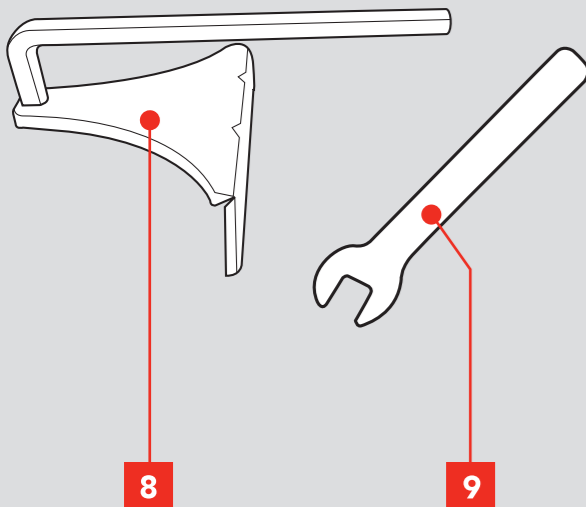

## ONLINE MANUAL

Scan this QR Code with your mobile device to take you to the online manual.



# SETUP & PREPARATION

## 1. ADJUSTING PLANING DEPTH

Before you make any adjustments, make sure the power cord is disconnected from the electricity supply

Planing depth can be adjusted between 0 and 1mm.

1. Increase cutting depth.

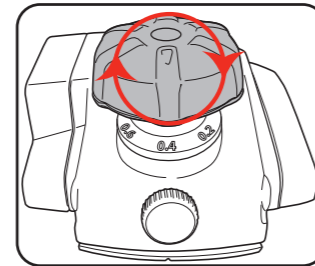

2. Decrease cutting depth.

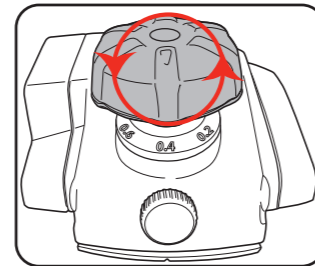

3. The numbers on the depth adjustment correspond to the planing depth (mm). Always test on a scrap workpiece first.

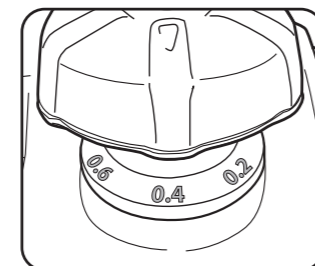

# OPERATION

## 2. ON/OFF SWITCH

The tool is recommended for use with a residual current device with a rated residual current of 30mA or less.

1. Press and hold lock off switch.

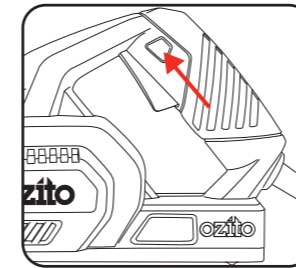

2. Press on/off switch (a), then release lock off button (b).

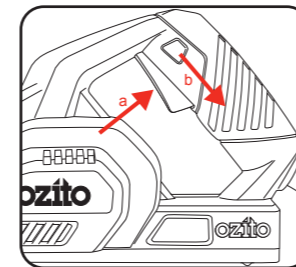

3. Release on/off switch to turn off.

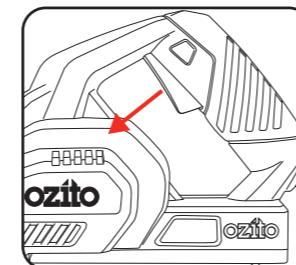

4. Wait until blade stops completely before putting planer down.

## 3. REBATING

### Fitting of the Guide Fence

1. Loosen fence securing knob.
2. Insert guide fence to the required depth.

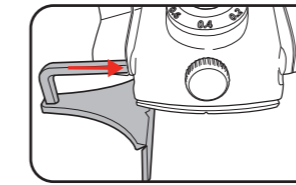
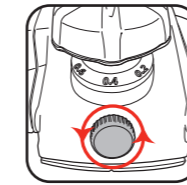

3. Tighten fence securing knob.

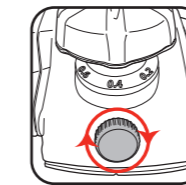

### Making a Rebate Cut

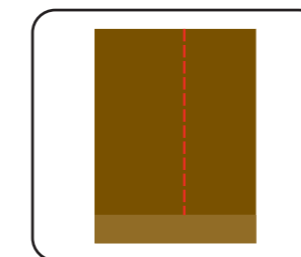
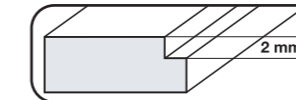

4. Mark out area for rebate.

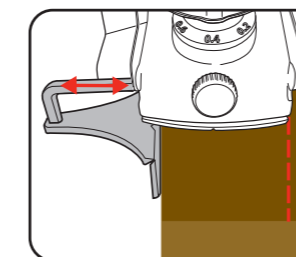

5. Adjust guide fence for required rebate.

3. Plane along workpiece using the fence as a guide.

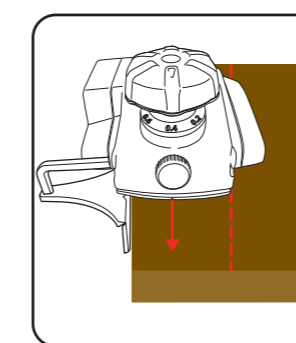

Note: It will be necessary to make a number of cuts to complete most rebates.

## 4. CHAMFERING

The planer has a precision machined groove in the front shoe for planing along the corner of your workpiece.

1. Set required depth on planer.

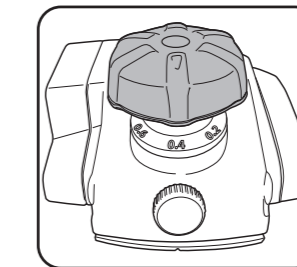

2. Place groove precisely on the corner of the workpiece.

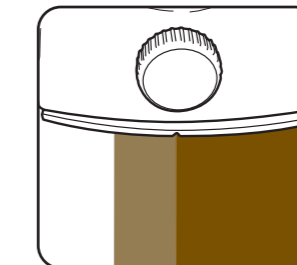

3. Plane along the edge of your workpiece.

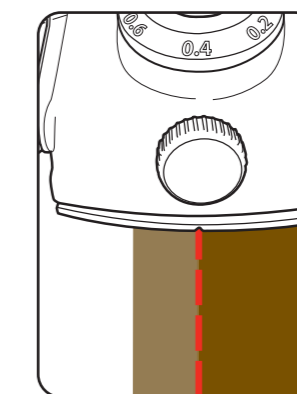

## 5. BLADES

### Changing Blades

Before you make any adjustments, make sure the power cord has been disconnected from the electricity supply.

The blades that come fitted to the tool are 82mm HSS blades. The drum is fitted with two separate blades; both must be reversed or replaced at the same time. Never replace only one blade.

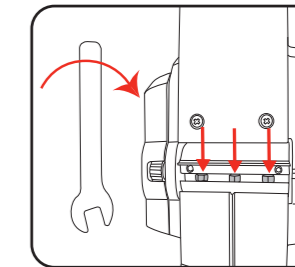

1. Loosen the 3 hex head screws using the spanner provided.

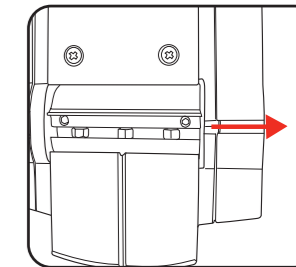

2. Push the used blade out through the slot in the motor housing using a screwdriver. **Keep fingers away from blade.**

3. Install new blades.

**Note:** Blades are reversible. If changing blades for the first time, turn over the blades to expose a fresh cutting edge.

4. Tighten the 3 hex head screws.

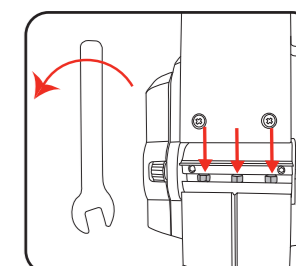

5. Repeat the process for the second blade.