



HEDGE & GRASS SHEAR

INSTRUCTION MANUAL

SPECIFICATIONS

Voltage:	18V
No Load Speed:	1,200/min
Hedge Trimmer:	200mm Blade
Grass Shear:	100mm Blade
Max. Cutting Cap.:	Ø8mm
Tool Weight:	0.82kg

ozito.com.au

5 YEAR
REPLACEMENT WARRANTY

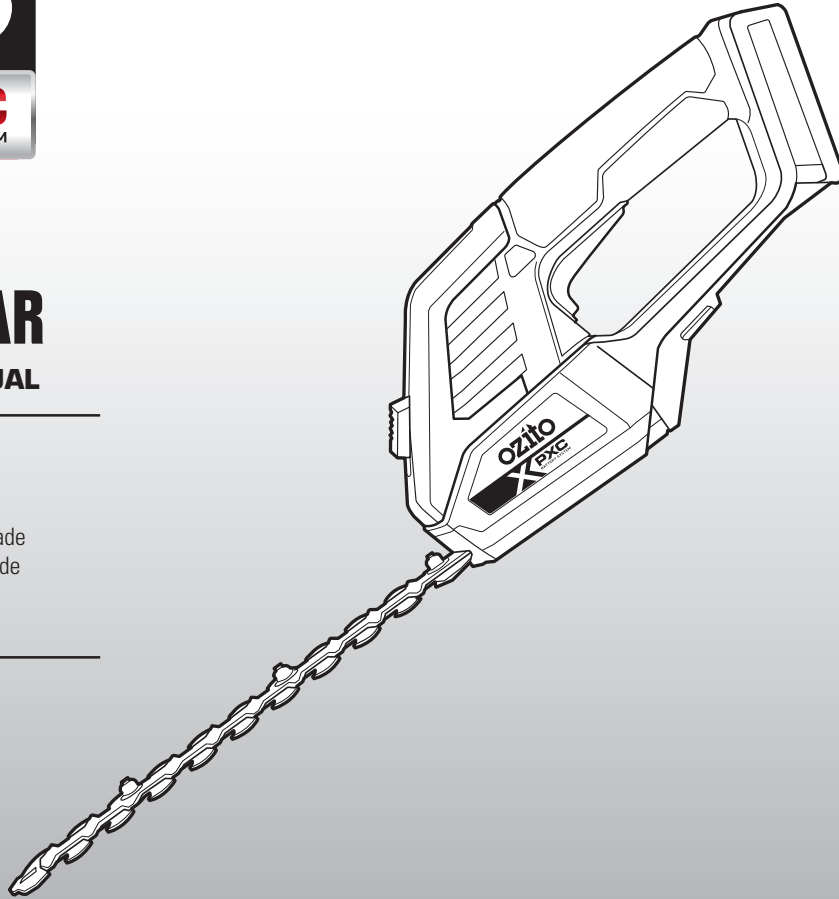

STANDARD EQUIPMENT



Hedge & Grass Shear



Hedge Trimmer Blade

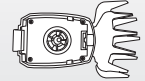

Grass Shear Blade

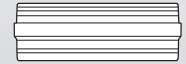

Blade Covers

PXGSHTS-1810

WARRANTY

IN ORDER TO MAKE A CLAIM UNDER THIS WARRANTY YOU MUST RETURN THE PRODUCT TO YOUR NEAREST BUNNINGS WAREHOUSE WITH YOUR BUNNINGS REGISTER RECEIPT. PRIOR TO RETURNING YOUR PRODUCT FOR WARRANTY PLEASE TELEPHONE OUR CUSTOMER SERVICE HELPLINE:

Australia 1800 069 486

New Zealand 0508 069 486

TO ENSURE A SPEEDY RESPONSE PLEASE HAVE THE MODEL NUMBER AND DATE OF PURCHASE AVAILABLE. A CUSTOMER SERVICE REPRESENTATIVE WILL TAKE YOUR CALL AND ANSWER ANY QUESTIONS YOU MAY HAVE RELATING TO THE WARRANTY POLICY OR PROCEDURE.

WARNING

The following actions will result in the warranty being void.

- If the tool has been operated on a supply voltage other than that specified on the tool.
- If the tool shows signs of damage or defects caused by or resulting from abuse, accidents or alterations.
- Failure to perform maintenance as set out within the instruction manual.
- If the tool is disassembled or tampered with in any way.
- Professional, industrial or high frequency use.

The benefits provided under this warranty are in addition to other rights and remedies which are available to you at law.

Our goods come with guarantees that cannot be excluded at law. You are entitled to a replacement or refund for a major failure and for compensation for any other reasonably foreseeable loss or damage. You are also entitled to have the goods repaired or replaced if the goods fail to be of acceptable quality and the failure does not amount to a major failure.

Generally you will be responsible for all costs associated with a claim under this warranty, however, where you have suffered any additional direct loss as a result of a defective product you may be able to claim such expenses by contacting our customer service helpline above.

5 YEAR REPLACEMENT WARRANTY

Your Product is guaranteed for a period of 60 months from the original date of purchase and is intended for DIY (Do It Yourself) use only. If a product is defective it will be replaced in accordance with the terms of this warranty. **Lithium Ion batteries and chargers are covered by a 36 month warranty.** Warranty excludes consumable parts, for example: bearings, blades, blade cover.

KNOW YOUR PRODUCT

HEDGE & GRASS SHEAR

1. Base Release Button
2. Removable Base
3. Safety Switch
4. On/Off Trigger
5. Sure Grip Handle
6. Battery Seating

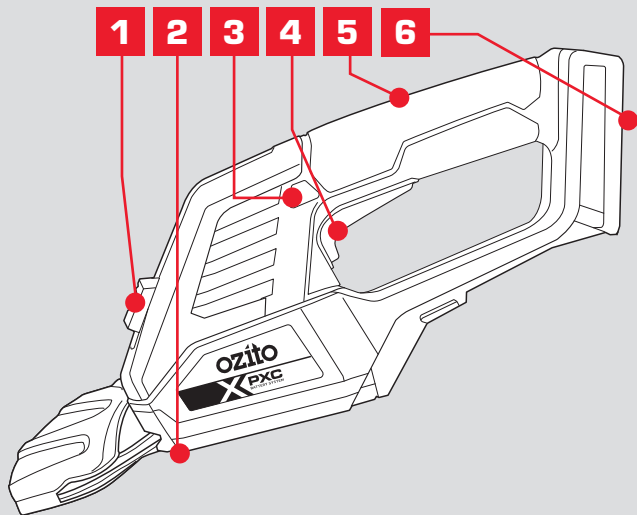

ACCESSORIES

7. Blade Covers
8. Grass Shear Blade
9. Hedge Trimmer Blade

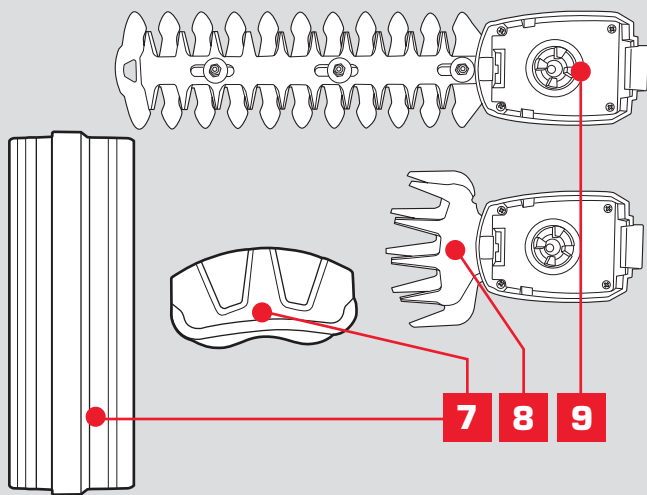

BATTERY & CHARGER

This tool is compatible with all battery and chargers from the Ozito PXC Range.

ONLINE MANUAL

Scan this QR Code with your mobile device to take you to the online manual.



5 YEAR
REPLACEMENT WARRANTY

SETUP & PREPARATION

1. CHANGING BLADES



WARNING! ENSURE THE APPLIANCE IS SWITCHED OFF AND THE BATTERY IS DISCONNECTED BEFORE PERFORMING ANY OF THE FOLLOWING TASKS.



WARNING! WHEN HANDLING THE BLADE ASSEMBLY, WEAR NON-SLIP, HEAVY-DUTY PROTECTIVE GLOVES. DO NOT PLACE YOUR HAND OR FINGERS BETWEEN BLADES OR IN ANY POSITION WHERE THEY COULD GET PINCHED OR CUT. NEVER TOUCH BLADES OR SERVICE THE APPLIANCE WITH THE BATTERY INSTALLED.



WARNING! NEVER OPERATE THE APPLIANCE WHILE THE BLADE COVER IS FITTED.

Remove the Blade Base

1. Slide forward, then press down and hold the base release button.

Note: Ensure the base is supported by hand when the release button is pressed to prevent it falling unexpectedly.

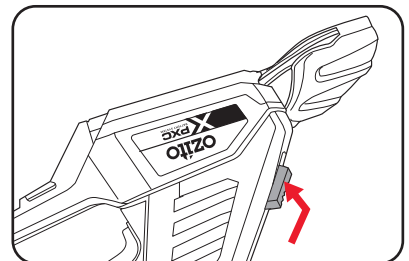

2. Remove the base by lifting from the front and then sliding out.

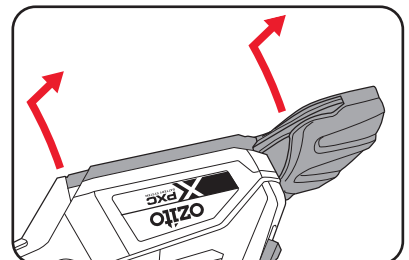

Inserting the Blade Base

When attaching the base to the unit the gears should align with each other in most instances. The gears on the unit are spring loaded, this design feature allows the blade base and unit to lock onto each other without perfect alignment of the gears.

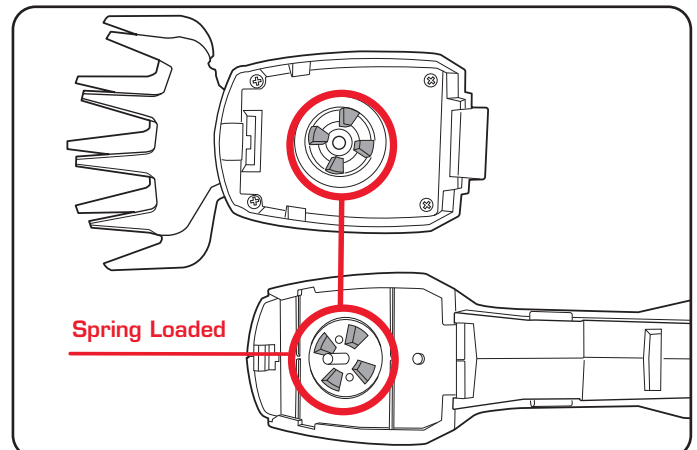

1. Slide the back of the blade base into the recess in the housing.

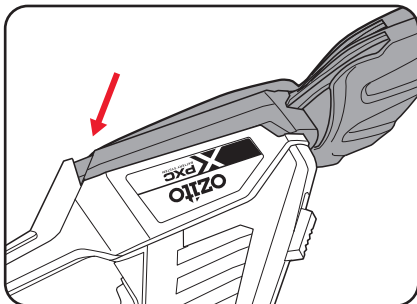

2. Slide forward, then press down and hold the base release button before you push the front of the blade base into the housing.

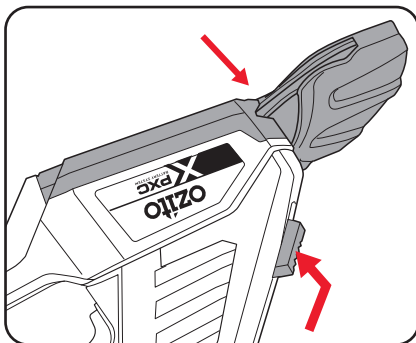

3. Release the button to lock the base in place.



WARNING!: DO NOT USE ANY ATTACHMENTS OR ACCESSORIES NOT RECOMMENDED BY THE MANUFACTURER OF THIS PRODUCT, AS IT CAN RESULT IN SERIOUS PERSONAL INJURY.

2. BATTERY & CONTROLS

Inserting a Removing the Battery

To insert a battery, align the ribs of the battery with the recess at the rear of the handle and slide the battery in so that it clicks into place.

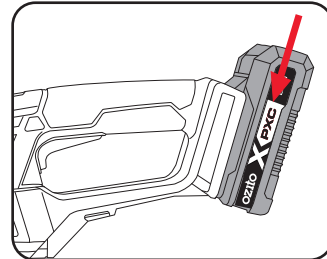

To remove a battery, press and hold the battery release tab as you slide the battery out.

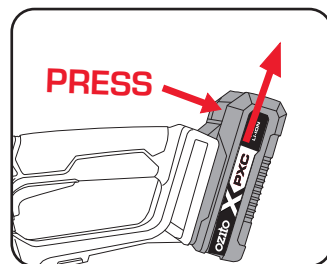

Switching On and Off



WARNING! BEFORE YOU START THE UNIT, MAKE SURE THAT THE BLADE IS NOT MAKING CONTACT WITH ANY OBJECTS.

To start, press and hold the safety switch from one side and then squeeze the on/off trigger.

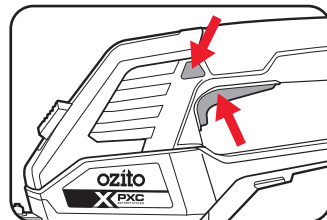

Note: The safety switch can be released after the trigger is pressed.

To stop operation, release the on/off trigger.

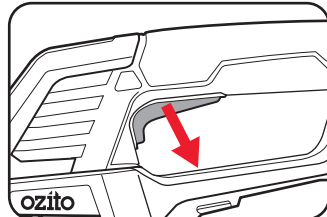

WARNING! THE APPLIANCE MAY RUN FOR A FEW SECONDS AFTER IT HAS BEEN SWITCHED OFF. LET THE MOTOR COME TO A COMPLETE STANDSTILL BEFORE SETTING THE UNIT DOWN.



WARNING! DO NOT OPERATE THE APPLIANCE WITH LONG LOOSE HAIR OR LOOSE FITTING JEWELLERY. TIE LONG LOOSE HAIR BACK AND REMOVE LOOSE FITTING JEWELLERY.



WARNING! WHEN TRANSPORTING THE APPLIANCE ONE LOCATION TO ANOTHER, ALWAYS CARRY USING THE SURE GRIP HANDLE ONLY. NEVER CARRY HOLDING THE BLADE AS IT IS VERY SHARP AND WILL CUT YOU.

OPERATION

3. OPERATION

Using the Grass Shear & Hedge Trimmer



WARNING! ALWAYS WEAR APPROPRIATE PERSONAL PROTECTIVE EQUIPMENT (PPE) WHEN USING THE HEDGE TRIMMER & GRASS SHEAR, SUCH AS STURDY, NON-SLIP FOOTWEAR, LONG TROUSERS, SAFETY GOGGLES AND GLOVES WHEN USING THE EQUIPMENT. NEVER USE EQUIPMENT BAREFOOT OR IN SANDALS.

The hedge trimmer blade is designed for trimming and shaping small shrubs, bushes and hedges. With the grass shear blade equipped lawn edges and small areas of grass around trees and shrubs can be trimmed.

The equipment is intended for private use i.e. for use in home and gardening environments. Public facilities, parks, sporting grounds, along roadways, or agriculture and forestry are excluded. Only use appliances which are in perfect working order.

Note: Do not use the hedge trimmer blade for cutting stems greater than $\varnothing 8\text{mm}$. Use the trimmer only for cutting normal shrubbery found around houses and buildings. Do not overload the appliance.



> $\varnothing 8\text{mm}$

- A hedge trimmer blade can be used to cut shrubs and bushes as well as hedges.
- To obtain the best cutting results, hold the hedge trimmer so that the cutter teeth are at an angle of approximately 15° in relation to the hedge.
- Maintain proper footing and balance. Do not overreach. You should have solid footing and balance at all times, always working away and in front of your body.
- Do not cut hedges or grass when wet. (For best results are achieved when dry).
- The twin-bladed cutters rotate in opposite directions, thus enabling cutting in both directions.
- To ensure that you cut the hedge to a level height, we recommend tying a guide line of string or similar along the hedge. Cut off all branches that protrude beyond the guide line.



WARNING! CLEAR THE AREA TO BE CUT BEFORE EACH USE. REMOVE ALL OBJECTS, SUCH AS CORDS, LIGHTS, WIRE, OR STRING WHICH CAN BECOME ENTANGLED IN THE CUTTING BLADE AND CREATE A RISK OF SERIOUS PERSONAL INJURY.



WARNING! IF THE BLADE JAMS ON ANY ELECTRICAL CORD OR LINE, DO NOT TOUCH THE BLADE! IT CAN BECOME ELECTRICALLY LIVE AND VERY DANGEROUS. CONTINUE TO HOLD THE HEDGE TRIMMER/GRASS SHEAR BY THE INSULATED REAR HANDLE OR LAY IT DOWN AND AWAY FROM YOU IN A SAFE MANNER. DISCONNECT THE ELECTRICAL SERVICE TO THE DAMAGED LINE OR CORD BEFORE ATTEMPTING TO FREE THE BLADE. FAILURE TO HEED THIS WARNING MAY RESULT IN SERIOUS PERSONAL INJURY OR POSSIBLE DEATH.



WARNING! DO NOT OPERATE THE UNIT IN A TREE, ON A LADDER, FROM A ROOFTOP, OR ANY UNSTABLE SUPPORT, THIS IS EXTREMELY DANGEROUS.

Top Cutting

Use a wide sweeping motion. A slight downward tilt of the cutting blades in the direction of motion gives the best cutting results.

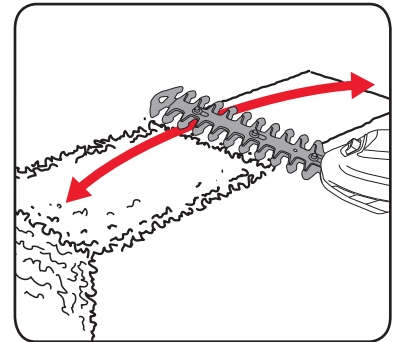

Side Cutting

When trimming the sides of the hedge, begin at the bottom and cut upwards. Trim the side of a hedge so that it will be slightly narrower at the top. This shape will expose more of the hedge, resulting in a more uniform growth.

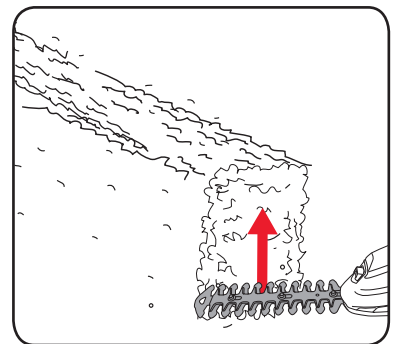

Using the Grass Shear

Move the grass shear parallel to the ground. Direct the shears forward smoothly, allowing the grass shears to glide over the ground. Do not sweep the shear from side to side as this will not allow the blade to cut properly.



Note: Place the blade cover back over the blade and remove the battery when the equipment is not being used.

Run Time

The operating time of the PXC battery (the area that can be covered with a single battery charge) is largely dependent on the blade fitted, the state of the shrubbery (e.g. Density, moisture, thickness, etc.) and the rate of work.

Frequently turning the equipment on and off while in use will also reduce the amount runtime and area that you can cover. If the operating time of the PXC battery (runtime and area coverage) is still unsatisfactory in spite of the above measures, you can remedy the problem by using PXC battery with a larger capacity (Ah).

MAINTENANCE



WARNING! ALWAYS ENSURE THE HEDGE & GRASS SHEAR HAS COMPLETELY STOPPED AND THE BATTERY IS REMOVED PRIOR TO ANY MAINTENANCE.

Sharpening the Hedge Cutting Blade

1. Start and stop your trimmer until the cutter blade and the guard are slightly offset.
2. Remove the battery pack from your trimmer/shear.
3. Remove the blade from the Hedge Trimmer/Grass Shear.
4. Clamp the blade assembly in a vise and file the exposed cutting surface of each blade tooth. Remove as little material as possible.
5. Remove the blade from the vise and insert the battery pack. Repeat steps 1-3 for the unsharpened edges of the blade teeth.

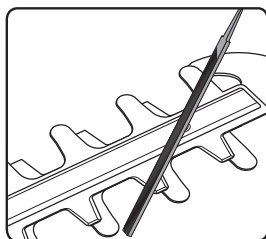
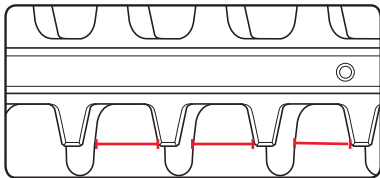

Note: Do not operate your trimmer/shear with dull or damaged cutting blades. This may cause overload and will give unsatisfactory cutting results.

Lubricating the Blades

The blades rail should be cleaned and treated with light machine oil or spray lubricant (such as WD40, CRC 5.56 or RP7) after each use. When a job lasts for a longer period of time it is recommended that the blade rail also be treated with spray lubricant at regular intervals during operation.

1. Remove the battery pack from the appliance.
2. Lay the blade on a flat surface. Apply a light weight machine oil along the edge of the top blade.

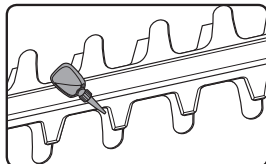

WARNING! DO NOT OIL WHILE THE APPLIANCE IS RUNNING.

Cleaning

- We recommend that you clean the unit immediately each time you have finished using it.
- Use a soft brush to remove debris from all air intakes and the cutting blade.
- To remove sap and other sticky residue, spray the blades with a resin solvent. Run the motor briefly so that the solvent is evenly distributed then wipe the surface with a dry cloth.
- Keep air intake clean and air vents free of debris to avoid overheating the motor.
- Never use water for cleaning your hedge trimmer/grass trimmer. Avoid using solvents when cleaning plastic parts. Most plastics are susceptible to damage from various types of commercial solvents. Use clean cloths to remove dirt, dust, oil, grease, etc.
- Keep away from corrosive agents such as garden chemicals.

Storage

- Store the equipment and its accessories in a dark and dry place at above freezing temperature, out of children's reach. The ideal storage temperature is between 5°C and 30°C.
- Always place the blade cover on the blade before storing the hedge & grass shear. Use caution to avoid the sharp teeth of the blade.
- When in storage remove the battery from the appliance.



WARNING! STORE THE APPLIANCE IN A SAFE AND DRY PLACE OUT OF THE REACH OF CHILDREN.

Transport

- Always place the blade cover on the blade before transporting the hedge trimmer/grass shear. Use caution to avoid the sharp teeth of the blade.
- Remove the battery before transporting it.
- Protect the machine from damage and strong vibrations that can occur particularly when transporting in vehicles.

Note: Ozito will not be responsible for any damage or injuries caused by the repair of the equipment by an unauthorised person or by mishandling of the machine. This machine is designed for DIY use - use in commercial or industrial environments will void the warranty.

Spare parts can be ordered from the Special Orders Desk at your local Bunnings Warehouse.

For further information, visit www.ozito.com.au or contact Ozito Customer Service:

Australia 1800 069 486

New Zealand 0508 069 486

E-mail: hello@ozito.com.au

DESCRIPTION OF SYMBOLS

V	Volts	Hz	Hertz
a.c./~	Alternating current	W	Watts
d.c./---	Direct current	IPX1	Ingress protection from water
Ah	Amp hour	\varnothing	Diameter
mA	Milliamperes	n	No load speed
/min	Revolutions or reciprocation per minute		Warning
mm	Millimetre		Wear safety eye protection
	Regulatory compliance mark (RCM)		DANGER! Moving blade. Keep body parts away from the blade
	Wear protective gloves		Do not use in the rain or leave the machine outdoors while raining
	Read instruction manual to reduce the risk of injury		
	Sound pressure level 87dB		

CARING FOR THE ENVIRONMENT



Power tools that are no longer usable should not be disposed of with household waste but in an environmentally friendly way. Please recycle where facilities exist. Check with your local council authority for recycling advice.



Recycling packaging reduces the need for landfill and raw materials. Reuse of recycled material decreases pollution in the environment. Please recycle packaging where facilities exist. Check with your local council authority for recycling advice.



ELECTRICAL SAFETY



WARNING! When using electric machines, basic safety precautions, including the following, should always be followed to reduce risk of fire, electric shock, personal injury and material damage.

-Read the whole manual carefully and make sure you know how to switch the machine off in an emergency, before operating the machine. Save these instructions and other documents supplied with this machine for future reference.

-This appliance is not intended for use by persons (including children) with reduced physical, sensory or mental capabilities, or lack of experience and knowledge, unless they have been given supervision or instruction concerning use of the appliance by a person responsible for their safety.

Children should be supervised to ensure that they do not play with the appliance.

-This appliance is compatible and only to be used with all batteries & chargers from the Ozito PXC range. Refer to the PXC battery and charger manuals for information regarding charging, use and storage.

-Remove the batteries from the appliance before being charged.

-Do not combine different types of batteries or new and used batteries.

-If the appliance is to be stored unused for a long period, the batteries should be removed.

-Do not use modified or damaged batteries.



GENERAL MACHINE SAFETY WARNINGS



WARNING! Read all safety warnings, instructions, illustrations and specifications provided with this machine. Failure to follow all instructions listed below may result in electric shock, fire and/or serious injury.

Save all warnings and instructions for future reference.

The term "machine" in the warnings refers to your mains-operated (corded) machine or battery-operated (cordless) machine.

1) Work area safety

- a) **Keep work area clean and well lit.** Cluttered or dark areas invite accidents.
- b) **Do not operate machines in explosive atmospheres, such as in the presence of flammable liquids, gases or dust.** Machines create sparks which may ignite the dust or fumes.
- c) **Keep children and bystanders away while operating a machine.** Distractions can cause you to lose control.

2) Electrical safety

- a) **Machine plugs must match the outlet. Never modify the plug in any way. Do not use any adapter plugs with earthed (grounded) machines.** Unmodified plugs and matching outlets will reduce risk of electric shock.
- b) **Avoid body contact with earthed or grounded surfaces, such as pipes, radiators, ranges and refrigerators.** There is an increased risk of electric shock if your body is earthed or grounded.
- c) **Do not expose machines to rain or wet conditions.** Water entering a machine will increase the risk of electric shock.
- d) **Do not abuse the cord. Never use the cord for carrying, pulling or unplugging the machine. Keep cord away from heat, oil, sharp edges or moving parts.** Damaged or entangled cords increase the risk of electric shock.
- e) **When operating a machine outdoors, use an extension cord suitable for outdoor use.** Use of a cord suitable for outdoor use reduces the risk of electric shock.
- f) **If operating a power tool in a damp location is unavoidable, use a residual current device (RCD) protected supply.** Use of an RCD reduces the risk of electric shock.

3) Personal safety

- a) **Stay alert, watch what you are doing and use common sense when operating a machine. Do not use a machine while you are tired or under the influence of drugs, alcohol or medication.** A moment of inattention while operating machines may result in serious personal injury.
- b) **Use personal protective equipment. Always wear eye protection.** Protective equipment such as a dust mask, non-skid safety shoes, hard hat or hearing protection used for appropriate conditions will reduce personal injuries.
- c) **Prevent unintentional starting. Ensure the switch is in the off-position before connecting to power source and/or battery pack, picking up or carrying the machine.** Carrying machines with your finger on the switch or energising machines that have the switch on invites accidents.
- d) **Remove any adjusting key or wrench before turning the machine on.** A wrench or a key left attached to a rotating part of the machine may result in personal injury.
- e) **Do not overreach. Keep proper footing and balance at all times.** This enables better control of the machine in unexpected situations.
- f) **Dress properly. Do not wear loose clothing or jewellery. Keep your hair and clothing away from moving parts.** Loose clothes, jewellery or long hair can be caught in moving parts.
- g) **If devices are provided for the connection of dust extraction and collection facilities, ensure these are connected and properly used.** Use of dust collection can reduce dust-related hazards.
- h) **Do not let familiarity gained from frequent use of machines allow you to become complacent and ignore machine safety principles.** A careless action can cause severe injury within a fraction of a second.

4) Machine use and care

- a) **Do not force the machine. Use the correct machine for your application.** The correct machine will do the job better and safer at the rate for which it was designed.
- b) **Do not use the machine if the switch does not turn it on and off.** Any machine that cannot be controlled with the switch is dangerous and must be repaired.
- c) **Disconnect the plug from the power source and/or remove the battery pack, if detachable, from the machine before making any adjustments, changing accessories, or storing machines.** Such preventive safety measures reduce the risk of starting the machine accidentally.
- d) **Store idle machines out of the reach of children and do not allow persons unfamiliar with the machine or these instructions to operate the machine.** Machines are dangerous in the hands of untrained users.
- e) **Maintain machines and accessories. Check for misalignment or binding of moving parts, breakage of parts and any other condition that may affect the machine's operation. If damaged, have the machine repaired before use.** Many accidents are caused by poorly maintained machines.
- f) **Keep cutting machines sharp and clean.** Properly maintained cutting machines with sharp cutting edges are less likely to bind and are easier to control.
- g) **Use the machine, accessories and machine bits etc. in accordance with these instructions, taking into account the working conditions and the work to be performed.** Use of the machine for operations different from those intended could result in a hazardous situation.
- h) **Keep handles and grasping surfaces dry, clean and free from oil and grease.** Slippery handles and grasping surfaces do not allow for safe handling and control of the machine in unexpected situations.

5) Battery machine use and care

- a) **Recharge only with the charger specified by the manufacturer.** A charger that is suitable for one type of battery pack may create a risk of fire when used with another battery pack.
- b) **Use machines only with specifically designated battery packs.** Use of any other battery packs may create a risk of injury and fire.
- c) **When battery pack is not in use, keep it away from other metal objects, like paper clips, coins, keys, nails, screws or other small metal objects, that can make a connection from one terminal to another.** Shorting the battery terminals together may cause burns or a fire.
- d) **Under abusive conditions, liquid may be ejected from the battery; avoid contact. If contact accidentally occurs, flush with water. If liquid contacts eyes, additionally seek medical help.** Liquid ejected from the battery may cause irritation or burns.
- e) **Do not use a battery pack or machine that is damaged or modified.** Damaged or modified batteries may exhibit unpredictable behaviour resulting in fire, explosion or risk of injury.
- f) **Do not expose a battery pack or machine to fire or excessive temperature.** Exposure to fire or temperature above 130 °C may cause explosion.
- g) **Follow all charging instructions and do not charge the battery pack or machine outside the temperature range specified in the instructions.** Charging improperly or at temperatures outside the specified range may damage the battery and increase the risk of fire.

6) Service

- a) **Have your machine serviced by a qualified repair person using only identical replacement parts.** This will ensure that the safety of the machine is maintained.
- b) **Never service damaged battery packs.** Service of battery packs should only be performed by the manufacturer or authorized service providers.



HEDGE & GRASS SHEAR SAFETY WARNINGS



WARNING! This appliance is not intended for use by persons (including children) with reduced physical, sensory or mental capabilities, or lack of experience and knowledge, unless they have been given supervision or instruction concerning use of the appliance by a person responsible for their safety.

Young children should be supervised to ensure that they do not play with the appliance.

- **Keep all parts of the body away from the blade. Do not remove cut material or hold material to be cut when blades are moving.** Blades continue to move after the switch is turned off. A moment of inattention while operating the hedge trimmer may result in serious personal injury.
- **Carry the appliance by the handle with the blade stopped and taking care not to operate any power switch.** Proper carrying of the hedge trimmer will decrease the risk of inadvertent starting and resultant personal injury from the blades.
- **When transporting or storing the appliance, always fit the blade cover.** Proper handling of the hedge trimmer will decrease the risk of personal injury from the blades.
- **When clearing jammed material or servicing the unit, make sure all power switches are off and the battery pack is removed or disconnected.** Unexpected actuation of the hedge trimmer while clearing jammed material or servicing may result in serious personal injury.
- **Hold the appliance by insulated gripping surfaces only, because the blade may contact hidden wiring.** Blades contacting a "live" wire may make exposed metal parts of the appliance "live" and could give the operator an electric shock.
- **Keep all power cords and cables away from cutting area.** Power cords or cables may be hidden in hedges or bushes and can be accidentally cut by the blade.
- **Do not use the appliance in bad weather conditions, especially when there is a risk of lightning.** This decreases the risk of being struck by lightning.
- Never allow children or people unfamiliar with these instructions to use the appliance.
- Avoid using the appliance, while people, especially children or pets, are nearby.
- Use the appliance only in daylight or good artificial light.
- Never operate the appliance with damaged guards or without guards in place.
- Switch on the appliance only when the hands and feet are away from the cutting blades.
- Use only the manufacturer's recommended replacement parts and accessories.
- Always remove the battery from the appliance when leaving unattended.
- Always remove the battery from the appliance before carrying out maintenance or cleaning work.
- Inspect and maintain the appliance regularly. Have the appliance repaired only by an authorized repairer.
- When not in use, store the appliance out of the reach of children.
- Face the cutting blades away from yourself, other people and animals while the power is connected to the appliance (especially during operation).
- Keep ventilation openings clear of debris. Keep handles dry, clean and free of oil and grease.
- Never reach underneath the appliance (the cutting blade area) until it has completely stopped and the power has been disconnected.
- Do not get distracted and always concentrate on what you are doing. Use common sense. Never operate the machine when you are tired, sick or under the influence of alcohol or other drugs.
- Do not operate this appliance with long loose hair or loose fitting jewellery. Tie long loose hair back and remove loose fitting jewellery.
- Avoid using power tools and machines for long periods of time without breaks. Vibration from tools and machines can be transmitted into your hands and arms.



WARNING! When servicing, use only identical replacement parts. Use of any other parts may create a hazard or cause product damage. To ensure safety and reliability, all repairs should be performed by a qualified service technician.



Danger! Always remove the battery from the hedge & grass shear:

- when the equipment is left unattended,
- when the equipment is being checked, cleaned, or having maintenance work done,
- after striking a foreign object. Inspect the appliance for damage and make repairs as necessary.
- before clearing a blockage,
- or if the equipment vibrates abnormally.