

TRANSFER PUMP INSTALLATION KIT

Ø25mm

SET-UP GUIDE

CONTENTS

- | | |
|-------------------------------|--------------------------------|
| 1. Connector | 4. Filter Check Valve (fitted) |
| 2. Ø25mm x 3m Suction Hose | 5. Ø25mm Male Adaptor (fitted) |
| 3. Stainless Steel Hose Clamp | 6. Ø25mm Universal Connector |

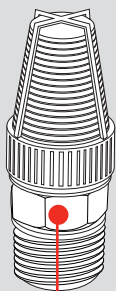
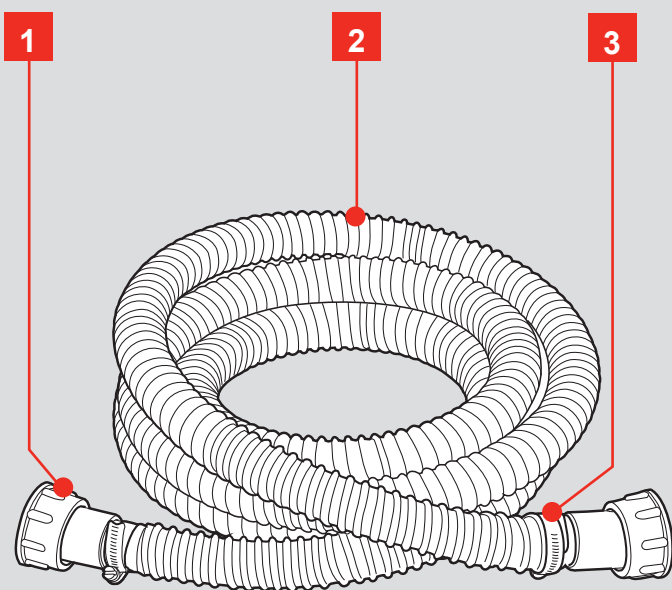

4

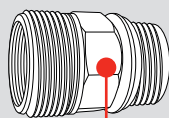

5

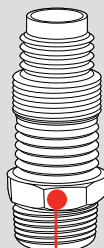

6

ONLINE MANUAL

Scan this QR Code with your mobile device to take you to the online manual.

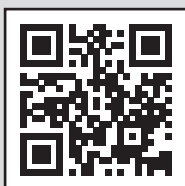

SETUP

Ensure your pump is disconnected from the power supply before performing any of the following operations.

1. Secure the Ø25mm Male Adaptor to the pump suction inlet.

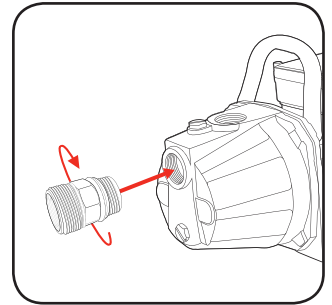

2. Securely attach the Suction Hose to the Male Adaptor.

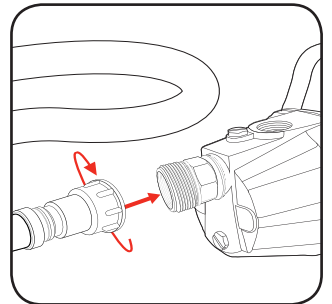

3. The Filter Check Valve prevents long priming periods and unnecessary damage to the pump as a result of stones and solid foreign materials entering. Ensure it is securely attached to the Suction Hose

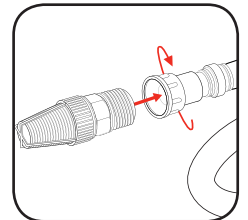

4. The Universal Connector is designed to fit various sizes of hose and fittings.

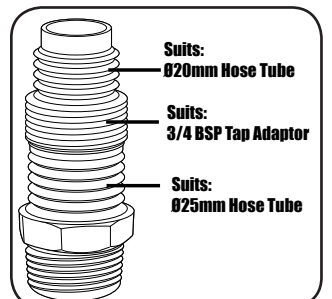
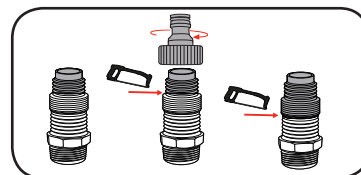

5. Screw the prepared Universal Connector into the pump outlet.

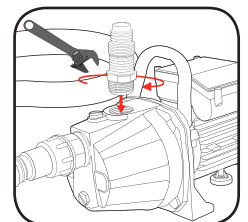

6. Securely attach your output hose/tubing/tap adaptor (not included) to the Universal Connector, fit hose clamps (not included) if you are using flexible hose or tube (not included), and tighten well

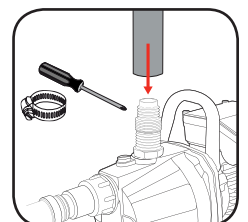

7. Refer to the instruction manual supplied with your transfer pump for full details on warnings, safety, operation, priming, installation and proper use of your pump.