

OPERATION (cont.)

3. DIAGNOSIS (cont.)

Display 4

1. Engine: OFF
Battery voltage: 12-12.3V

LOW LED - Red
OK LED - Green

Low battery power.

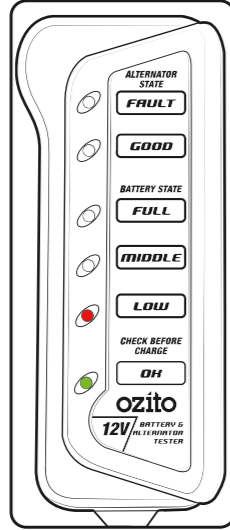

Display 5

1. Engine: OFF
Battery voltage: 12.3-12.5V

MIDDLE LED - Yellow
OK LED - Green

Middle battery power.

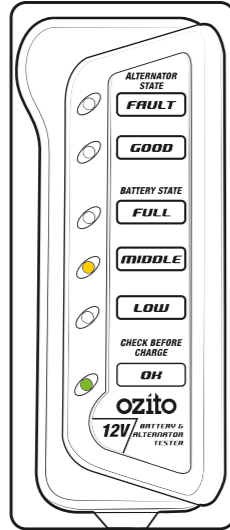

Display 6

1. Engine: OFF
Battery voltage: 12.6V-13.5V

FULL LED - Green
OK LED - Green

Full battery power.

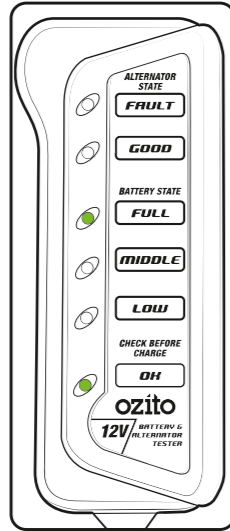

MAINTENANCE

- If the enclosure of the battery tester requires cleaning, do not use solvents. Use a moist, soft cloth only. Never immerse any part of the Battery tester into liquid.
- Keep terminal clamps clean and dry at all times.

DESCRIPTION OF SYMBOLS

V	Volts	A	Amperes
	Regulatory Compliance Mark (RCM)		Warning
	Read Instruction Manual		

CARING FOR THE ENVIRONMENT



Power tools that are no longer usable should not be disposed of with household waste but in an environmentally friendly way. Please recycle where facilities exist. Check with your local council authority for recycling advice.



Recycling packaging reduces the need for landfill and raw materials. Reuse of recycled material decreases pollution in the environment. Please recycle packaging where facilities exist. Check with your local council authority for recycling advice.

SPARE PARTS

Spare parts can be ordered from the Special Orders Desk at your local Bunnings Warehouse.

For further information, visit www.ozito.com.au or contact Ozito

Customer Service:

Australia 1800 069 486

New Zealand 0508 069 486

E-mail: enquiries@ozito.com.au

GENERAL POWER TOOL SAFETY WARNINGS

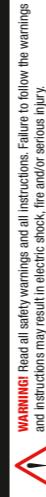

WARNING: Read all safety warnings and all instructions. Failure to follow the warnings and instructions may result in electric shock, fire and/or serious injury.

1. Work area safety
 - a. Keep work area clean and well lit. Cluttered or dark areas invite accidents.
 - b. Do not operate power tools in explosive atmospheres, such as in the presence of flammable liquids, gases or dust. Power tools create sparks which may ignite the dust or fumes.
 - c. Keep children and bystanders away while operating a power tool. Distractions can cause you to lose control.
2. Electrical safety
 - a. Power tool plugs must match the outlet. Never modify the plug in any way. Do not use any adapter plugs with grounded power tools. Unmodified plugs and matching outlets will reduce risk of electric shock.
 - b. Avoid body contact with earthed or grounded surfaces, such as pipes, radiators, ranges and refrigerators. There is an increased risk of electric shock if your body is earthed or grounded.
 - c. Do not expose power tools to rain or wet conditions. Water entering a power tool will increase the risk of electric shock.
 - d. Do not abuse the cord. Never use the cord for carrying, pulling or unplugging the power tool. Keep cord away from heat, oil, sharp edges or moving parts. Damaged or entangled cords increase the risk of electric shock.
3. Personal safety
 - a. Stay alert, watch what you are doing and use common sense when operating a power tool. Do not use a power tool while you are tired or under the influence of drugs, alcohol or medication. A moment of inattention while operating power tools may result in serious personal injury.
 - b. Use personal protective equipment. Always wear eye protection. Protective equipment such as dust mask, non-slip safety shoes, hard hat, or hearing protection used for appropriate conditions will reduce personal injuries.
 - c. Prevent unintentional starting. Ensure the switch is in the off-position before connecting to power source and/or battery pack, picking up or carrying the tool. Carrying power tools with your finger on the switch or energising power tools that have the switch on invites accidents.

ozito BATTERY & ALTERNATOR TESTER

12V

INSTRUCTION MANUAL

SPECIFICATIONS

Input Max.: 12V DC
Weight: 0.1 kg

ozito.com.au

3 YEAR REPLACEMENT WARRANTY*

STANDARD EQUIPMENT

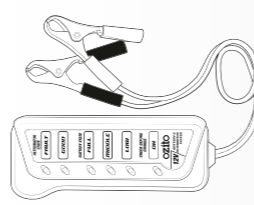

12V Battery & Alternator Tester

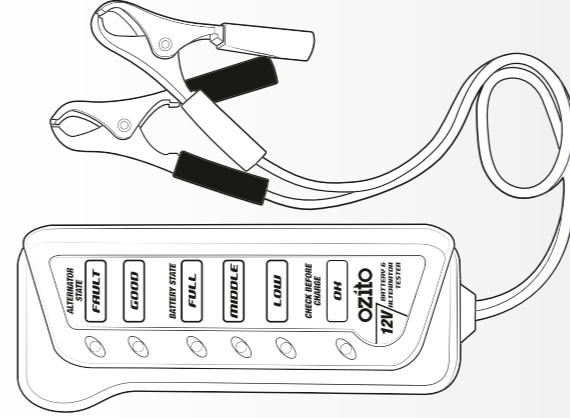

OCBT-1200

BATTERY TESTER WARNINGS

WARNING: Save all warnings and instructions for future reference

- WARNING:** Read all safety warnings and all instructions. Failure to follow the warnings and instructions may result in electric shock, fire and/or serious injury.
- This appliance is only intended for lead acid batteries
- Do not use a power tool while you are tired or under the influence of drugs, alcohol or medication. A moment of inattention while operating power tools may result in serious personal injury.
- The warnings, cautions and instructions discussed in this instruction manual cannot cover all possible conditions and situations that may occur.
- Common sense and caution are factors that cannot be built into this product but must be used.
- It is recommended to work with someone who can come to your aid when working near a lead acid battery.
- Do not come in contact with leaking battery electrolyte. If it gets on your face, neck, or clothes, flush with water immediately. If it gets in your eyes, immediately flush with water for at least ten minutes and get medical attention immediately.
- Be extra cautious to reduce risk of dropping a metal tool onto the battery. It could spark or short-circuit the battery.
- Remove personal metal items such as rings, bracelets, necklaces and watches when working with a lead acid battery. It can produce a short circuit current high enough to weld a ring or the like to metal causing a severe burn.
- Before testing, inspect the battery for cracks or broken cases or covers. If the battery is damaged, do not use tester.
- Work Area**
 - Wear ANSI-approved safety goggles and protective gloves during set up and use of the Battery Tester.
 - Test in a well ventilated area. Explosive gases may be produced during testing. Do not smoke, cause sparks, or strike matches near the battery when testing.
 - Protective, electrically non-conductive clothes and non-slip footwear are recommended when working. Wear steel-toe boots to prevent injury from falling objects.
- Keep Area**
 - Keep area safe work environment. Keep your work area clean and well lit.
 - Note: Minimize distractions in the work environment.
 - Distractions can cause you to lose control of the tool.
 - When connecting the battery tester cables to the battery, avoid creating sparks; especially when the battery is being charged. Explosive gases are created during charging. Sparking could also damage the vehicle electrical system.
 - Always lock up tools and keep them out of the reach of children
 - Do not dispose battery tester to rain, snow or wet conditions.
 - Stay clear of hot engine and car parts.
- Personal Safety**
 - Wear ANSI-approved safety goggles and protective gloves during set up and use of the Battery Tester.
 - Test in a well ventilated area. Explosive gases may be produced during testing. Do not smoke, cause sparks, or strike matches near the battery when testing.
 - Protective, electrically non-conductive clothes and non-slip footwear are recommended when working. Wear steel-toe boots to prevent injury from falling objects.

WARRANTY

IN ORDER TO MAKE A CLAIM UNDER THIS WARRANTY YOU MUST RETURN THE PRODUCT TO YOUR NEAREST BUNNINGS WAREHOUSE WITH YOUR BUNNINGS REGISTER RECEIPT. PRIOR TO RETURNING YOUR PRODUCT FOR WARRANTY PLEASE TELEPHONE OUR CUSTOMER SERVICE HELPLINE:

Australia: 1800 069 486
New Zealand: 0508 069 486

TO ENSURE A SPEEDY RESPONSE PLEASE HAVE THE MODEL NUMBER AND DATE OF PURCHASE AVAILABLE. A CUSTOMER SERVICE REPRESENTATIVE WILL TAKE YOUR CALL AND ANSWER ANY QUESTIONS YOU MAY HAVE RELATING TO THE WARRANTY POLICY OR PROCEDURE.

The benefits provided under this warranty are in addition to other rights and remedies which are available to you at law. Our goods come with guarantees that cannot be excluded at law. You are entitled to a replacement or refund for a major failure and for compensation for any other reasonably foreseeable loss or damage. You are also entitled to have the goods repaired or replaced if the goods fail to be of acceptable quality and the failure does not amount to a major failure. Generally you will be responsible for all costs associated with a claim under this warranty, however, where you have suffered any additional direct loss as a result of a defective product you may be able to claim such expenses by contacting our customer service helpline above.

3 YEAR REPLACEMENT WARRANTY*

Your product is guaranteed for a period of **36 months from the original date of purchase**. If a product is defective it will be replaced in accordance with the terms of this warranty. Warranty excludes consumable parts, for example: valve adapters and accessories.
*This product is intended for DIY use only and replacement warranty covers domestic use. **WARNING**
The following actions will result in the warranty being void.
If the tool has been operated on a supply voltage other than that specified on the tool. If the tool shows signs of damage or defects caused by or resulting from abuse, accidents or alterations.
Failure to perform maintenance as set out within the instruction manual. If the tool is disassembled or tampered with in any way. Professional, industrial or high frequency use.

KNOW YOUR PRODUCT

12V BATTERY & ALTERNATOR TESTER

1. Alternator State LED's
2. Battery State LED's
3. Check Before Charge LED
4. Black Negative Terminal Clamp (-)
5. Red Positive Terminal Clamp (+)

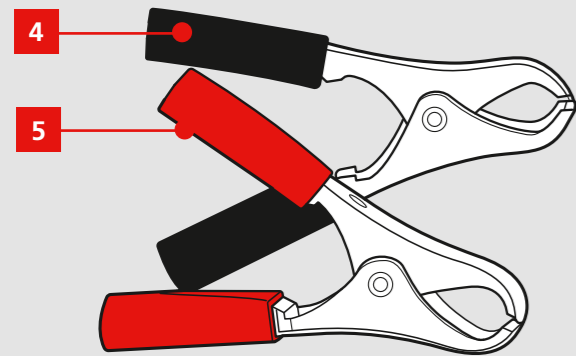
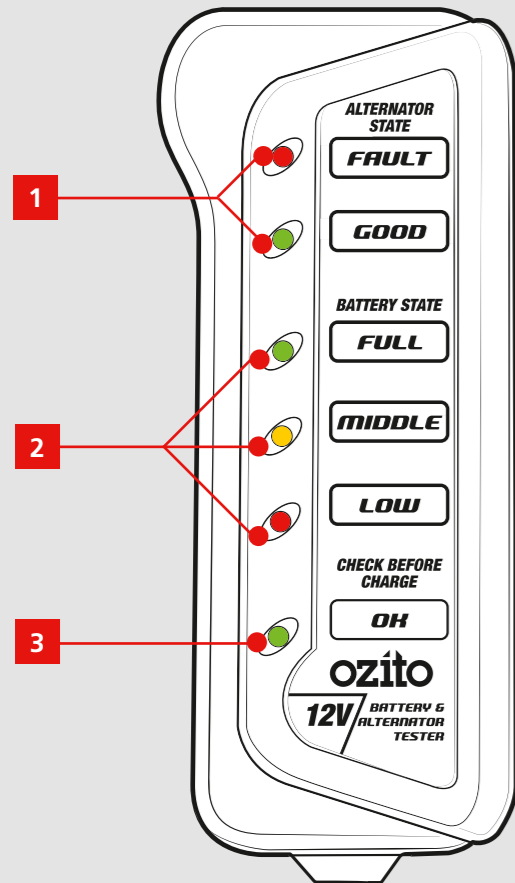

ONLINE MANUAL

Scan this QR Code with your mobile device to take you to the online manual.



3 YEAR REPLACEMENT WARRANTY*

SETUP & PREPARATION

1. BATTERY CONNECTION

WARNING! READ AND UNDERSTAND THE WARNINGS BEFORE SETUP AND TESTING.

WARNING! ENSURE THE POWER CORD IS UNCOILED AND FULLY EXTENDED TO AVOID OVERHEATING THE POWER CORD. ENSURE THAT IT DOES NOT GET TANGLED OR CAUGHT IN ANY ROTATING PARTS WITHIN THE ENGINE COMPARTMENT OF THE VEHICLE.

WARNING! ONLY FOR 12 VOLT LEAD ACID BATTERY.

WARNING! CHECK CORD AND CLAMP FOR DAMAGE BEFORE EVERY USE. DO NOT USE IF CORD OR CLAMP INSULATION IS MISSING OR DAMAGED AND WIRE IS EXPOSED.

Connecting to a Vehicle Battery

Before testing make sure the battery terminals are really clean as grease and dust could lead to errors in the test results. The battery MUST be disconnected prior to cleaning. Check the battery and connections for any cracks or damage before proceeding with cleaning and testing. To help ensure a good connection of the battery load tester clamps, clean the battery terminals with a solution of baking soda and water, and wipe the battery terminals with a cloth to remove any dirt and grease.

If the battery is still fitted to a motor vehicle, make sure that all the electronics are turned OFF, and that the ignition is turned OFF.

1. With the vehicle engine not running, connect the red positive terminal clamp to the positive (+) pole on your vehicle 12V battery.

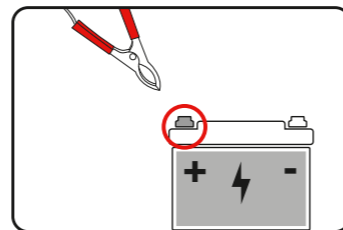

2. Connect the black negative terminal clamp to the negative (-) pole on your vehicle 12V battery.

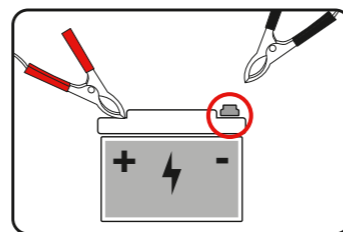

Disconnecting from a Vehicle Battery

1. Remove the black negative terminal clamp from the negative (-) pole of your vehicle battery.
2. Remove the red positive terminal clamp from the positive (+) pole of the vehicle battery.

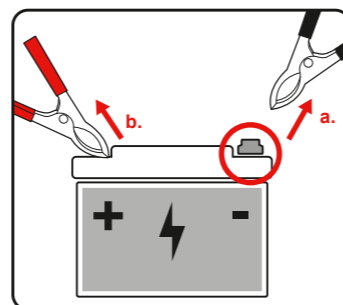

OPERATION

2. OVERVIEW

With the battery terminal clamps correctly connected to your vehicles 12V battery.

Alternator State

1. Start the engine and accelerate to 2000 rpm.

FAULT LED Red = Alternator voltage too high, could damage your battery

GOOD LED Green = Alternator working correctly.

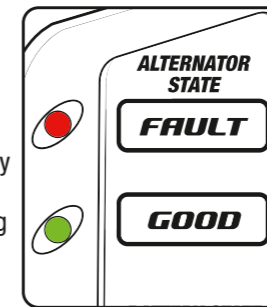

Battery State

1. Engine OFF

FULL LED Green = 12.6V–13.5V battery voltage

MIDDLE LED Yellow = 12.3V–12.5V battery voltage

LOW LED Red = 12–12.3V battery voltage

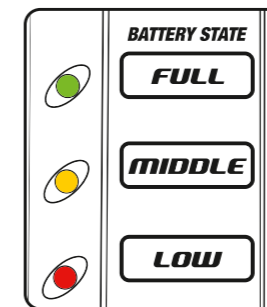

Check Before Charge

1. Engine OFF

OK LED Green = Battery can accept charge.

Note: The LED will not illuminate when the battery's voltage is 9.9V or below- battery is dead and cannot be charged.

Battery should be replaced.

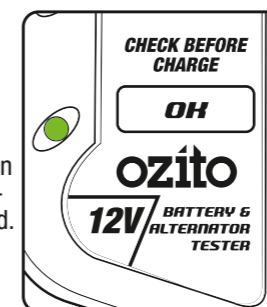

3. DIAGNOSIS

Display 1

1. Engine: OFF
Battery voltage: 10–12V

OK LED - Green

Flat battery. Battery could be charged but voltage is very low.

Note: The LED will not operate when the battery's voltage is 9.9V or below- battery is dead and cannot be charged.

Battery should be replaced.

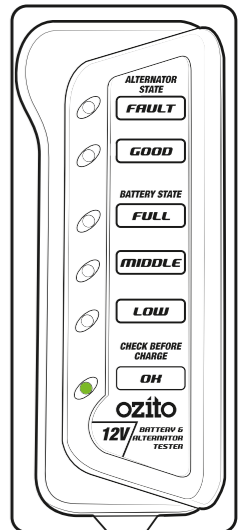

Display 2

1. Engine: ON
Charging voltage: 13.6–14.5V

GOOD LED - Green
FULL LED - Green
OK LED - Green

Battery is accepting full charging voltage from alternator.

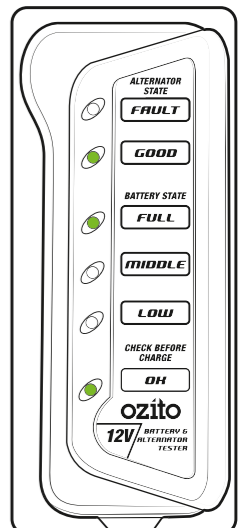

Display 3

1. Engine: ON
Charging voltage: >14.6V

FAULT LED - Red
FULL LED - Green
OK LED - Green

Alternator output voltage is too high, could damage your battery.

