

KNOW YOUR PRODUCT

CORDLESS PRUNING SAW

- 1. Blade Holder
- 2. Locking Sleeve
- 3. Blade
- 4. Clamping Jaw
- 5. Clamp Lever
- 6. Protective Cover
- 7. Safety Switch
- 8. Variable Speed Trigger
- 9. Main Handle
- 10. Battery Seating

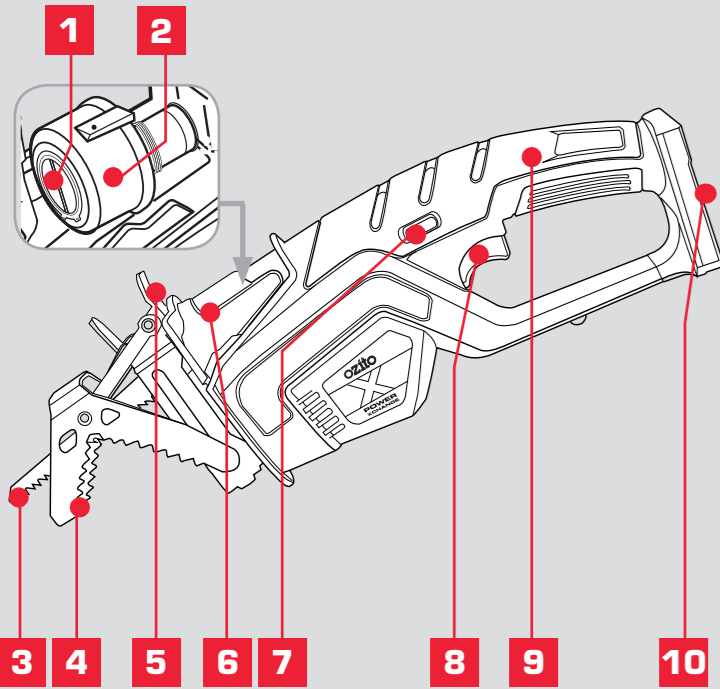

BATTERY & CHARGER (sold separately)

This tool is compatible with all battery and chargers from the Ozito Power X Change Range.

ONLINE MANUAL

Scan this QR Code with your mobile device to take you to the online manual.



SETUP & PREPARATION

1. BATTERY & CHARGER (SOLD SEPARATELY)

CAUTION: THE CHARGER FOR THIS PRODUCT SHOULD BE PROTECTED BY A RESIDUAL CURRENT DEVICE (RATED AT 30mA OR LESS).

The purchased battery will be shipped in a low charge condition, and requires charging prior to use. Allow several cycles of charging and discharging (through use of the tool) for the battery to reach its optimum performance / runtime.

Charging your lithium ion battery - Fast Charger

1. Connect the charger into a mains power outlet.

2. The charger LED will flash green showing power is being supplied to the charger.

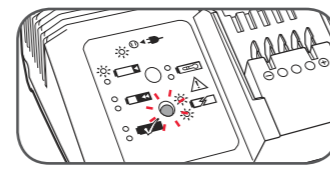

3. With the charger sitting on a flat surface, align the raised ribs on the battery with the recess in the charger and slide onto the charger ensuring a firm connection.

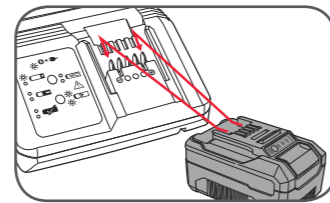

4. The charger LED will illuminate red signifying that the battery is charging.

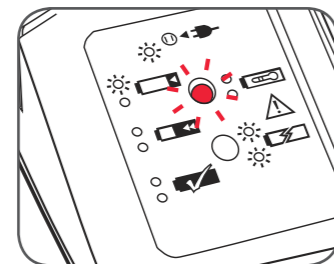

5. The charger LED will illuminate green once the battery is charged.

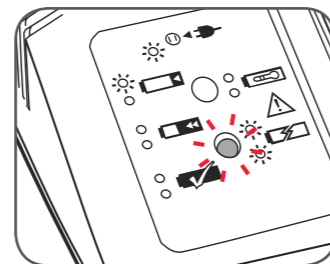

LED Indicator	Situation
GREEN (Flashing)	Stand By (no battery pack is inserted)
RED (Flashing)	Battery is charging (low charge)
RED (Illuminated)	Battery is charging (mid charge)
GREEN (Illuminated)	Battery is 85% - 100% charged and ready for use.
BOTH (Illuminated)	Battery pack is too hot or too cold (charging will begin automatically when battery reaches correct charging temperature).
BOTH (Flashing)	Defective battery. Never charge a defective battery pack! Remove battery pack from charger.

Charging your lithium ion battery - Eco Charger

1. Connect the charger into a mains power outlet.

2. The charger LED will flash green showing power is being supplied to the charger.

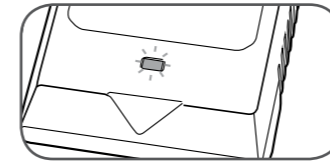

3. With the battery sitting on a flat surface, align the raised ribs on the battery with the recess in the charger and slide onto the battery ensuring a firm connection.

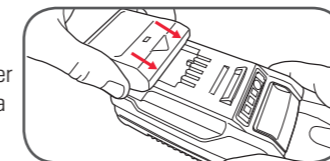

4. The charger LED will illuminate red signifying that the battery is charging.

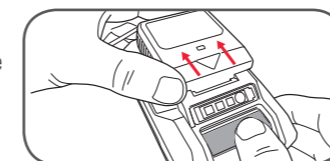

5. When removing the charger from the battery, first press the battery release tab, then slide the charger from its position.

LED Indicator	Situation
GREEN (Flashing)	Stand By (no battery pack is inserted)
RED (Illuminated)	Battery is charging (low charge)
GREEN (Illuminated)	Battery is charged and ready for use.
RED (Flashing)	Battery or Charger fault
RED & GREEN (Flashing)	Battery pack is too hot or too cold (remove battery from charger and store at room temperature 20°C. Insert battery again when at correct charging temperature). If this happens again, the battery is defective and needs to be replaced.

Battery Charge Indicator

The purchased battery is equipped with a battery charge indicator to show the state of the battery charge.

Press the charge indicator button and look to see which LED lights.

- Battery requires immediate charging
- Low state of charge, requires charging soon.
- Mid state of charge
- Full state of charge.

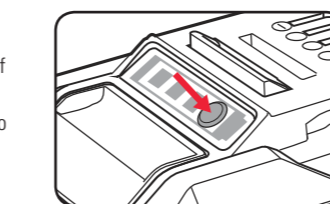

Note: The battery needs to be removed from the tool to check the state of charge.

2. CUTTING BLADES

WARNING! ENSURE THE BATTERY IS DISCONNECTED FROM THE TOOL BEFORE PERFORMING ANY OF THE FOLLOWING OPERATIONS.

CAUTION! DO NOT HANDLE BLADES WITHOUT GLOVES AS THEY ARE SHARP AND CAN BECOME HOT AFTER USE, POTENTIALLY CAUSING PERSONAL INJURY.

Fitting a Cutting Blade

The pruning saw can be fitted with standard reciprocating saw blades, therefore can be used to cut various timbers and plastics.

1. Press both sides of the protective cover and open it.
2. Rotate and hold the blade holder as shown.

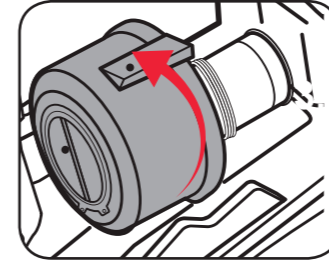
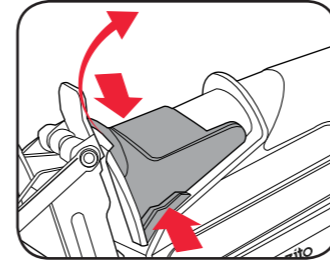

3. Insert the cutting blade into the blade holder then release the blade holder

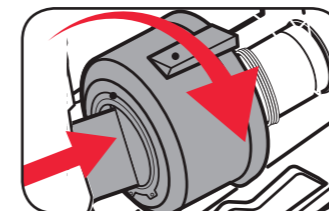
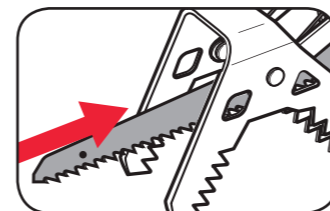

4. Ensure the blade is secure by pulling on the blade.

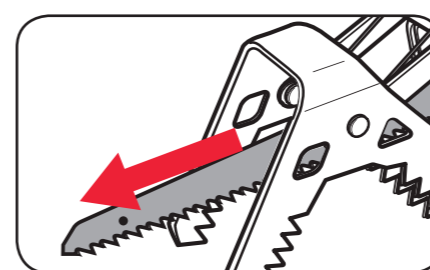

5. Close the protective cover



Removing the Cutting Blade

1. Open the protective cover.
2. Rotate and hold the blade holder as shown.
3. Remove the cutting blade from the blade holder.

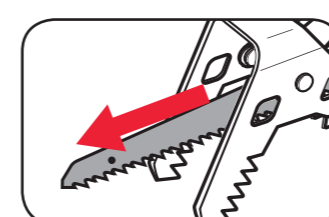
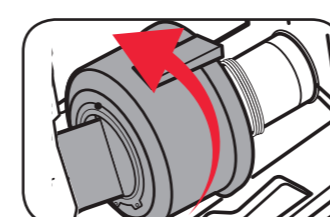

4. Close the protective cover

3. PREPARATION

The clamping jaw allows branches to be gripped up to Ø60mm, providing cutting of unsupported branches easier. When cutting wider branches or timber, the clamping jaw can be removed and the pruning saw can be used as a standard reciprocating saw.

Removing the Clamping Jaw

1. Press the clamp lever and pull the bracket from the bracket rail.

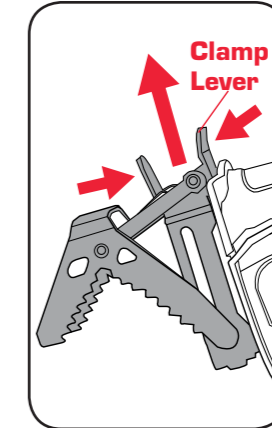

Fitting the Clamping Jaw

1. First align the clamping jaw with the bracket rail, then slide it onto the rail while pressing the clamp lever.
2. Release the clamp lever to lock in place.

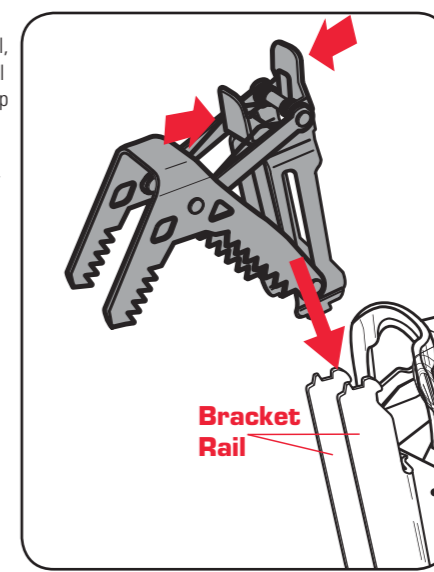

Note: Ensure the clamp jaw is secured by pulling the clamp jaw away from the body.

Installing and Removing the Battery

1. Slide the battery in so that it clicks into place.

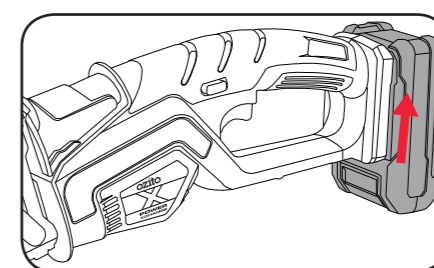

2. To remove, press and hold the battery release tab to release the battery, then slide the battery out.

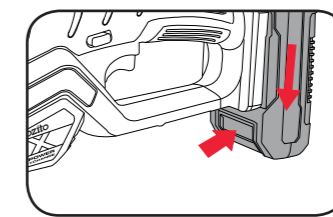

OPERATION

4. CONTROLS AND OPERATION

Switching the Saw On and Off

1. Push the safety switch in from either side of the tool and then squeeze the variable speed trigger to start the pruning saw.

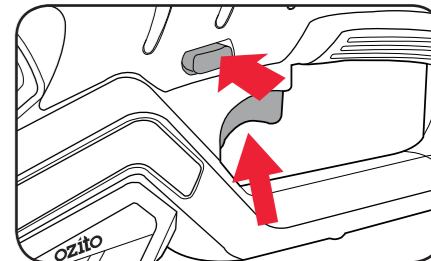

2. Release the variable speed trigger to stop the pruning saw.

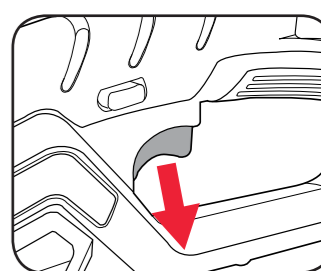

Torque Control Trigger

When the variable speed trigger is fully depressed and the saw has started the cut into the timber, based on load, the blade will speed up to complete the cut.

Cutting Branches Using the Clamping Jaw

1. Ensure the blade and the clamping jaw is secured correctly and hold the saw firmly.
2. Place the branch in between the clamping jaws and then lower to perform the cut.

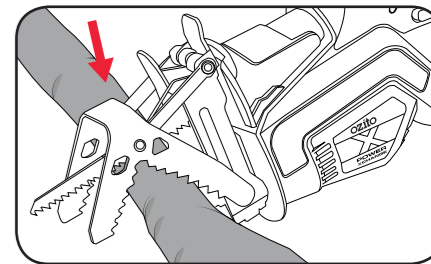

Note: The clamping jaw helps to guide the saw when cutting round branches up to Ø70mm.

Cutting Without the Clamping Jaw

When cutting thicker branches (up to Ø90mm) or sawing wood or plastic the clamping jaws can be removed to prevent them getting in the way of the cut.

1. Position the bracket rail of the saw onto the material to be cut for stability and then perform the cut holding the saw firmly.

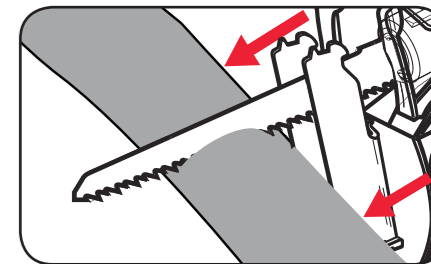

5 YEAR
REPLACEMENT WARRANTY