

GARDENLINE®

# Garden Fountain Pump

## User Guide



### AFTER SALES SUPPORT

☎ 1300 922 271  [service.australia@isc-gmbh.info](mailto:service.australia@isc-gmbh.info)

MODEL: GLSP 57 • 91208 • 11/2014



## Warranty Details

### Garden Fountain Pump

The product is guaranteed to be free from defects in workmanship and parts for a period of 36 months from the date of purchase. Defects that occur within this warranty period, under normal use and care, will be repaired, replaced or refunded at our discretion. The benefits conferred by this warranty are in addition to all rights and remedies in respect of the product that the consumer has under the Competition and Consumer Act 2010 and similar state and territory laws.

Our goods come with guarantees that cannot be excluded under the Australian Consumer Law. You are entitled to a replacement or refund for a major failure and for compensation for any other reasonably foreseeable loss or damage. You are also entitled to have the goods repaired or replaced if the goods fail to be of acceptable quality and the failure does not amount to a major failure.



# Table of contents

---

<b>02</b>	<b>Warranty Details</b>
<b>04</b>	<b>Safety information</b>
<b>07</b>	<b>Items supplied</b>
<b>08</b>	<b>Layout</b>
<b>09</b>	<b>Use</b>
<b>10</b>	<b>Before starting the equipment</b>
<b>12</b>	<b>Operation</b>
<b>14</b>	<b>Data</b>



# Safety information

# 1

Children are not allowed to play with the equipment. Unless supervised, children are not allowed to clean the equipment and carry out user-level maintenance work.

**Important.**

No repairs can be carried out on the electrical parts of this pump. The power cable of this equipment cannot be replaced. If the power cable or plastic-coated and sealed motor component is damaged, the equipment must be scrapped.

It is essential to connect the pump to a power supply protected by means of an earth-leakage circuit breaker (RCD) with a nominal leakage current of max. 30mA.

Do not place electrical equipment in the household waste – use the special collection points provided in your community. Ask your local council where to find a suitable collection point. If electrical devices are disposed of in an uncontrolled manner, there is a risk of hazardous substances escaping under the impact of the weather and getting into the ground water.



**Before you put the fountain pump into operation, carefully read the following safety regulations and the operating instructions.**

**If you give the equipment to any other person, give them the operating instructions as well. Keep these instructions in a safe place.**

**⚠ Caution!**

**In stagnant water bodies, garden ponds, swimming ponds and their surrounding areas the pump may only be used with an earth-leakage circuit breaker with an actuating rated current of up to 30 mA (acc. to VDE 0100 part 702 and 738). Also pay attention to local regulations for connecting to the power supply. The pump is not designed for use in swimming pools and paddling pools of any kind or other bodies of water in which people may be present during operation.**

**Operation is prohibited if a person is in the danger area. An electric shock can be fatal, so it is imperative to observe the following information:**

**The pump may be operated only from a suitable shock-proof socket.**



- Pumps with a 10m power cable (at least H07RN8-F) are prescribed for outdoors operation.
- Pull out the power plug prior to any maintenance work.
- Should the pump cable or the plug become damaged, the cable is not allowed to be repaired! The pump is not allowed to be used any longer.
- The pump is allowed to be used only to convey water.
- Never let the pump hang from the discharge line or the power cable.
- Protect the pump from frost.
- Take suitable measures to keep the equipment out of the reach of children.
- The use of cable networks, extension cables, connection leads and adapters without earthing contact is prohibited.

### **⚠ WARNING**

**Read all the safety regulations and instructions.**

**Any errors made in following the safety information and instructions may result in an electric shock, fire and/or serious injury.**

**Keep all the safety information and instructions in a safe place for future use.**



# Items supplied

# 2

## Packaging:

Your equipment is packaged to protect it from damage in transit. Packaging is raw material and can therefore be reused or returned to the raw material system.

- Open the packaging and take out the equipment with care.
- Remove the packaging material and any packaging and/or transportation braces (if present).
- Check to see if all the items are supplied.
- Inspect the equipment and accessories for transport damage.
- If possible, keep the packaging until the end of the guarantee period.

## Important.

The equipment and packaging material are not toys. Do not let children play with plastic bags, plastic sheets and small parts. There is a risk of choking and suffocating!

- Fountain pump
- Coupling
- Spout connection
- Fountain pipe
- Cascade fountain
- Bell fountain
- Bubble maker
- Operating instructions

# Layout

# 3

1. Fountain pump
2. Intake cage with BIOCELL insert
3. Carry-handle
4. Coupling
5. Spout connection
6. Fountain pipe
7. Cascade fountain
8. Bell fountain
9. Bubble maker



8

AFTER SALES SUPPORT



AUS 1300 922 271



service.australia@  
isc-gmbh.info

91208

GLSP 57  
11/2014



High performance universal fountain pump for continuous operation in garden ponds.

- Oil-free motor
- Stator hermetically sealed in cast resin
- Permanent magnet rotor surrounded by water

**Note:** Even though this product is suitable for continuous use, it must still be protected against freezing temperatures. We recommend therefore that you take the pump out of operation if you live in an area where there is a risk of the temperature dropping below freezing point.

### **Important.**

**The pump is not allowed to be used to operate swimming pools!**

The equipment is allowed to be used only for its intended purpose. Any other use is deemed to be a case of misuse. The user/operator and not the manufacturer will be liable for any damage or injuries of any kind resulting from such misuse.

Please note that our equipment has not been designed for use in commercial, trade or industrial applications. Our warranty will be voided if the equipment is used in commercial, trade or industrial businesses or for equivalent purposes.

# Before starting the equipment **5**

## **BIOCELL intake filter**

The intake filter of the fountain pump works with a BIOCELL filter insert. BIOCELL is a special material for the natural and biological cleaning of water. While normal mechanical filters only catch dirt particles such as plant residues, dead insects etc., the biological filtering process also decomposes dirt and sludge. This is done by saltpeter-forming bacteria. BIOCELL is a porous material specially developed for biological filtering processes, which offers these bacteria ideal conditions for reproduction. In the BIOCELL filter, toxic organic substances are converted into natural vegetable nutrients. This is a natural process which contributes greatly to the biological balance in the garden pond.

- Read the above safety instructions before you put your equipment into operation.
- Place the pump on a horizontal surface, located higher than the pond bed (this prevents excessive contamination through sludge from the pond bed).
- Make sure that the intake cage inlets are not blocked.
- Make sure that the pump is completely covered with water. Do not operate the pump out of the water or if it projects above the surface of the water.

## Mains connection

The equipment you have purchased comes with an earthing-pin plug. The equipment is designed for connection to a socket outlet with earthing contact for 230 V ~ 50 Hz. Make sure that the socket-outlet is sufficiently fused (at least 6 A) and in good working order. Insert the power plug in the socket-outlet and the equipment is ready for operation.



## Fountain operation

There are 3 options:

- Only fountain (cascade fountain, bell fountain or bubble-maker).
- Fountain together with water spout connection for water spectacles.
- Only water spout connection for water spectacles.

## Only fountain

When installing the pump in the pond, make sure that the fountain head sticks out of the water surface. If only the fountain is used, you must turn the stopcock (A) of the spout connection one quarter clockwise in order to close it. The stopcock (B) must be open (See Fig. 2).

## Fountain together with water spout connection

Install the pump as described above. In addition you can attach water spectacles with a hose inner diameter of 13mm or 20mm to the water spout connection.

The spout connection can be opened by turning the stopcock (A) counter-clockwise (see Fig. 2).

### Only water spout connection

Turn the stopcock (B) by 90°. The stopcock (A) must be open. All the water will thus flow through the spout connection and none through the fountain (see Fig. 3).

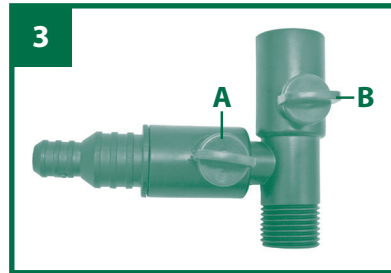
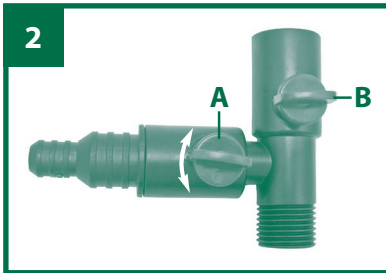

## Maintenance

- To ensure a long product life and uninterrupted service we recommend that you regularly check and care for your pump.
- The filter must be cleaned with lukewarm water whenever the delivery head or delivery rate diminishes.
- Clean the rotating parts of the pump at regular intervals if you use water that contains lime.
- To take the pump apart, proceed as follows:

### **Always pull out the power plug first!**

- a) Undo the intake cage (2) by turning it in the direction of the arrow (see Fig. 4).
- b) Screw out the screw in counterclockwise direction (Fig. 5/Item 1).
- c) Important. At the top and bottom end of the rotor are two washers which can fall out when the cover is taken off and when the rotor is removed. Take care not to lose these washers and be certain to fit them again when assembling.
- d) Turn the rotor cover on the bottom side of the pump counterclockwise (Fig. 5/Item 2) and then remove the rotor (Fig. 6).
- e) Clean the rotor and pump with clear water and assemble in the reverse order.

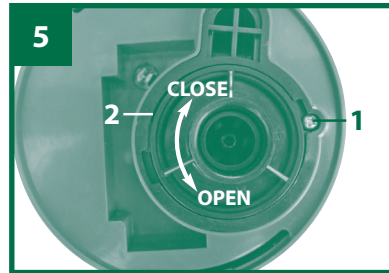

### Ordering spare parts

Please provide the following information on all orders for spare parts:

- Type of unit
- Article number of the unit
- ID number of the unit
- Part number of the required spare part

## Storage

Store the equipment and accessories out of children's reach in a dark and dry place at above freezing temperature. The ideal storage temperature is between 5°C and 30°C. Store the fountain pump in its original packaging.

## Disposal and recycling

The equipment is supplied in packaging to prevent it from being damaged in transit. The raw materials in this packaging can be reused or recycled. The equipment and its accessories are made of various types of material, such as metal and plastic. Defective components must be disposed of as special waste. Ask your dealer or your local council.

## Technical data

Mains connection .....	230 V ~ 50 Hz
Rating .....	50 W
Pumping rate $Q_{\max}$ .....	1750 l/h
Delivery head $H_{\max}$ .....	2m
Immersion depth .....	3m
Cascade fountain $h_{\max}$ .....	1.1m
Bubble-maker $h_{\max}$ .....	0.32m
Bell fountain $\varnothing_{\max}$ .....	0.45m
Protection type .....	IPX8
Max. water temperature .....	35°C





Lined writing area consisting of 20 horizontal lines for text entry.



AUS

1300 922 271



service.australia@isc-gmbh.info

91208

GLSP 57  
11/2014





A series of horizontal lines for writing, starting from the line below the pencil and continuing down the page.



EH 06/2014 (01)