

Original Operating Instructions
Universal Panel Saw

Einhell[®]

7

Art.-Nr.: 43.074.01

I.-Nr.: 11010

BT-UP **470**



Ⓜ Read and follow the operating instructions and safety information before using the equipment for the first time.

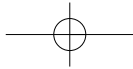
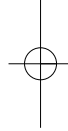

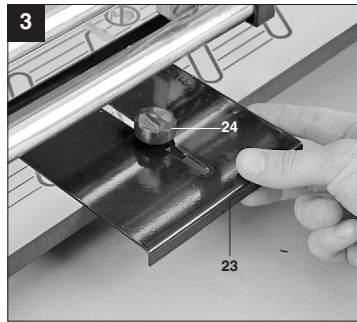
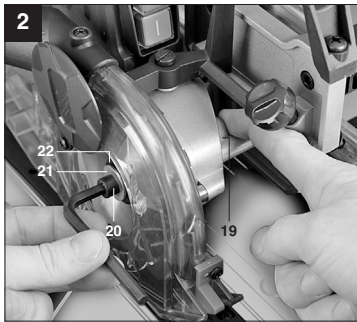
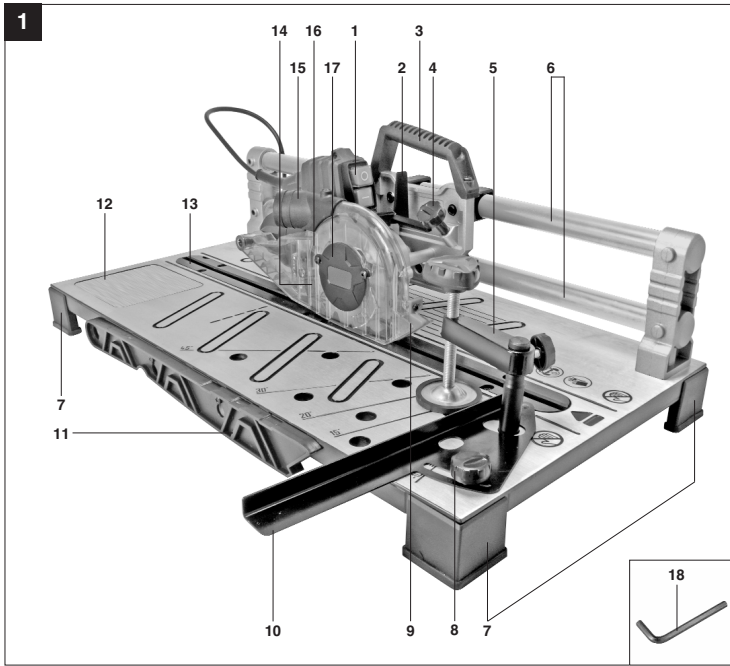

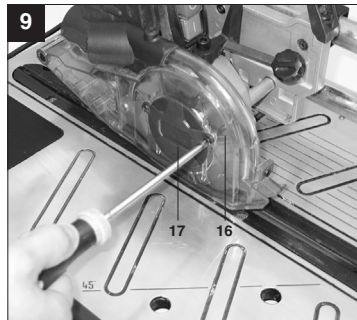
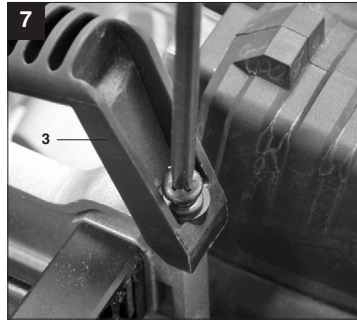
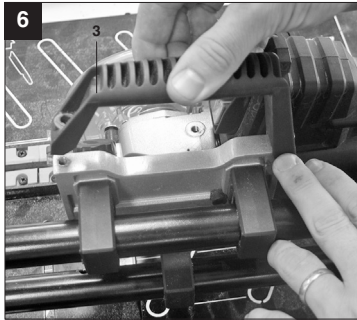
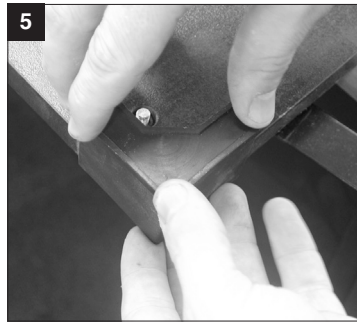
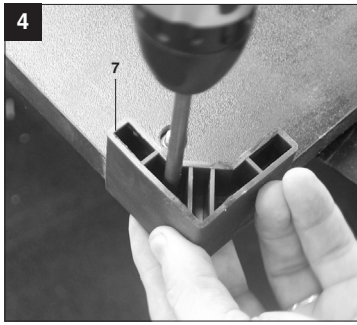

4

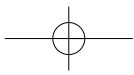

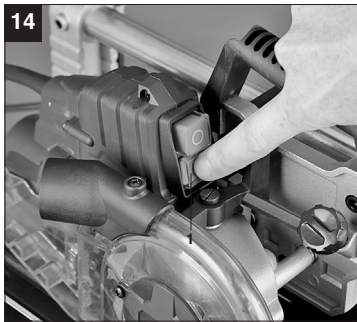
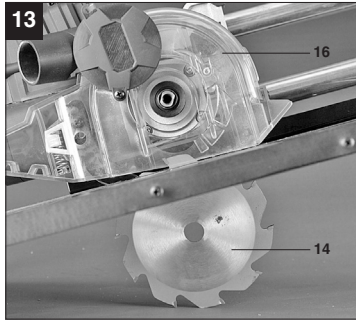
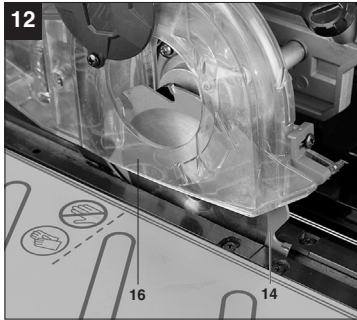
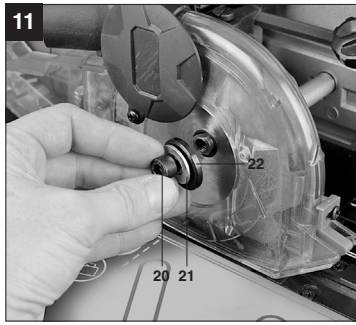
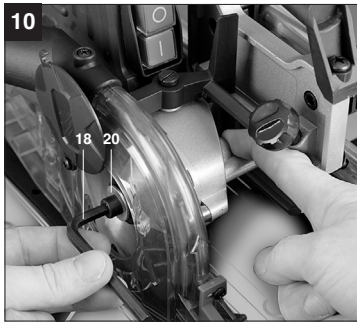

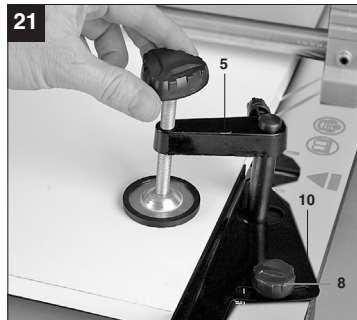
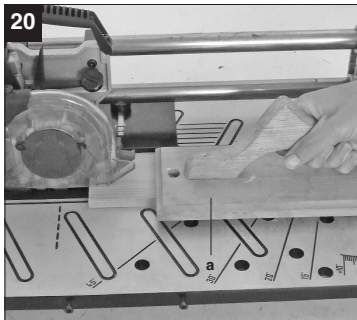
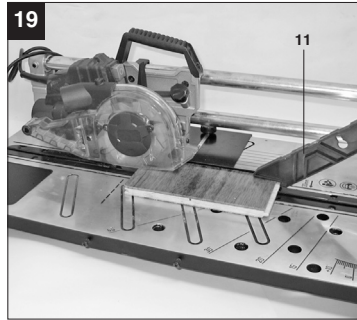
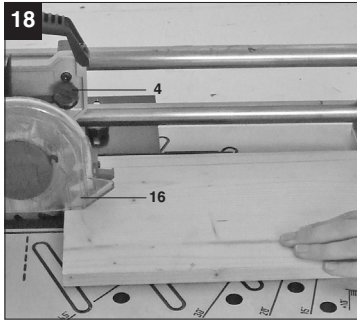
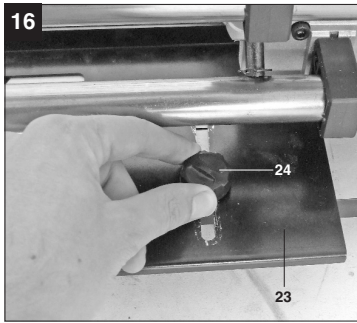

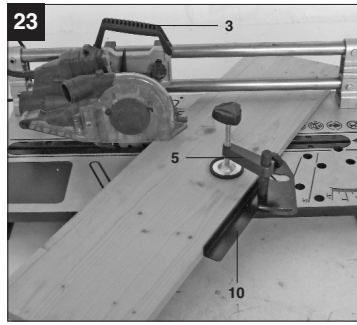
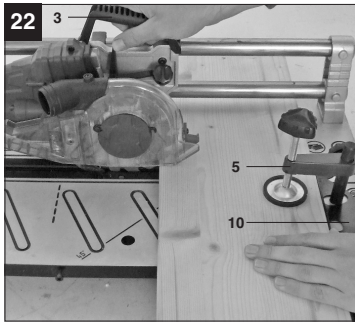

GB



"Caution - Read the operating instructions to reduce the risk of injury"



Wear ear-muffs.
The impact of noise can cause damage to hearing.



Wear a breathing mask.
Dust which is injurious to health can be generated when working on wood and other materials.
Never use the device to work on any materials containing asbestos!



Wear safety goggles.
Sparks generated during working or splinters, chips and dust emitted by the device can cause loss of sight.

⚠ Important.

When using the equipment, a few safety precautions must be observed to avoid injuries and damage. Please read the complete operating instructions and safety information with due care. Keep this manual in a safe place so that the information is available at all times. If you give the equipment to any other person, hand over these operating instructions and the safety information as well. We cannot accept any liability for damage or accidents which arise due to a failure to follow these instructions and the safety information.

1. Safety Information

Please refer to the booklet included in delivery for the safety information.

⚠ CAUTION

Read all the safety information and instructions. Any errors made in following the safety regulations and instructions may result in an electric shock, fire and/or serious injury. **Keep all safety regulations and instructions in a safe place for future use.**

2. Layout (Fig. 1-3)

1. ON/OFF switch
2. Safety lever
3. Handle
4. Knurled handle
5. Workpiece clamping device
6. Guide rails
7. Plastic feet
8. Locking screw for angle stop
9. Saw blade position indicator
10. Angle stop
11. Push stick in holder
12. Machine table
13. Table insert
14. Saw blade
15. Extractor socket
16. Saw blade guard
17. Saw blade cover
18. Hexagon wrench
19. Spindle lock
20. Saw blade screw
21. Washer
22. Outer flange
23. Parallel stop
24. Locking screw for parallel stop
25. Dust bag (not illustrated)

3. Items supplied (Fig. 1-4)

- Universal Panel Saw
- Carbide-tipped saw blade
- Angle stop
- Push stick
- Parallel stop
- Tools
- Installation material
- Plastic feet

4. Intended use

The universal panel saw is designed for the slitting and cross-cutting (only with the cross stop) of timbers and panels, commensurate with the equipment's size. The equipment is **not** to be used for cutting any type of round wood.

The equipment is to be used only for its prescribed purpose.

Any other use is deemed to be a case of misuse. The user/operator and not the manufacturer will be held liable for damage and/or injuries of any kind that result from such misuse.

The equipment is to be operated only with suitable saw blades (saw blades made of HM or CV) It is prohibited to use any type of HSS saw blade and cutting-off wheel.

To use the equipment properly you must also observe the safety regulations, the assembly instructions and the operating instructions to be found in this manual.

All persons who use and service the equipment have to be acquainted with this manual and must be informed about the equipment's potential hazards.

It is also imperative to observe the accident prevention regulations in force in your area.

The same applies for the general rules of health and safety at work.

The manufacturer will not be liable for any changes made to the equipment nor for any damage resulting from such changes.

Even when the equipment is used as prescribed it is still impossible to eliminate certain residual risk factors. The following hazards may arise in connection with the equipment's construction and design:

- Contact with the saw blade in the uncovered saw zone.
- Reaching into the running saw blade (cut injuries).
- Kick-back of workpieces and parts of workpieces.
- Saw blade fracturing.
- Catapulting of faulty carbide tips from the sawblade.

GB

- Damage to hearing if ear-muffs are not used as necessary.
- Harmful emissions of wood dust when used in closed rooms.

Please note that our equipment has not been designed for use in commercial, trade or industrial applications. Our warranty will be voided if the equipment is used in commercial, trade or industrial businesses or for equivalent purposes.

5. Technical data

AC motor	240 V ~ 50Hz
Power P	860 W
Idle speed n_0	11,000 min ⁻¹
Carbide saw blade	Ø 127 x Ø 17 x 2.5 mm
Number of teeth	14
Cutting height max.	18 mm / 0°
Dust extraction connector	Ø 36 mm
Weight	7.6 kg
Protection class:	II / 

Noise emission values

Sound and vibration values were measured in accordance with EN 61029.

	Operation
L_{pA} sound pressure level	96 dB(A)
K_{pA} uncertainty	3 dB
L_{WA} sound power level	109 dB(A)
K_{WA} uncertainty	3 dB

Vibration emission value $a_h < 2.5 \text{ m/s}^2$

Wear ear-muffs.

The impact of noise can cause damage to hearing.

Reduce noise generation and vibration to a minimum!

- Use only equipment that is in perfect condition.
- Maintain and clean the equipment regularly.
- Adopt your way of working to the equipment.
- Do not overload the equipment.
- Have the equipment checked if necessary.
- Switch off the equipment when not in use.

6. Before starting the equipment

- Unpack the saw and check it for damage which may have occurred in transit.
- The equipment has to be set up where it can stand securely.
- All covers and safety devices have to be properly fitted before the equipment is switched on.
- It must be possible for the blade to run freely.
- When working with wood that has been processed before, watch out for foreign bodies such as nails or screws, etc.
- Before you actuate the On/Off switch, make sure that the saw blade is correctly fitted and that the equipment's moving parts run smoothly.
- Check that the voltage on the rating plate is the same as your supply voltage before you connect the equipment to the power supply.

7. Assembly

Important. Pull out the power plug before carrying out any maintenance, resetting or assembly work on the circular saw!

7.1 Setting up the saw (Fig. 4-7)

Insert the plastic feet (7) into each corner of the housing. Secure the feet with the supplied screws, springs and washers. Tighten the screws. Attach the rubber pieces to the feet. Secure the handle (3) to the equipment using the supplied screws. Tighten the screws.

7.2 Changing the table insert

- To prevent increased likelihood of injury the table insert (13) should be changed whenever it is worn or damaged.
- Remove the screws.
- Lift the worn table insert (13) up and out.
- To fit the replacement table insert, proceed in reverse order.

7.3 Changing the saw blade (Fig. 8-13)

Important. Pull out the power plug.

- Wear work gloves when changing the saw blade.
- Use the knurled handle (4) to lock the equipment at the guide rail (6).
- Unscrew the screw from the saw blade cover (17).
- Then press the spindle lock (19). Turn the saw blade screw (20) anticlockwise with the supplied hexagon wrench (18).
- Remove the screw (20), washer (21) and the external flange (22). The saw blade (14) will drop

through the opening in the worktop and can be removed when you lift the equipment.

- Clean the blade flange thoroughly before fitting the new blade.
- Mount and fasten the new saw blade in reverse order.

Important. Check that the saw blade turns in the correct direction. The cutting direction of the teeth must point in running direction, i.e. upwards. Refer to the directional arrow on the saw blade cover and the saw blade. Make sure the power plug is disconnected and check if the new saw blade moves freely. Always check to make sure that all safety devices are properly mounted and in good working condition before you begin working with the saw again.

7.4 Transport and storage (Fig. 8)

- Use only the transport devices to move the equipment. Never use the guards for handling or moving the equipment.
- Lock the equipment with the knurled handle (4) and carry the equipment by the handle (6) or the machine table (12).
- Store the equipment in a dry room between +5°C and +40°C.

8. Operation

Important!!

- After every new adjustment we recommend you to make a trial cut in order to check the new settings.
- After switching on the saw, wait for the blade to reach its maximum speed of rotation before commencing with the cut.
- Take extra care when starting the cut!

8.1 ON/OFF switch (Fig. 14-15)

- To turn the saw on, press the green button "I".
- To turn the equipment off again, press the red button "O".
- Your panel saw is equipped with an overload cut-out switch. The overload cut-out switch disconnects the power supply if the saw blade is jammed or blocked. The switch unlocks automatically after a certain period and can not be reset manually.

8.2 Cutting narrow workpieces (Fig. 19)

Be sure to use a push stick (14) when making longitudinal cuts in workpieces smaller than 120 mm in width. A push stick is supplied with the saw. **Replace a worn or damaged push stick immediately.**

8.3 Cutting very narrow workpieces (Fig. 20)

- Be sure to use a push block (a) when making longitudinal cuts in very narrow workpieces with a width of 30 mm and less.
- **There is no push block supplied with the saw!** (Available from your specialist dealer) Please the push block without delay when it becomes worn.

8.4 Making longitudinal cuts (Fig. 8, 16-20)

- Use the knurled handle to lock the motor unit in splitting position; this will release the safety lever.
- Set the parallel stop (23) to the required width and lock into position with the locking screw (24). Remove the workpiece clamping device (5) and the angle stop (10) so that the workpiece lies flat on the work table.
- The distance markings on the table are intended only as a rough guide to the dimensions. First, cut a test piece and reset if necessary.
- Switch on the equipment and wait for a few seconds for the equipment to reach its full operating speed.
- Push the workpiece through under the saw blade cover (16). Place your hands (with fingers closed) flat on the workpiece and push the workpiece along the parallel stop (23) to the saw blade. Push the workpiece on the left side using your left hand, however only as far as the front edge of the saw blade guard.
- Always push the workpiece through to the end of the splitter.
- Always leave the offcuts on the saw table until the saw blade has come to a complete standstill.
- Always use the push stick (11) when your hands come to within a distance of 125 mm from the saw blade. After use, return the push stick (11) to its mount.

8.5 Making cross cuts, angle -10° ... +45° (Fig. 8, 17, 21-23)

- Remove the locking screw (24) of the parallel stop (23) and remove the parallel stop (23) so that the wood can lie flat on the table.
- Always carry out cross cuts with the angle stop (10) and the workpiece clamping device (5).
- Set the angle stop (10) to the required angle and secure the angle stop and the workpiece with the workpiece clamping device (5). When the angle

GB

stop is in the first position, the angles can be set with the locking screw (8) in increments of one degree from -10° to 10°.

- When working with angles 15°, 20°, 30° and 45°, remove the locking screw (8). Reposition the angle stop (10). Fasten the angle stop (10) by inserting the workpiece clamping device (5) into the hole on the angle stop.
- Secure the workpiece with the workpiece clamping device (5).
- Switch the equipment on and wait for it to reach its full operating speed. Press the safety lever (2) to raise the saw blade cover (16). Hold the equipment by its handle and pull it through the workpiece; then push the equipment back again until the workpiece is released.
- Switch off the equipment and remove the workpiece and sawdust only after the saw blade has stopped moving.

9. Replacing the power cable

If the power cable for this equipment is damaged, it must be replaced by the manufacturer or its after-sales service or similarly trained personnel to avoid danger.

10. Cleaning, maintenance and ordering of spare parts

Always pull out the mains power plug before starting any cleaning work.

10.1 Cleaning

- Keep all safety devices, air vents and the motor housing free of dirt and dust as far as possible. Wipe the equipment with a clean cloth or blow it down with compressed air at low pressure.
- We recommend that you clean the equipment immediately after you use it.
- Clean the appliance regularly with a damp cloth and some soft soap. Do not use cleaning agents or solvents; these may be aggressive to the plastic parts in the appliance. Ensure that no water can get into the interior of the equipment.
- Clean the guide rails (6) and plastic bearings each time after using and if necessary apply a little oil to the guide rails (6) to prevent them from rusting.

10.2 Servicing

- **Important.** Pull out the power plug.
- Remove dust and dirt regularly from the equipment. Cleaning is best carried out with a fine brush or a cloth.
- Never use caustic agents to clean plastic parts.
- Keep the saw unit drag device clean and lubricate it in regular intervals.

10.3 Ordering replacement parts:

Please provide the following information on all orders for spare parts:

- Model/type of the equipment
- Article number of the equipment
- ID number of the equipment
- Spare part number of the required spare part

For our latest prices and information please go to www.isc-gmbh.info

11. Disposal and recycling

The equipment is supplied in packaging to prevent it from being damaged in transit. The raw materials in this packaging can be reused or recycled. The equipment and its accessories are made of various types of material, such as metal and plastic. Defective components must be disposed of as special waste. Ask your dealer or your local council.



Never place any electric tools in your household refuse.
Seek advice on correct disposal from local waste authorities.



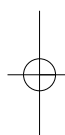
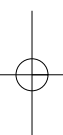

©
The reprinting or reproduction by any other means, in whole or in part,
of documentation and papers accompanying products is permitted only
with the express consent of ISC GmbH.

© Technical changes subject to change

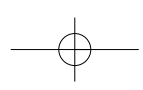

GUARANTEE CERTIFICATE

Dear Customer,

All of our products undergo strict quality checks to ensure that they reach you in perfect condition. In the unlikely event that your device develops a fault, please contact our service department at the address shown on this guarantee card. Of course, if you would prefer to call us then we are also happy to offer our assistance under the service number printed below. Please note the following terms under which guarantee claims can be made:

1. These guarantee terms cover additional guarantee rights and do not affect your statutory warranty rights. We do not charge you for this guarantee.
2. Our guarantee only covers problems caused by material or manufacturing defects, and it is restricted to the rectification of these defects or replacement of the device. Please note that our devices have not been designed for use in commercial, trade or industrial applications. Consequently, the guarantee is invalidated if the equipment is used in commercial, trade or industrial applications or for other equivalent activities. The following are also excluded from our guarantee: compensation for transport damage, damage caused by failure to comply with the installation/assembly instructions or damage caused by unprofessional installation, failure to comply with the operating instructions (e.g. connection to the wrong mains voltage or current type), misuse or inappropriate use (such as overloading of the device or use of non-approved tools or accessories), failure to comply with the maintenance and safety regulations, ingress of foreign bodies into the device (e.g. sand, stones or dust), effects of force or external influences (e.g. damage caused by the device being dropped) and normal wear resulting from proper operation of the device.

The guarantee is rendered null and void if any attempt is made to tamper with the device.
3. The guarantee is valid for a period of 2 years starting from the purchase date of the device. Guarantee claims should be submitted before the end of the guarantee period within two weeks of the defect being noticed. No guarantee claims will be accepted after the end of the guarantee period. The original guarantee period remains applicable to the device even if repairs are carried out or parts are replaced. In such cases, the work performed or parts fitted will not result in an extension of the guarantee period, and no new guarantee will become active for the work performed or parts fitted. This also applies when an on-site service is used.
4. In order to assert your guarantee claim, please send your defective device postage-free to the address shown below. Please enclose either the original or a copy of your sales receipt or another dated proof of purchase. Please keep your sales receipt in a safe place, as it is your proof of purchase. It would help us if you could describe the nature of the problem in as much detail as possible. If the defect is covered by our guarantee then your device will either be repaired immediately and returned to you, or we will send you a new device.

Of course, we are also happy offer a chargeable repair service for any defects which are not covered by the scope of this guarantee or for units which are no longer covered. To take advantage of this service, please send the device to our service address.

EINHELL AUSTRALIA PTY LTD
6/166 Wellington Street
Collingwood VIC 3066
Australia
Phone: 1300 922 271

