

Original instructions  
XPL-600U

REPLACEMENT WARRANTY  
12 MONTHS HOME USE



#### XU1 Power tools

iSC GmbH, Eschenstraße 6, D-94405 Landau, Germany

Telephone: GB: 0151 294 4488 / IRL: 1850 882711

## SAFETY INSTRUCTIONS

 ALWAYS WEAR EYE, FACE AND EAR PROTECTION

### When operating the tool

Check that the switch is in the "OFF" position before connecting to the power supply. Switch to "OFF" immediately after completion of the task.

Keep the mains cable away from any moving parts or accessories.

Never cover the ventilation slots in the tool.

Always hold the body and auxiliary handle firmly. Otherwise, the counterforces produced during use or the jamming of the blade can cause inaccuracies or put the planer out of control.

### Electrical safety

Before you connect the equipment to the mains supply make sure that the data on the rating plate are identical to the mains data.

**Hold power tool by insulated gripping surfaces, when performing an operation where the cutting accessory may contact hidden wiring or its own cord.** Cutting accessory contacting a "live" wire may make exposed metal parts of the power tool "live" and could give the operator an electric shock.

**This appliance is not intended for use by persons (including children) with reduced physical, sensory or mental capabilities, or lack of experience and knowledge, unless they have been given supervision or instruction concerning use of the appliance by a person responsible for their safety.**

**Recommendations for the use of a residual current device** with a rated residual current of 30mA or less.

### Using an extension lead

Always use an approved extension lead suitable for the power input of this tool. Before use, inspect the extension lead for signs of damage, wear and ageing. Replace the extension lead if damaged or defective.

When using an extension lead on a reel, always unwind the lead completely. Use of an extension lead not suitable for the power input of the tool or which is damaged or defective may result in a risk of fire and electric shock.

### Description of symbols

V	Volts
Hz	Hertz
~	Alternating current
W	Watts
/min	Revolutions or reciprocation per minute
no	No load speed



Double insulated



Warning



Read instruction manual



Wear eye protection

Wear breathing protection

Wear hearing protection

### General Power Tool Safety Warnings



**WARNING!** Read all safety warnings and all instructions. Failure to follow the warnings and instructions may result in electric shock, fire and/or serious injury. **Save all warnings and instructions for future reference.** The term "power tool" in all of the warnings refers to your mains-operated (corded) power tool or battery-operated (cordless) power tool.

#### 1) Work area safety

a) **Keep work area clean and well lit.** Cluttered and dark areas invite accidents.

b) **Do not operate power tools in explosive atmospheres, such as in the presence of flammable liquids, gases or dust.** Power tools create sparks which may ignite the dust or fumes.

c) **Keep children and bystanders away while operating a power tool.** Distractions can cause you to lose control.

#### 2) Electrical safety

a) **Power tool plugs must match the outlet. Never modify the plug in any way. Do not use any adapter plugs with earthed (grounded) power tools.** Unmodified plugs and matching outlets will reduce risk of electric shock.

b) **Avoid body contact with earthed or grounded surfaces such as pipes, radiators, ranges and refrigerators.** There is an increased risk of electric shock if your body is earthed or grounded.

c) **Do not expose power tools to rain or wet conditions.** Water entering a power tool will increase the risk of electric shock.

d) **Do not abuse the cord. Never use the cord for carrying, pulling or unplugging the power tool. Keep cord away from heat, oil, sharp edges or moving parts.** Damaged or entangled cords increase the risk of electric shock.

e) **When operating a power tool outdoors, use an extension cord suitable for outdoor use.** Use of a cord suitable for outdoor use reduces the risk of electric shock.

f) **If operating a power tool in a damp location is unavoidable, use a residual current device (RCD) protected supply.** Use of an RCD reduces the risk of electric shock.

#### 3) Personal safety

a) **Stay alert, watch what you are doing and use common sense when operating a power tool. Do not use a power tool while you are tired or under the influence of drugs, alcohol or medication.** A moment of inattention while operating power tools may result in serious personal injury.

b) **Use personal protective equipment. Always wear eye protection.** Personal protective equipment such as dust mask, non-skid safety shoes, hard hat, or hearing protection used for appropriate conditions will reduce personal injuries.

c) **Prevent unintentional starting. Ensure the switch is in the off-position before connecting to power source and/or battery pack, picking up or carrying the tool.** Carrying power tools with your finger on the switch or energising power tools that have the switch on invites accidents.

d) **Remove any adjusting key or wrench before turning the power tool on.** A wrench or a key left attached to a rotating part of the power tool may result in personal injury.

e) **Do not overreach. Keep proper footing and balance at all times.** This enables better control of the power tool in unexpected situations.

f) **Dress properly. Do not wear loose clothing or jewellery. Keep your hair, clothing and gloves away from moving parts.** Loose clothes, jewellery or long hair can be caught in moving parts.

g) **If devices are provided for the connection of dust extraction and collection facilities, ensure these are connected and properly used.** Use of dust collection can reduce dust-related hazards.

#### 4) Power tool use and care

a) **Do not force the power tool. Use the correct power tool for your application.** The correct power tool will do the job better and safer at the rate for which it was designed.

b) **Do not use the power tool if the switch does not turn it on and off.** Any power tool that cannot be controlled with the switch is dangerous and must be repaired.

c) **Disconnect the plug from the power source and/or the battery pack from the power tool before making any adjustments, changing accessories, or storing power tools. Such preventive safety measures reduce the risk of starting the power tool accidentally.**

d) **Store idle power tools out of the reach of children and do not allow persons unfamiliar with the power tool or these instructions to operate the power tool.** Power tools are dangerous in the hands of untrained users.

e) **Maintain power tools. Check for misalignment or binding of moving parts, breakage of parts and any other condition that may affect the power tools operation. If damaged, have the power tool repaired before use.** Many accidents are caused by poorly maintained power tools.

f) **Keep cutting tools sharp and clean.** Properly maintained cutting tools with sharp cutting edges are less likely to bind and are easier to control.

g) **Use the power tool, accessories and tool bits etc. in accordance with these instructions and in the manner intended for the particular type of power tool, taking into account the working conditions and the work to be performed.** Use of the power tool for operations different from those intended could result in a hazardous situation.

#### 5) Service

a) **Have your power tool serviced by a qualified repair person using only identical replacement parts.** This will ensure that the safety of the power tool is maintained.

### Additional safety rules for Planer



**WARNING!**Use of this tool can generate dust containing chemicals known to cause cancer, birth defects or other reproductive harm. Use appropriate respiratory protection.

**Hold power tool by insulated gripping surfaces, when performing an operation where the cutting accessory may contact hidden wiring or its own cord.** Cutting accessory contacting a "live" wire may make exposed metal parts of the power tool "live" and could give the operator an electric shock

- Be sure to read the instruction manual thoroughly before using this tool.
- Be sure the voltage agrees with specific data on the nameplate.
- Be sure the switch is in OFF position before connecting tool to the power supply.
- Be sure to switch OFF immediately if the tool is jammed in work.
- Be sure the tool is disconnected from power source when cleaning or making adjustments to the tool.
- Be sure the tool is properly held and set for correct use before turning switch to ON.

**Wait for the cutter to stop before setting the tool down.** An exposed cutter may engage the surface leading to possible loss of control and serious injury.

- Be sure to use specified replacement parts only.
- Be sure to maintain tool with care. Follow instructions for lubricating and changing accessories.
- Be sure to store tool in a clean dry place after disconnecting from power source.
- Keep air vents unobstructed for proper motor cooling.
- DO NOT lay tool down on shoe when the blades are exposed. This can chip the blades.
- Keep side dust extraction port unobstructed at all times.
- Never reach under the tool for any reason unless it is turned off and UNPLUGGED. BLADES ARE EXPOSED AND EXTREMELY SHARP.
- Use this tool for working with wood and wood products only.
- Never operate without securely holding the front handle.
- Always operate planer with two hands.
- Planer blades are extremely sharp – Handle with great care.

**CAUTION:**Some wood contains preservatives such as copper chromium arsenate (CCA) which can be toxic. When sanding, drilling, or cutting these materials extra care should be taken to avoid inhalation and minimise skin contact.



## PRODUCT PARTS

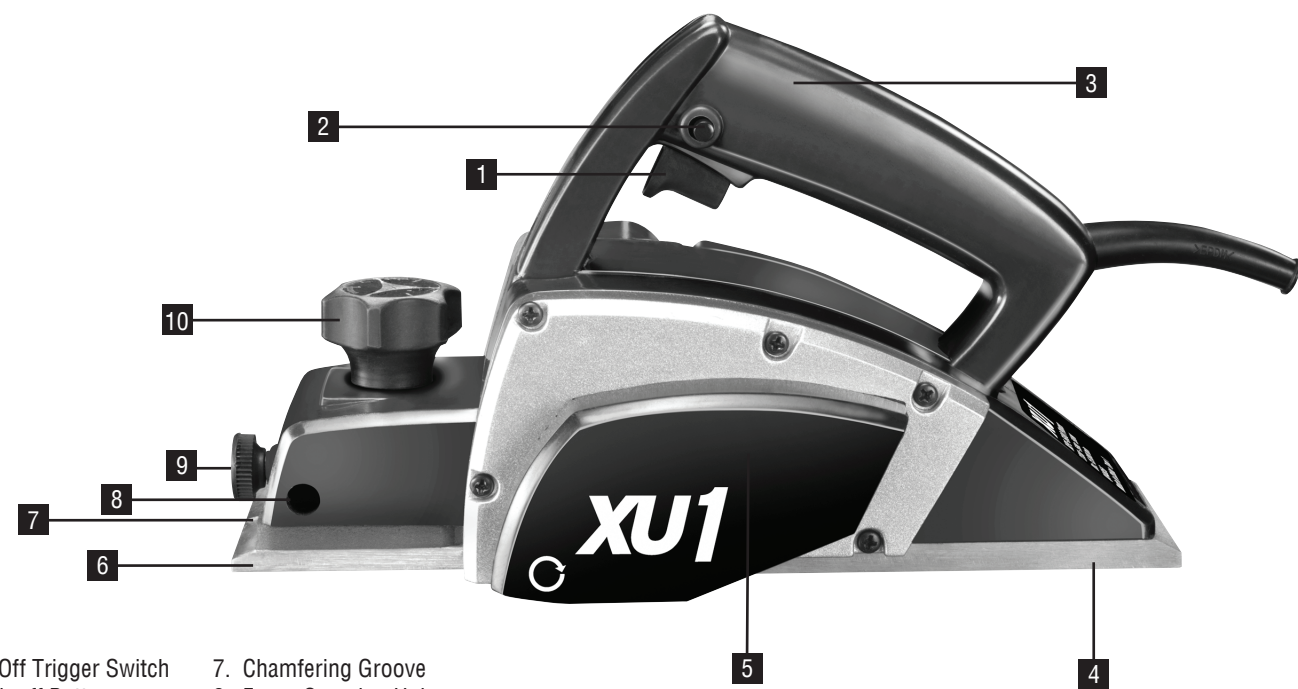

- |                          |                           |
|--------------------------|---------------------------|
| 1. On/Off Trigger Switch | 7. Chamfering Groove      |
| 2. Lock-off Button       | 8. Fence Securing Hole    |
| 3. Handle                | 9. Fence Securing Knob    |
| 4. Rear Shoe             | 10. Depth Adjustment Knob |
| 5. Drive Belt Cover      |                           |
| 6. Front Shoe            |                           |

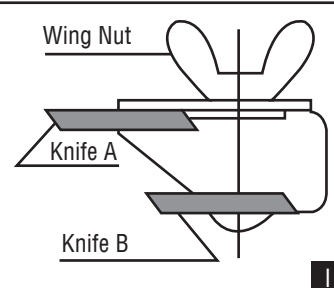
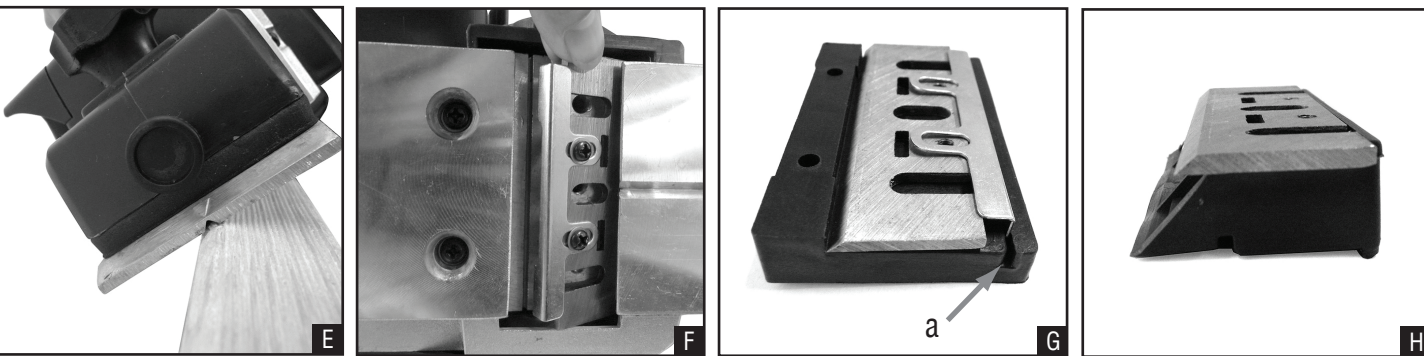
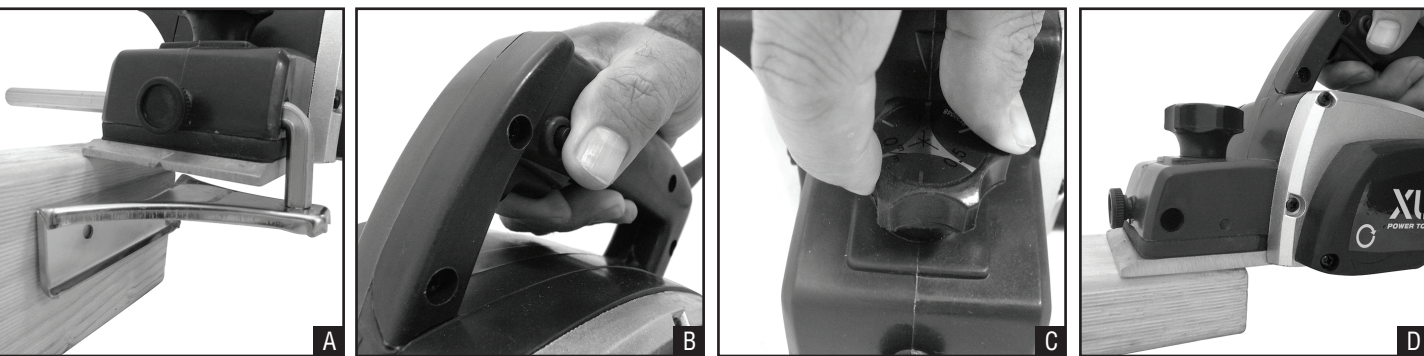

## SPECIFICATIONS

Input Power:	500W
Input Voltage:	230V~50Hz
No Load Speed:	15,000/min
Planing Width:	82mm
Max Planing Depth:	1mm
Max Rebate Depth:	6mm
Weight:	2.45kg

**WARNING!** The noise level of this machine can exceed 85dB(A). Operators are recommended to use hearing protection devices.

## ASSEMBLY

### Assembling the fence

- Place the planer on the surface of the work piece and insert the edge fence into the fence securing hole.
- Adjust the edge fence until it sits flushed to the side of your work piece and tighten the edge fence securing knob **Fig. A**

**Note:** Make sure your edge fence sits flushed to your work piece at all times to prevent uneven planing.

## OPERATION

### Turning On/Off the Planer

**Caution:** Always pick up your planer before depressing the switch, failure to do so may result in an exposed cutter to engage the surface leading to possible loss of control and/or serious injury.

- Firmly grip the planer depress the lock-off button and squeeze the On/Off trigger switch. **Fig. B**
- Note:** The lock-off button is a safety measure. The planer will not start unless the lock-off button has been fully depressed first.

- To turn off the planer, simply release the On/Off trigger switch.

**Note:** This tool is not designed for the On/Off trigger switch to be locked in the 'ON' position. Never jam the On/Off trigger switch in the 'ON' position.

### Adjusting Planing Depth

- Before performing any adjustments ensure the tool has been switched off and is disconnected from any power supply
- Planing depth is infinitely variable from 0 to 1mm. This is adjustable by rotating the depth of cut adjustment knob. As the knob is rotated clockwise from the "0" position the cutting depth will increase from 0 to a maximum of 1mm. **Fig. C**

**Note:** It is recommended that test cuts be made on scrap wood after each adjustment.

- When planing, it is better to make several shallow passes for a smoother finish than one deep pass.

## Planing

**Caution:** Prior to planing, please check that work piece to be planed is free of any nails, screws and staples as this may damage the blades, belts or the base of the planer or result in personal injury.

- Ensure workpiece is clamped securely so that it will not move during the planing
- Hold the planer handle firmly in one hand while holding the depth of cut adjustment knob with your other hand.
- Place the front shoe on the surface of the work piece to be planed, making certain that the cutting blades are not touching the surface **Fig. D**

**Note:** Make sure the front shoe is placed completely flat on the work piece.

- Depress the lock-off button and squeeze the On/Off trigger switch. Allow the motor to reach its full speed before planing.
- Once the motor has reach its full speed, move the planer slowly along the surface of the work piece.

**Note:** Maintain a downward pressure at all times to keep the planer flat on the work piece from start to finish.

## Rebating

Your planer can make rebate cuts up to 6mm deep.

- Draw the cutting line on the workpiece.
- Insert the edge fence into the fence securing hole.
- Align the edge of the blade to the cutting line.
- Adjust the edge fence until it sits flushed to the side of your work piece and tighten the edge fence securing knob **Fig. A**

**Note:** Make sure your edge fence sits flushed to your work piece at all times to prevent uneven planing.

## Edge Chamfering

- Align the 'V' groove in the front base with the edge of the work piece **Fig. E**
- Gently guide the planer forward to start chamfering.

## CHANGING BLADES

For best results, keep the blades clean and sharpen or replace when necessary.

**Caution:** Before you make any adjustments, make sure the tool has been switched off and the power cord has been disconnected from the electricity supply.

**Caution:** Blades are sharp, use gloves when changing or making adjustments.

**Note:** The drum is fitted with two separate blades; both must be sharpened or replaced at the same time. Never replace only one blade.

- In an anti-clockwise direction, remove the three bolts with the wrench provided and remove the blade clamp and blade carrier to which the blades are attached. **Fig. F**
- The blade carrier has two screws fastening it to the blade. Remove blade carrier screws and washers from the blade.
- Place the new blade onto the blade aligning block (supplied in the carton) with the sharp edge flush to the raised edge of the aligning block **Fig. G**
- Fit the blade carrier into the groove (a) on the other end of of the blade aligning block **Fig. G**
- Then align the screw holes on the blade.
- Fasten the blade carrier and blade back together with the washers and screws.
- Fit the blade carrier with the blade assembled back onto the drum. Ensure the blade carrier sits in the groove in the drum with the blade carrier hard up against the rear of the groove.
- Fit the blade clamp over the blade carrier and blade, using the wrench supplied ensure the bolts are securely fastened.
- Rotate the cutter block and repeat steps 3 to 8 for the other blade.

**Note:** Prior to using the planer rotate the drum by hand to ensure the blades do not hit any part of the planer body.

## MAINTENANCE

### Sharpening the Blade

- To sharpen the blades, remove the blades from the planer as shown in the 'Changing Blades' section.
- Place the wider base of the blade sharpening jig on a flat surface and place one blade on the jig with the cutting edge hanging over the edge. **Fig. H**

**Note:** Make sure the angle face of the blade is facing the same direction as the angled face of the sharpening jig.

- Align the screw hole on the blade with the screw hole on the sharpening jig and fit both the screws through.
- Hold it firmly with your hands and flip it around to fit the other blade on through the screws.

**Note:** Make sure the angle face of the knife is facing the same direction as the angled face of the sharpening jig.

- Place the securing plate on top of the knife through the screws and fasten it with the wing nuts. **Fig. I**
- Then sharpen the blades with a sharpening stone (not provided).

### Changing the Drive Belt

- Remove the two screws on the drive belt cover and remove the cover.
- Remove the broken and/or damaged belt.
- Place the new drive belt onto the smallest drive pulley first and while turning the planer drum anti-clockwise slip the new belt onto the larger planer drum drive pulley until the belt is fully located over all of the pulley drive grooves.

### Cleaning and Lubrication

- Use a stiff brush to gently brush off any dust from the base and around the drum as a result of planing.
- Use only mild soap and a damp cloth to wipe the tool.

**Caution:** Never let any liquid get inside the tool.

- Self-lubricating bearings are used in the tool and periodic lubrication is not required.

## WARRANTY

All of our products undergo strict quality checks to ensure that they reach you in perfect condition. In the unlikely event that your device develops a fault, please contact our service department at the address shown on this guarantee card. You can also contact us by telephone using the customer service number shown. Please note the following terms under which guarantee claims can be made:

- These warranty terms regulate additional warranty services, which the manufacturer mentioned below promises to buyers of its new products in addition to their statutory guarantee claims are not affected by this guarantee. Our guarantee is free of charge to you.

- The warranty services only covers defects due to material or manufacturing faults on a product which you have bought from the manufacturer mentioned below are limited to either the rectification of said defects on the product or the replacement of the product, whichever we prefer. Please note that our devices are not designed for use in commercial, trade or professional applications. A guarantee contract will not be created if the device has been used by commercial, trade or industrial business or has been exposed to similar stresses during the guarantee period.

- The following are not covered by our guarantee:
  - Damage to the device caused by a failure to follow the assembly instructions or due to incorrect installation, a failure to follow the operating instructions (for example connecting it to an incorrect mains voltage or current type) or a failure to follow the maintenance and safety instructions or by exposing the device to abnormal environmental conditions or by lack of care and maintenance.
  - Damage to the device caused by abuse or incorrect use (for example overloading the device or the use or unapproved tools or accessories), ingress of foreign bodies into the device (such as sand, stones or dust, transport damage), the use of force or damage caused by external forces (for example by dropping it).
  - Damage to the device or parts of the device caused by normal or natural wear or tear or by normal use of the device.

- Your Product is guaranteed for a period of 12 months from the original date of purchase and is intended for DIY (Do It Yourself) use only. Warranty excludes consumable parts, for example: cutting blade. Guarantee claims should be submitted before the end of the guarantee period within two weeks of the defect being noticed. No guarantee claims will be accepted after the end of the guarantee period. The original guarantee period remains applicable to the device even if repairs are carried out or parts are replaced. In such cases, the work performed or parts fitted will not result in an extension of the guarantee period, and no new guarantee will become active for the work performed or parts fitted. This also applies if an on-site service is used.

IN ORDER TO MAKE A CLAIM UNDER THIS WARRANTY YOU MUST RETURN THE PRODUCT TO THE PLACE OF PURCHASE WITH YOUR REGISTER RECEIPT.

Please refer to the restrictions of this warranty concerning wearing parts, consumables and missing parts as set out in the service information in these operating instructions.

CUSTOMER SERVICE HELPLINE  
GB: 0151 294 4488  
IRL: 1850 882711

**XU1**  
Unit 9 Stadium Court, Wirral International Business Park, Plantation Road, Bromborough, Wirral, CH62 3QG