

KNOW YOUR PRODUCT

CORDLESS TRIMMER/SHEAR

- 1. Base Release Button
- 2. Removable Base
- 3. Safety Switch
- 4. On/Off Trigger
- 5. Sure Grip Handle
- 6. Battery Seating

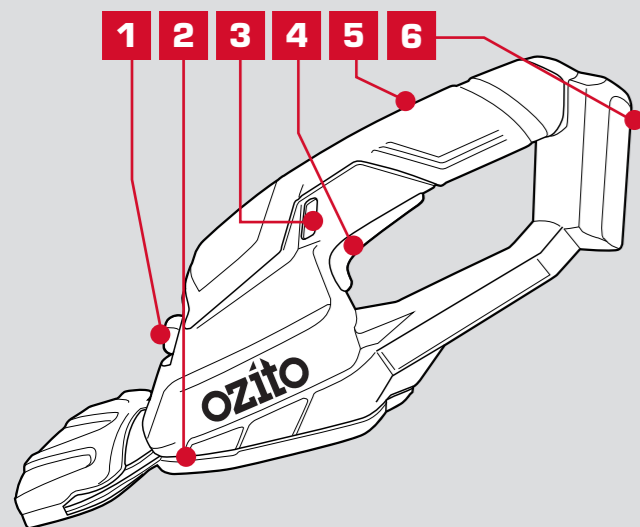

ACCESSORIES

- 7. Hedge Trimmer Blade
- 8. Grass Shear Blade
- 9. Blade Covers

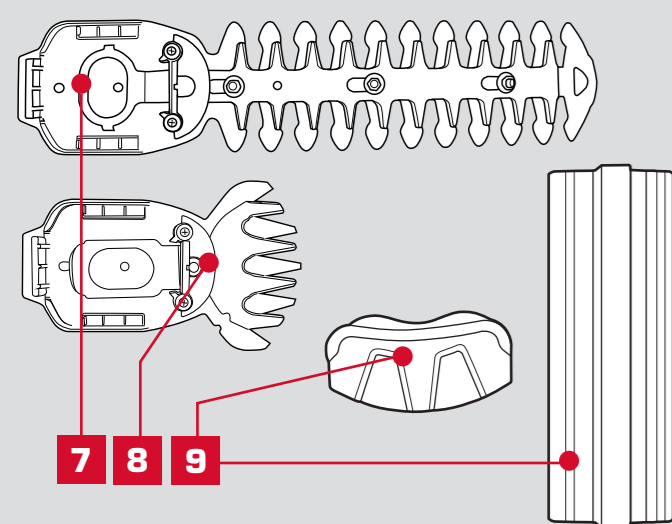

ONLINE MANUAL

Scan this QR Code with your mobile device to take you to the online manual.



5 YEAR
REPLACEMENT WARRANTY

SETUP & PREPARATION

1. CHANGING BLADES

WARNING! ENSURE THE TOOL IS SWITCHED OFF AND BATTERY DISCONNECTED BEFORE PERFORMING ANY OF THE FOLLOWING STEPS. WEAR GLOVES, BLADES ARE SHARP.

Inserting the Blade Base

- Slide the back of the blade base into the recess in the housing.

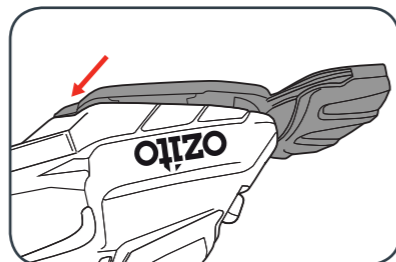

- Push the front of the blade base into the housing until it clicks into place.

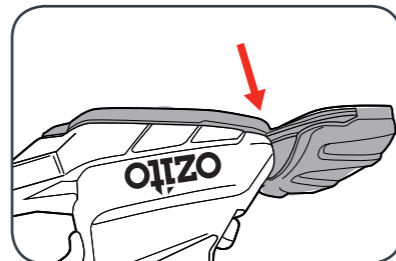

Remove the Blade Base

- Press and hold the base release button.

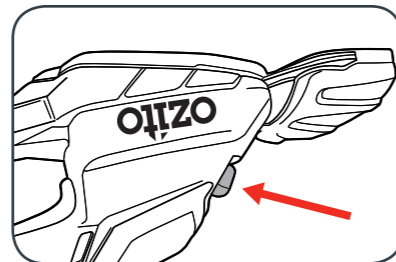

- Remove the base by lifting from the front and then sliding out.

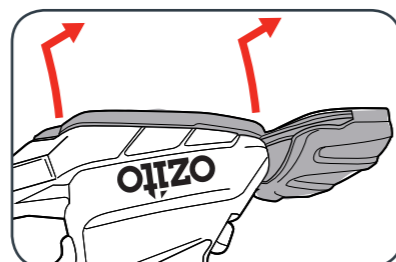

Note: Ensure the base is supported by hand when the release button is pressed to prevent it falling unexpectedly.

2. BATTERY & CHARGING (sold separately)

CAUTION: THE CHARGER FOR THIS PRODUCT SHOULD BE PROTECTED BY A RESIDUAL CURRENT DEVICE (RATED AT 30mA OR LESS).

The purchased battery will be shipped in a low charge condition, and requires charging prior to use.

Charging your lithium ion battery - Fast Charger

- Connect the charger into a mains power outlet.
- The charger LED will flash green showing power is being supplied to the charger.
- With the charger sitting on a flat surface, align the raised ribs on the battery with the recess in the charger and slide onto the charger ensuring a firm connection.
- The charger LED will illuminate red signifying that the battery is charging.
- The charger LED will illuminate green once the battery is charged.

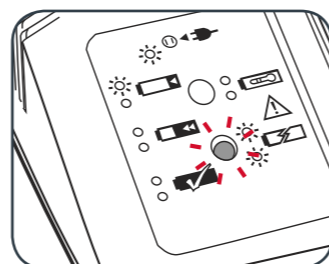
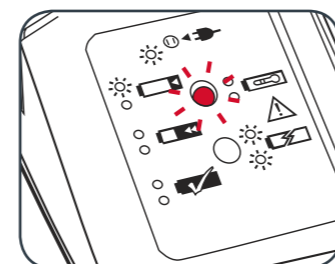
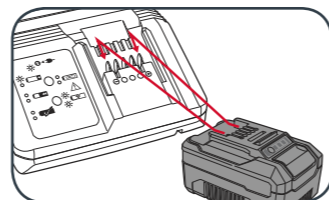
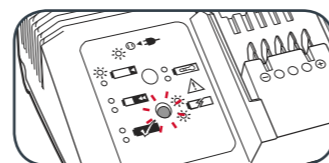

Charger LED Indicator

LED Indicator	Situation
GREEN (Flashing)	Stand By (no battery pack is inserted).
RED (Flashing)	Battery is charging (low charge).
RED (Illuminated)	Battery is charging (mid charge).
GREEN (Illuminated)	Battery is 85% - 100% charged and ready for use.
BOTH (Illuminated)	Battery pack is too hot or too cold (charging will begin automatically when battery reaches correct charging temperature).
BOTH (Flashing)	Defective battery. Never charge a defective battery pack! Remove battery pack from charger.

Charging your lithium ion battery - Eco Charger

- Connect the charger into a mains power outlet.
- The charger LED will flash green showing power is being supplied to the charger.
- With the battery sitting on a flat surface, align the raised ribs on the battery with the recess in the charger and slide onto the battery ensuring a firm connection.
- The charger LED will illuminate red signifying that the battery is charging.
- When removing the charger from the battery, first press the battery release tab, then slide the charger from its position.

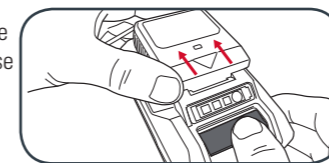
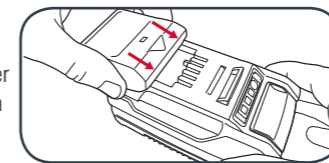
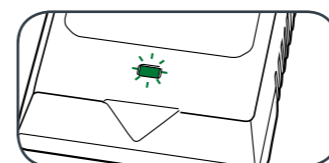

Charger LED Indicator

LED Indicator	Situation
GREEN (Flashing)	Stand By (no battery pack is inserted).
RED (Illuminated)	Battery is charging (low charge).
GREEN (Illuminated)	Battery is charged and ready for use.
RED (Flashing)	Battery or Charger fault.
RED & GREEN (Flashing)	Battery pack is too hot or too cold (remove battery from charger and store at room temperature 20°C. Insert battery again when at correct charging temperature). If this happens again, the battery is defective and needs to be replaced.

Battery Charge Indicator

The purchased battery is equipped with a battery charge indicator to show the state of the battery charge. Press the charge indicator button and look to see which LED lights.

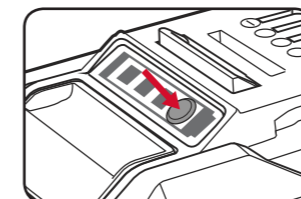

- Battery requires immediate charging
- Low state of charge, requires charging soon.
- Mid state of charge
- Full state of charge.

Note: The battery needs to be removed from the tool to check the state of charge.

3. INSERTING & REMOVING THE BATTERY

Inserting a Battery (not included)

- Align the ribs of the battery with the recess at the back of the handle.
- Slide the battery in so that it clicks into place.

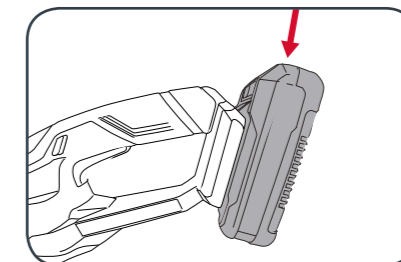
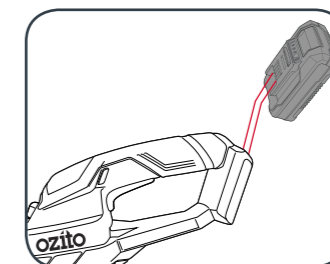

Removing a Battery

- Press and hold the battery release tab and then slide out.

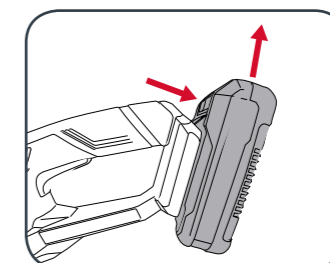

WARNING! DO NOT USE ANY ATTACHMENTS OR ACCESSORIES NOT RECOMMENDED BY THE MANUFACTURER OF THIS PRODUCT, AS IT CAN RESULT IN SERIOUS PERSONAL INJURY.

OPERATION

4. CONTROLS & OPERATION

Switching On and Off

- Press and hold the safety switch and then squeeze the on/off trigger to start.
- To stop operation, release the on/off trigger.

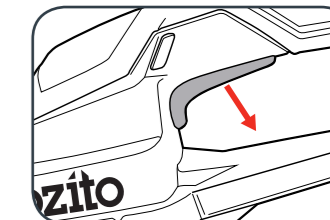
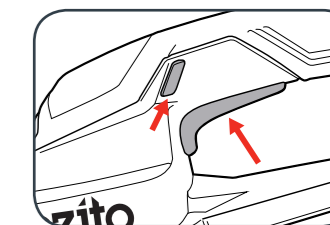

WARNING! CLEAR THE AREA TO BE CUT BEFORE EACH USE. REMOVE ALL OBJECTS, SUCH AS CORDS, LIGHTS, WIRE, OR STRING WHICH CAN BECOME ENTANGLED IN THE CUTTING BLADE AND CREATE A RISK OF SERIOUS PERSONAL INJURY.

Top cutting

Use a wide sweeping motion. A slight downward tilt of the cutting blades in the direction of motion gives the best cutting results.

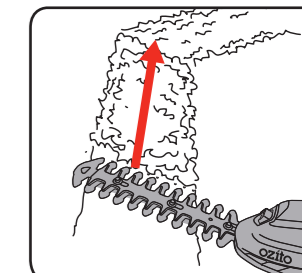

Side cutting

When trimming the sides of the hedge, begin at the bottom and cut upwards. Trim the side of a hedge so that it will be slightly narrower at the top. This shape will expose more of the hedge, resulting in a more uniform growth.

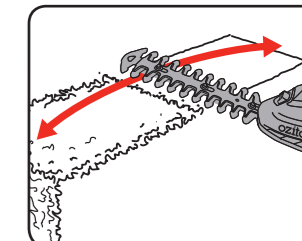

Using the Grass Shear:

Move the grass shear parallel to the ground. Direct the shear forward smoothly. Do not sweep the shear from side to side as this will not allow the blade to cut properly.

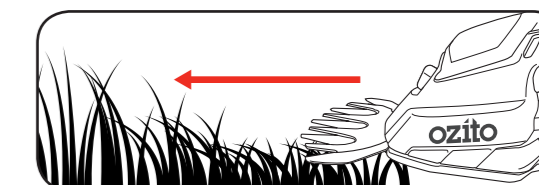

WARNING! IF THE BLADE JAMS ON AN HIDDEN ELECTRICAL CORD, DO NOT TOUCH THE BLADE! IT CAN BECOME LIVE AND VERY DANGEROUS. DISCONNECT THE ELECTRICAL SERVICE TO THE DAMAGED LINE BEFORE ATTEMPTING TO FREE THE BLADE.