

**Modern design and  
strong power for  
pleasant heat!**

**Einhell®**

**NEW GENERATION**



The wall heating unit NWH 2000 can be regulated by a twin-level heater (high-quality non-glowing heat element, so-called PTC-Heater) and timer. As soon as the equipment is switched on, the air discharge flap opens. An integrated noiseless roller fan and the connectable "Swing"-function of the air discharge lamellas, which turn upwards and downwards when electrically operated, distribute the warmth optimally in the room. If the unit is switched off, the air discharge flap closes time-delayed. All functions can be set directly on the unit itself or by the supplied Infra-red remote control.

The NWH 2000 is particularly suitable for hobby- and cellar-rooms, utility rooms, winter garden and bath/toilet (please pay attention to the national regulations).



## **NWH 2000 Wall Heater**

### **Logistic information:**

<b>Type:</b>	<b>NWH 2000</b>	<b>Sales unit:</b>	2 pcs
<b>Art.-No.:</b>	23.385.02	<b>20`:`:</b>	900 pcs
<b>Ident-No.:</b>	01018	<b>40`:`:</b>	1,800 pcs
<b>Bar code</b>	4006825 549980	<b>40``HC:</b>	2,082 pcs
<b>Packing:</b>	663 x 160 x 272 mm	<b>Weight:</b>	4.5 kg (net)
		<b>Weight:</b>	4.8 kg (gross)



Abbildungen können nicht im Serien-Lieferumfang enthaltenes Zubehör darstellen / Illustrations can contain accessories, which are not included in standard extent of delivery. Abbildungen ähnlich, produktionsbedingte Abweichung vorbehalten / Illustration similar (in design), production-wise modifications reserved.

File: S:\shared-pool\Product-Dokumentation\T-Produktbeschreibung\30\_n0t\Originale\_Englisch\_PA04\2338502\_01018.doc

Erstelldatum/create date: 18.06.2008 08:20:00Aktualisiert/up dated: 25.06.2008

Modern design and strong power for pleasant heat!

**Einhell**<sup>®</sup>  
NEW GENERATION

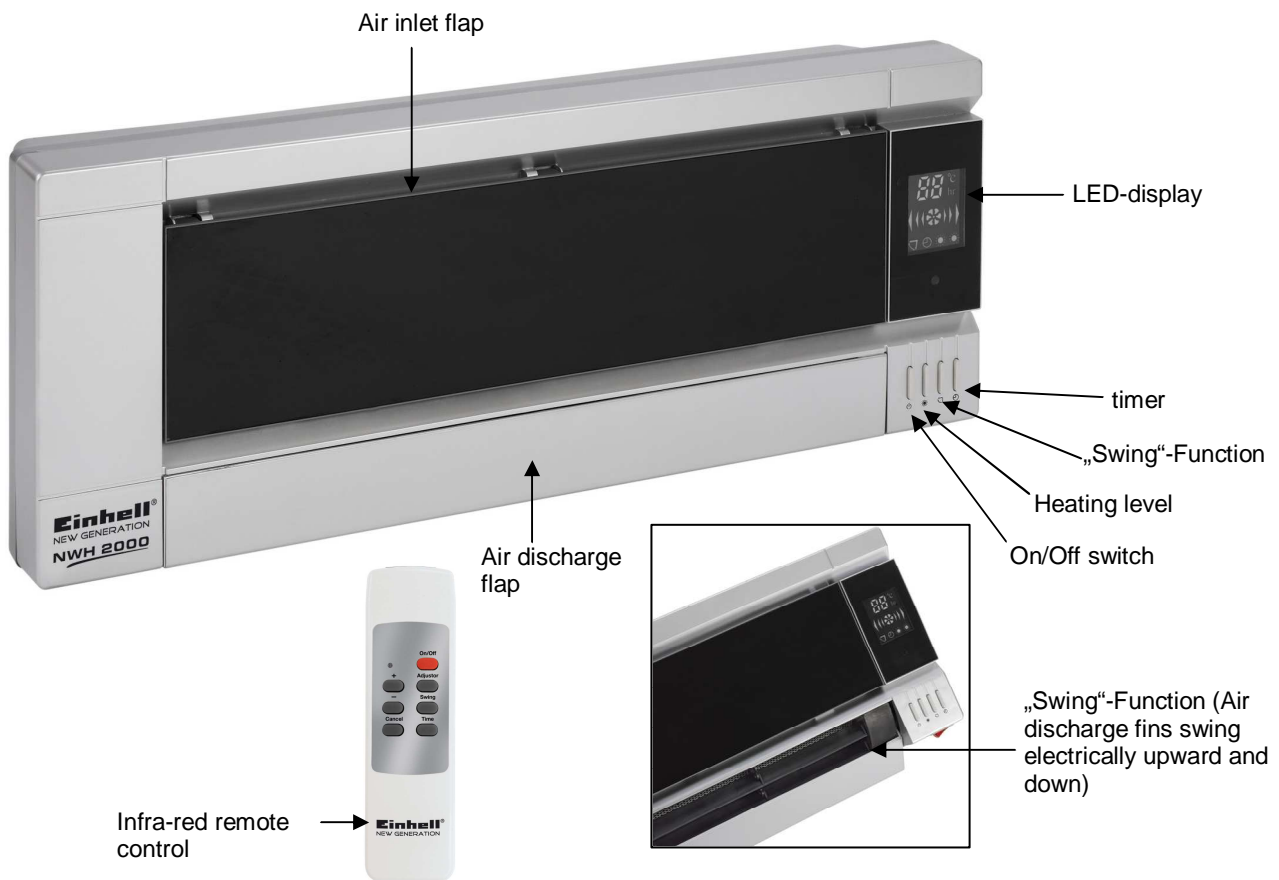

**Features:**

- Infra-red remote control
- Air filter
- Air discharge flap
- Air discharge fins automatically turnable
- On/Off switch
- 3 - level switch for fan and heating (1,000/2,000 W)
- 1 - 8 h timer
- Room temperature adjustable
- LED-display (Unit on, temperature, fan, "swing-function", timer, heating level)
- Switch-off-delay (fan switches off only after cooling down)
- Overheating protection
- „Swing“-Funktion (Air discharge fins swing electrically upward and down)

**Technical Data:**

- Mains: 230 V ~ 50 Hz
- Heating power: 2,000 W
- Mains cable: 3 x 1 mm<sup>2</sup> x 1.8 m
- Protection category: IPX0
- Tool dimensions: 623 x 133 x 243 mm

**Logistic information:**

<b>Type:</b>	<b>NWH 2000</b>	<b>Tool:</b>	<b>Wall Heater</b>
<b>Art.-No.:</b>	23.385.02	<b>Sales unit:</b>	2 pcs
<b>Ident-No.:</b>	01018	<b>20``:</b>	900 pcs
<b>Bar code</b>	4006825 549980	<b>40``:</b>	1,800 pcs
<b>Packing:</b>	663 x 160 x 272 mm	<b>40``HC:</b>	2,082 pcs
		<b>Weight:</b>	4.5 kg (net)
		<b>Weight:</b>	4.8 kg (gross)

