



Cordless Screwdriver LE-AS 14,4-2

Art.-No.: **45.131.62**

Bar code: 4006825515480

Sales unit: 5 pcs

Cordless Screwdriver for multi-purpose use. Smooth running, electronic speed control and an ergonomic design allow fatigue-free working.

Features:

- 17 step torque settings (1)
- Quick chuck (2)
- Right/left turn (3)
- Electronic speed control (4)
- 1 NiCd changeable accu 14.4 volts (5)

Standard accessories:

- 3-5 hour charger (6)
- Transport- and storage case (7)
- 1 additional NiCd changeable accu 14.4 volts (8)

Technical data screwdriver:

- Battery voltage: 14.4 volts
- Battery capacity: 1.2 Ah
- Idle speed: 0-550 min⁻¹
- Torque setting: 17 steps
- Weight: 3.1 kg
- Packing dimensions: 355 x 265 x 95 mm

Technical data charger:

- Charging time: 3-5 hour
- Charging current: 400 mA

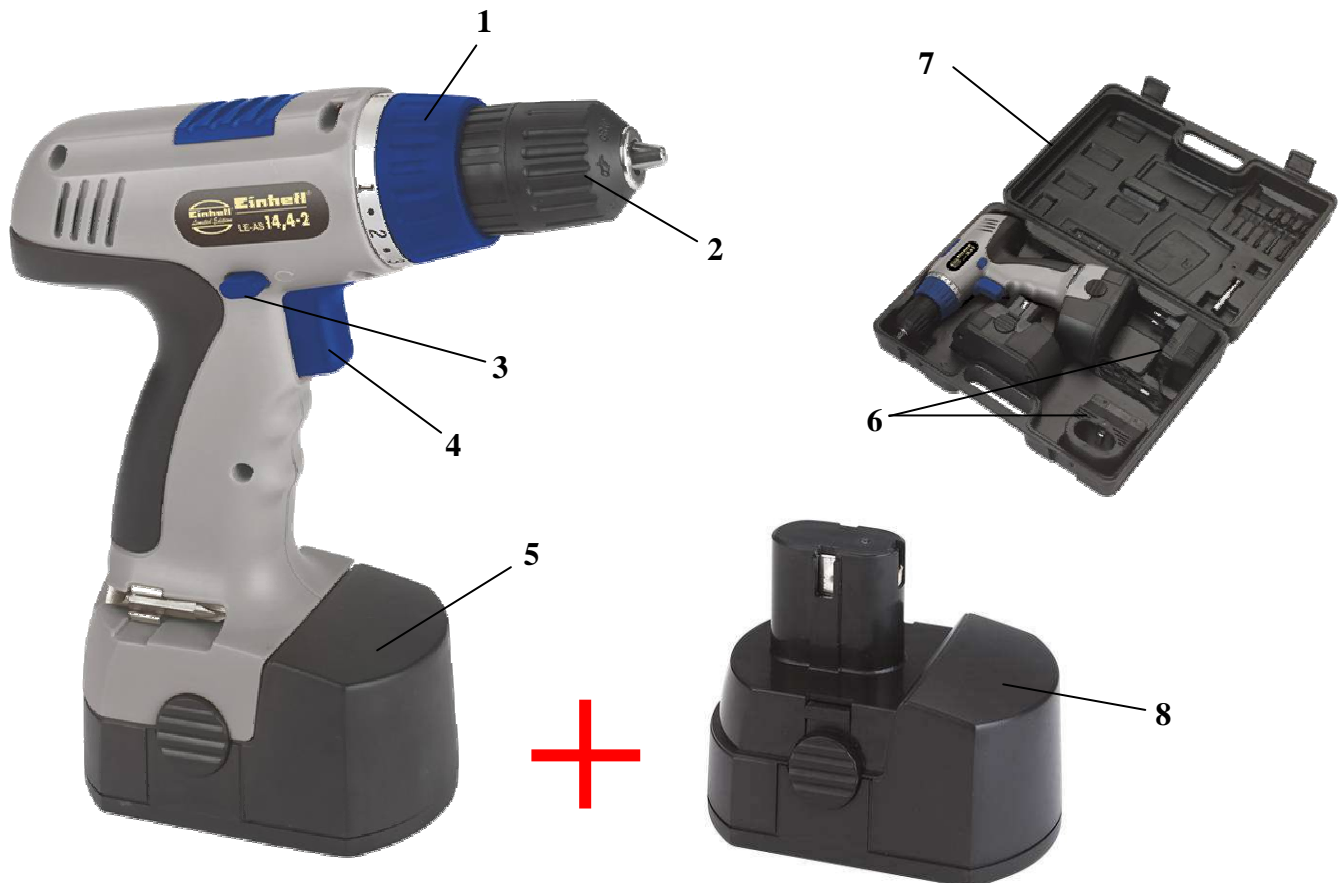

As special accessory available:

Spare power pack 14.4 volts

Art.-No.: **45.115.81**

Bar code: 4006825513929

Abbildungen können nicht im Serien-Lieferumfang enthaltenes Zubehör darstellen / Illustrations can contain accessories, which are not included in standard extent of delivery.

Abbildungen ähnlich, produktionsbedingte Abweichung vorbehalten / Illustration similar (in design), production-wise modifications reserved
File: G:\Webshop\T-Produktbeschreibung\60\Originale_Englisch_PA04\4513162_01015.doc

Erstelldatum / create date: 12.12.2005 4:27

Aktualisiert / up dated: 23.12.2005